

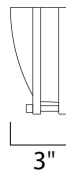

#### PRODUCT DESCRIPTION

Commercial grade energy efficient lighting featuring linear frames of metal finished in Satin Nickel diffused by an etched opal acrylic creating an updated energy efficient classic.

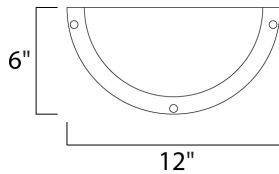

#### MEASUREMENTS

DIMENSION : 12" W x 6" H x 3" Ext  
MAX OAH :  
HANGING WEIGHT : 1.29 lb

#### LAMPING

INPUT VOLTAGE : 120-277V  
LUMENS : 700 Rated  
BULB : 1 x 12W LED PCB Integrated , 12W Total  
BULB INCLUDED : (Integrated)  
DIMMABLE : No  
CRI : 90+ CRI  
COLOR\_TEMP : 3000K

#### FINISHES OPTION

 Satin Nickel (SN)

#### GLASS

White WT

#### MATERIAL

Steel, Opal Acrylic

#### RATINGS

cETLus  
Damp Location  
ADA



#### ADDITIONAL

INSTALL UP/DOWN: Up/Down  
OPERATING TEMPERATURE:  
-20°C (-4°F), 40°C (104°F)

PHOTOMETRIC: Report Found Online

Always consult a qualified electrician before installing any lighting product.



WESTERN DISTRIBUTION CENTER (HEADQUARTER)  
253 NORTH VINELAND AVE | CITY OF INDUSTRY, CA 91746

EASTERN DISTRIBUTION CENTER  
101 GARDNER PARK | PEACHTREE CITY, GA 30269

P. 626.956.4200 | F. 626.956.4225 | maximlighting.com