



PIPELINE SERIES PENDANT CM9

DESIGNER
CAINE HEINTZMAN

INSTRUCTIONS



SCAN HERE

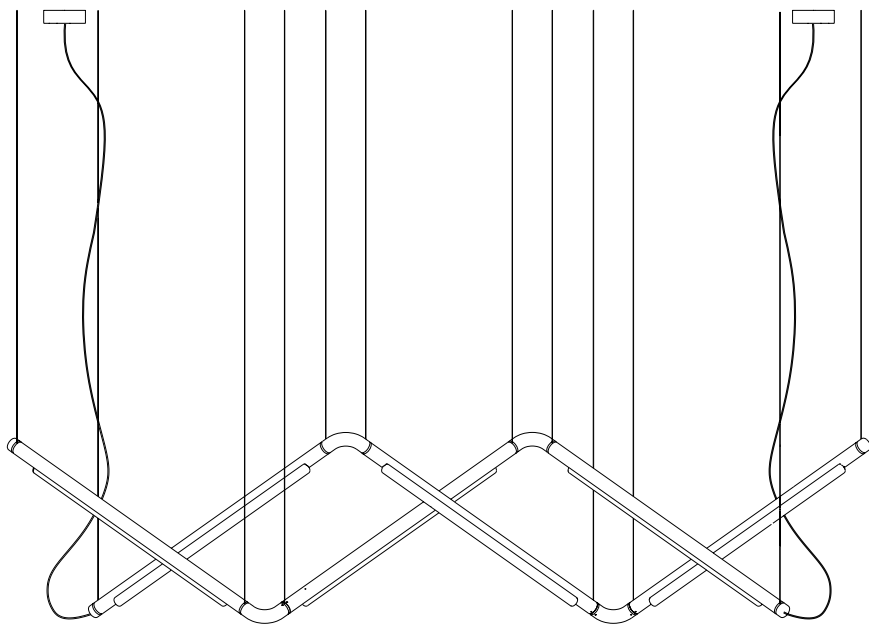

NORTH AMERICA



a-n-d.com

INSTALLATION NOTES

The luminaire is powered by 24V DC. A constant voltage LED driver is required to operate the luminaire. The LED driver varies, depending on input voltage and dimming requirements.

It is recommended that two people install the Pipeline Pendant; one to gently support the luminaire while the other makes the electrical and mechanical connections to the ceiling.

For questions regarding installation, please email **info@a-n-d.com**



CARE INSTRUCTIONS

Always wear clean gloves when handling the luminaire. Clean finished surfaces with a soft, lint-free cloth. Clean acrylic diffuser soft lint-free cloth or an unscented magic eraser pad.

For replacement parts contact A-N-D directly.



WARNING

The luminaire must be installed by a qualified electrician in a dry indoor location.

Failure to meet any or all of these criteria will not only damage the luminaire, but will void both the warranty and all of its certifications.

PIPELINE CM9

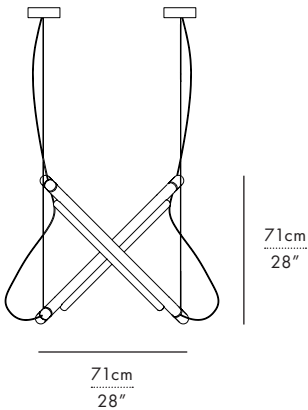
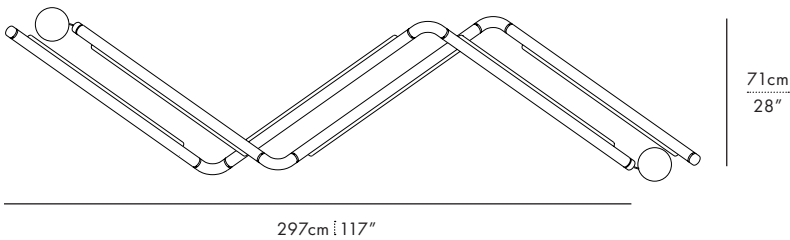
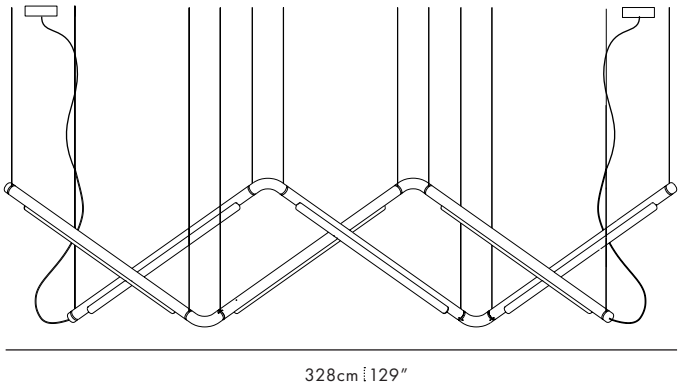

COMPONENTS

- ① BACKPLATE (2)
- ② #8-32 SCREW (4)
- ③ WIRE NUT (8)
- ④ LED DRIVER (2)
- ⑤ CANOPY (2)
- ⑥ CANOPY SCREW (6)
- ⑦ STRAIN RELIEF (2)
- ⑧ ELECTRICAL CORD (2)
- ⑨ O-RING (8)
- ⑩ POWERCAP ASSEMBLY (2)
- ⑪ CEILING ANCHOR (12)
- ⑫ #6 SCREW (12)
- ⑬ CABLE GRIPPER (12)
- ⑭ SUSPENSION CABLE (12)
- ⑮ ENDCAP ASSEMBLY (2)
- ⑯ LUMINAIRE (6)
- ⑰ ACRYLIC DIFFUSER (6)
- ⑱ SETSCREW (12)
- ⑲ CONNECTOR (8)
- ⑳ ELBOW (4)

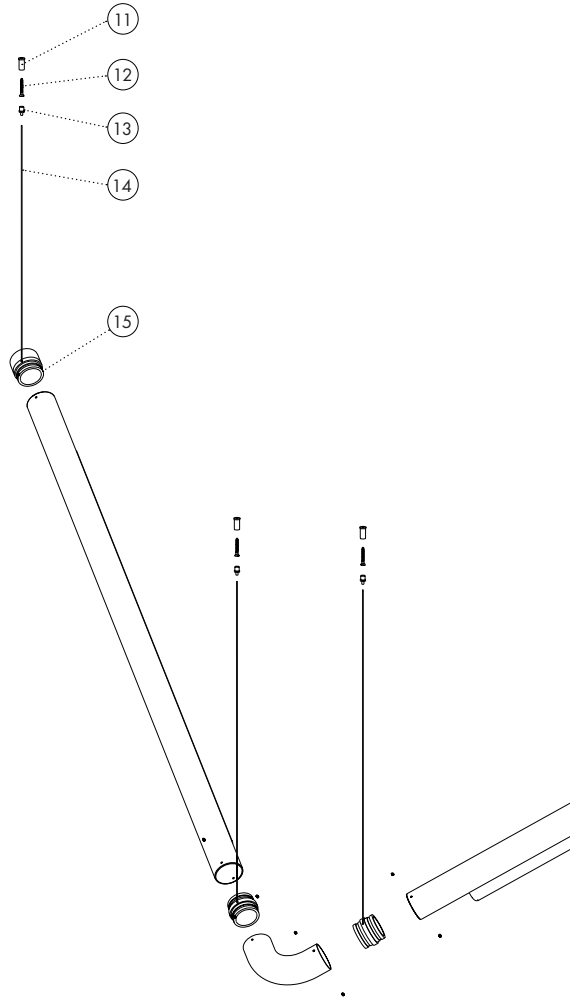

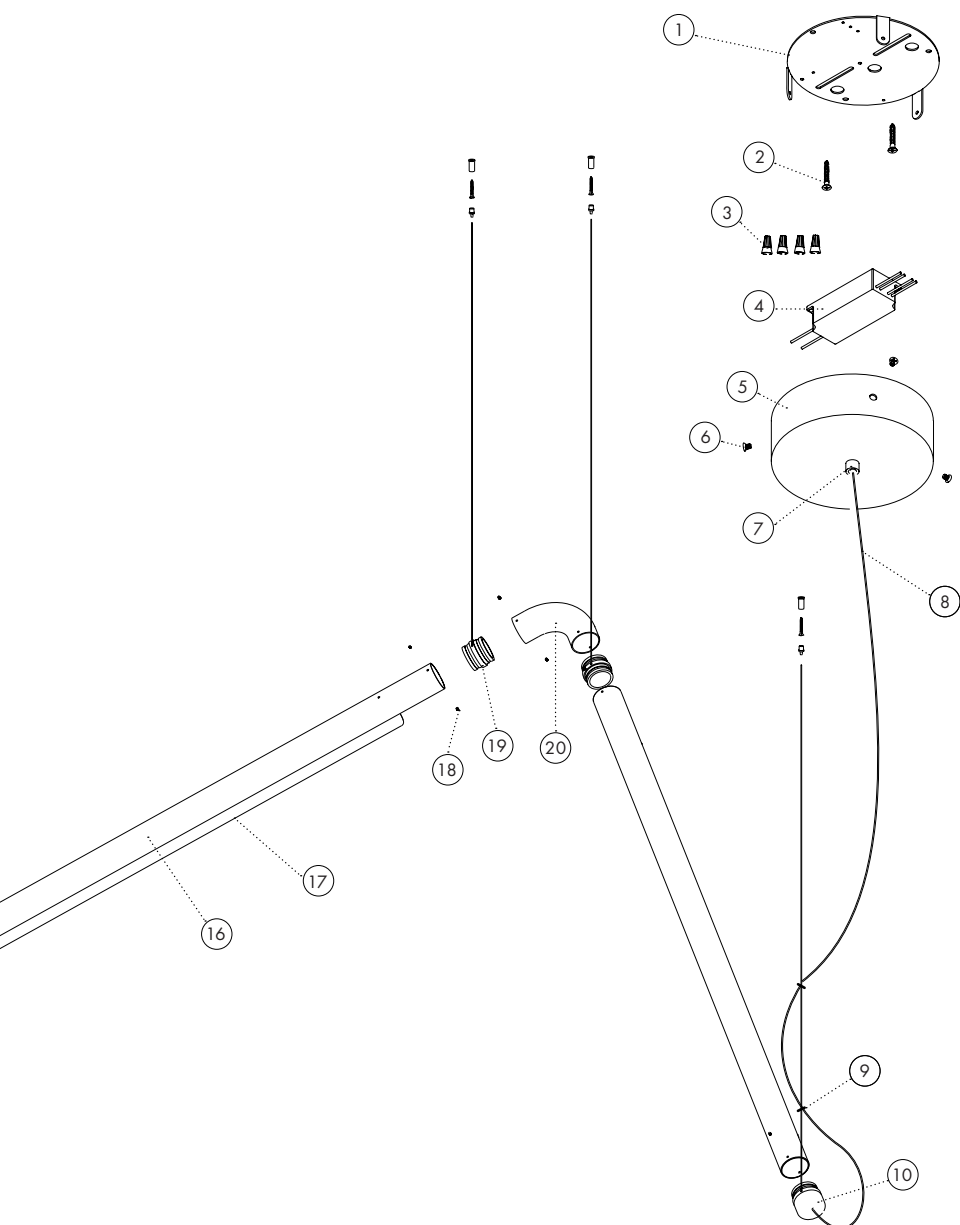

*PARTIAL CM9 MODEL SHOWN

LED DRIVER OPTIONS

The Pipeline Pendant LED driver varies depending on dimming requirements and input voltage.

Use the ordering code to determine the driver selected:
ie. PIP-CM9-P-BK-BK-27-010-277

DIMMING --- INPUT VOLTAGE

PHASE CUT DIMMING (PC)

M40 SERIES - ES POWER

INPUT: 120VAC

OUTPUT: 24VDC, 75W

L x W x H: 140 x 49 x 32

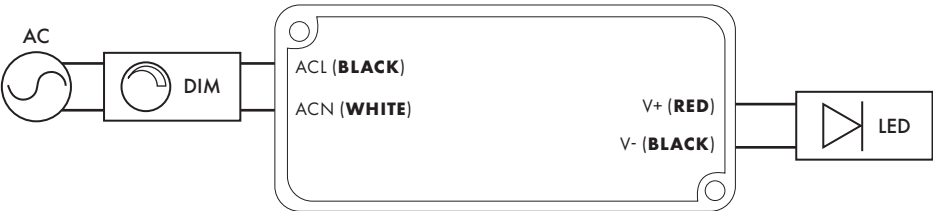

0-10 + PWM DIMMING (010)

Q68-P SERIES - ES POWER

INPUT: 110-277VAC

OUTPUT: 24VDC, 68W

L x W x H: 140 x 49 x 32

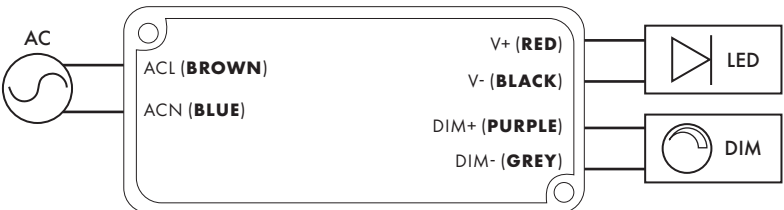

PREPARATION



STEP 1

Determine the drop height of the fixture and set cable lengths.

Suspension cable length:

Position the cable grippers on the suspension cables to set the luminaire's drop height.

! Caution!

Do not trim cables until installation is complete. This allows for any required adjustments.

Electrical cord length:

When trimming excess length, add an extra 45cm/18" to the lowest drop height. This allows for slack and electrical connections inside the canopy.

! Caution!

The electrical cord must not bear any weight.

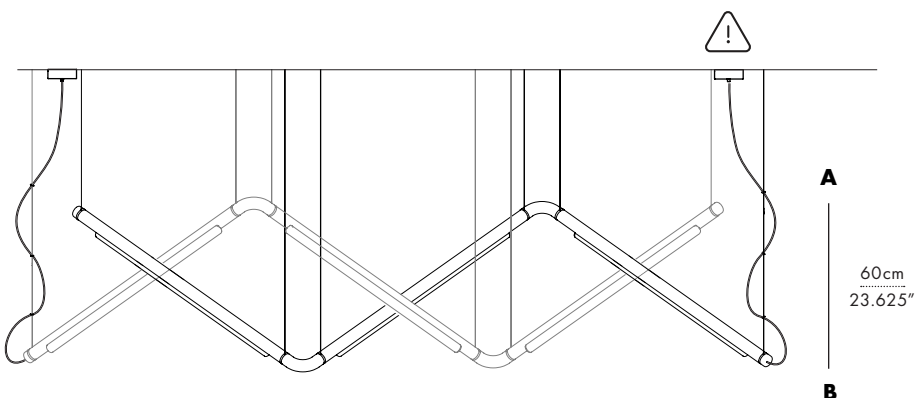
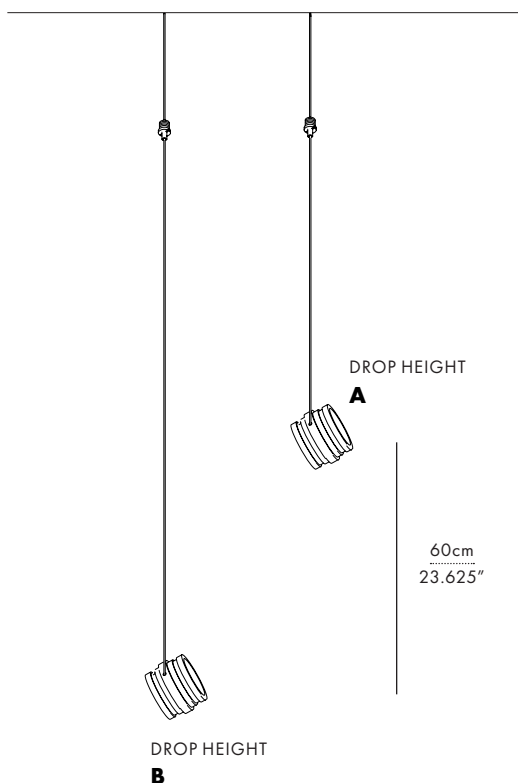

The CM9 has two drop heights to calculate high and low.

The difference in height between the two drop heights is 60cm/23.625".

The two heights are labelled **A** and **B**.

INSTALLATION

STEP 2

Mark the suspension anchor points on the ceiling.

If required, a substrate specific anchor is to be provided by installer. Ex: drywall anchors.

There are 12 anchors total.
The anchors are placed in two parallel lines of 6 anchors.

See the spacing on the diagram for details.

✕ = ANCHOR POINTS

STEP 3

Install the suspension cable anchors on ceiling.

Use the provided #6 screws.

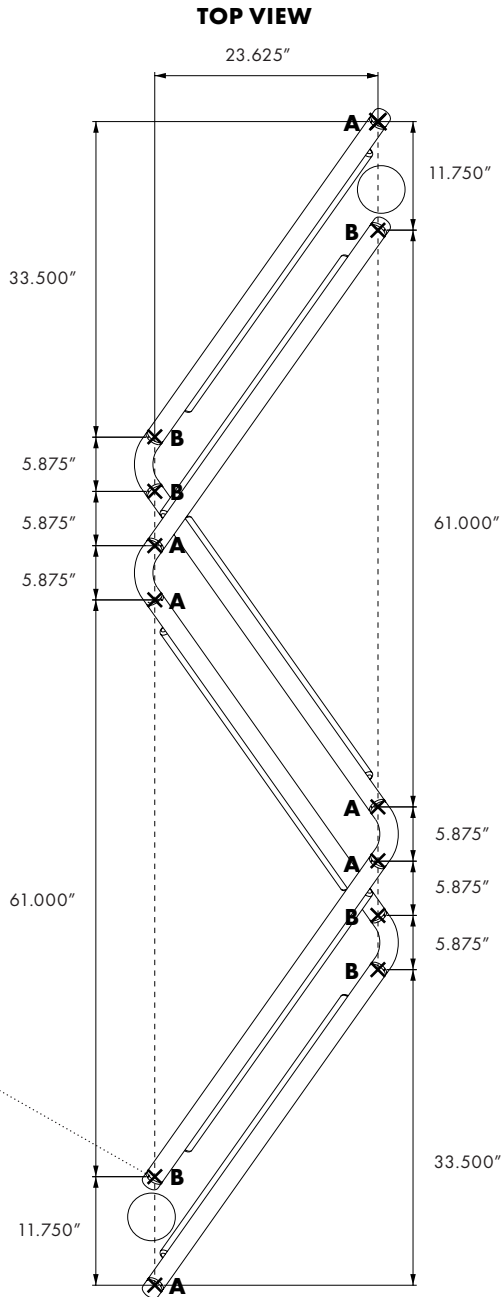
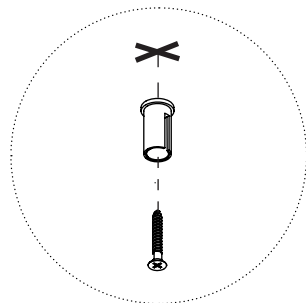

STEP 4

Hang the suspension cables and connectors.

Attach the suspension cable grippers to the ceiling anchors by threading them clockwise.

Align the suspension cable so that it exits the slot in the side of the ceiling anchor.

To adjust the position of the cable in the cable gripper, push the center pin inwards. This releases the auto-locking mechanism on the cable.

NOTE:

Intertwine the two luminaires.

Before hanging and connecting the luminaires together, take note of the arrangement.

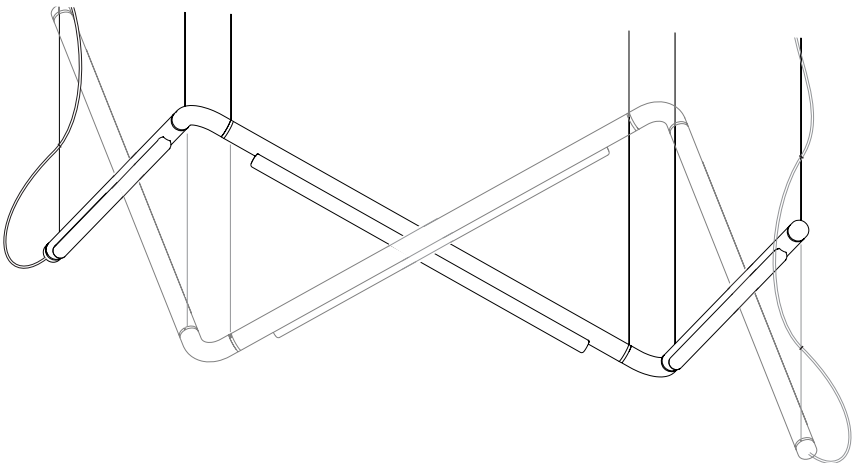
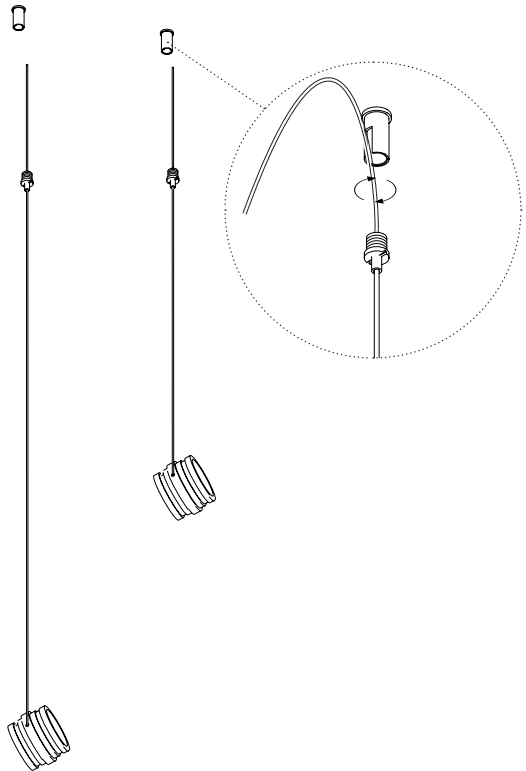

INSTALLATION

STEP 5

Suspend the luminaire.

Attach one section at a time.
Connect the elbows last.

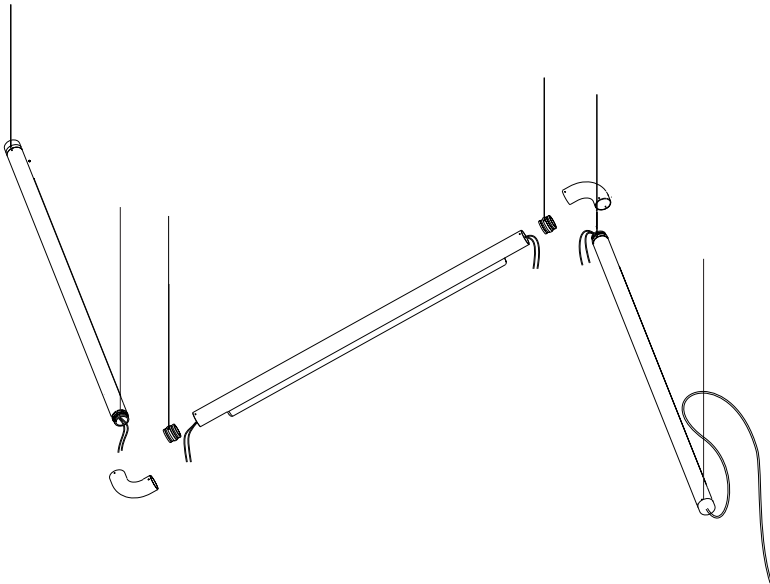

5A

Connect the internal electrical wires:

Red wire to red wire (V+)

Black wire to black wire (V-)

Use the electrical cord extension to connect through the elbows.

Push the electrical wires and connectors inside the luminaire.

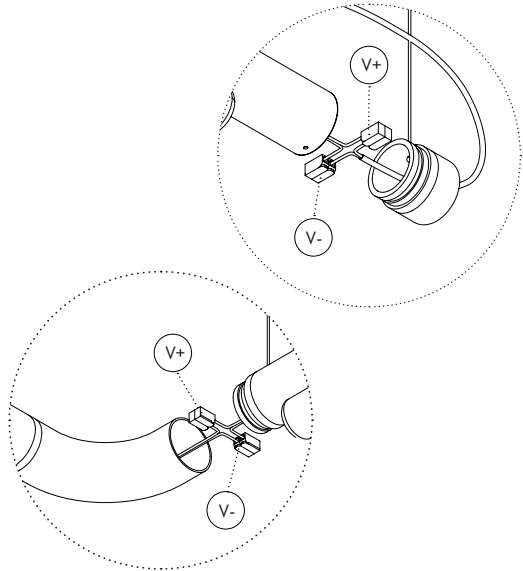

5B

Connect and close the luminaire sections.

Use the provided set screws and hex key.

Tighten the set screws until the sections are aligned and secure.

Caution!

Overtightening the set screws will cause misalignment and possibly damage the luminaire.

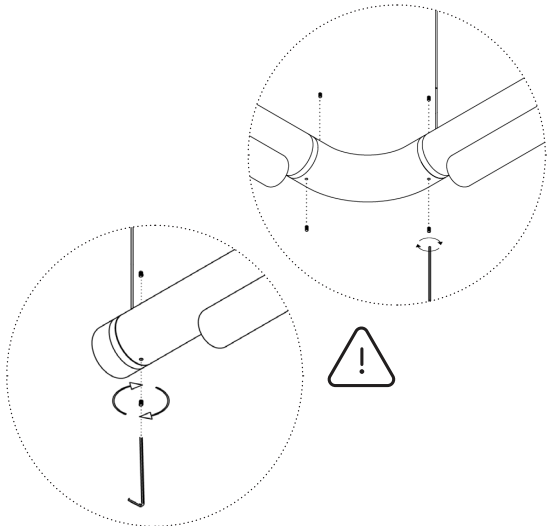

INSTALLATION

STEP 6

Mount the backplate to the junction box and pull the wires through.

Use the provided #8-32 screws.

⚠ Caution!

Ensure that the power is disconnected at the breaker.

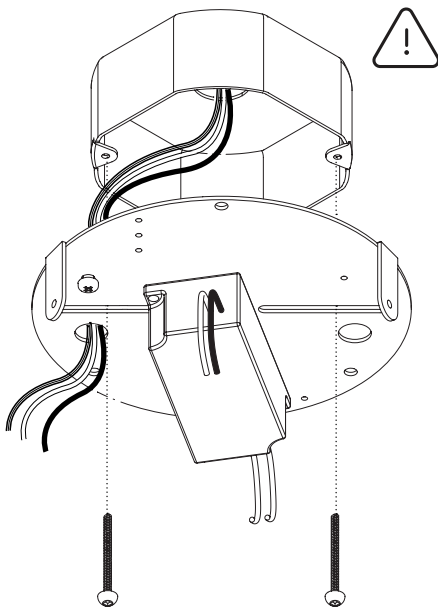

STEP 7

Connect the primary circuit on the LED driver to input power. Connect ground.

Black/brown wire = **Line** (L)

White/blue wire = **Neutral** (N)

Green screw = **Ground** (G)

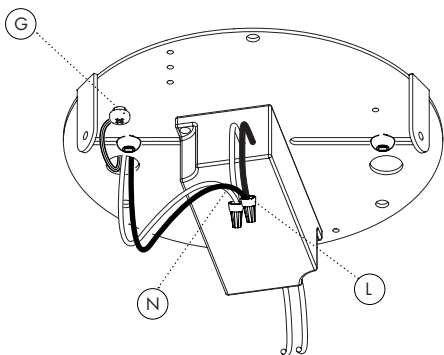

REFER TO PAGE 6: DRIVER OPTIONS FOR MORE DETAILS

STEP 8

Connect the luminaire to secondary circuit on LED driver.

Dashed line = **Positive** (V+)

Black = **Negative** (V-)

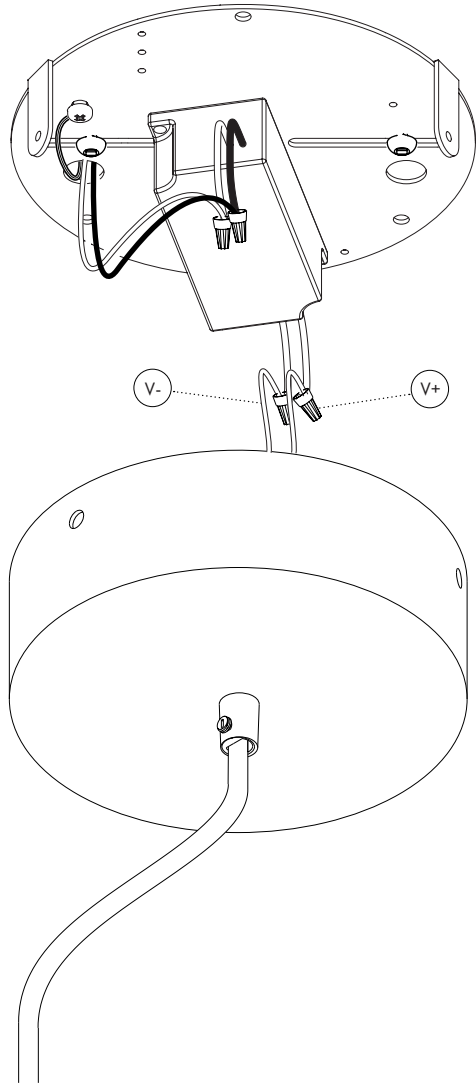

REFER TO PAGE 6: DRIVER OPTIONS FOR MORE DETAILS

INSTALLATION

STEP 9

Attach the canopy to the backplate and secure the electrical cord.

Use the provided colour matched machine screws to attach the canopy.

Adjust the position of the electrical cord then secure it by tightening the screw on the strain relief until it gently holds it in place.

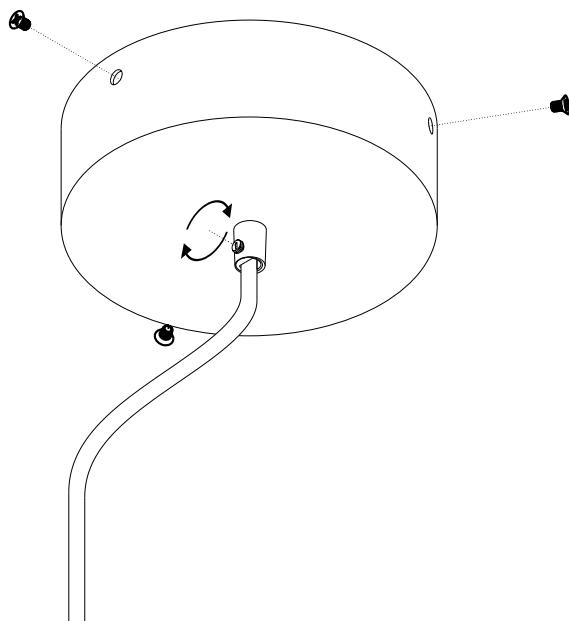

STEP 10

Adjust the position of the electrical cord and trim excess cable.

Use the O-rings to create a sweep of the electrical cord along the suspension cable.

This is a visual element of the Pipeline luminaire.

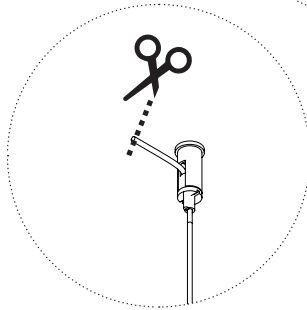
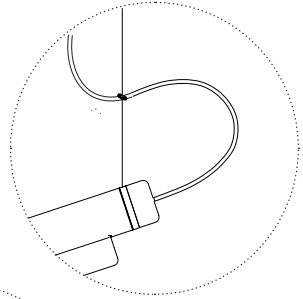



For support, please contact:

info@a-n-d.com

+1 604 563 6938

A-N-D

1951 Franklin St,
Vancouver, BC
Canada V5L 0C7

a-n-d.com