



---

# PIPELINE SERIES

## CEILING/WALL 40 + 125

---

DESIGNER  
**CAINE HEINTZMAN**

INSTRUCTIONS



SCAN HERE

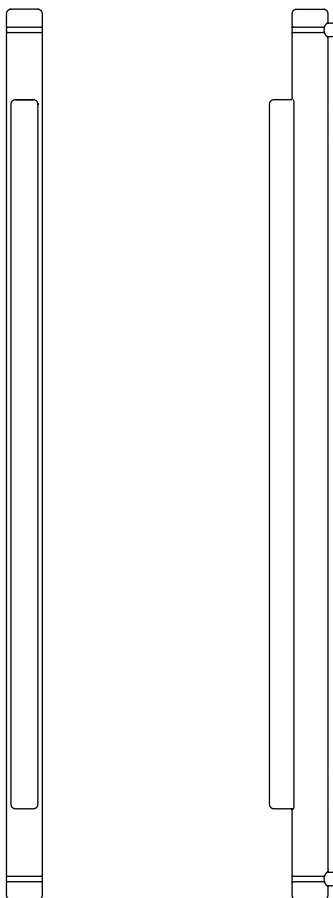

**NORTH AMERICA**



**a-n-d.com**

# INSTALLATION NOTES

---

It is recommended that two people install the Pipeline Ceiling/Wall; one to gently support the luminaire while the other makes the electrical and mechanical connections.

Both installers should wear clean gloves and take great care not to damage the luminaire.

For questions regarding installation, please email **info@a-n-d.com**



---

## CARE INSTRUCTIONS

Always wear clean gloves when handling the luminaire. Clean finished surfaces with a soft, lint-free cloth. Clean acrylic diffuser with a soft lint-free cloth or an unscented magic eraser pad.

For replacement parts contact A-N-D directly. Never exceed the recommended wattage, as doing so may damage the luminaire or cause a fire.



---

## WARNING

The luminaire must be installed by a qualified electrician in a dry indoor location.

Failure to meet any or all of these criteria will not only damage the luminaire, but will void both the warranty and all of its certifications.

Always ensure circuit breaker is off prior to making electrical connections.

# LED DRIVER OPTIONS



The Pipeline CW LED driver varies depending on dimming requirements and input voltage.

Use the ordering code to determine the selected driver:

ie. PIP-40-CW-BK-BK-27-010-120

DIMMING --- INPUT VOLTAGE

## PHASE CUT DIMMING

M-28 SERIES - ES POWER

**INPUT:** 110V-130VAC

**OUTPUT:** 24VDC, 24W

**L x W x H:** 89 x 42 x 31



## 0-10 + PWM DIMMING

Q22-P SERIES - ES POWER

**INPUT:** 110-277VAC

**OUTPUT:** 24VDC, 22W

**L x W x H:** 89 x 42 x 31

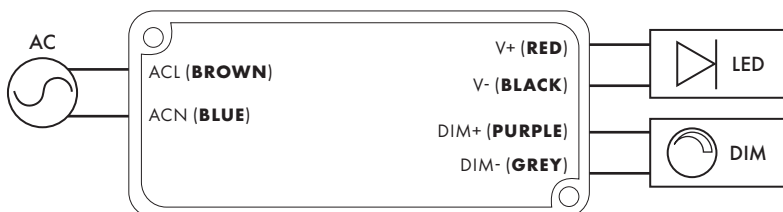

# PIPELINE OPTIONS

The Pipeline Ceiling/Wall is available in 2 sizes, and can be installed on a ceiling or wall, vertically or horizontally.

PIPELINE 40

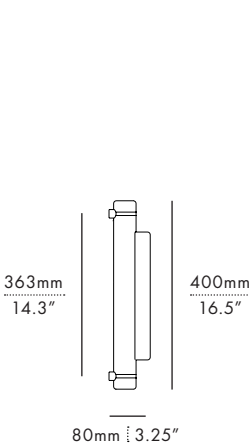

PIPELINE 125

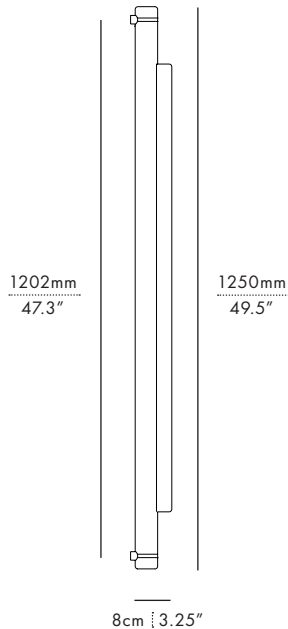

There are three installation options:

**OPTION 1 – P. 5**

**Cover Plate:** The luminaire mounts above the wall surface and a decorative plate conceals the connections to the junction box.

**OPTION 2 – P. 12**

**Trimless (Mud In):** The mounting hardware is concealed beneath drywall, creating a subtle and elegant connection to the ceiling or wall.

**OPTION 3 – P. 20**

**Trimless (Surface Mount):** The luminaire mounts directly to the wall or ceiling surface.

# COMPONENTS — OPTION 1



## COVER PLATE

- ① SHOE SHIM
- ② MOUNTING SHOE (2)
- ③ 5MM SHOE MOUNTING SCREW (2)
- ④ #6 SURFACE MOUNTING SCREW
- ⑤ SET SCREW (4)
- ⑥ HEX KEY
- ⑦ MOUNTING FOOT (2)
- ⑧ LUMINAIRE BODY
- ⑨ ACRYLIC DIFFUSER
- ⑩ ENDCAP (2)
- ⑪ 30MM COVERPLATE MOUNTING SCREW
- ⑫ COVERPLATE
- ⑬ JUMPWIRE
- ⑭ 25MM #8-32 SCREW (2)
- ⑮ UNIVERSAL BACKPLATE
- ⑯ DRIVER
- ⑰ WIRE NUTS (4)

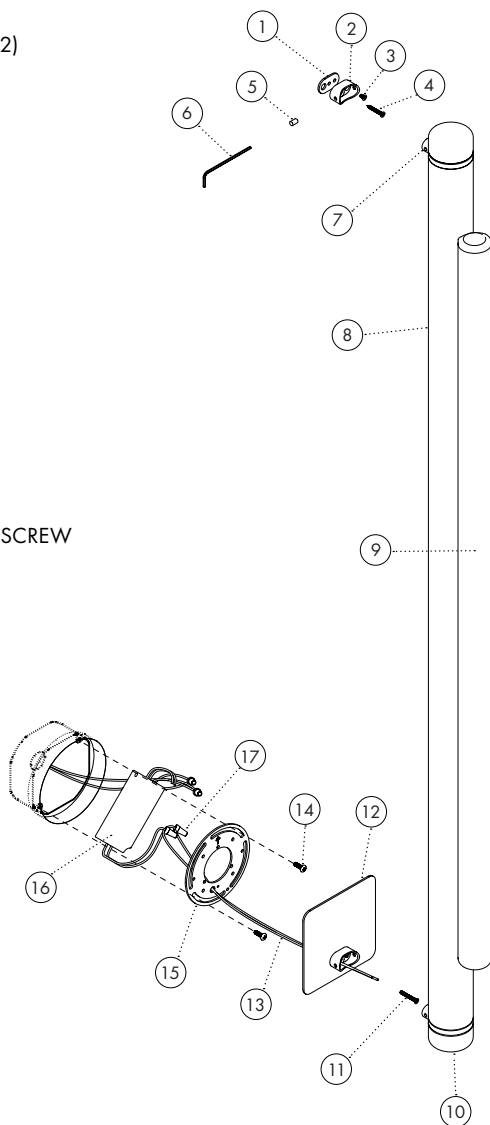

\* PIPELINE CW 125  
MODEL SHOWN

# INSTALLATION — OPTION 1

## COVER PLATE

For Cover Plate option, the luminaire mounts above the wall surface and a decorative plate conceals the connections to the junction box.

### STEP 1

Turn off breaker.

Connect mains to driver, and driver to jump wire following driver **PAGE 3** and wiring diagram.

Pull jump wire through universal backplate and place driver in enclosure.

Fasten universal backplate to junction box using (2) 8-32 screws.

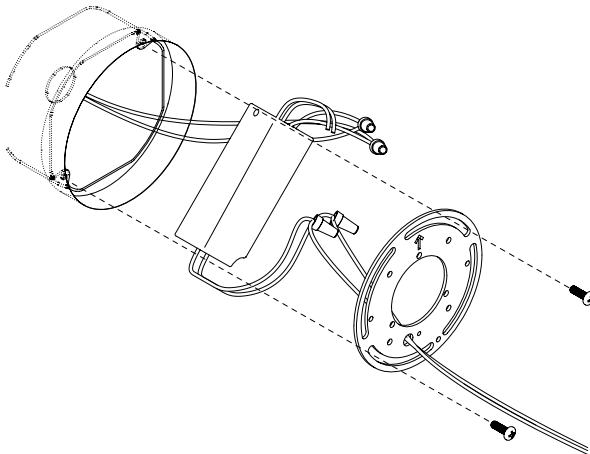
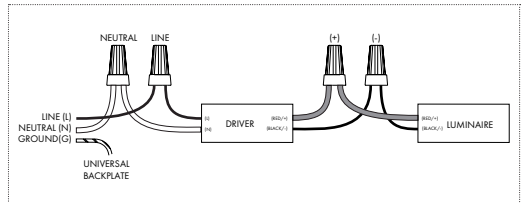

REFER TO PAGE 3: DRIVER OPTIONS FOR MORE DETAILS

## COVER PLATE

### STEP 2

Fasten Pipeline shoe to coverplate using 5mm screw.

Pull jump wire through largest opening of shoe/coverplate.

Fasten coverplate assembly to corresponding hole on universal backplate using 30mm screw.

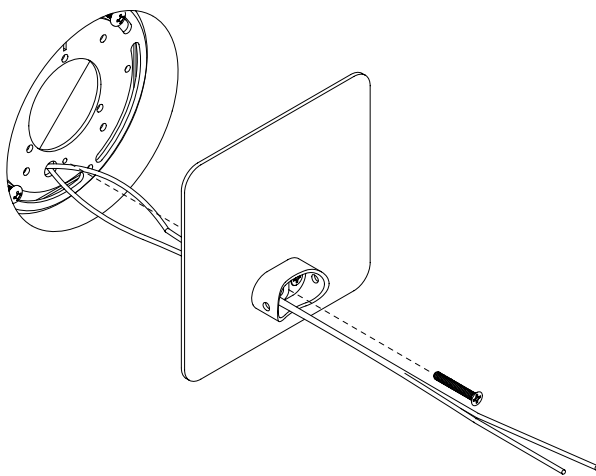

COVER PLATE

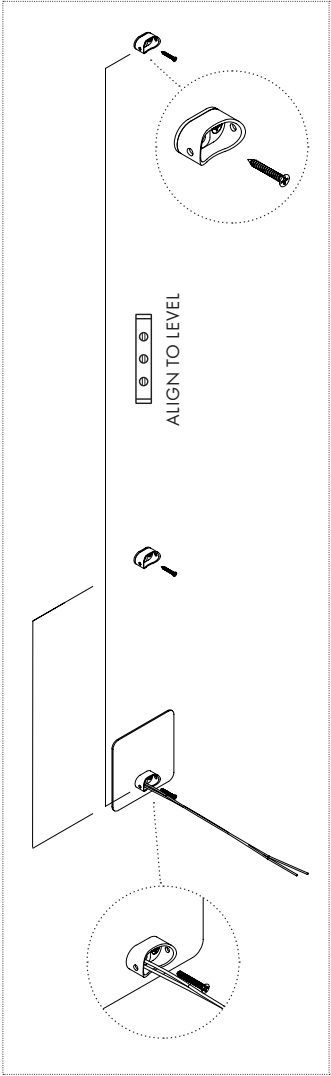

PIPELINE 125

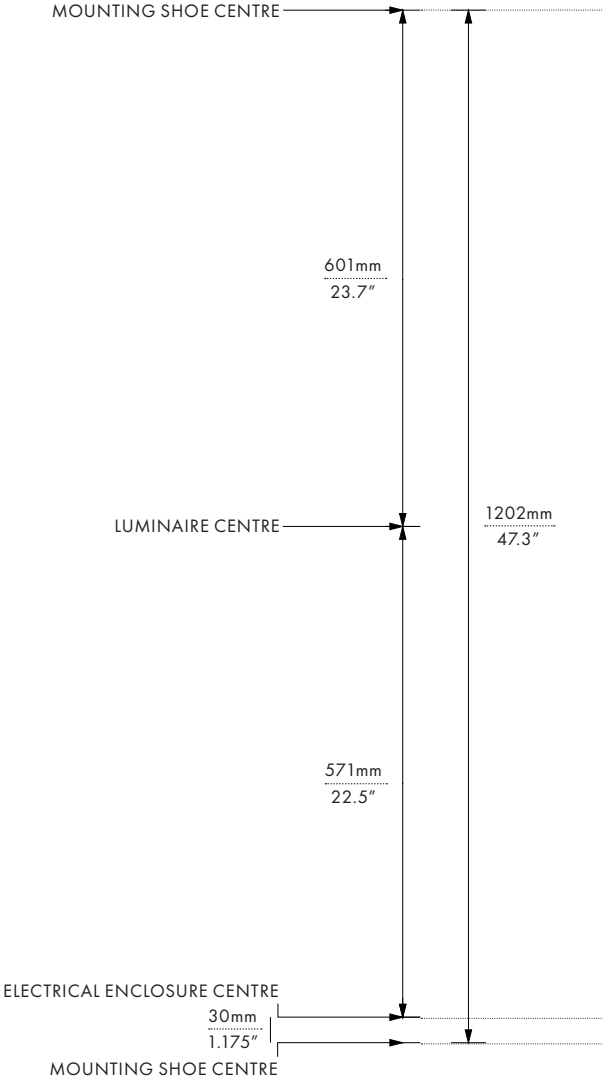



## COVER PLATE

### STEP 3

Fasten the shoe shim to the shoe using the 5mm screw.

Using the centre of the mounted shoe as a reference, measure, mark and fasten the second Pipeline shoe corresponding to the spacing your model requires.

\*Mounting shoe centre is offset 30mm / 1.175" from electrical enclosure centre.\*

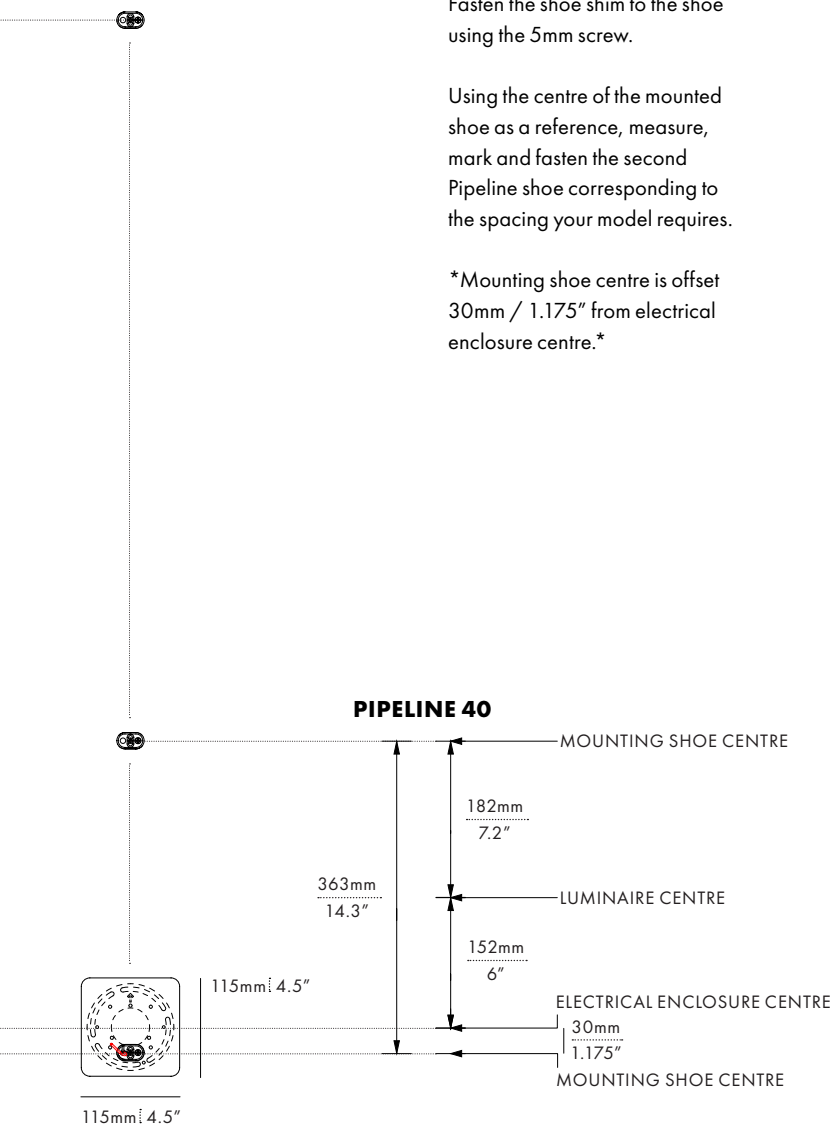

**STEP 4**

Feed the jump wire through the Pipeline foot and out the bottom of the open end of the Pipeline body. Insert the Pipeline feet into the Pipeline shoes while guiding the jump wire.

Connect jump wires to wire connectors from the luminaire and replace into the body.

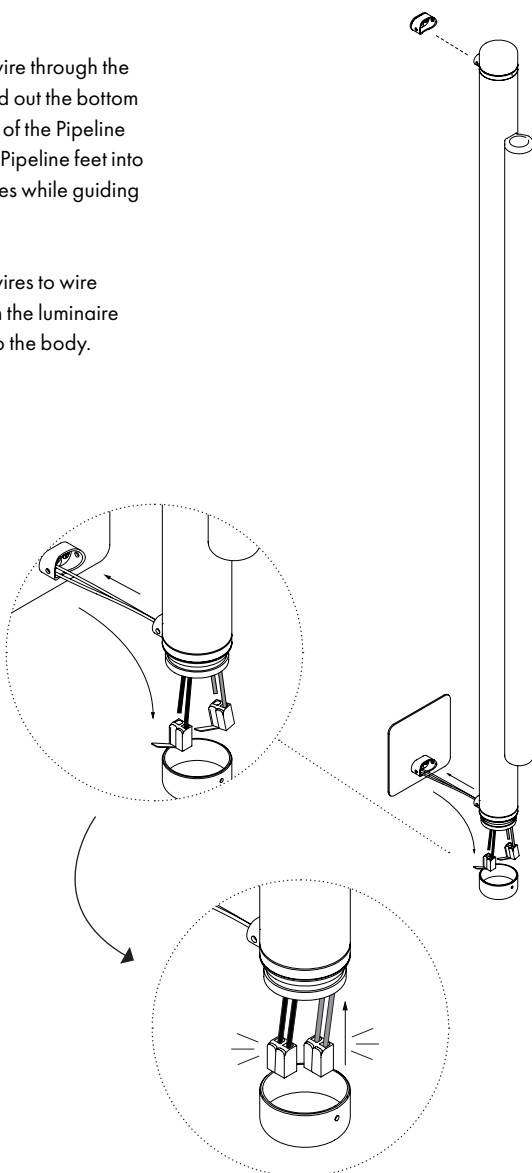

COVER PLATE

# STEP 5

Fasten the feet into the shoes using provided hex key and set screws.

Place the endcap onto the luminaire and secure with set screw.

Once secure turn endcap so screw is facing towards the wall.

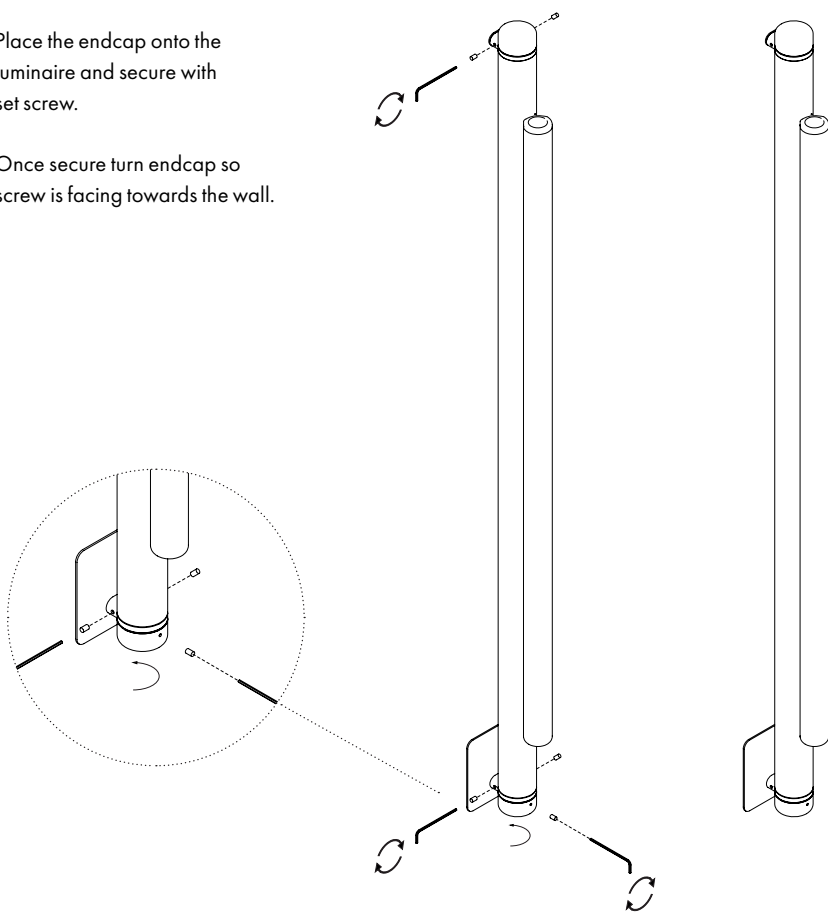

# COMPONENTS — OPTION 2

TRIMLESS (MUD IN) \*REMOTE DRIVER ONLY\*

\* PIPELINE CW 125  
MODEL SHOWN

- ① MOUNTING SHOE (2)
- ② 5MM SHOE MOUNTING SCREW
- ③ #6 SURFACE MOUNTING SCREW
- ④ SET SCREW (4)
- ⑤ HEX KEY
- ⑥ MOUNTING FOOT (2)
- ⑦ LUMINAIRE BODY
- ⑧ ACRYLIC DIFFUSER
- ⑨ ENDCAP (2)
- ⑩ MESH MUD TAPE
- ⑪ 30MM MUD-IN PLATE MOUNTING SCREWS (4)
- ⑫ MUD-IN PLATE
- ⑬ JUMPWIRE
- ⑭ 25MM #8-32 SCREW (2)
- ⑮ UNIVERSAL BACKPLATE
- ⑯ 30MM DEPTH SCREWS & NUTS (3)
- ⑰ DRIVER (REMOTE)
- ⑱ WIRE NUTS (4)

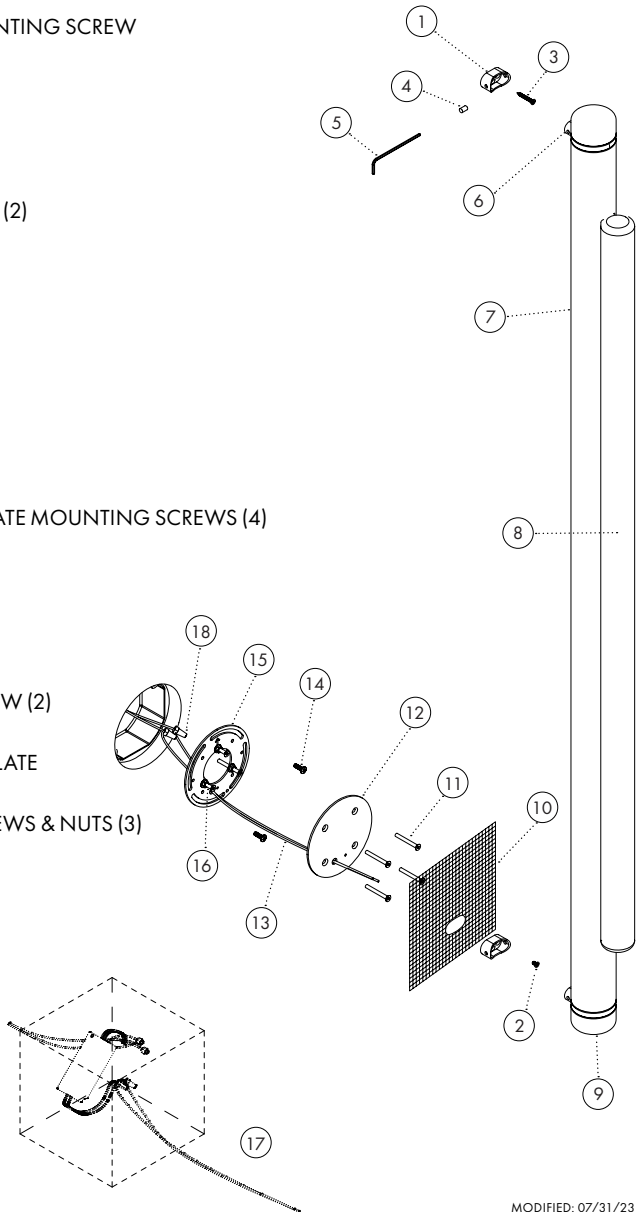

# INSTALLATION — OPTION 2



## TRIMLESS (MUD IN) \*REMOTE DRIVER ONLY\*

For Trimless (Mud In) option, the mounting hardware is concealed underneath drywall, creating a subtle connection to the junction box.

Due to the need for drying time, the installation requires several days to complete. Using a drywall professional is recommended.

### STEP 1

Turn off breaker.

Following driver **PAGE 3** and wiring diagram, connect mains to remote driver, and run low voltage wire to enclosure.

Connect jump wire and pull through universal backplate. Fasten universal backplate to junction box using (2) 8-32 screws.

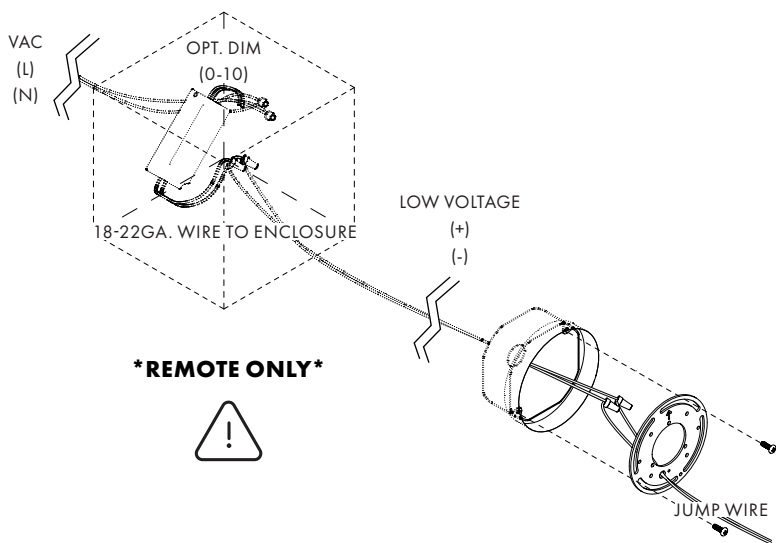
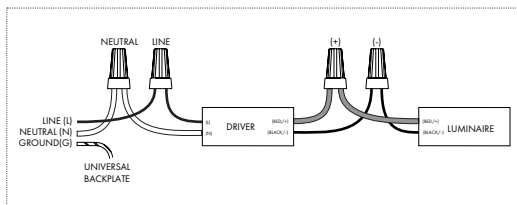

REFER TO PAGE 3: DRIVER OPTIONS FOR MORE DETAILS

## STEP 2

Measure and set depth screws and nuts on universal backplate so that the mud-in plate will sit flush with surrounding drywall.

Pull jump wire through corresponding opening and fasten mud-in plate using (4) 30mm screws.

Ensure screws and plate are all flush with surrounding wall.

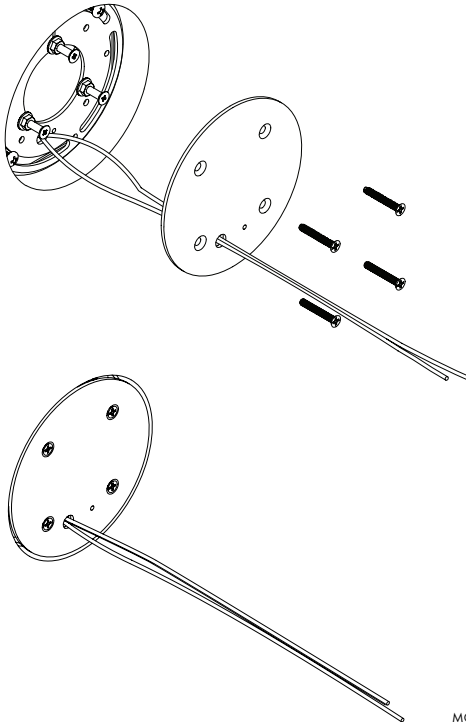
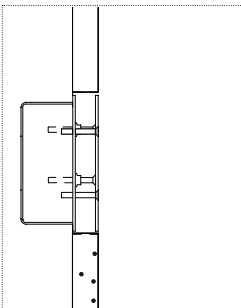
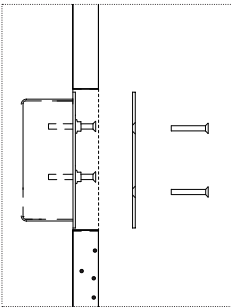

### STEP 3

This step requires a drywall and painting professional.

Place mesh mud tape over plate, bridging any opening while masking the wire way and screw hole. Mud, sand and paint until the area matches surrounding surfaces.

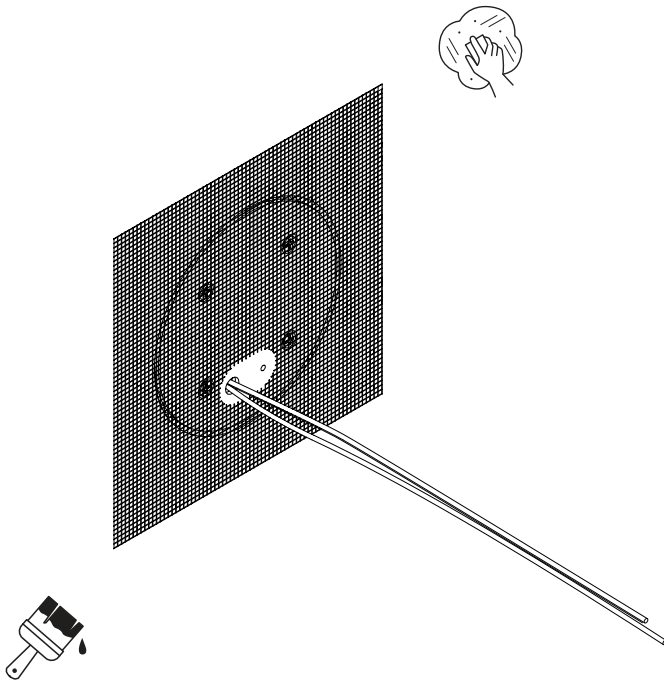

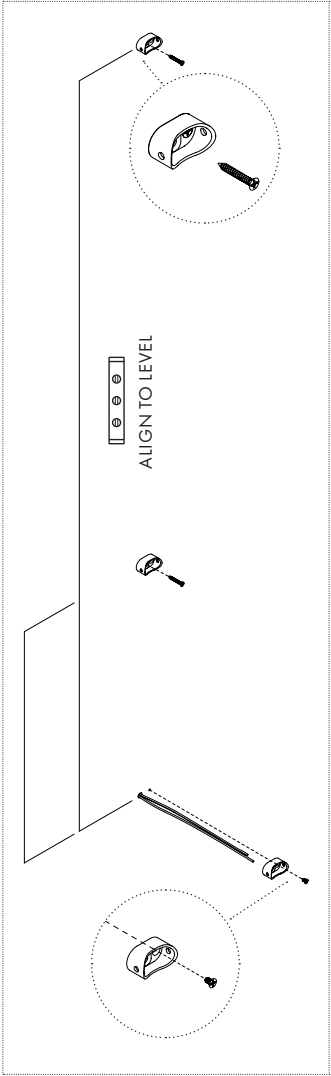

**PIPELINE 125**

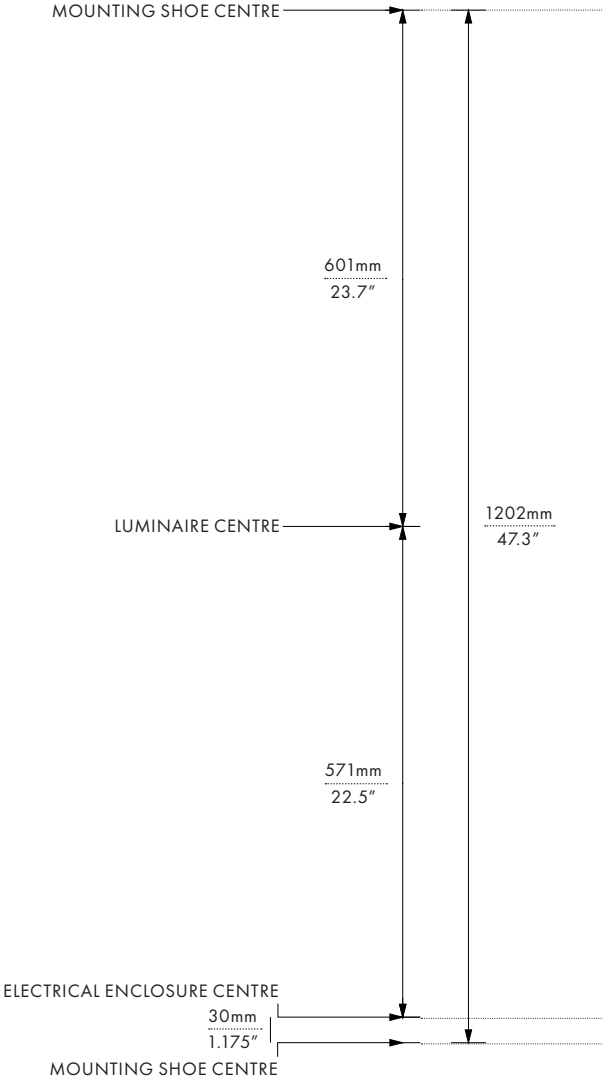



#### STEP 4

Feed the jump wire through the shoe and fasten to the mud-in plate using the 5mm screw.

Using the #6 surface mounting screw, measure and fasten the next Pipeline shoe referring to the corresponding measurements for your model.

\*Mounting shoe centre is offset 30mm / 1.175" from electrical enclosure centre.\*

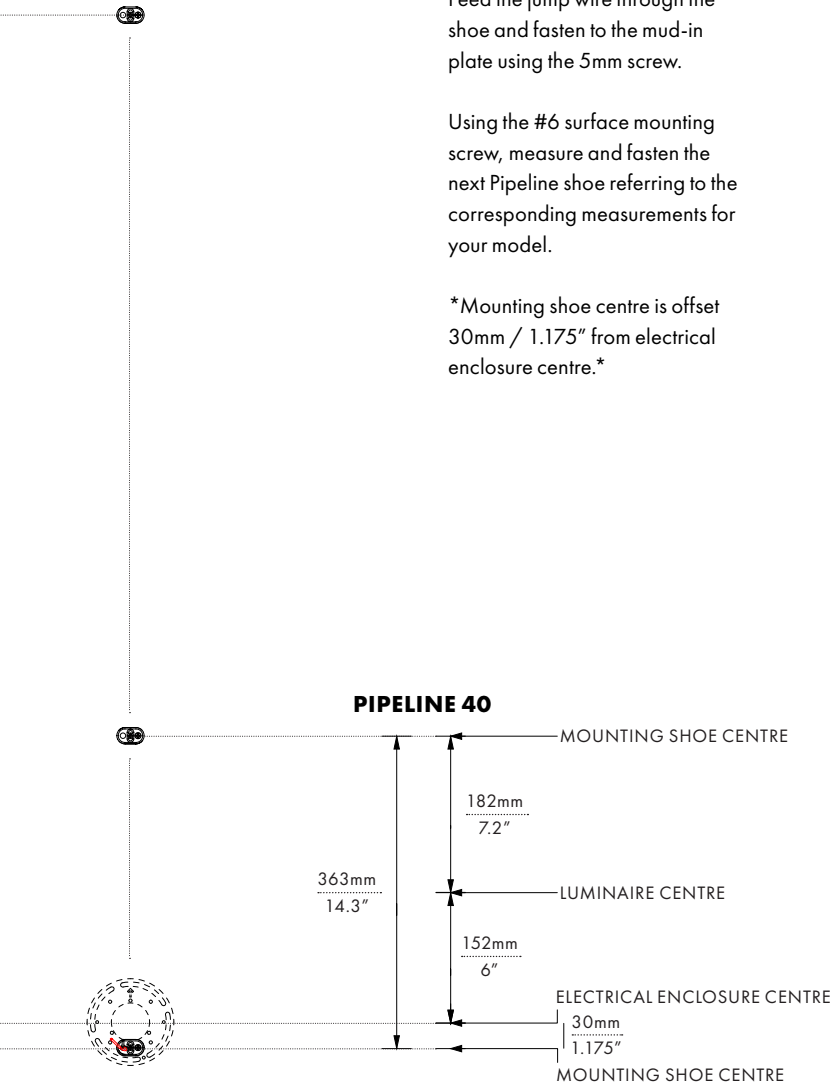

## STEP 5

Feed the jump wire through the Pipeline foot and out the bottom of the open end of the Pipeline body. Insert the Pipeline feet into the Pipeline shoes while guiding the jump wire.

Connect jump wires to wire connectors from the luminaire and replace into the body.

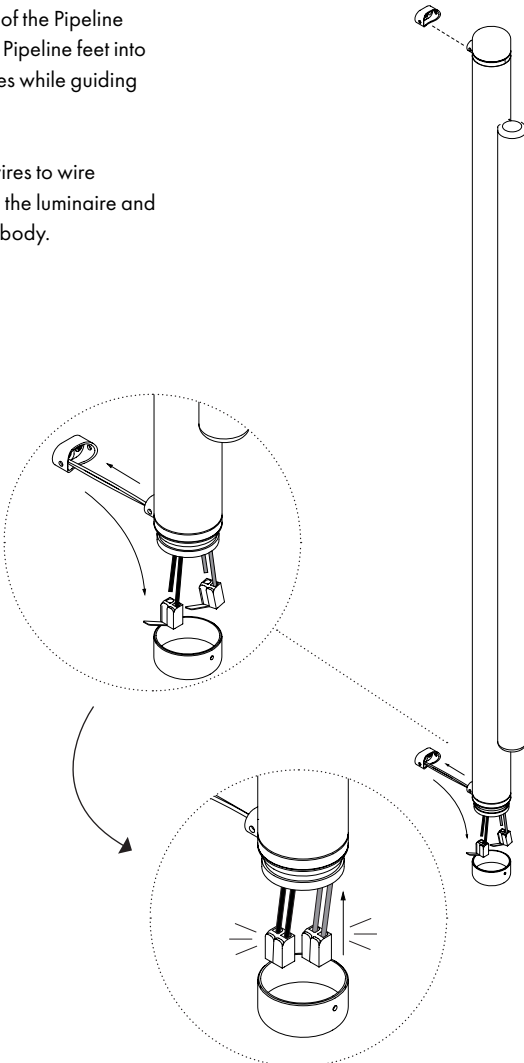

## STEP 6

Fasten the feet into the shoes using provided hex key and set screws.

Place the endcap onto the luminaire and secure with set screw.

Once secure turn endcap so screw is facing towards the wall.

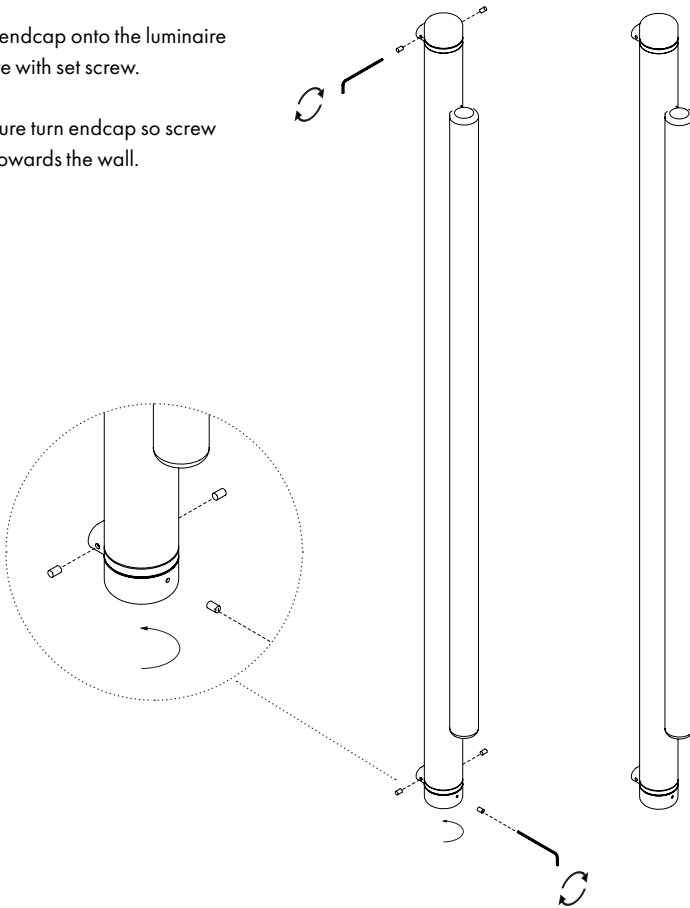

# COMPONENTS — OPTION 3

TRIMLESS (SURFACE MOUNT) \*REMOTE DRIVER ONLY\*

- 1

MOUNTING SHOE (2)
- 2

#6 SURFACE MOUNTING SCREW (2)
- 3

SET SCREW (4)
- 4

HEX KEY
- 5

MOUNTING FOOT (2)
- 6

LUMINAIRE BODY
- 7

ACRYLIC DIFFUSER
- 8

ENDCAP (2)
- 9

DRIVER (REMOTE)

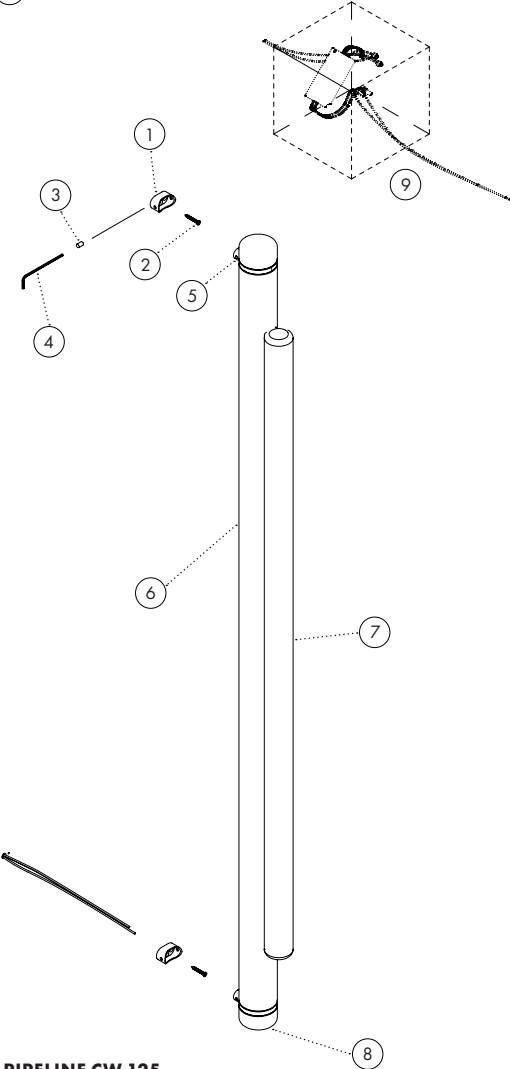
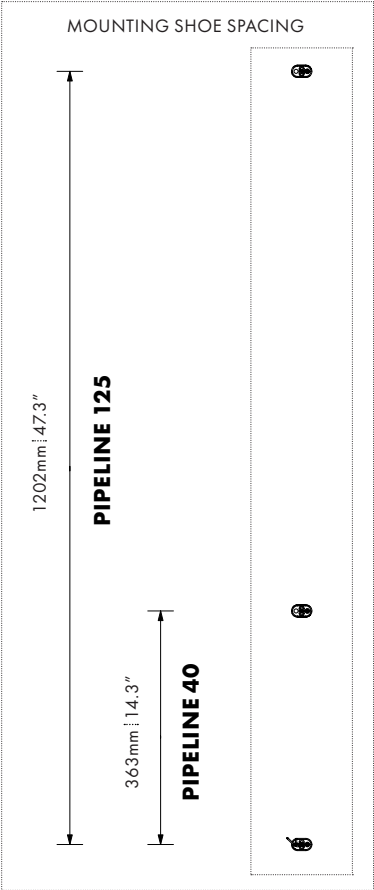

# INSTALLATION — OPTION 3



## TRIMLESS (SURFACE MOUNT) \*REMOTE DRIVER ONLY\*

For the Trimless Surface Mount option, the luminaire mounts directly onto the surface.

### STEP 1

Turn off breaker.

Following driver **PAGE 3** and wiring diagram, connect mains to remote driver, and run low voltage wire to wall opening.

Wires should protrude a minimum length of 150mm / 6".

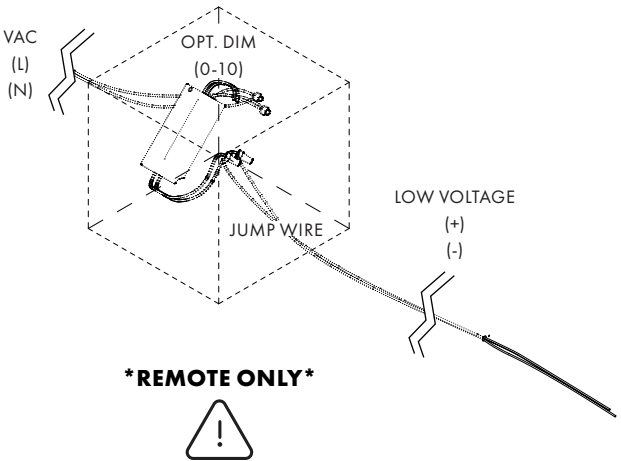
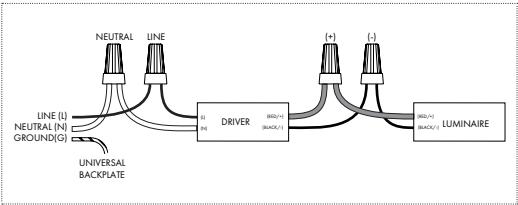

**\*REMOTE ONLY\***

REFER TO PAGE 3: DRIVER OPTIONS FOR MORE DETAILS

## STEP 2

Measure, mark and drill a pilot hole for the mounting screw. Insert surface anchors if necessary (not provided).

Feed the jump wire through the shoe and fasten to the surface using the #6 screw.

Measure and fasten the next Pipeline shoe referring to the corresponding measurements for your model.

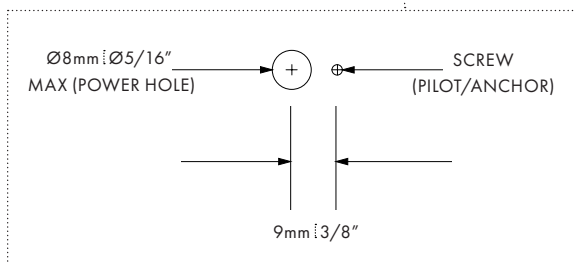
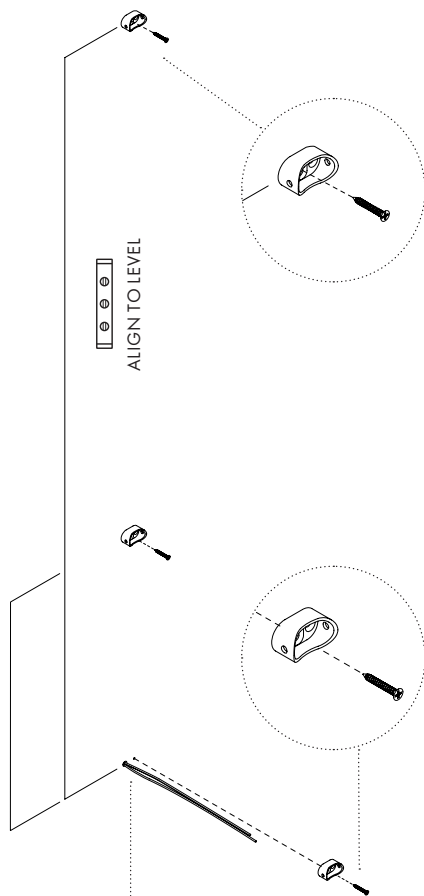

### STEP 3

Feed the jump wire through the Pipeline foot and out the bottom of the open end of the Pipeline body. Insert the Pipeline feet into the Pipeline shoes while guiding the jump wire.

Connect jump wires to wire connectors from the luminaire and replace into the body.

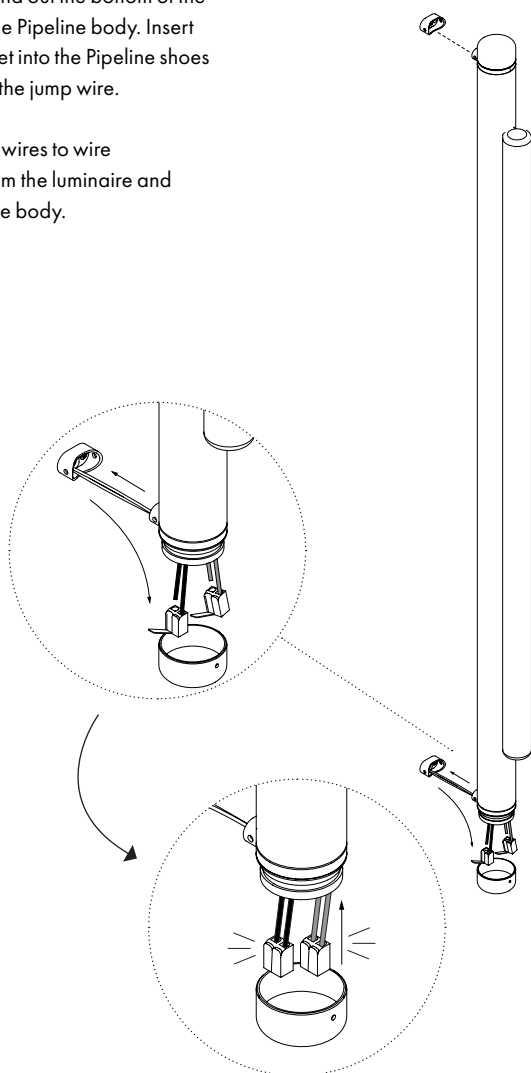

#### STEP 4

Fasten the feet into the shoes using provided hex key and set screws.

Place the endcap onto the luminaire and secure with set screw. Once secure turn endcap so screw is facing towards the wall.

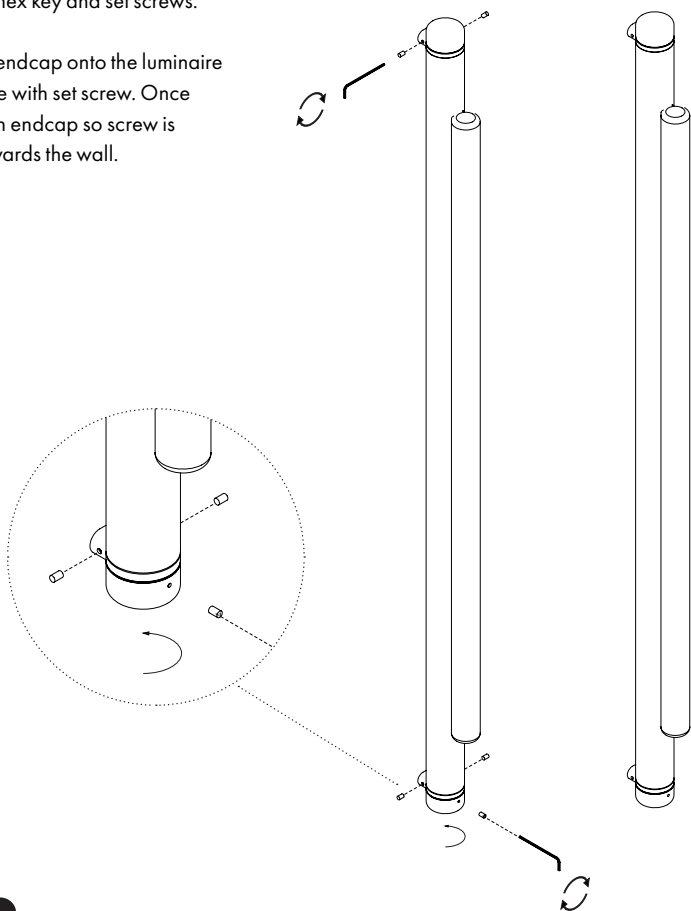

For support, please contact:  
[info@n-d.com](mailto:info@n-d.com)  
+1 604 563 6938

#### A-N-D

1951 Franklin St,  
Vancouver, BC  
Canada V5L 0C7