



LOBE SERIES PENDANT

DESIGNER
LUKAS PEET

INSTRUCTIONS



SCAN HERE

NORTH AMERICA

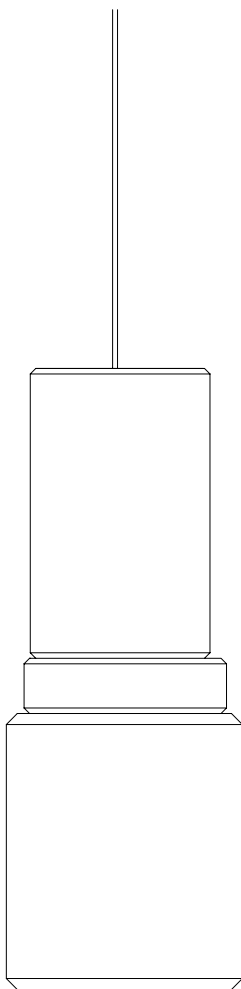

a-n-d.com

INSTALLATION NOTES

The luminaire is powered by a 300mA constant current LED driver. The LED driver varies depending on input voltage and dimming requirements.

For questions regarding installation, please email **info@a-n-d.com**



CARE INSTRUCTIONS

Always wear clean gloves when handling the luminaire. Clean painted surfaces with a soft, lint-free cloth. Clean acrylic diffuser with a soft lint-free cloth or an unscented magic eraser pad.

For replacement parts, contact A-N-D directly.



WARNING

The luminaire must be installed by a qualified electrician in a dry indoor location.

Failure to meet any or all of these criteria will not only damage the luminaire, but will void both the warranty and all of its certifications.

COMPONENTS



- ① LED DRIVER
- ② TERMINAL (4)
- ③ UNIVERSAL BACKPLATE
- ④ #8-32 SCREW (2)
- ⑤ COAXIAL CABLE
- ⑥ CANOPY SCREW (3)
- ⑦ CANOPY
- ⑧ STRAIN RELIEF PLASTIC SET SCREW
- ⑨ LUMINARE BODY

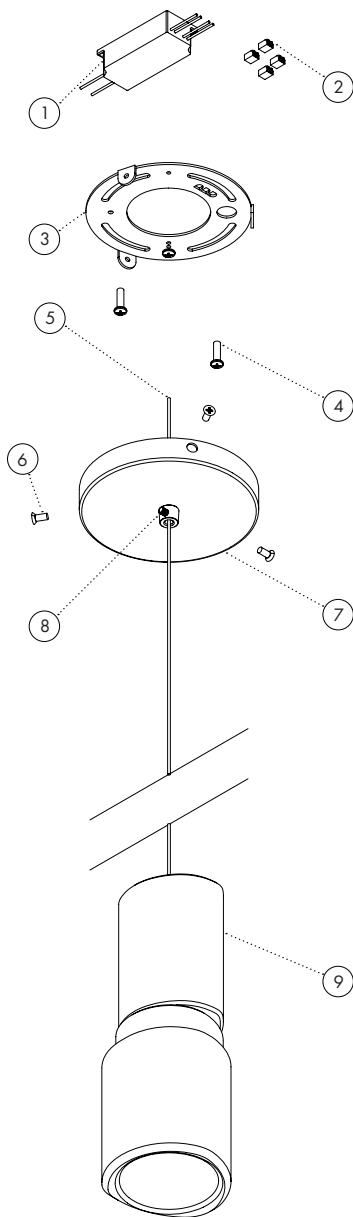

LED DRIVER OPTIONS

The Lobe Pendant LED driver varies depending on dimming requirements and input voltage.

Use the ordering code to determine the selected driver:

ie. LOB-P-PR-27-UNV-120/277

-----INPUT VOLTAGE



This is a universal dimming power supply.
It can be controlled either via 0-10 dimming **OR**
Phase Cut on primary.

ESS015 SERIES - ERP

INPUT: 120-277VAC

OUTPUT: 300mA, 12.6W

L x W x H: 85 x 31 x 31

DIMMING OPTIONS

- ① PHASE CUT (PC)
- ② 0-10

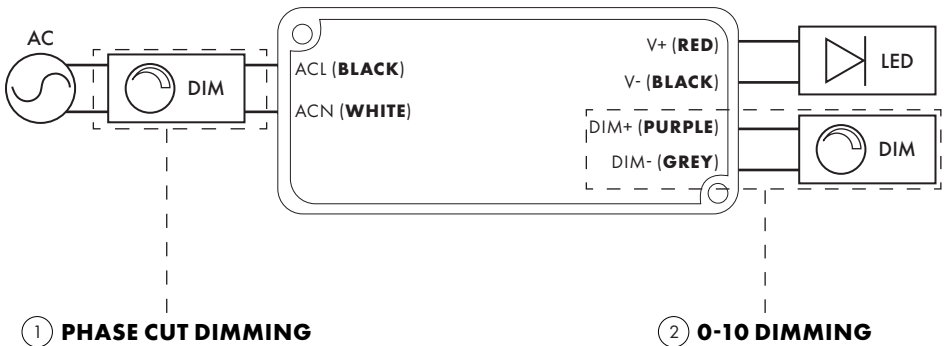

PREPARATION

STEP 1

Connect the input power to the primary circuit on the LED driver with the provided connectors

Connect the ground wire to back plate.

Black/brown wire = **Line** (L)

White/blue wire = **Neutral** (N)

Green screw = **Ground** (G)

⚠ Caution!

Ensure that the power is disconnected at the breaker.

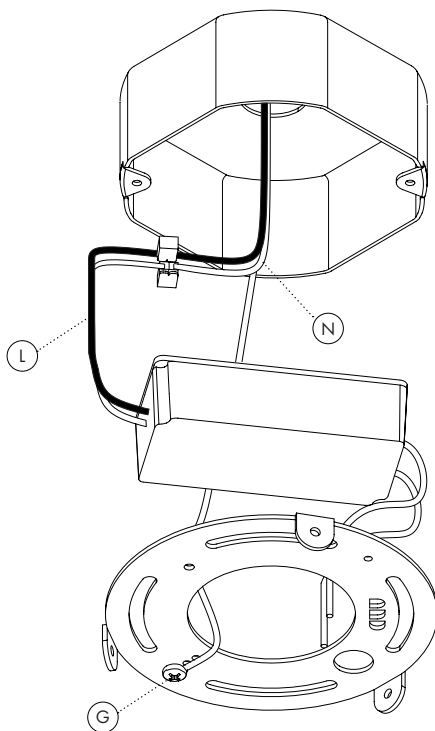

STEP 2

Place the LED driver inside a standard depth junction box or in a secure remote location and mount the backplate.

Use the provided #8-32 screws.

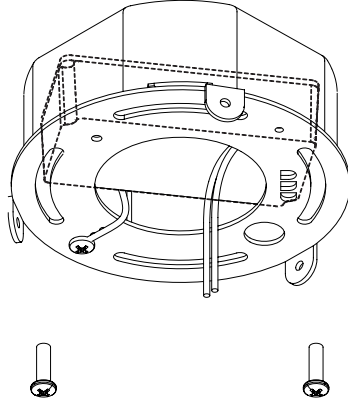

INSTALLATION

STEP 3

i) Determine the drop height of the fixture and trim excess cable.

Coaxial cable length:

Leave an extra 15cm/ 6" for final height adjustments.

ii) Secure the coaxial cable cord in position.

Turn the screw on the strain relief until it grips the coaxial cable.

EXTRA
15cm
6"

i
DROP
HEIGHT
244cm
96"

22.5cm
8.85"

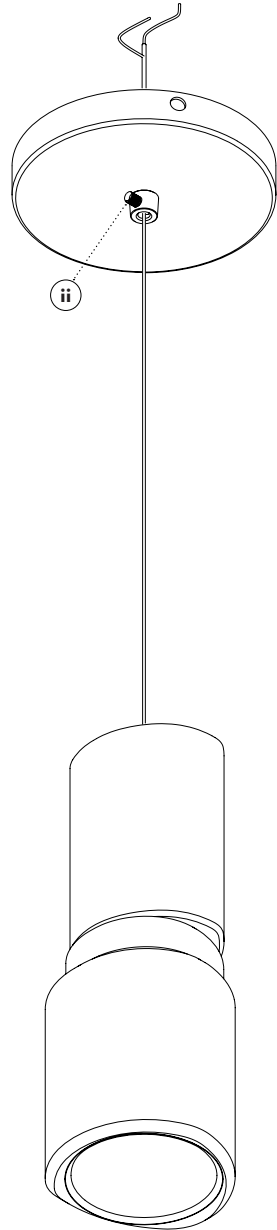

STEP 4

Connect the luminaire to the secondary circuit on the LED driver with provided connectors.

Braided wire = **Positive** (V+)

Black wire = **Negative** (V-)

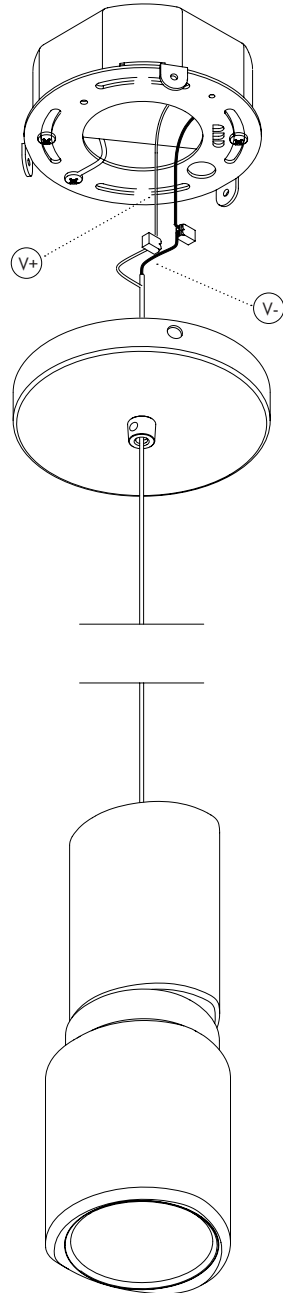
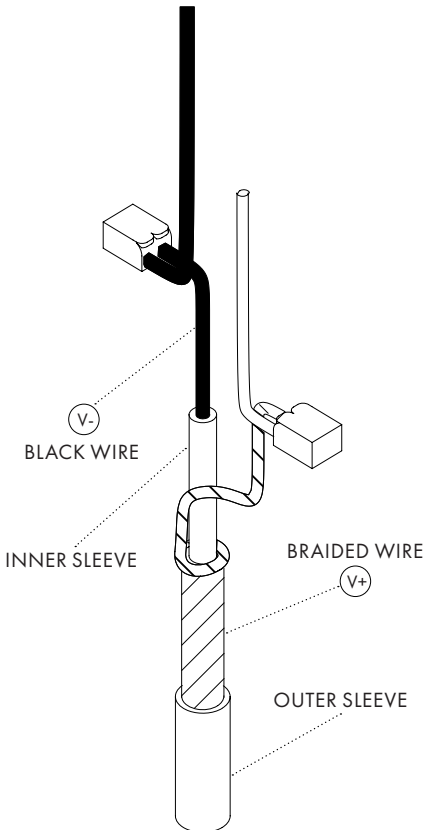

INSTALLATION

STEP 5

Attach the canopy to the backplate.

Use the provided colour matched canopy screws.

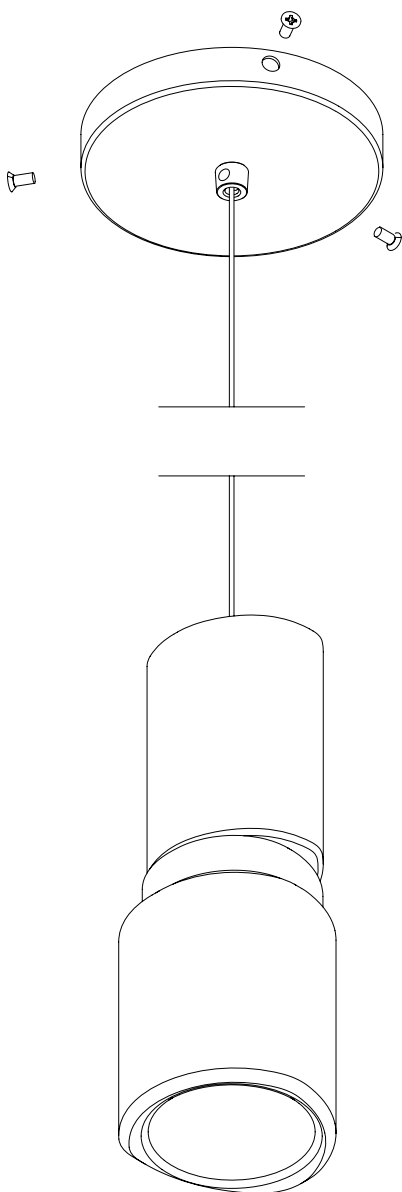

STEP 6

If necessary, adjust the fixture.

Due to its asymmetrical nature, Lobe Pendant might hang unbalanced.

Hold the top part and turn anti-clockwise the lower part until balance is achieved.

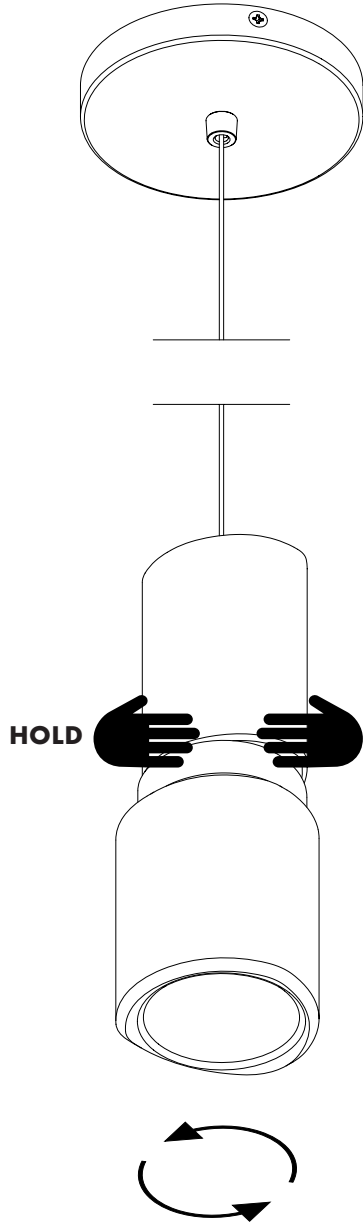
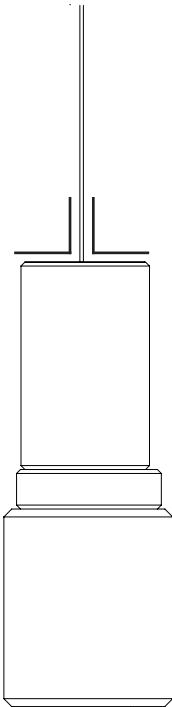



For support, please contact:

info@a-n-d.com

+1 604 563 6938

A-N-D

1951 Franklin St,
Vancouver, BC
Canada V5L 0C7

a-n-d.com