



---

# COLUMN SERIES

## VERTICAL – PENDANT

---

DESIGNER  
**LUKAS PEET**

INSTRUCTIONS



SCAN HERE

**NORTH AMERICA**

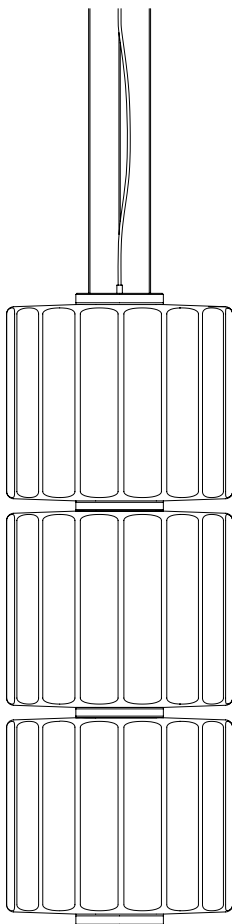

**a-n-d.com**

# INSTALLATION NOTES

---

The luminaire is powered by 24V DC. A constant voltage LED driver is required to operate the luminaire. The LED driver varies, depending on input voltage and dimming requirements.

A minimum of two people are required to install the Column Pendant.

For questions regarding installation, please email **info@[n-d.com](mailto:info@n-d.com)**



---

## CARE INSTRUCTIONS

Always wear clean gloves when handling the luminaire. Clean finished surfaces with a soft, lint-free cloth. Clean acrylic diffuser with a soft lint-free cloth and a diluted solution of dish soap in warm water.

For replacement parts contact A-N-D directly.



---

## WARNING

The luminaire must be installed by a qualified electrician in a dry indoor location.

Failure to meet any or all of these criteria will not only damage the luminaire, but will void both the warranty and all of its certifications.

# COMPONENTS



- ① BACKPLATE
- ② #8-32 SCREW (2)
- ③ #8 SCREW (3)
- ④ LED DRIVER
- ⑤ TERMINAL (4)
- ⑥ CANOPY SCREW (3)
- ⑦ CANOPY
- ⑧ STRAIN RELIEF PLASTIC SET SCREW
- ⑨ STRAIN RELIEF
- ⑩ ELECTRICAL CORD
- ⑪ AIRCRAFT CABLE (3)
- ⑫ SUSPENSION CAP
- ⑬ GLASS (1-6)
- ⑭ COLLAR RING (1-5)
- ⑮ LED MODULE (2-6)
- ⑯ ENDCAP

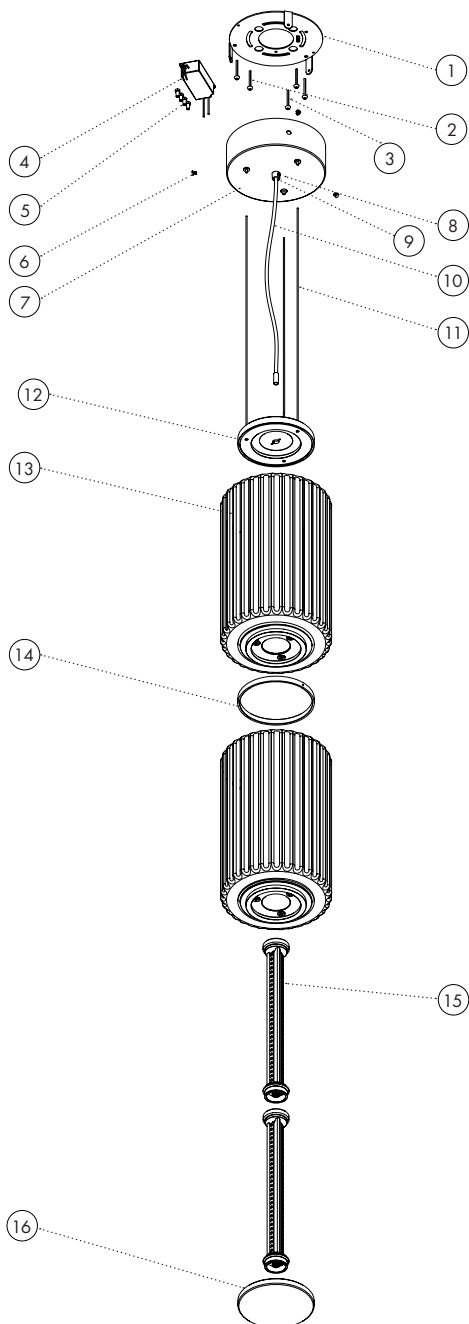

# COLUMN 175 VERTICAL OPTIONS

## WEIGHTS

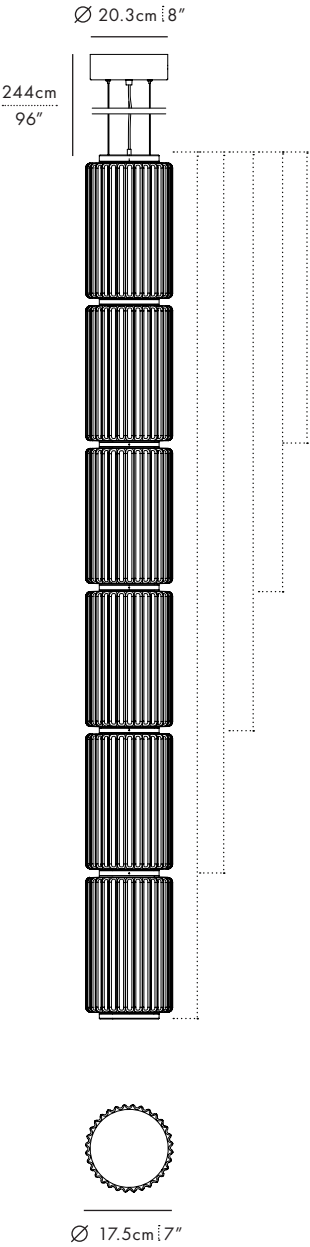

**VERTICAL 2**  
LENGTH: 59cm / 23.2"  
WEIGHT: 12.5lbs / 5.7 kg

**VERTICAL 3**  
LENGTH: 87cm / 34.25"  
WEIGHT: 17.1 lbs / 7.8 kg

**VERTICAL 4**  
LENGTH: 115cm / 45.27"  
WEIGHT: 21.7 lbs / 9.9 kg

**VERTICAL 5**  
LENGTH: 143cm / 53.3"  
WEIGHT: 26.3 lbs / 12 kg

**VERTICAL 6**  
LENGTH: 172cm / 67.7"  
WEIGHT: 30.9 lbs / 14.1 kg

# COLUMN 300 VERTICAL OPTIONS



## WEIGHTS

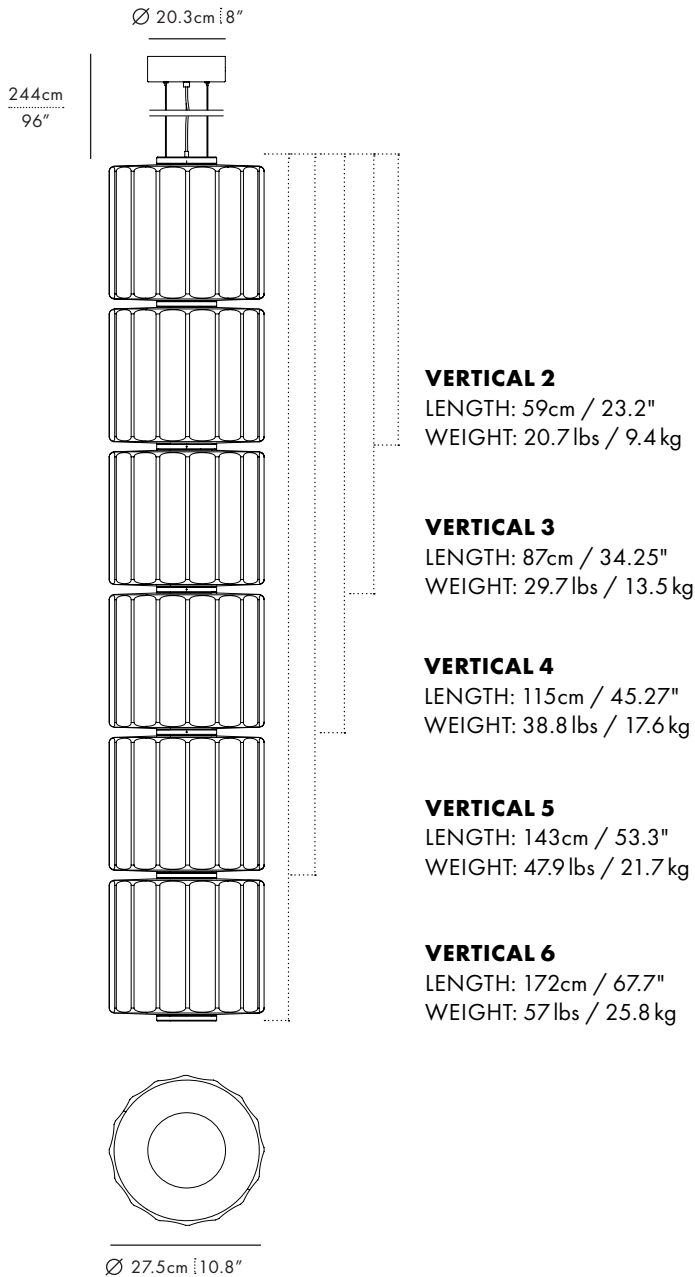

# LED DRIVER OPTIONS

The Column Pendant LED driver varies depending on dimming requirements and input voltage.

Use the ordering code to determine the driver selected:

ie. COL-175-1-P-V-CBN-27-010-277

DIMMING ----- INPUT VOLTAGE

## PHASE CUT DIMMING (PC)

M28 SERIES - ES POWER

**INPUT:** 120VAC

**OUTPUT:** 24VDC, 24W

**L x W x H:** 89 x 42 x 31

M40 SERIES - ES POWER

**INPUT:** 120VAC

**OUTPUT:** 24VDC, 75W

**L x W x H:** 140 x 49 x 32



## 0-10 + PWM DIMMING (010)

Q22-P SERIES - ES POWER

**INPUT:** 110-277VAC

**OUTPUT:** 24VDC, 60W

**L x W x H:** 111 x 44 x 32

Q22-P SERIES - ES POWER

**INPUT:** 110-277VAC

**OUTPUT:** 24VDC, 90W

**L x W x H:** 111 x 44 x 32

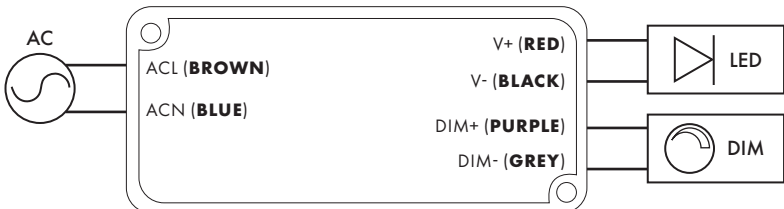

# PREPARATION



## STEP 1

**Remove the wrapped LED module from each glass box and set aside.**

The separate box contains all the required hardware for assembly.

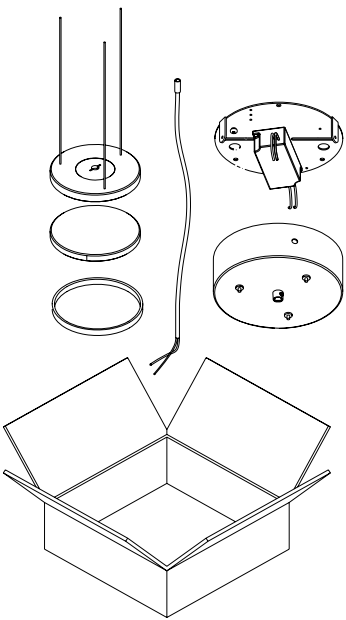
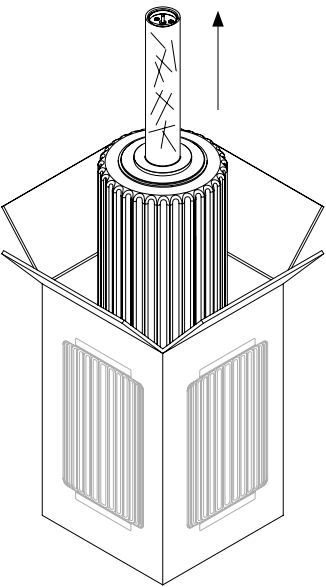

# INSTALLATION

## STEP 2

### Mount the backplate to the ceiling.

Use the provided two #8-32 screws to connect the backplate on the junction box.

Use the provided three #8 screws to secure the backplate on the ceiling.

**Correct weight anchors are provided by installer.**

#### **Caution!**

Ensure that the power is disconnected at the breaker.

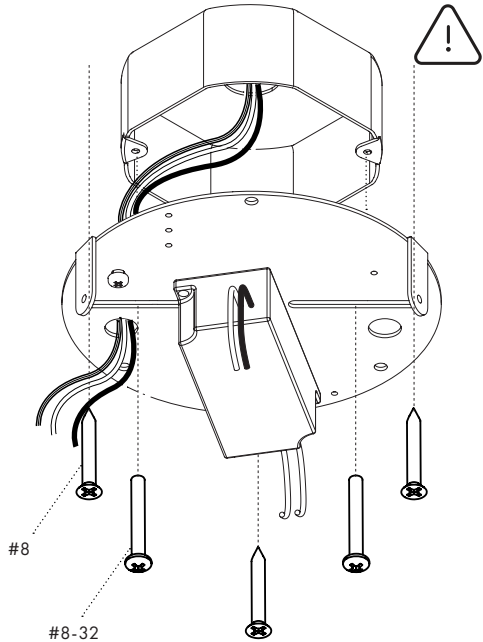

REFER TO PAGE 4, 5: FIXTURE WEIGHT FOR MORE DETAILS

## STEP 3

### Connect the primary circuit on the LED driver to input power. Connect ground.

Black/brown wire = **Line** (L)

White/blue wire = **Neutral** (N)

Green screw = **Ground** (G)

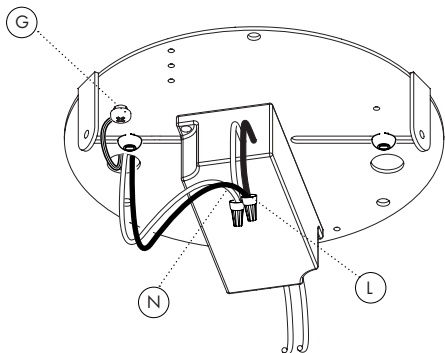

REFER TO PAGE 6: DRIVER OPTIONS FOR MORE DETAILS



## STEP 4

**Feed the aircraft cables (3) and the electrical cord through the canopy.**

### **Attention!**

Do not cut any cable/power cord at this step.

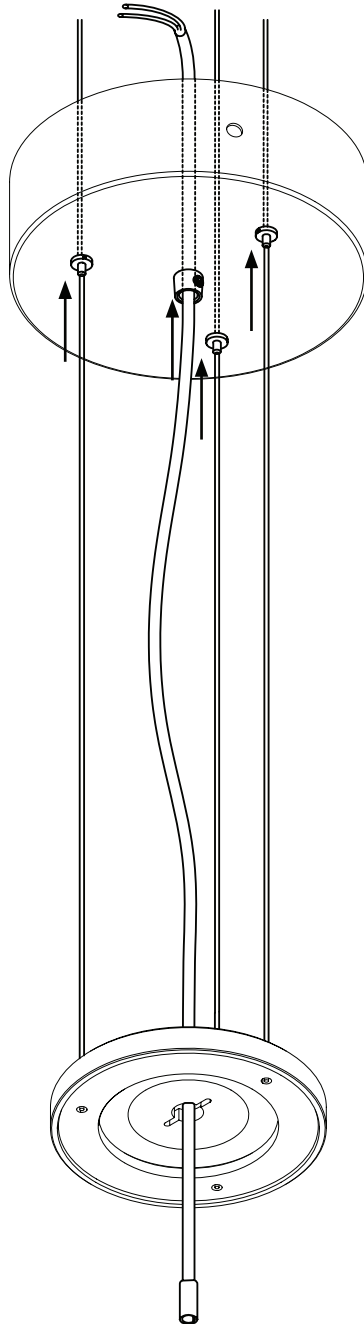

# INSTALLATION

## STEP 5

**Determine the drop height and trim the excess electrical cord and aircraft cable.**

Refer to **PAGE 4 & 5** for the light fixture total height.

**⚠ Attention!**

Leave an extra 15cm / 6" of aircraft cables and powercord inside the canopy.

Leave an extra 15cm / 6" powercord below the suspension cap.

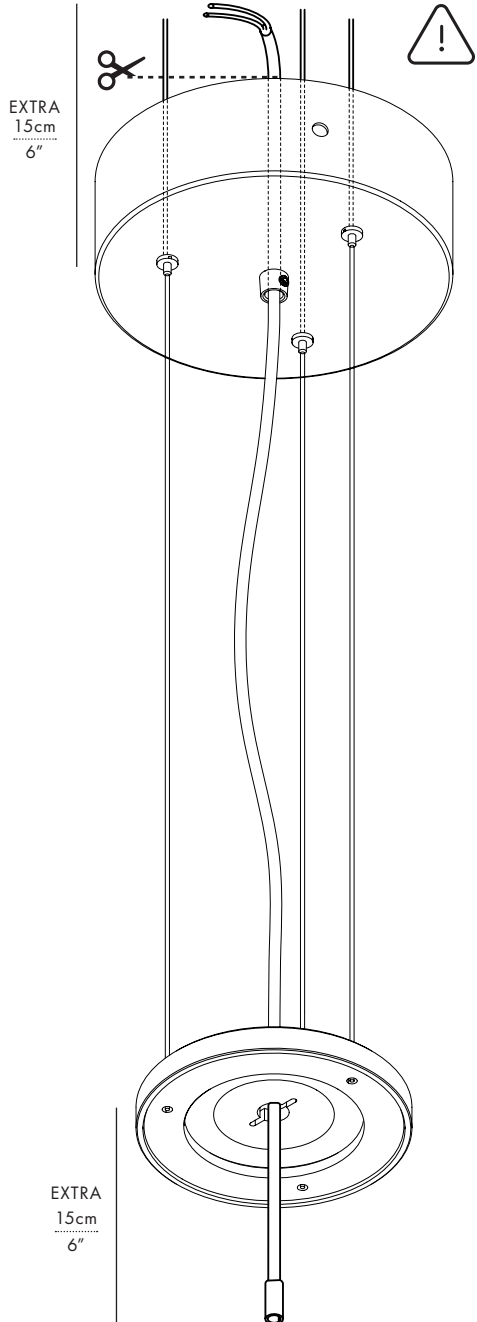

## STEP 6

**Connect the luminaire to secondary circuit on LED driver.**

Dashed line/red = **Positive** (V+)

Black = **Negative** (V-)

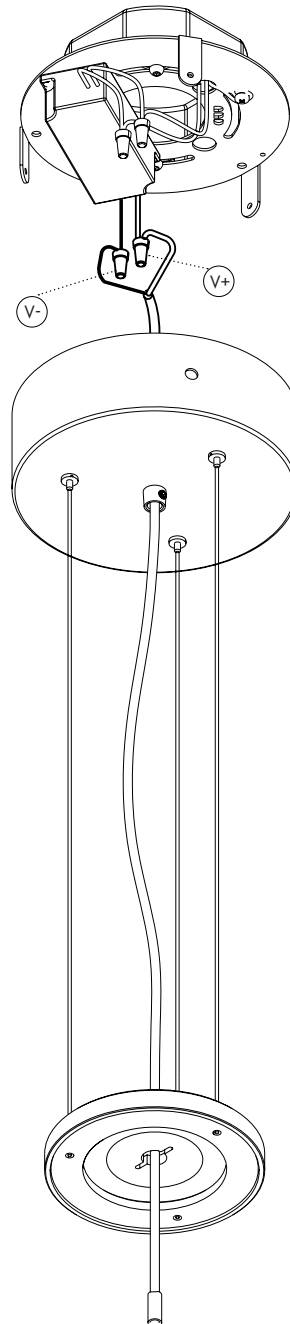

# INSTALLATION

---

## STEP 7

Using the provided canopy screws (3), attach the canopy to the backplate.

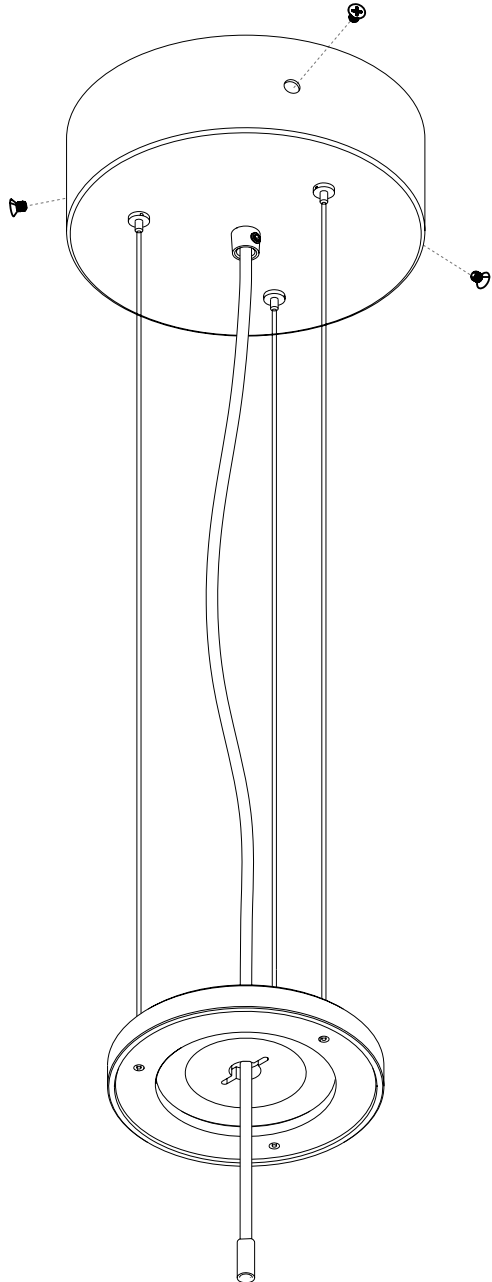

## STEP 8

**Ensure the suspension cap is levelled.**

While pushing the cable gripper, pull/feed the aircraft cables one at a time.

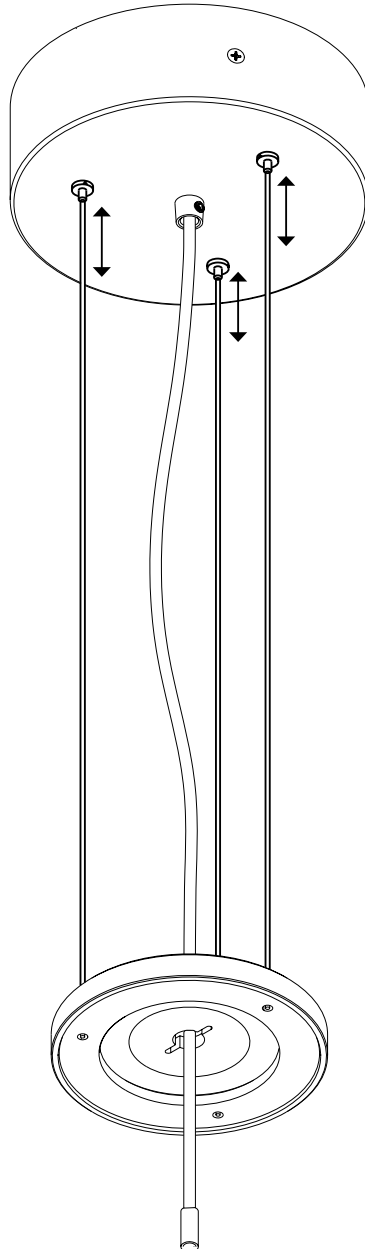
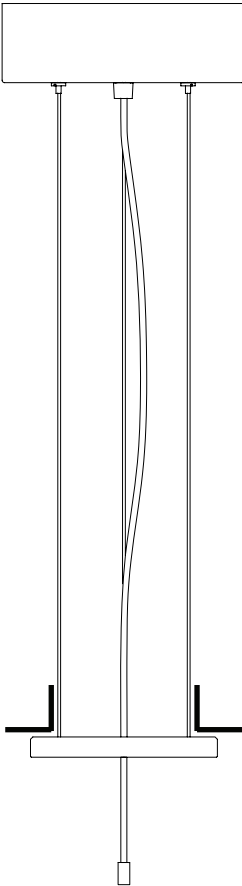

# INSTALLATION

## STEP 9

**Thread the glass onto the suspension cap by turning clockwise.**

### **Attention!**

Remove rings/jewelry from fingers to prevent breakage during this step.

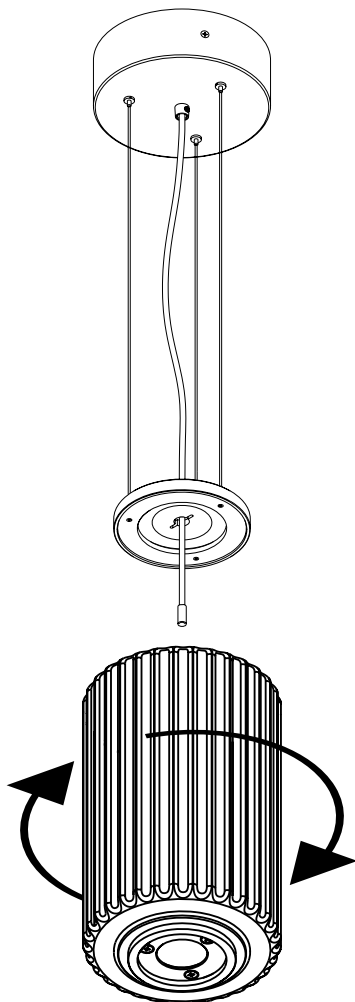

\* COLUMN 175 VERTICAL 2  
MODEL SHOWN

## STEP 10

**Place the collar centered to the bottom glass.**

**While your partner holds the top glass, tighten the bottom section.**

**Repeat for all glass needed.**

### **Caution!**

Ensure the collar is centered while tightening the glass: do not overtighten glass to avoid cracking.

### **Attention!**

Remove rings/jewelry from fingers to prevent breakage during this step.

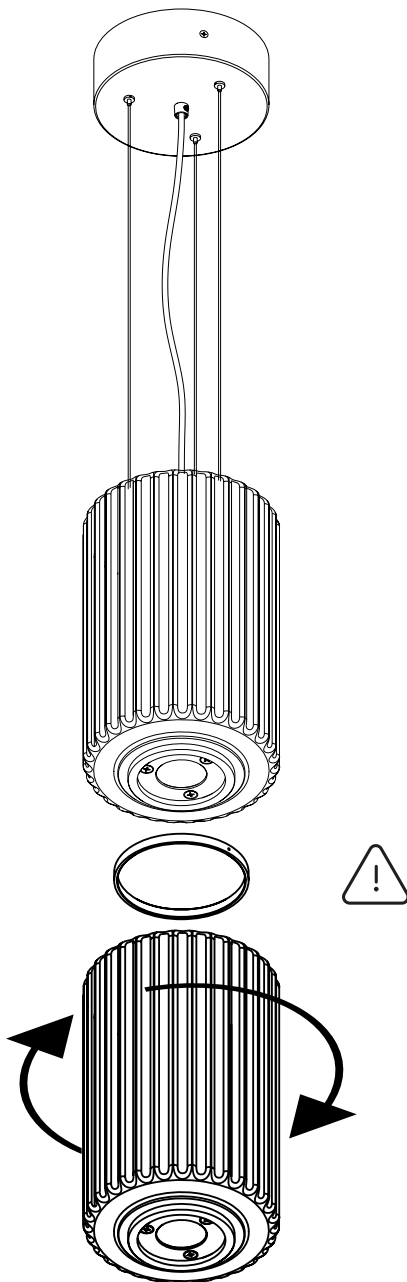

\* COLUMN 175 VERTICAL 2  
MODEL SHOWN

# INSTALLATION

## STEP 11

### Slide the first LED module from the bottom glass

Ensure the side with the DC JACK is facing up in the fixture.

#### ⚠ Caution!

Do not drop the LED module. Always hold the LED module with one hand.

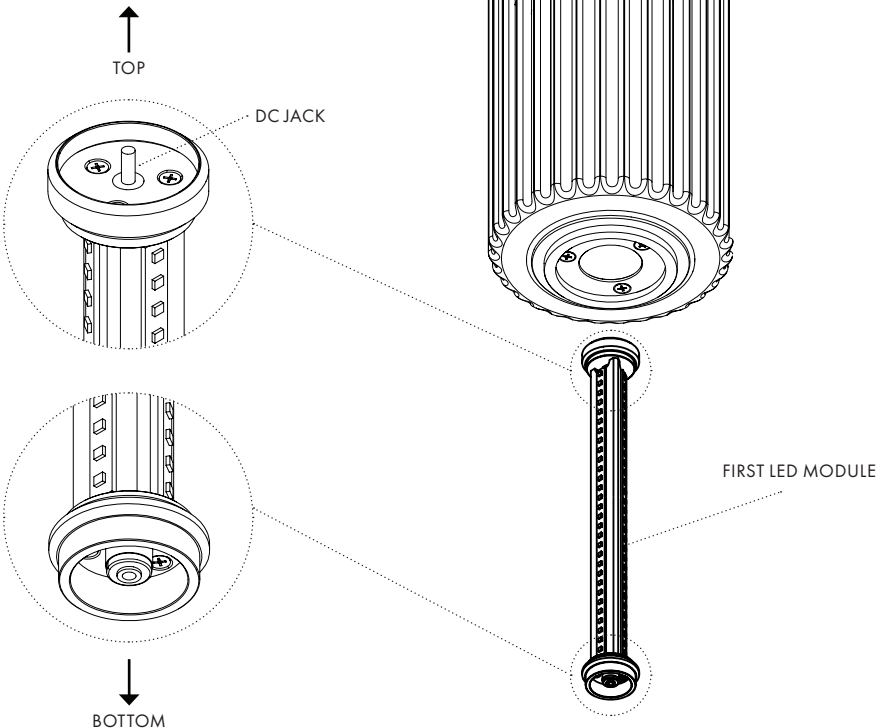

\* COLUMN 175 VERTICAL 2  
MODEL SHOWN



## STEP 12

### Thread the second LED module on the first one.

Repeat this step for all the LED modules required.

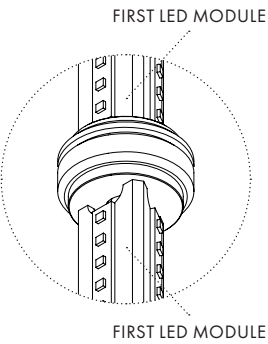
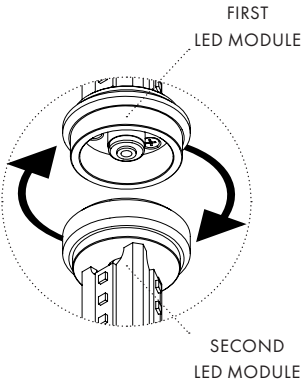

**\* COLUMN 175 VERTICAL 2  
MODEL SHOWN**

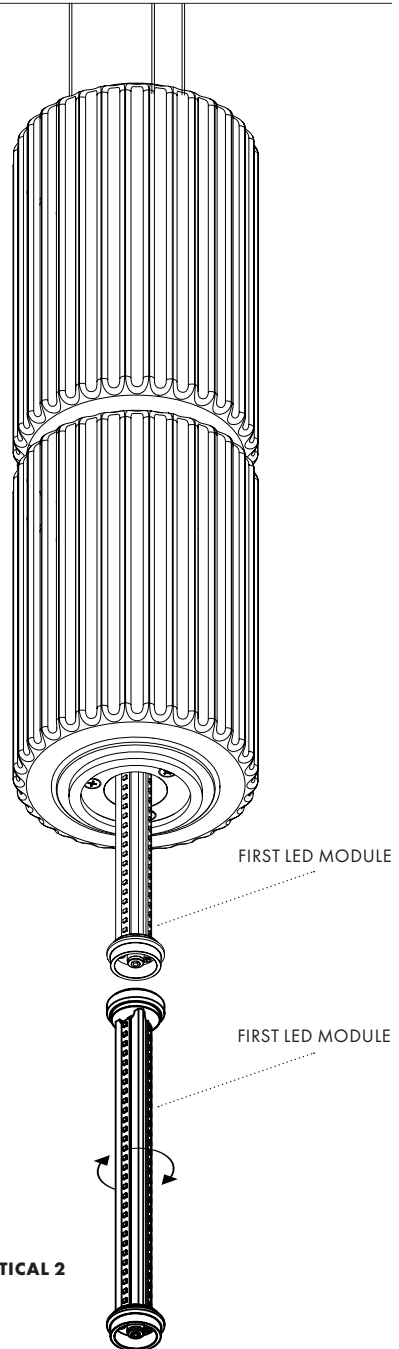

# INSTALLATION

## STEP 13

**Thread the endcap on the bottom glass.**

### **Attention!**

Do not drop the LED module while threading on the endcap.

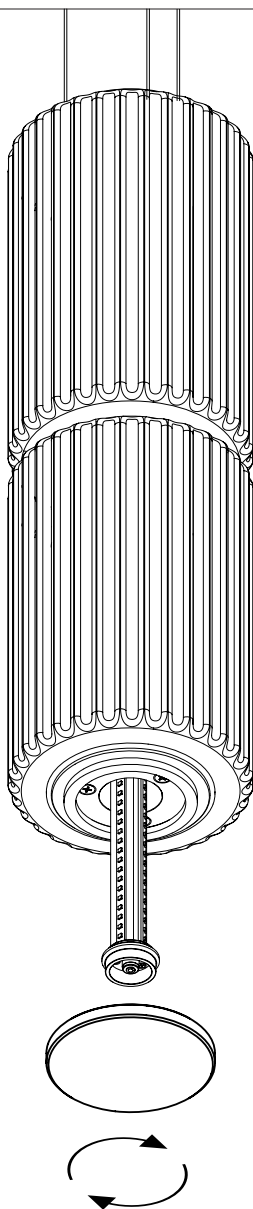

**\* COLUMN 175 VERTICAL 2  
MODEL SHOWN**

## STEP 14

**i) Connect the electrical cord to the light fixture and adjust the swag.**

The powercord should have some slack as pictured here.

**ii) Tighten the plastic strain relief to secure the power cord.**

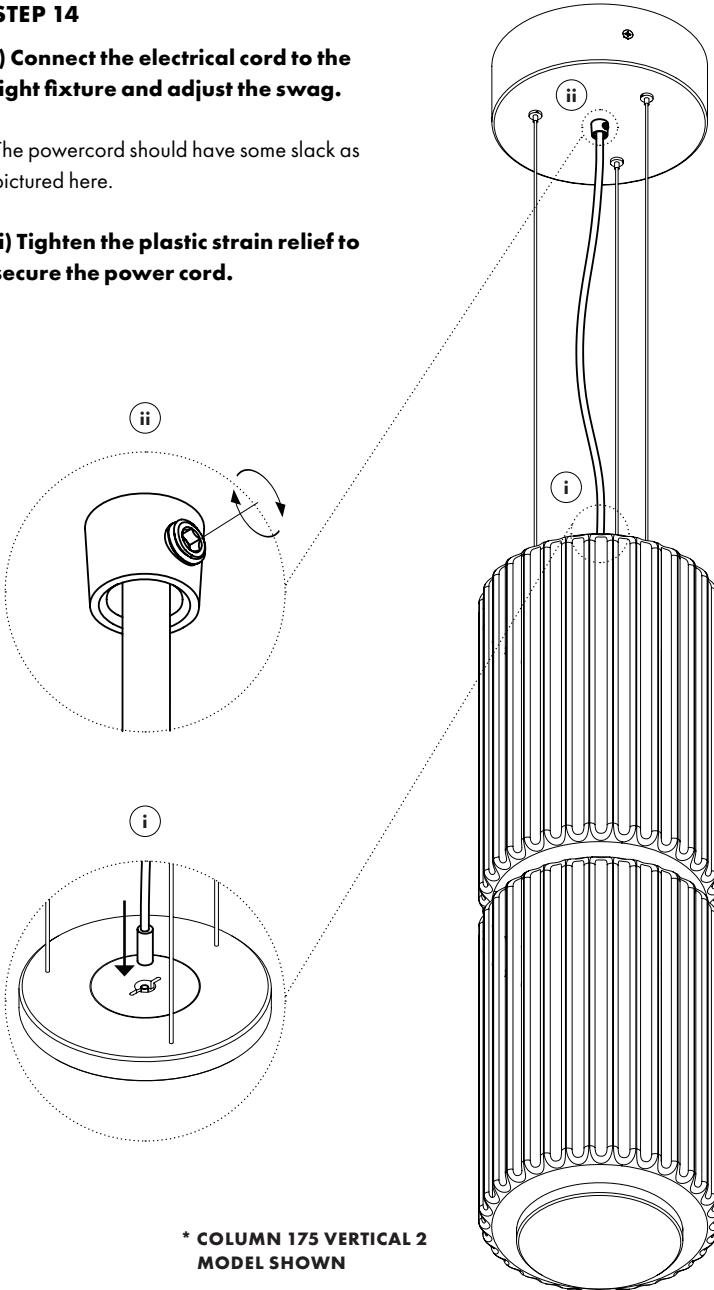

**\* COLUMN 175 VERTICAL 2  
MODEL SHOWN**



---

For support, please contact:

[info@a-n-d.com](mailto:info@a-n-d.com)

+1 604 563 6938

---

**A-N-D**

1951 Franklin St,  
Vancouver, BC  
Canada V5L 0C7

**[a-n-d.com](http://a-n-d.com)**