



IRIS SERIES

CEILING/WALL

DESIGNER
CAINE HEINTZMAN

INSTRUCTIONS



SCAN HERE

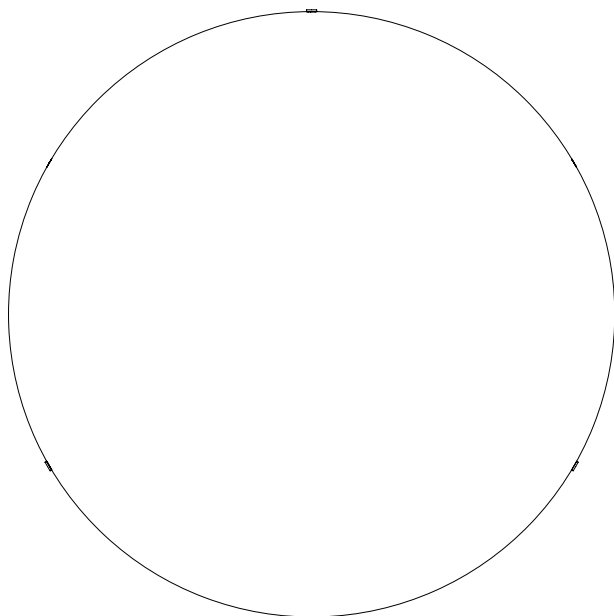

NORTH AMERICA



a-n-d.com

INSTALLATION NOTES

A low voltage Class 2 constant current LED driver is required to operate the luminaire.

It is recommended that two people install the Iris Ceiling/Wall; one to gently support the luminaire while the other makes the electrical and mechanical connections to the surface.

For questions regarding installation, please email **info@[n-d.com](mailto:info@n-d.com)**



CARE INSTRUCTIONS

Always wear clean gloves when handling the luminaire. Clean finished surfaces with a soft, lint-free cloth. Clean acrylic diffuser with a soft lint-free cloth and soap and water if necessary.

For replacement parts contact A-N-D directly. Never exceed the recommended wattage, as doing so may damage the luminaire or cause a fire.



WARNING

The luminaire must be installed by a qualified electrician in a dry indoor location.

Failure to meet any or all of these criteria will not only damage the luminaire, but will void both the warranty and all of its certifications.

Always ensure circuit breaker is off prior to making electrical connections.

LED DRIVER OPTIONS



The Iris CW LED driver varies depending on dimming requirements and input voltage.

Use the ordering code to determine the selected driver:

ie. IRI-90-CW-B-CLR-27-010-277

DIMMING --- INPUT VOLTAGE



DO NOT MODIFY DRIVER DIP SWITCH - IT COULD DAMAGE THE LUMINAIRE.

PHASE CUT DIMMING (PC)

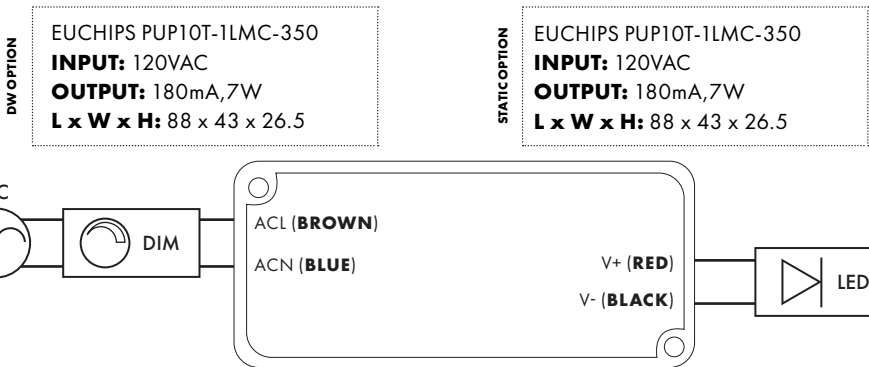

0-10 DIMMING (010)

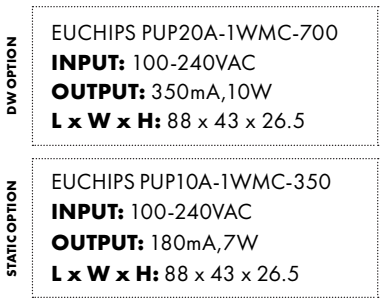

DALI DIMMING (DAL)

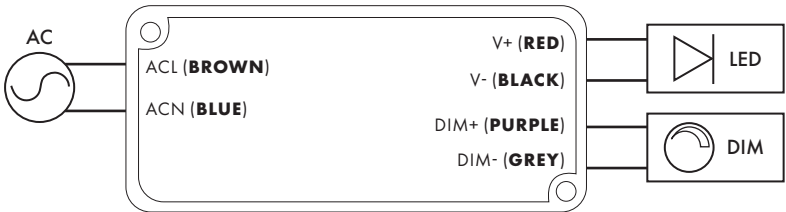
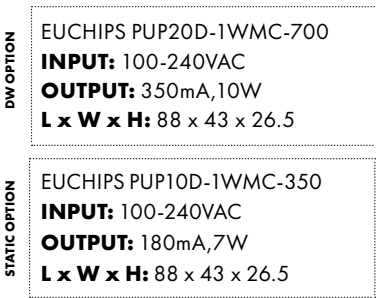

COMPONENTS

- ① TERMINAL (2)
- ② BACKPLATE ASSEMBLY
(LED, DIFFUSER, DRIVER,
BACKPLATE)
- ③ #8-32 BACKPLATE SCREW (2)
- ④ CANOPY
- ⑤ MOUNTING PUCK JIG
- ⑥ LENS SCREW (3)
- ⑦ LENS PUCK (3)
- ⑧ #6 SCREW (3)
- ⑨ LENS

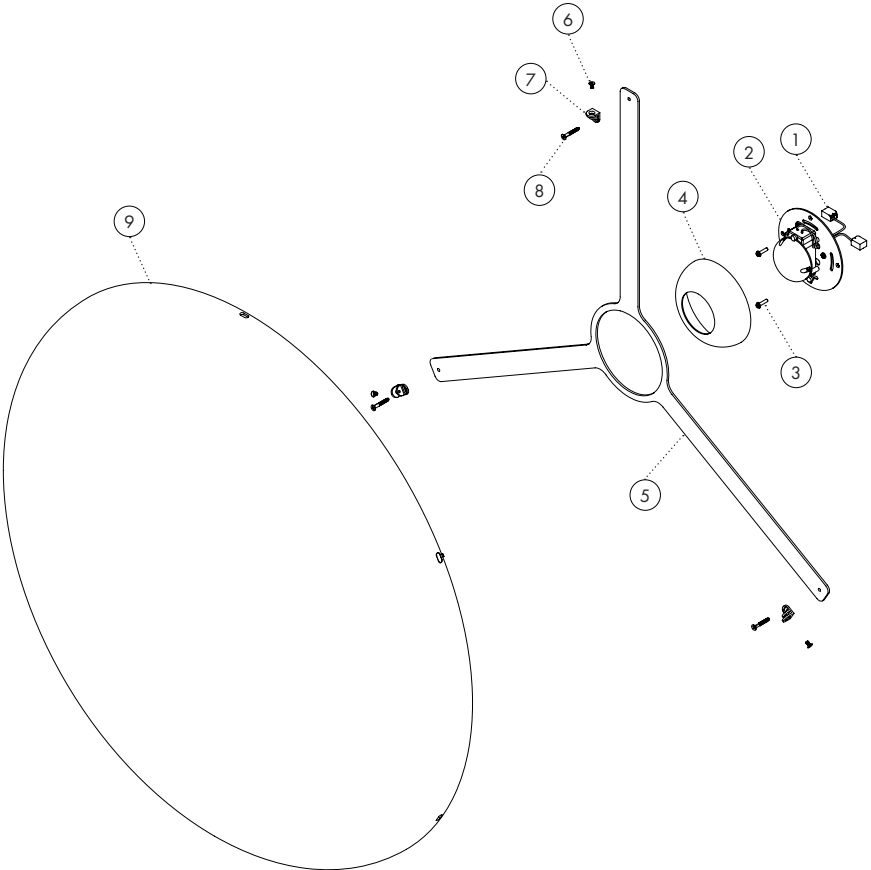

IRIS 90/60 DIMENSIONS



The Iris Ceiling/Wall can be installed on a ceiling or wall.

IRIS 90 30cm [11.8"
IRIS 60 20cm [7.9"

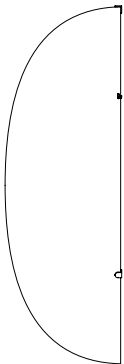
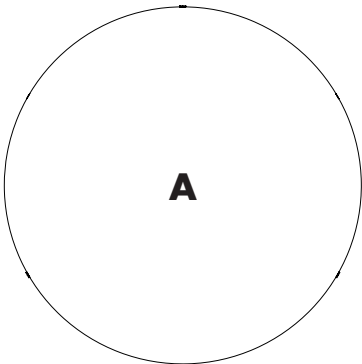
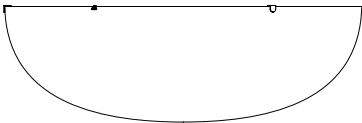

IRIS 90 90cm [35.4"
IRIS 60 60cm [23.6"

IRIS 90 30cm [11.8"
IRIS 60 20cm [7.9"

IRIS 90 15cm [5.9"
IRIS 60 10cm [3.9"

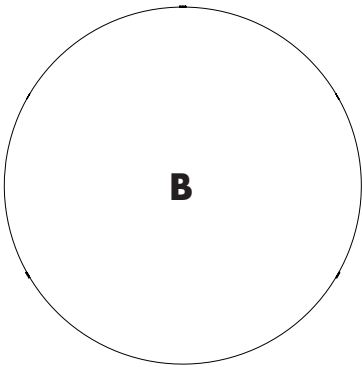

IRIS 90 90cm [35.4"
IRIS 60 60cm [23.6"

IRIS 90 15cm [5.9"
IRIS 60 10cm [3.9"

INSTALLATION

STEP 1

Connect the primary circuit on the LED driver to input power. Connect ground.

Black/brown wire = **Line** (L)

White/blue wire = **Neutral** (N)

Green screw = **Ground** (G)

⚠ Caution!

Ensure that the power is disconnected at the breaker.

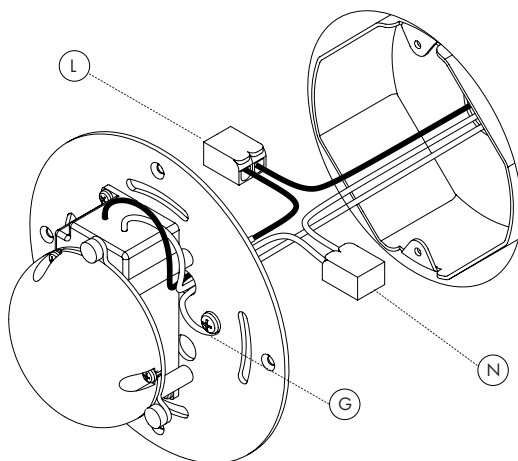

REFER TO PAGE 3: DRIVER OPTIONS FOR MORE DETAILS

STEP 2

Mount the backplate assembly to the junction box.

Use the provided #8-32 screws.

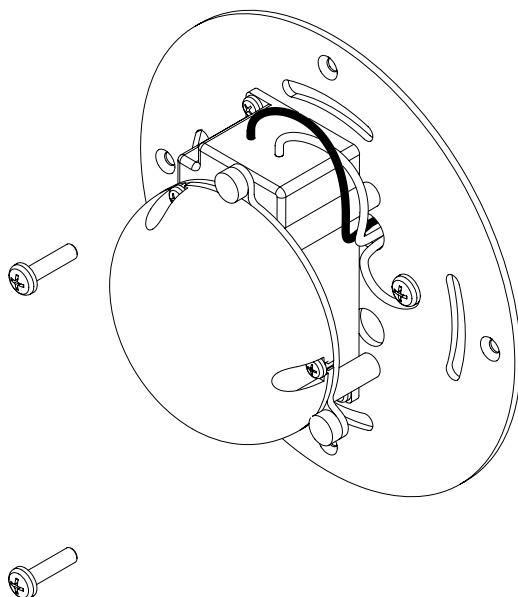

STEP 3

Slide the canopy over the backplate assembly.

The magnets will center the canopy on the backplate assembly.

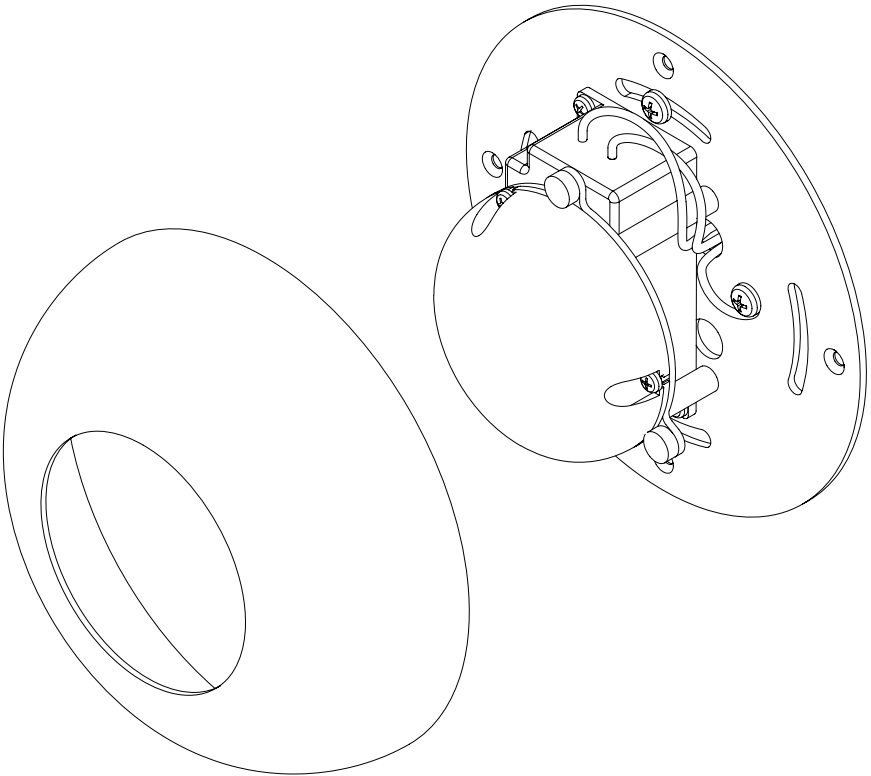

INSTALLATION

STEP 4

Slide the jig over the canopy and mark the three center points on the arms.

Remove and recycle jig after marking.

Use level to straighten orientation.

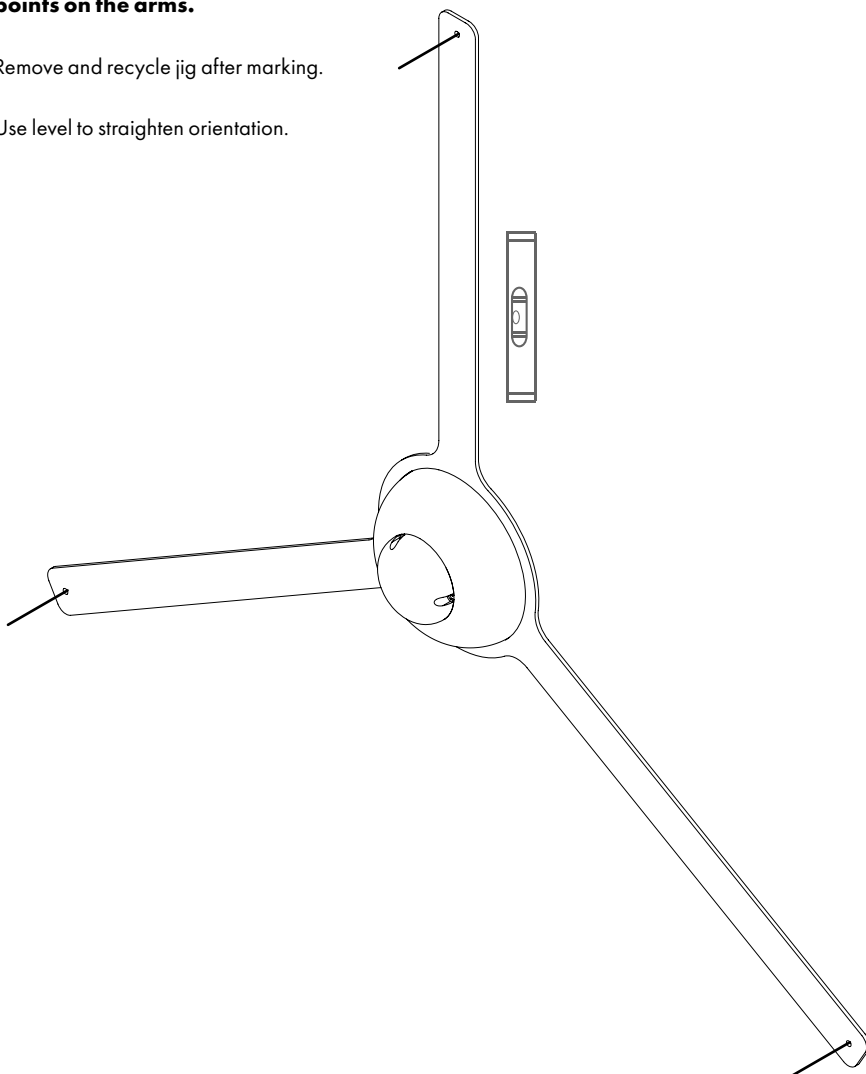

STEP 5

Using the provided #6 screws, attach the three lens pucks on the surface.

If necessary, use appropriate surface anchors (not provided).



INSTALLATION

STEP 6

Slide the diffuser over the three lens pucks and attach them with the provided lens screws.

⚠ Caution!

Pay attention to not damage the clear spacers on the lens while handling the diffuser.

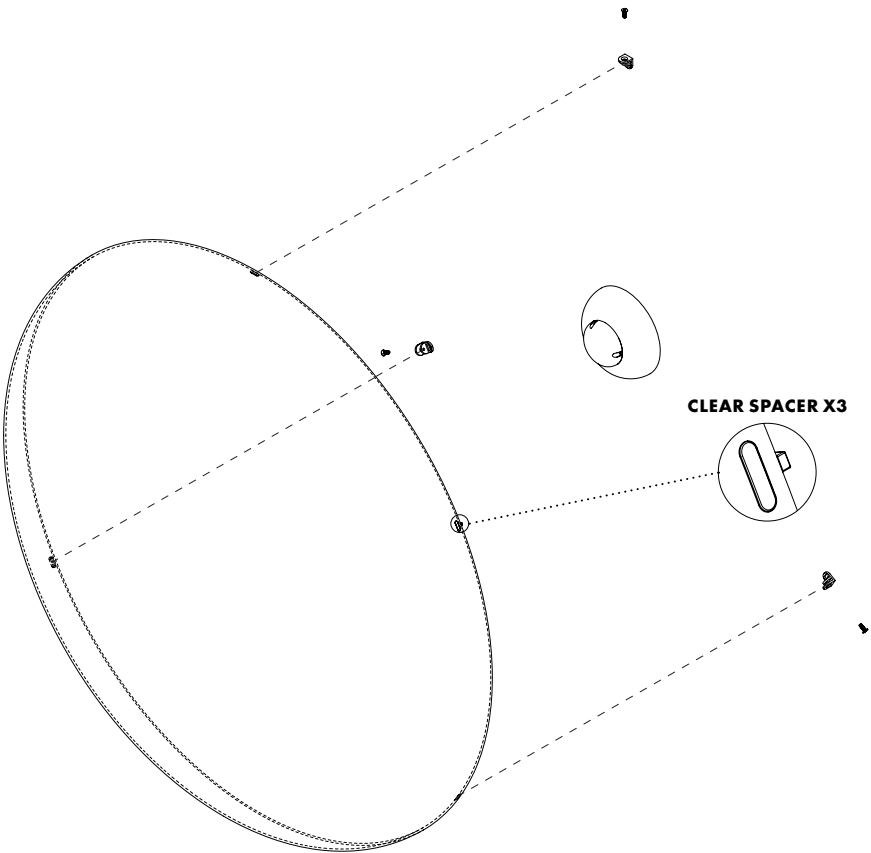

STEP 7

Ensure all the three lens pucks are secured.

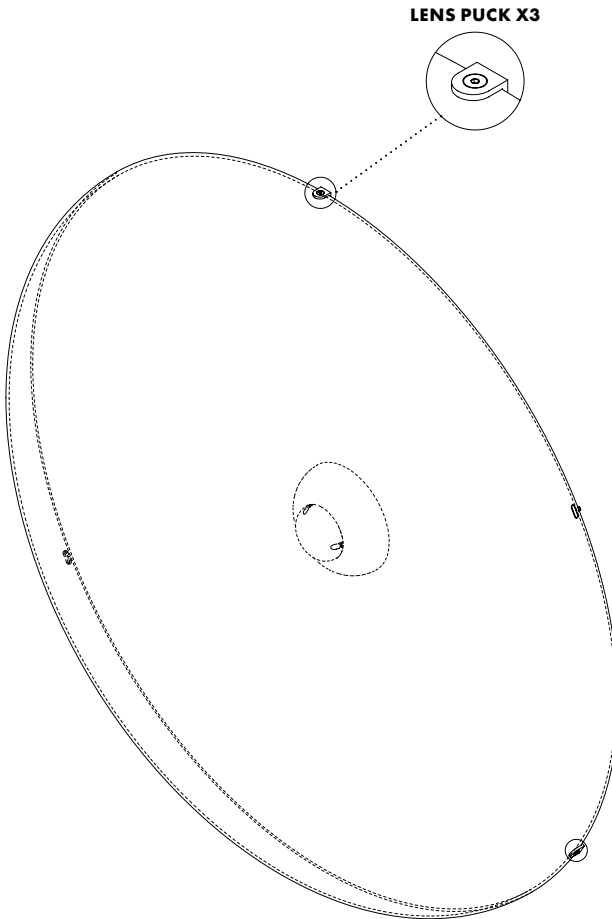



For support, please contact:

info@a-n-d.com

+1 604 563 6938

A-N-D

1951 Franklin St,
Vancouver, BC
Canada V5L 0C7

a-n-d.com