



---

# SLAB SERIES PENDANT

---

DESIGNER  
**LUKAS PEET**

**INSTRUCTIONS**



**SCAN HERE**

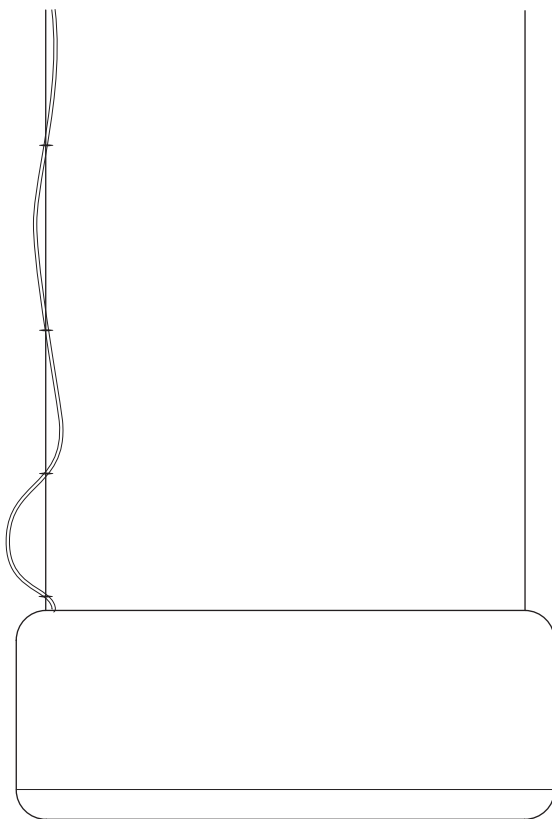

**NORTH AMERICA**



**a-n-d.com**

# INSTALLATION NOTES

---

The luminaire is powered by 12V DC. A constant voltage LED driver is required to operate the luminaire. The LED driver varies depending on input voltage and dimming requirements.

It is recommended that two people install the Slab Pendant; one to gently support the luminaire while the other makes the electrical and mechanical connections to the ceiling.

For questions regarding installation, please email **info@a-n-d.com**



---

## CARE INSTRUCTIONS

Always wear clean gloves when handling the luminaire. Clean finished surfaces with a soft, lint-free cloth. Clean acrylic diffuser with a soft lint-free cloth and a diluted solution of dish soap in warm water.

For replacement parts contact A-N-D directly.



---

## WARNING

The luminaire must be installed by a qualified electrician in a dry indoor location.

Failure to meet any or all of these criteria will not only damage the luminaire, but will void both the warranty and all of its certifications.

# COMPONENTS



- ① BACKPLATE
- ② #8-32 SCREW (2)
- ③ LED DRIVER
- ④ WIRE NUT (4)
- ⑤ CANOPY
- ⑥ STRAIN RELIEF
- ⑦ CANOPY SCREW
- ⑧ CEILING ANCHOR
- ⑨ #6 SCREW (2-3)
- ⑩ CABLE GRIPPER (2-3)
- ⑪ SUSPENSION CABLE (2-3)
- ⑫ O-RING (3)
- ⑬ ELECTRICAL CORD
- ⑭ LUMINAIRE BODY
- ⑮ ACRYLIC DIFFUSER

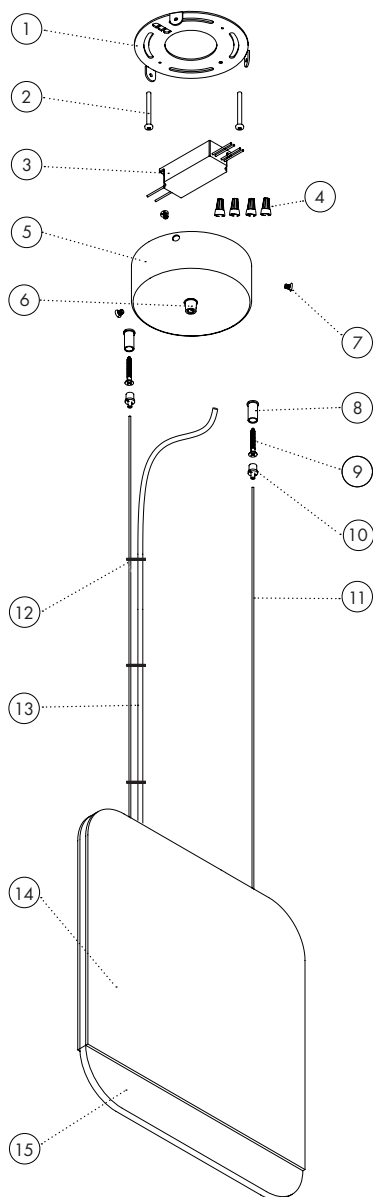

# SLAB OPTIONS

The Slab Pendant is available in 4 sizes:

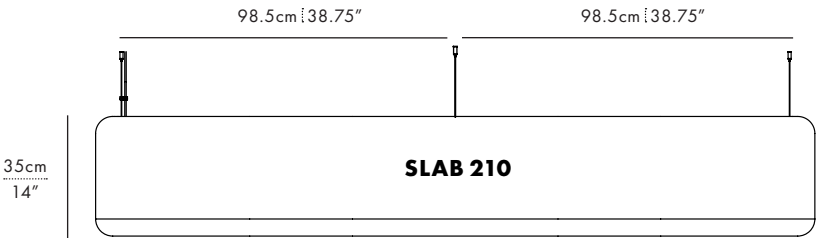
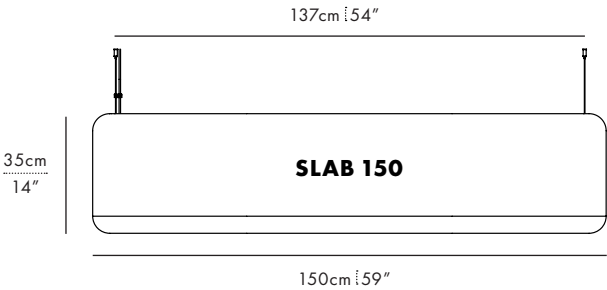
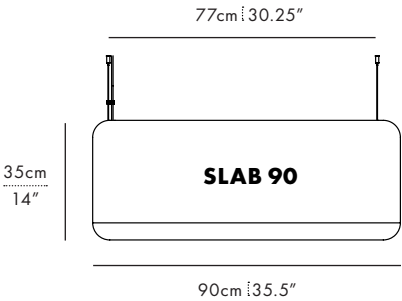
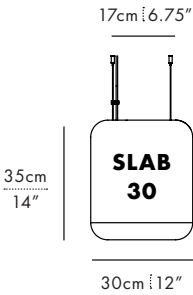

# LED DRIVER OPTIONS



The Slab Pendant LED driver varies depending on dimming requirements and input voltage.

Use the ordering code to determine the selected driver:

ie. SLA-30-P-BK-27-010-277

DIMMING --- INPUT VOLTAGE

## PHASE CUT DIMMING (PC)

M28 SERIES - ES POWER

**INPUT:** 120VAC

**OUTPUT:** 12VDC, 24W

**L x W x H:** 89 x 42 x 31

M30-P SERIES - ES POWER

**INPUT:** 120VAC

**OUTPUT:** 12VDC, 40W

**L x W x H:** 111 x 44 x 32



## 0-10 + PWM DIMMING (010)

Q22-P SERIES - ES POWER

**INPUT:** 110-277VAC

**OUTPUT:** 12VDC, 40W

**L x W x H:** 89 x 42 x 31

Q40-P SERIES - ES POWER

**INPUT:** 110-277VAC

**OUTPUT:** 12VDC, 40W

**L x W x H:** 111 x 44 x 32

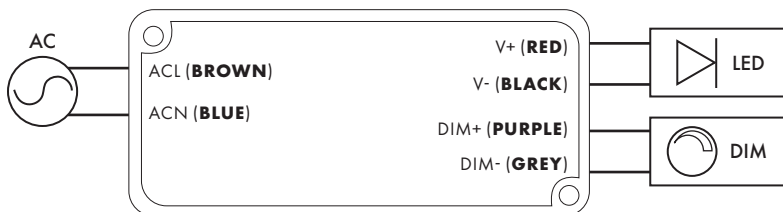

# PREPARATION

## STEP 1

**Determine the drop height of the fixture and trim excess cable.**

**Electrical cord length:**

Leave extra length. Add an extra 45cm/18" to the drop height. This allows for slack and electrical connections inside the canopy.

**⚠ Caution!**

The electrical cord must not bear any weight.

**Suspension cable length:**

Do not cut until **STEP 4**. This allows for adjustment.

DROP HEIGHT

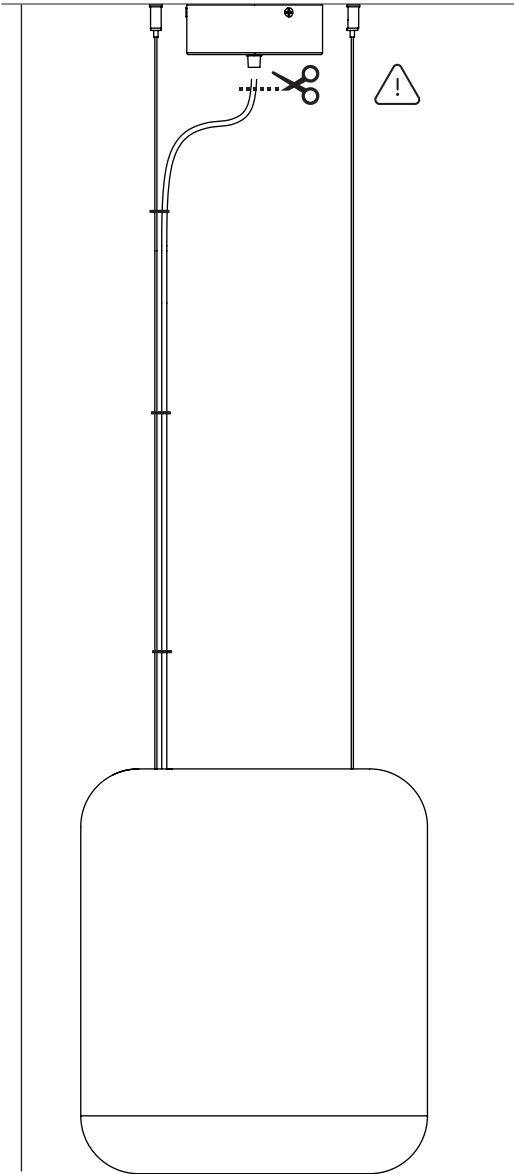

# INSTALLATION



## STEP 2

### Mark the suspension anchor points on the ceiling.

If required, all substrate specific anchors must be provided by installer. Ex: drywall anchors

Use the model specific dimensions on **PAGE 4** to determine the anchor spacing.

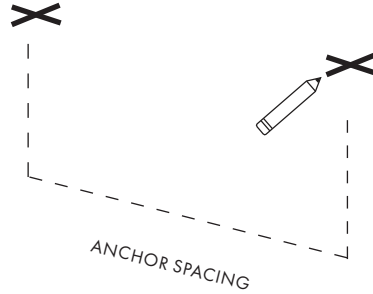

## STEP 3

### Install the suspension cable anchors on ceiling.

Use the provided #6 screws.

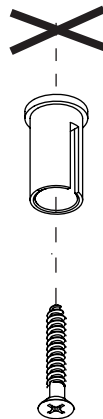

# INSTALLATION

## STEP 4

### **Suspend the luminaire.**

Attach the suspension cable grippers to the ceiling anchors by threading them clockwise.

Align the suspension cable so that it exits the slot in the side of the ceiling anchor.

To adjust the position of the cable in the cable gripper, push the center pin inwards. This releases the auto-locking mechanism on the cable.

### **Level the luminaire and trim excess suspension cable.**

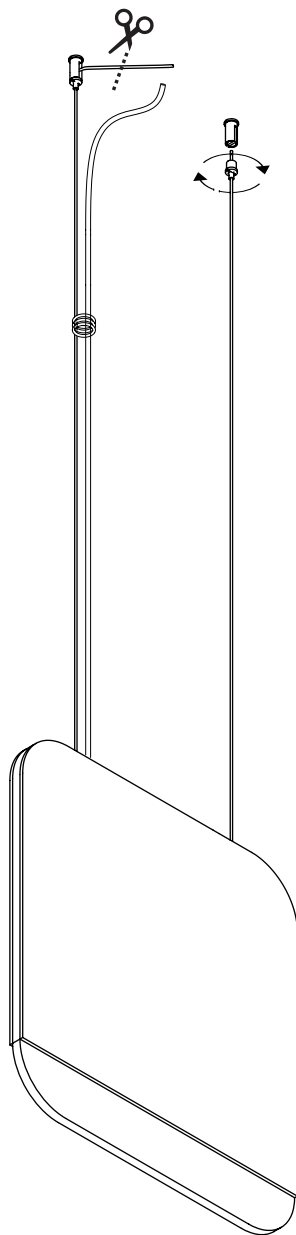



## STEP 5

### Mount the backplate to the junction box.

Use the provided machine screws.

#### **Caution!**

Ensure that the power is disconnected at the breaker.

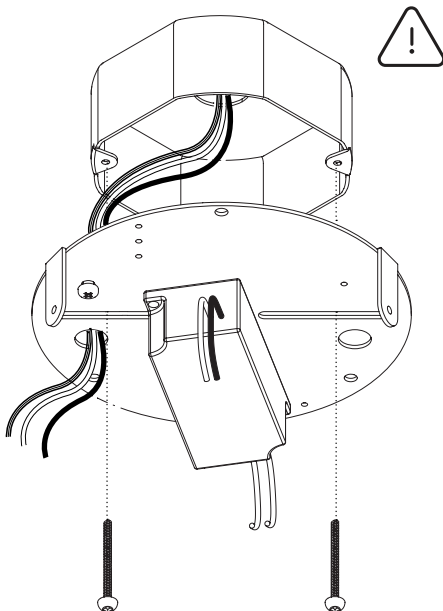

## STEP 6

### Connect the primary circuit on the LED driver to input power. Connect ground.

Black/brown wire = **Line** (L)

White/blue wire = **Neutral** (N)

Green screw = **Ground** (G)

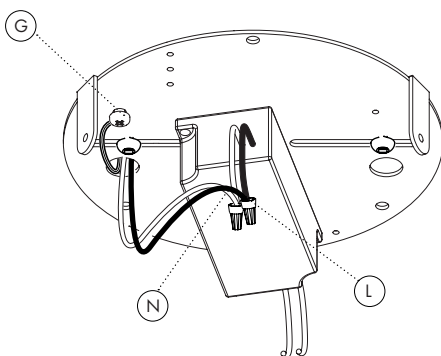

REFER TO PAGE 5: DRIVER OPTIONS FOR MORE DETAILS

# INSTALLATION

## STEP 7

**Connect the luminaire to secondary circuit on LED driver.**

Dashed line = **Positive** (V+)

Black = **Negative** (V-)

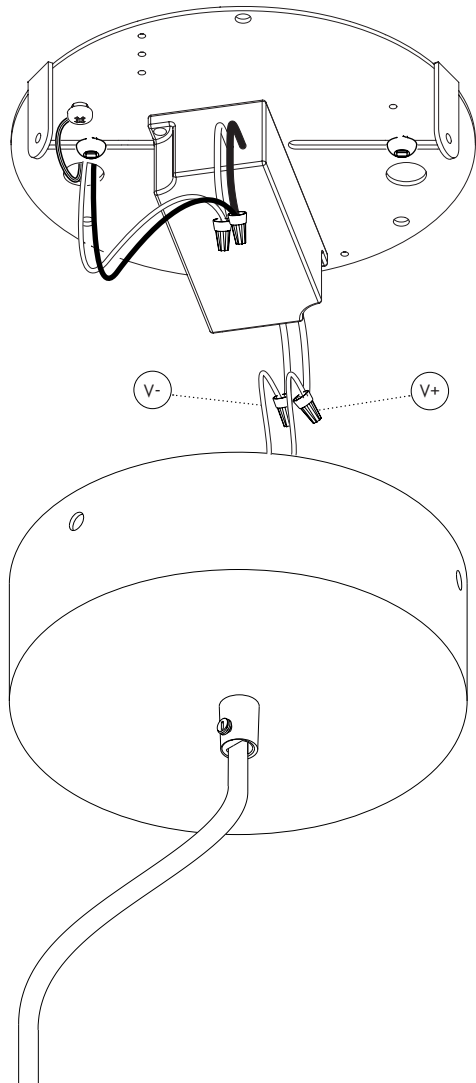

REFER TO PAGE 5: DRIVER OPTIONS FOR MORE DETAILS

## STEP 8

**Attach the canopy to the backplate and secure the electrical cord.**

Use the provided colour matched canopy screws.

Adjust the position of the electrical cord then secure it by tightening the screw on the strain relief until it gently holds it in place.

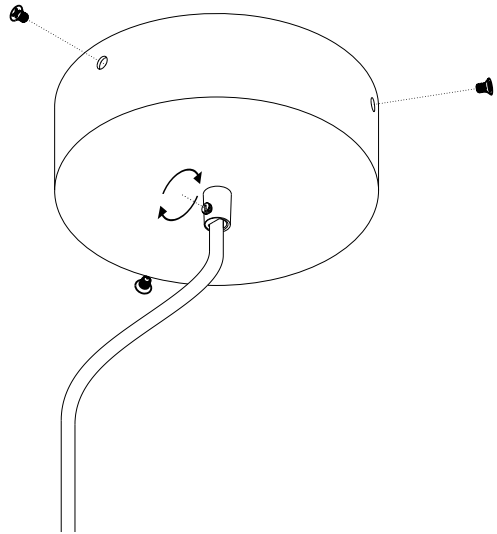



---

For support, please contact:

[info@a-n-d.com](mailto:info@a-n-d.com)

+1 604 563 6938

---

**A-N-D**

1951 Franklin St,  
Vancouver, BC  
Canada V5L 0C7

**[a-n-d.com](http://a-n-d.com)**