

AUTUMN PENDANT

Assembly instructions

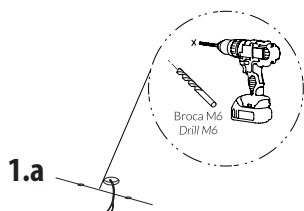

1



1.a

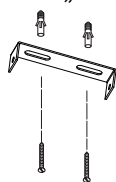

1.b

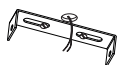

2

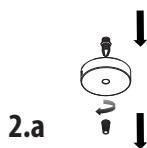

2.a

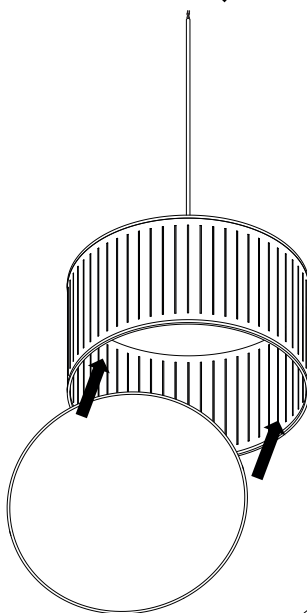

2.b

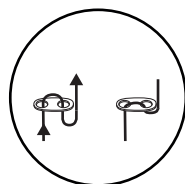

PLACE THE LIGHT DIFFUSER
FROM THE LAMP SHADE
COLOCAR EL DIFUSOR DENTRO
DE LA PANTALLA

3

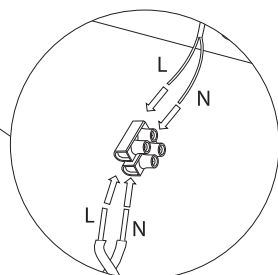
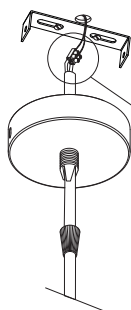

ELECTRICAL CONNECTION BY TERMINAL BLOCK
CONEXIÓN ELECTRICA MEDIANTE REGLETA.

4

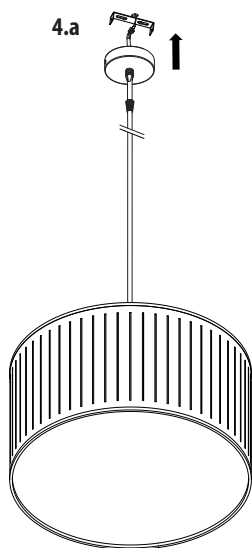

4.b

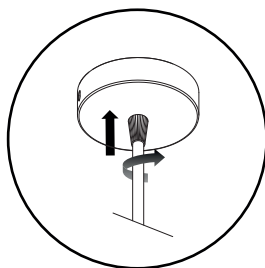

**FIX THE WIRE
BY CABLE PRESS**
FIJAR EL CABLE
MEDIANTE PRENSA
CABLES

4.c

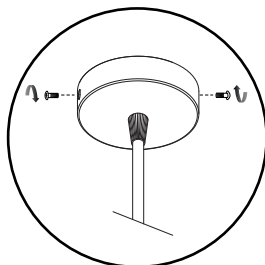

**FIX CEILING ROSETT USING
THE M4 SCREWS**
FIJAR FLORÓN DE TECHO
MEDIANTE LOS TORNILLOS M4

5

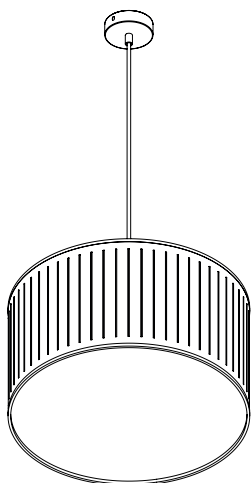

WARNING!

- Never cover the luminaire.
- Disconnect power supply before installation and change of the bulb.
- If the wire or flexible cord is damaged, it must only be change by the manufacturer, their Service Dept. or qualified personnel in order to avoid risk.



Installation of this material can be dangerous and must be done by qualified personnel.



ATENCIÓN!

- No cubra la luminaria.
- Desconectar la conexión a red antes de ser manipulada y realizar el cambio de bombilla.
- Si el cable flexible o cordón de esta luminaria es dañado, deberá sustituirse exclusivamente por el fabricante o su servicio técnico o una persona de cualificación equivalente con objeto de evitar cualquier riesgo.



La instalación de este material podría ser peligroso y por ello se ha de hacer por personal cualificado.

WE CREATE JEWELRY FOR YOUR HOME



Technical data

- Light fitting for indoor use only
- Bulb to be used:
E27 • LED • 1500lm • 2700K
- Recommended brands:
Philips • Osram

Datos técnicos

- Luminaria para uso interior
- Bombilla a utilizar:
E27 • LED • 1500lm • 2700K
- Marcas recomendadas:
Philips • Osram



IP 20
~230V-50/60Hz

