

Installation Instructions

NEX-712-LED

LED Exit & Emergency Combo with Remote Capability and Self-Diagnostics

READ PRIOR TO ATTEMPTING INSTALLATION
ALWAYS TURN OFF MAIN POWER BEFORE INSTALLATION
INSTALLATION SHOULD BE CARRIED OUT BY YOUR LOCAL ELECTRICIAN

⚠ WARNING - This equipment is intended to be installed only by qualified personnel. The installation must be made in accordance with the current edition to the National Electric Code and all applicable state and local building codes. The final installation must be approved by the appropriate qualified electrical/building inspector(s). Improper installation may result in a fire or electrical hazard. Be sure the electrical power to the circuit has been disconnected before installing this electrical system.

⚠ AVERTISSEMENT - Cet équipement est destiné à être installé uniquement par du personnel qualifié. L'installation doit être faite en conformité avec l'édition actuelle du Code national de l'électricité et toutes étatiques et locales codes du bâtiment applicables. L'installation finale doit être approuvée par l'inspecteur en électricité / bâtiment qualifié approprié(s). Une mauvaise installation peut entraîner un incendie ou un risque électrique. Soyez sûr de la puissance électrique vers le circuit a été coupée avant l'installation de ce système électrique.

IMPORTANT SAFEGUARDS READ AND FOLLOW ALL SAFETY INSTRUCTIONS

1. Review the diagrams thoroughly before beginning.
2. All electrical connetions must be in accordance with local codes, ordinances, and the National Electric code.
3. Disconnect power at fuse or circuit breaker before installing or servicing.
4. Do not use outdoors.
5. Do not mount in hazardous locations, or near gas or electric heaters.
6. Do not let power cords touch hot surface.
7. Equipment should be mounted in locations and at heights where it will not be subjected to tampering and by unauthorized personnel.
8. The use of accessory equipment not recommended by the manufacturer may cause an unsafe condition.
9. Do not use this equipment for other than intended use.
10. All servicing should be performed by a qualified personnel only.
11. Allow battery to charge for 24 hours before full duration test.
12. Maximum mounting height is 17'-6".

SAVE THESE INSTRUCTIONS

MAINTENANCE

Always disconnect power at fuse or circuit breaker before installing or servicing, servicing should be performed only by qualified personnel.

BATTERY: Should be tested periodically and replaced when it no longer meets the required duration of 30 seconds or 90 minutes. Battery needs to be recharged if product is kept in stock over 9 months.

OPERATION

1. Apply AC power to the unit, the indicator should show red.
2. Push the test switch, the LED indicator turns off and the LED board stays on.
3. After releasing the test switch, LED indicator turns back to red.

TROUBLESHOOTING GUIDE

If LED heads or LED indicator do not illuminate, check the following:

1. Check AC supply - verify that unit has 24 hours of AC voltage.
2. Unit is shorted or battery is not connected.
3. Battery voltage too low. Allow luminaire to recharge for 24 hours and then re-test.
4. If above troubleshooting do not solve your problem, contact factory for assistance.

ROUTINE TESTING

National Electric Code (NEC) and NFPA life safety code regulations require that routine tests need to be performed as below:

Once every month, perform 30 seconds duration test, push in and hold the test switch to perform a full 90-minute test.

Disconnect AC power supply and switch to emergency mode, the unit should stay on 90 minutes minimum.

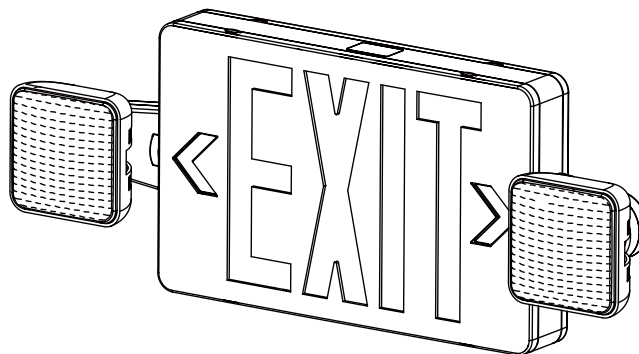

Installation Instructions

NEX-712-LED

LED Exit & Emergency Combo with Remote Capability and Self-Diagnostics

READ PRIOR TO ATTEMPTING INSTALLATION
ALWAYS TURN OFF MAIN POWER BEFORE INSTALLATION
INSTALLATION SHOULD BE CARRIED OUT BY YOUR LOCAL ELECTRICIAN

INSTALLATION INSTRUCTIONS

WALL MOUNT (Figure 2)

1. Insert flat head screwdriver into the slots on the bottom of luminaire to pry off front cover. (Figure 1)
2. Remove the appropriate knock out from back plate and mount the back plate to the junction box.
3. Remove side hole plug from housing, snap lamp heads on the unit and connect to PC board. (Figure 6)
4. Route the AC supply wires through center hole inside of housing
5. Install fixture to junction box.
6. Make correct electrical connections inside of fixture. (See wiring diagram)
7. Push excess wire into junction box.
8. Snap chevron to EXIT panel if required.
9. Attach battery connector to PC board, restore front panel on unit. Adjust direction of lamp heads as needed.

CEILING MOUNT (Figure 3)

1. Attach crossbar to junction box, set the crossbar so that the short blade is touching the junction box.
2. Insert flat head screwdriver into the slots on the bottom of luminaire to pry off front cover.
3. If double face is desired, replace back plate with additional face plate provided.
4. Remove out the mounting hole cover on the top and side of the unit, assemble the canopy to the unit. (Figure 5)
5. Snap lamp heads on the unit and connect to PC board. (Figure 6)
6. Route the proper wires through mounting hole out of housing.
7. Make electrical connections inside the junction box. (See wiring diagram)
8. Fasten crossbar on junction box by screws provided, fasten canopy to crossbar and against the wall.
9. Snap chevron to EXIT panel if required.
10. Attach battery connector to PC board, restore front panel on unit and adjust the direction of lamp heads as needed.

CONNECTING REMOTE HEADS (Figure 4)

If fixture has remote capability option, max remote capability is 3.6 VDC 1.5W Max.

Connect remote heads extension wire to remote wire, yellow = positive (+), purple = negative (-).

Connect using wire nuts.

Wiring Diagram

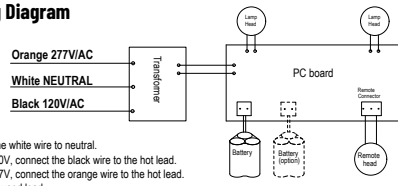

Canopy Assembly - Figure 5

Put the canopy connector inside of housing then slider and fixed by plastic clip.

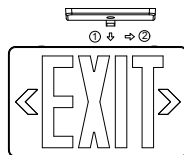

Lamp Head Assembly - Figure 6

Assemble lamp head on main frame by plastic clip, lamp head can easy rotate to frontward or backward.

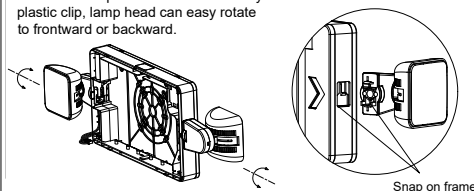
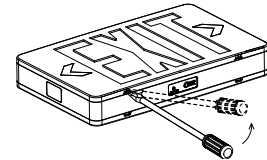
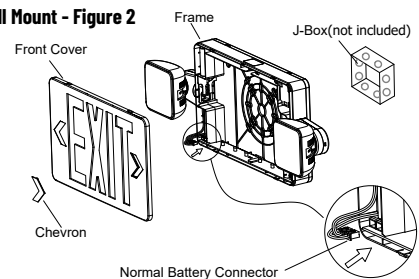

Figure 1



Wall Mount - Figure 2



Ceiling Mount - Figure 3

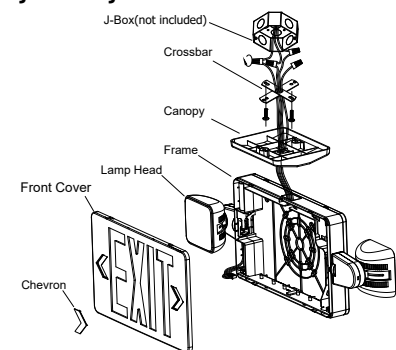

Connecting Battery and Remote Heads - Figure 4

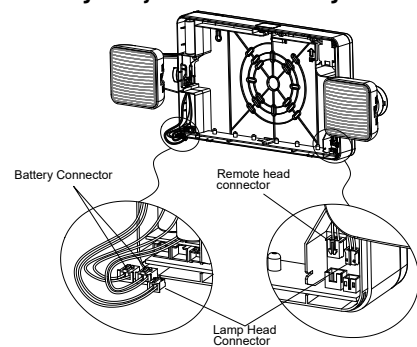

Installation Instructions

NEX-712-LED

LED Exit & Emergency Combo with Remote Capability and Self-Diagnostics

READ PRIOR TO ATTEMPTING INSTALLATION

ALWAYS TURN OFF MAIN POWER BEFORE INSTALLATION

INSTALLATION SHOULD BE CARRIED OUT BY YOUR LOCAL ELECTRICIAN

SELF-DIAGNOSTICS INSTRUCTIONS

1. When AC power is supplied, the luminaire will automatically initiate self-test and self-diagnostic tests as follows:
- a) Verifies battery disconnection, charger board failure every 5 seconds
- b) 1 minute self-testing every month
- c) 90 minute self-testing every 12 months after installation
2. Dual color LED lamp indicator shows the following status:
- a) Green color = ON / READY
- = Blinking: Testing
- b) Red color = Service Alert
- c) Service Alert LED Code (Red color LED lamp indicator)

●	One blink, 4 second pause	Battery is not connected
●●	Two blinks, 4 second pause	Battery failure (discharge time shortage)
●●●	Three blinks, 4 second pause	Charger board circuit failure
●●●●	Four blinks, 4 second pause	Transfer function failure
●●●●●	Five blinks, 4 second pause	Integral LED head failure (for emergency operation)
●●●●●●	Six blinks, 4 second pause	Remote heads failure (for remote operation)
●●●●●●●	Seven blinks, 4 second pause	LED strip failure

NOTE: After solving the fault of emergency equipment, please press test button for 2 seconds without releasing to reset. LED indicator will show green when complete.

3. Self testing / self diagnostic also have manual test functionality, press test button as follows:

Press test button once	30 seconds discharge test
Press test button twice within 2 seconds	3 minutes discharge test
Press test button 3 times within 2 seconds	30 minutes discharge test
Press test button 4 times within 2 seconds	90 minutes discharge test

REMOTE HEAD INSTALLATION

1. Remove jump connector from the female connector on the PCBA. (Figure 1)
2. Attach the remote male connector into the female connector on PC board. (Figure 2)
3. Connect extended remote head wires to the remote wires using wire nut. Yellow is positive (+) and purple is negative (-).

Figure 1

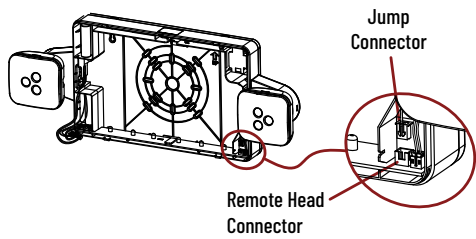

Figure 2

