

## GLO-BALL S2

Designed by Jasper Morrison, 1998

F3010061

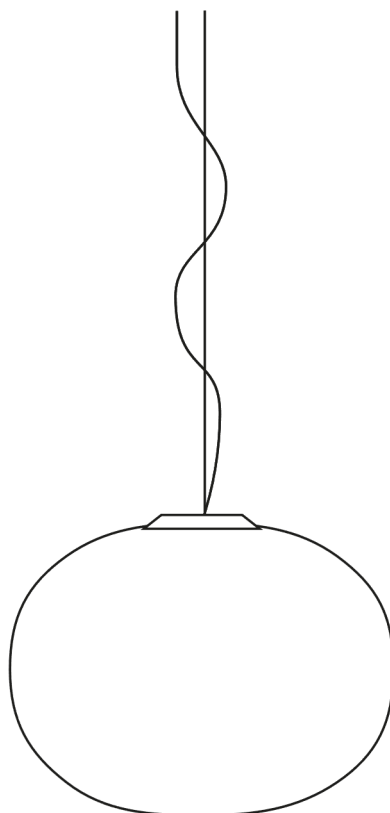

## GLO-BALL S2

F3010061

EN

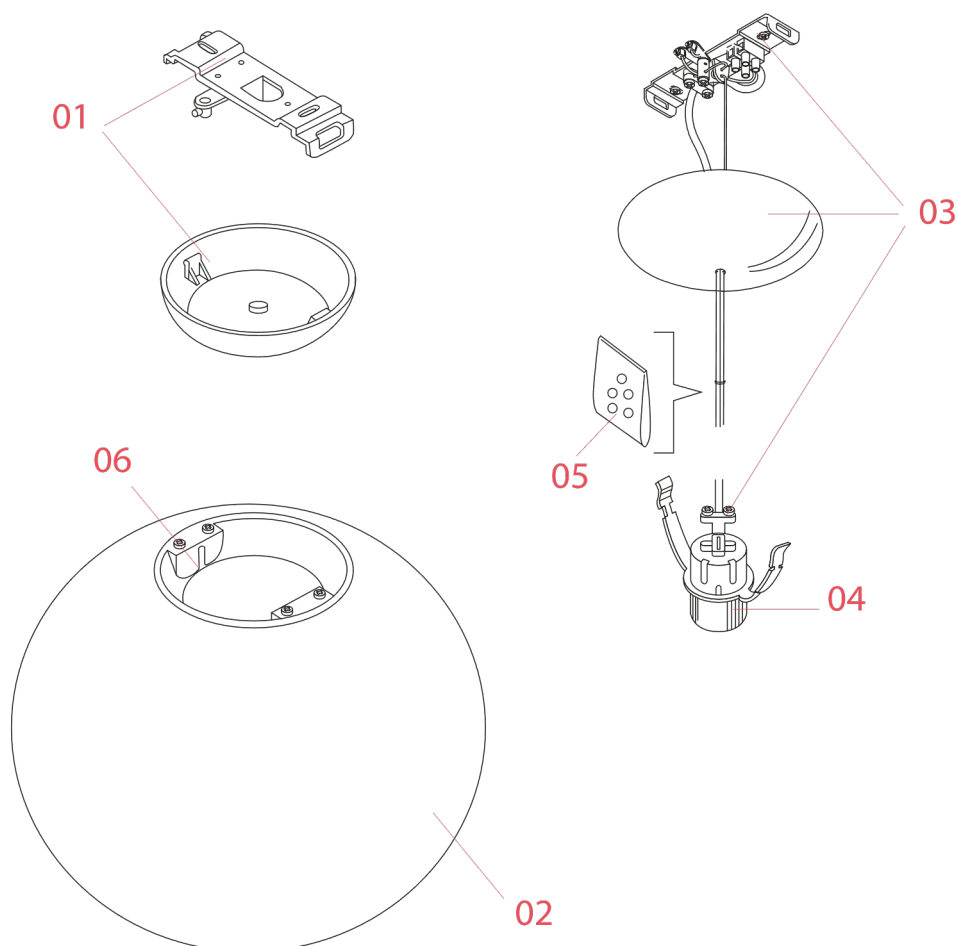

01. RA3690209 – White ceiling rose Assembly

02. F3015061 – White diffuser

03. A2512000 – Electrical wiring assembly

04. RF04322 – BJB E27 Lamp holder

05. RF05382 – Kit of quantity 5 OR rings

06. RF09514 – Ring nut assembly for diffuser 2

GLO-BALL S2 F3010061

EN

## RA3690209

WHITE CEILING ROSE ASSEMBLY



Chasen  
p.03



Glo-ball  
S1  
p.03



Glo-ball  
S2  
p.03



Skygarden  
1  
p.03



Skygarden  
Small  
p.03



Smithfield S  
p.03



Smithfield  
S Pro  
p.03



Taraxacum  
S1 Cocoon  
p.03



Taraxacum  
S2 Cocoon  
p.03



Viscontea  
p.03

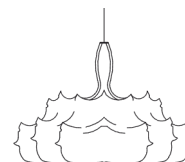

Zeppelin 1  
p.03

**WARNING!** When installing and whenever acting on the appliance, ensure that the power supply has been switched off.  
For the installation of the spare-part, it is necessary to consult a qualified electrician.

GLO-BALL S2 F3010061

EN

## RA3690209

WHITE CEILING ROSE ASSEMBLY

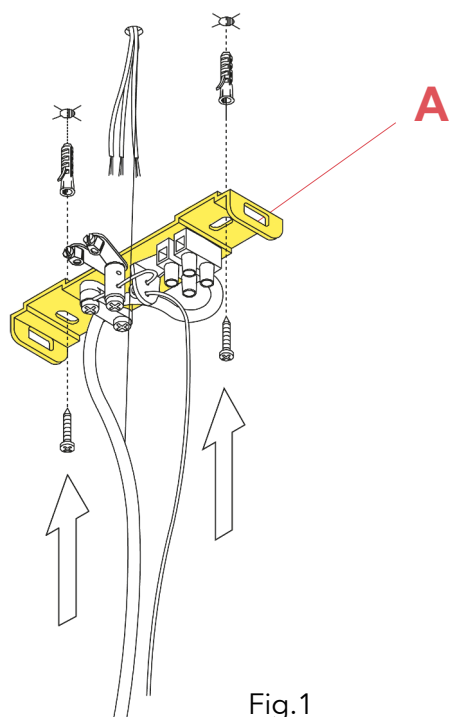

Fig.1

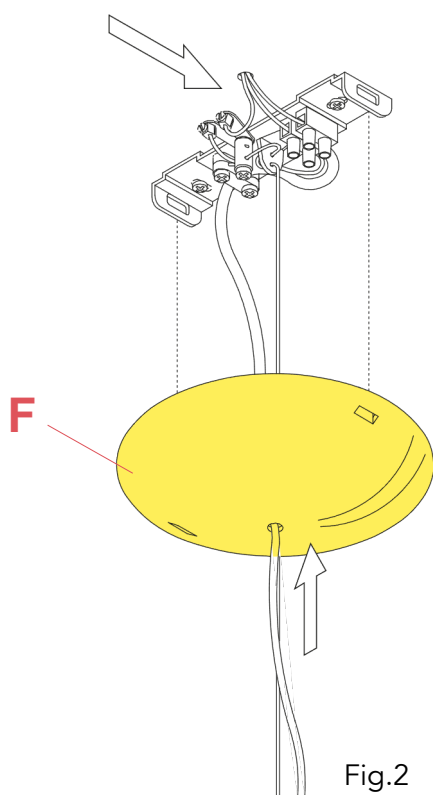

Fig.2

Fix the wall fixture (A) with the appropriate expansion bolts. **NOTE:** Select and employ screw anchors which are suited to the surface where the appliance is to be installed.

Connect the power cable to the terminal box (not supplied with the spare-part). Mount the ceiling-rose (F).

**WARNING!** When installing and whenever acting on the appliance, ensure that the power supply has been switched off. For the installation of the spare-part, it is necessary to consult a qualified electrician.



**GLO-BALL S2 F3010061**

**EN**

## **F3015061**

WHITE DIFFUSER



**WARNING!** When installing and whenever acting on the appliance, ensure that the power supply has been switched off.  
For the installation of the spare-part, it is necessary to consult a qualified electrician.

©2021 Flos - All rights reserved - [www.flos.com](http://www.flos.com)

Flos reserves the right to introduce any changes to its own models, without prior notice.

GLO-BALL S2 F3010061

EN

## F3015061

WHITE DIFFUSER

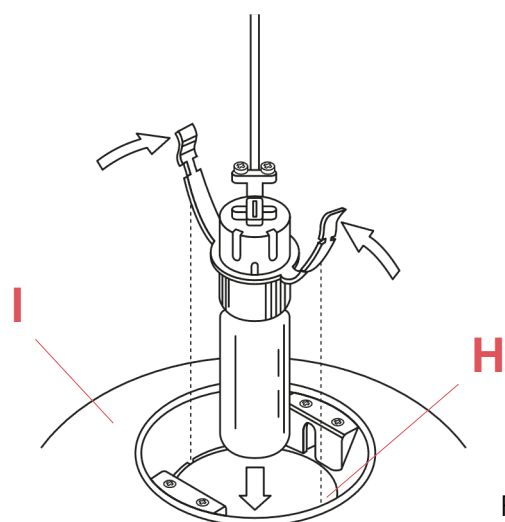

Fig.1

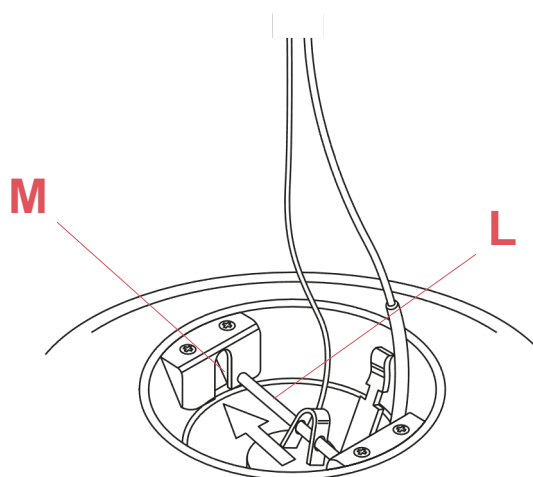

Fig.2

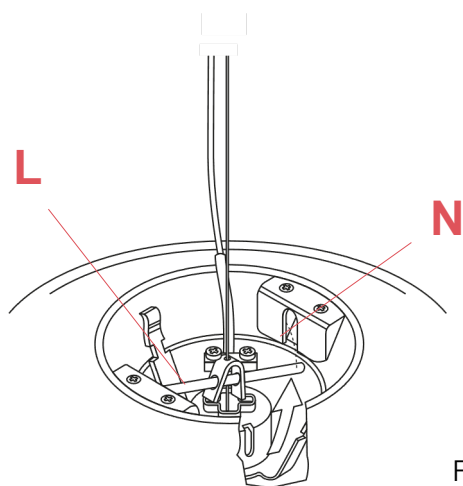

Fig.3

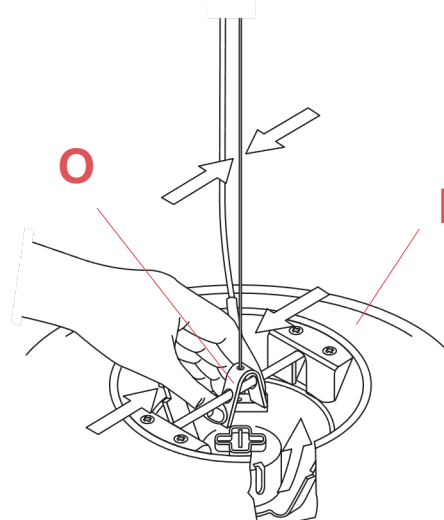

Fig.4

Insert the bulb. Insert the bulb-holder in its housing (H) in the diffuser (I). (fig.1)

Insert the rod (L) in the housing (M). (fig.2)

Hook the rod (L) into the housing (N), until it locks "clicks – in". (fig.3)

To balance the diffuser (I), regulate the spring (O) on the horizontal axis. (fig.4)

**WARNING!** When installing and whenever acting on the appliance, ensure that the power supply has been switched off.  
For the installation of the spare-part, it is necessary to consult a qualified electrician.

**GLO-BALL S2 F3010061**

**EN**

## **A2512000** ELECTRICAL WIRING ASSEMBLY



WARNING! When installing and whenever acting on the appliance, ensure that the power supply has been switched off.  
For the installation of the spare-part, it is necessary to consult a qualified electrician.

©2021 Flos - All rights reserved - [www.flos.com](http://www.flos.com)  
Flos reserves the right to introduce any changes to its own models, without prior notice.

GLO-BALL S2 F3010061

EN

## A2512000

ELECTRICAL WIRING ASSEMBLY

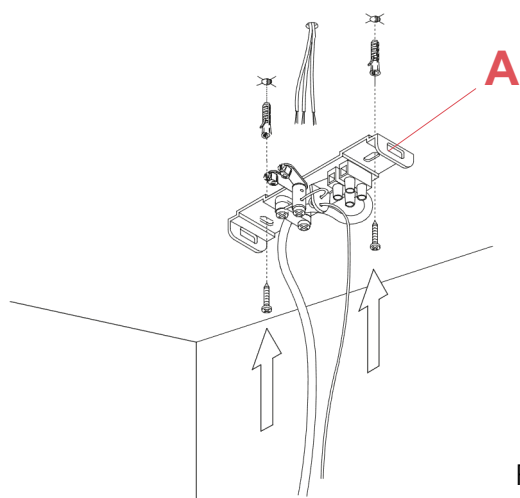

Fig.1

Fix the wall fixture (A) with the appropriate expansion bolts.

**NOTE:** Select and employ screw anchors which are suited to the surface where the appliance is to be installed.

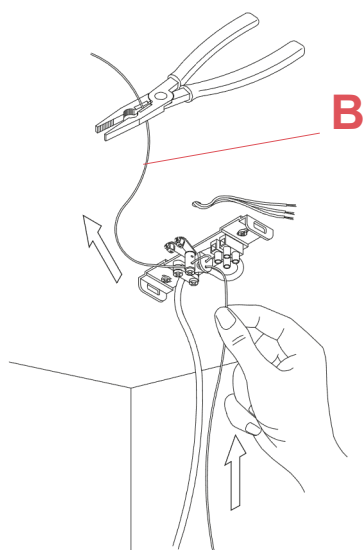

Fig.2

Cut the steel cable (B) at the desired height.

**WARNING!** When installing and whenever acting on the appliance, ensure that the power supply has been switched off. For the installation of the spare-part, it is necessary to consult a qualified electrician.

## A2512000

### ELECTRICAL WIRING ASSEMBLY

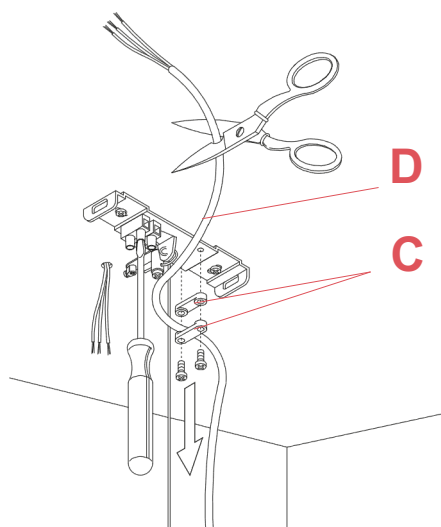

Fig.3

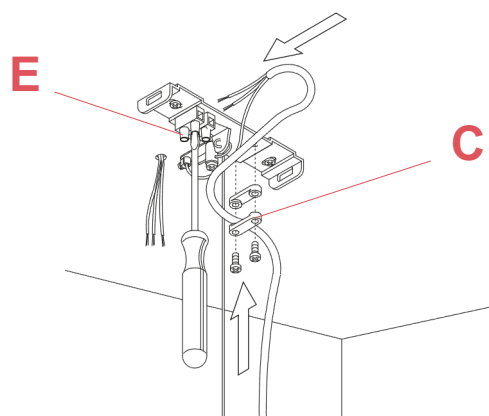

Fig.4

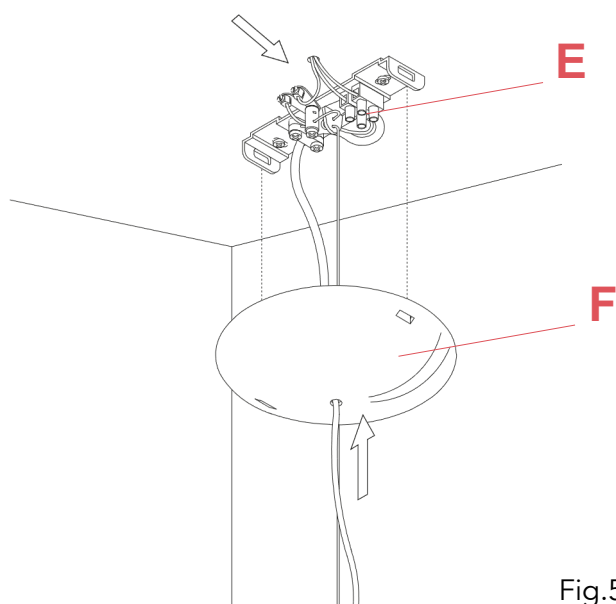

Fig.5

Detach the cable-block (C). Disconnect the feed cable (D) and cut it at the height desired.

Mount the cable block (C) and carry out the wiring to the terminal block (E).

Connect the power cable to the terminal block (E) and earthing. Mount the ceiling-rose (F).

GLO-BALL S2 F3010061

EN

## A2512000

ELECTRICAL WIRING ASSEMBLY

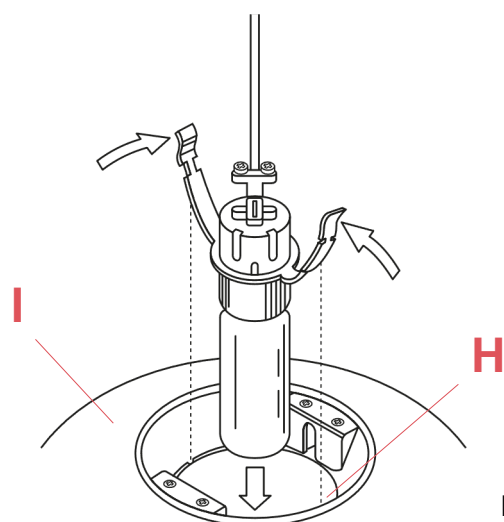

Fig.6

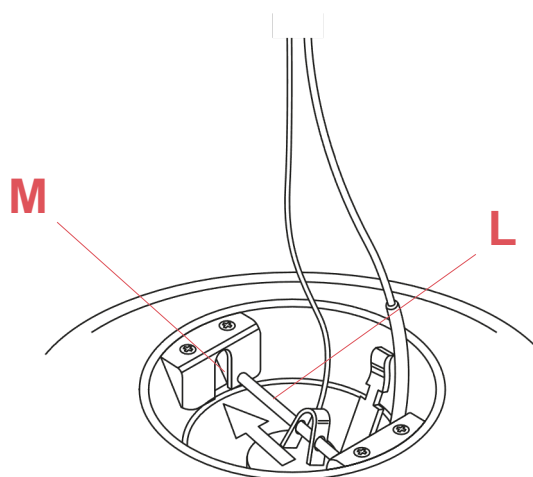

Fig.7

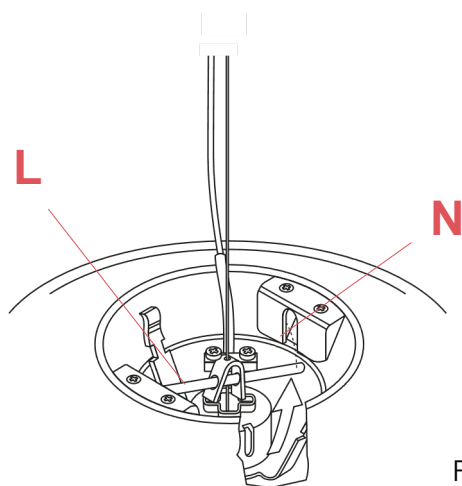

Fig.8

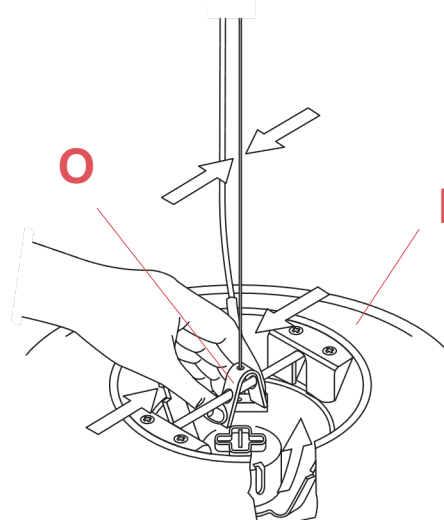

Fig.9

NOW Insert the bulb. Insert the bulb-holder in its housing (H) in the diffuser (I). (fig.6)

Insert the rod (L) in the housing (M). (fig.7)

Hook the rod (L) into the housing (N), until it locks "clicks – in". (fig.8)

To balance the diffuser (I), regulate the spring (O) on the horizontal axis. (fig.9)

**WARNING!** When installing and whenever acting on the appliance, ensure that the power supply has been switched off.  
For the installation of the spare-part, it is necessary to consult a qualified electrician.

**GLO-BALL S2** F3010061

**EN**

## RF04322

BJB E27 LAMP HOLDER



WARNING! When installing and whenever acting on the appliance, ensure that the power supply has been switched off.  
For the installation of the spare-part, it is necessary to consult a qualified electrician.

©2021 Flos - All rights reserved - [www.flos.com](http://www.flos.com)  
Flos reserves the right to introduce any changes to its own models, without prior notice.

GLO-BALL S2 F3010061

EN

## RF04322

BJB E27 LAMP HOLDER

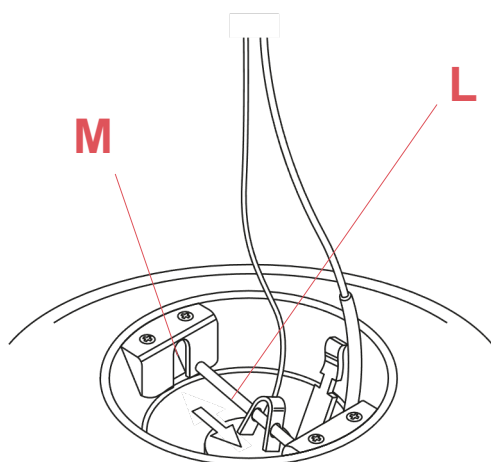

Fig.1

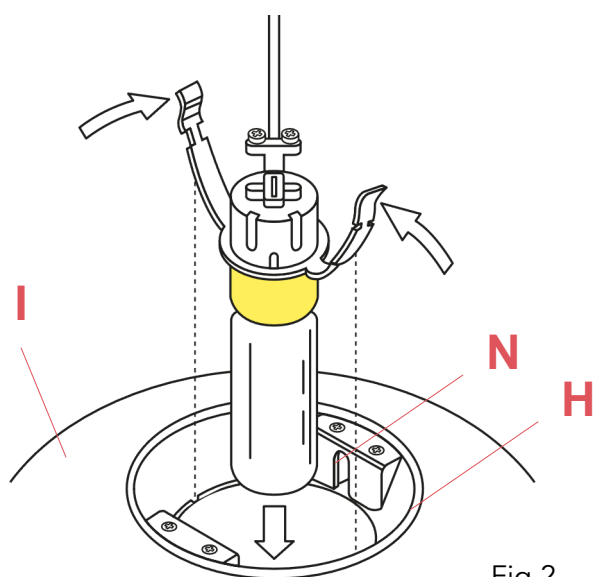

Fig.2

Remove the white glass diffuser.  
It is necessary to ask somebody to hold the glass diffuser (I).  
Unlock the rod (L) from the housings (M) present on the diffuser assembly (I).  
Remove the glass diffuser (I) by unhooking the lamp holder supports from the housing (H).

Remove the lamp-bulb.

**WARNING!** When installing and whenever acting on the appliance, ensure that the power supply has been switched off.  
For the installation of the spare-part, it is necessary to consult a qualified electrician.



GLO-BALL S2 F3010061

EN

**RF04322**

BJB E27 LAMP HOLDER

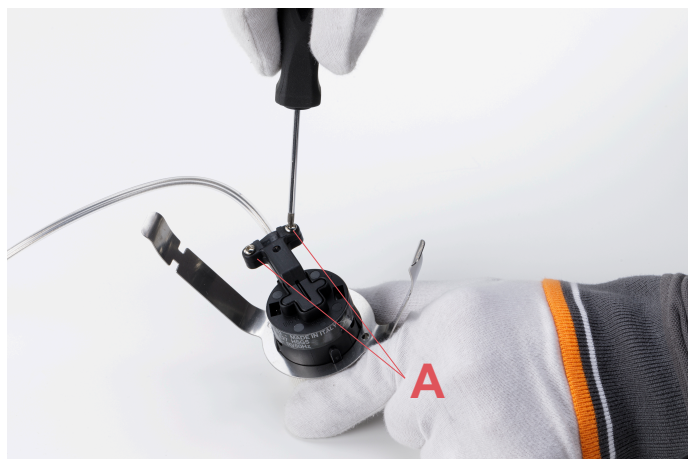

Fig.3

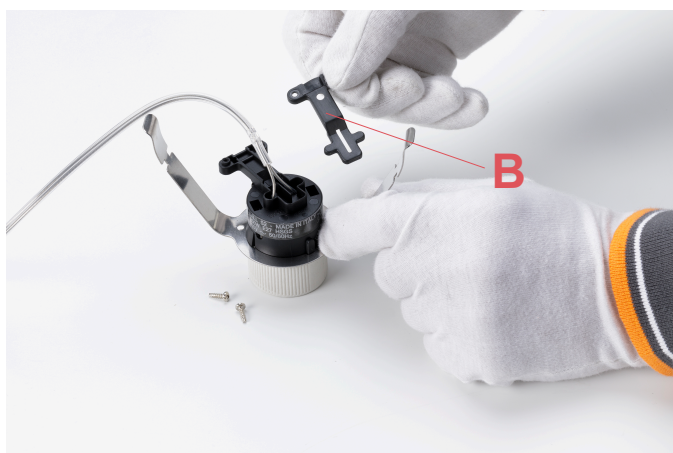

Fig.4

Unfasten the 2 screws (A) of the cable clamp present on the lamp holder assembly and then remove the cover (B).

WARNING! When installing and whenever acting on the appliance, ensure that the power supply has been switched off. For the installation of the spare-part, it is necessary to consult a qualified electrician.

GLO-BALL S2 F3010061

EN

## RF04322

BJB E27 LAMP HOLDER



Fig.5

Insert a thin pin (C) or any other similar object inside the terminals (D) of the wire connections. Press down inside the terminals (D) with the pin (C) and then free the wires from the lamp holder.

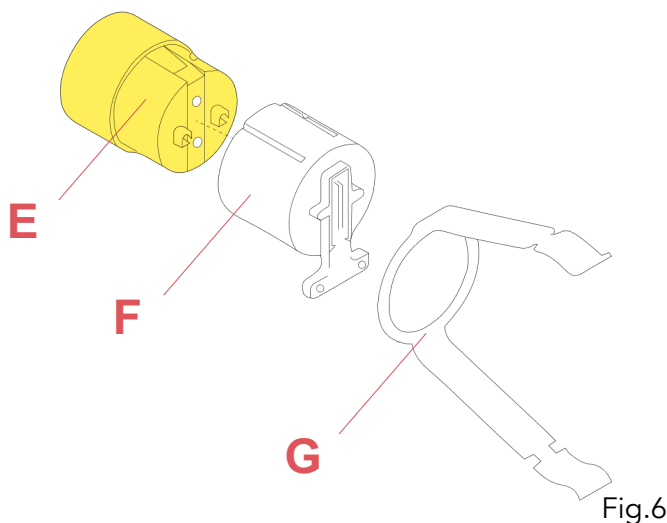

Fig.6

Remove the lamp holder (E) that needs to be replaced, from the cap (F) and from the lamp holder assembly support (G).

Assemble now the new spare-part:

Insert the new lamp holder (E) inside the cap (F) and lamp holder support (G).

**REMARK!!!** Ensure that the terminals of the lamp holder correspond with the holes present on the cap.

**WARNING!** When installing and whenever acting on the appliance, ensure that the power supply has been switched off. For the installation of the spare-part, it is necessary to consult a qualified electrician.

GLO-BALL S2 F3010061

EN

## RF04322

BJB E27 LAMP HOLDER

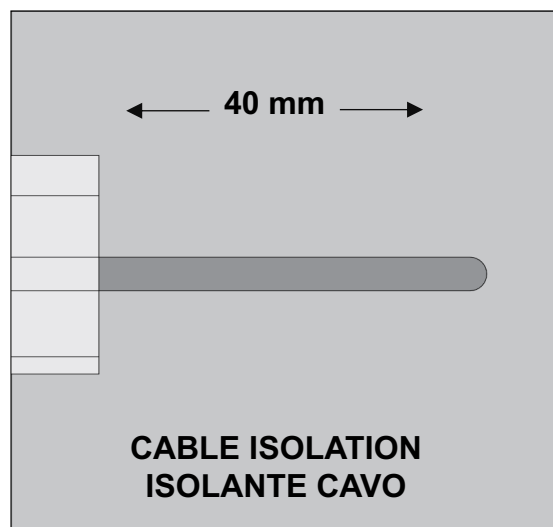

Fig.6

Strip-off 40mm length of the electrical isolation.

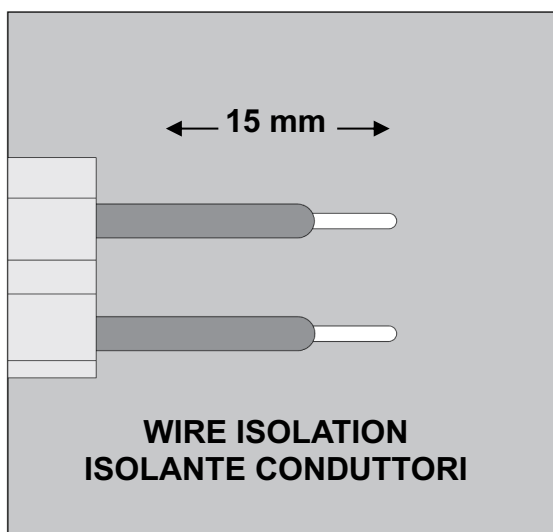

Fig.7

Strip-off 15mm length of the wires isolations.

WARNING! When installing and whenever acting on the appliance, ensure that the power supply has been switched off.  
For the installation of the spare-part, it is necessary to consult a qualified electrician.

GLO-BALL S2 F3010061

EN

## RF04322

BJB E27 LAMP HOLDER



Fig.7

Twist and bend the conductors (K) of the wires and connect them inside the terminals (D) of the lamp holder.

Verify that they are inserted correctly by pulling the wires.

Clamp the electrical cable.  
Position the cable clamp cover (B) and fasten the 2 screws (A).



Fig.8

Now Insert the lamp bulb.  
Install the bulb-holder in its housing (H) present on the glass diffuser (I).  
Insert the rod (L) in the housing (M).  
Hook the rod (L) into the housing (N), up to the blocking "click". (view image at page 12)

**WARNING!** When installing and whenever acting on the appliance, ensure that the power supply has been switched off.  
For the installation of the spare-part, it is necessary to consult a qualified electrician.

GLO-BALL S2 F3010061

EN

RF05382

KIT OF QUANTITY 5 OR RINGS



Glo-ball  
S1  
p.18



Glo-ball  
S2  
p.17



Skygarden  
1  
p.08



Skygarden  
2  
p.08



Skygarden  
Small  
p.08



Smithfield  
S  
p.05



Smithfield  
S Pro  
p.05



Tatou  
S2  
p.11

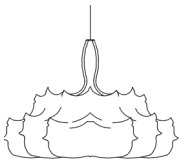

Zeppelin 1  
p.05

WARNING! When installing and whenever acting on the appliance, ensure that the power supply has been switched off.  
For the installation of the spare-part, it is necessary to consult a qualified electrician.

**GLO-BALL S2 F3010061**

**EN**

## **RF09514**

RING NUT ASSEMBLY FOR DIFFUSER 2



WARNING! When installing and whenever acting on the appliance, ensure that the power supply has been switched off.  
For the installation of the spare-part, it is necessary to consult a qualified electrician.

©2021 Flos - All rights reserved - [www.flos.com](http://www.flos.com)  
Flos reserves the right to introduce any changes to its own models, without prior notice.

GLO-BALL S2 F3010061

EN

**RF09514**

RING NUT ASSEMBLY FOR DIFFUSER 2

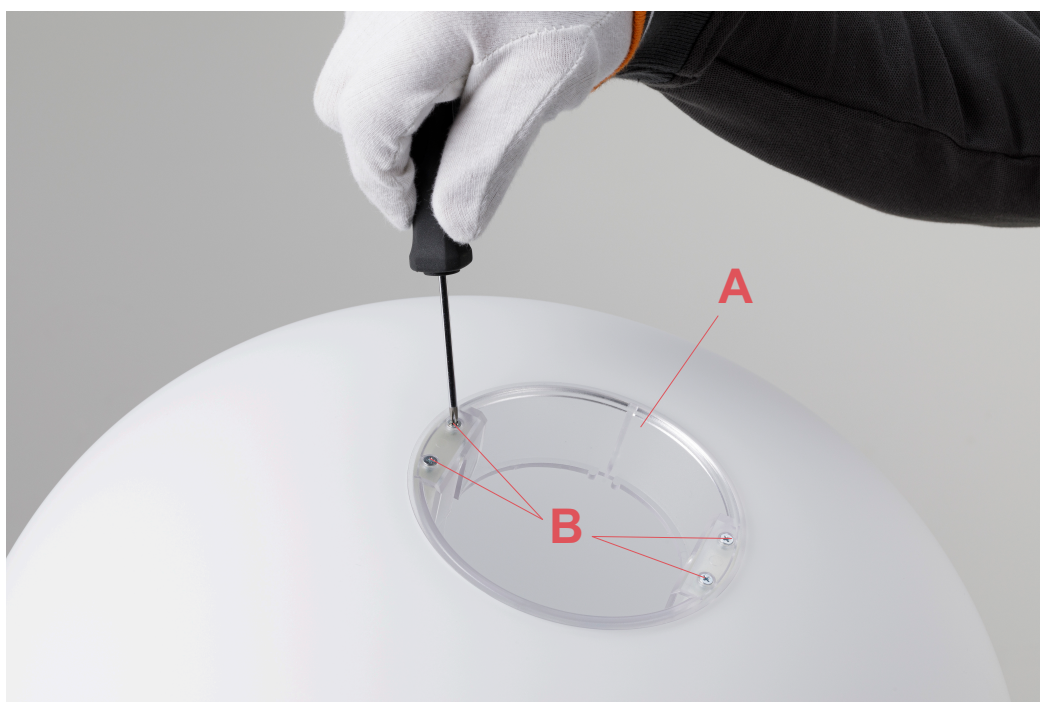

Insert the ring nut (A) in the glass diffuser hole and then fasten the screws (B).

**REMARKS!!!** Do not tighten the screws hard. Risk cracking the glass diffuser.

WARNING! When installing and whenever acting on the appliance, ensure that the power supply has been switched off.  
For the installation of the spare-part, it is necessary to consult a qualified electrician.

©2021 Flos - All rights reserved - [www.flos.com](http://www.flos.com)  
Flos reserves the right to introduce any changes to its own models, without prior notice.