

CONTENTS

Pearl Sconce (120V/240V)

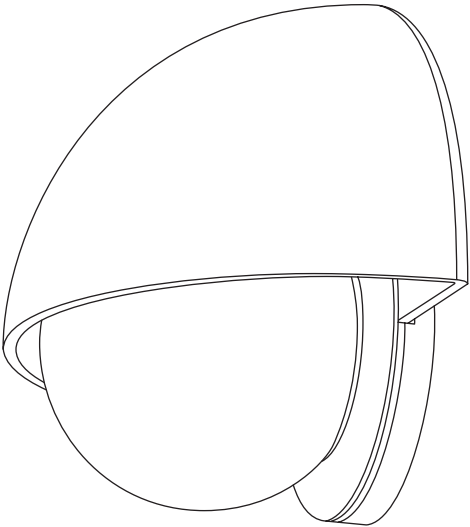

(x2) 8-32 J box Screw

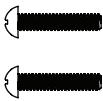

(x7) Wago Connectors



(x2) Button head Screw



Crossbar with ground screw

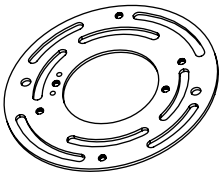

Driver

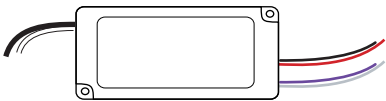

(x4) Toggle anchor
(240V only)

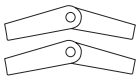

(x4) Metal screw
(240V only)



Driver Box
(240V only)

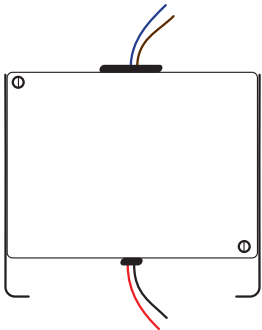

(x4) Wood screw
(240V only)

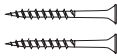

(x4) Long 8-32 screw
(240V only)

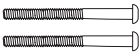

SAFETY INFORMATION

Maximum ambient temperature: 25°C

The light source contained in this luminaire shall only be replaced by the manufacturer or his service agent or a similar qualified person.

PEARL SCNCE (120V) | INSTALLATION

Note: Please contact a licensed electrician.

01. Unscrew the glass diffuser (A) from the main sconce base (B) in a counter clockwise direction. Then gently slide it out, as there is a very tight clearance.

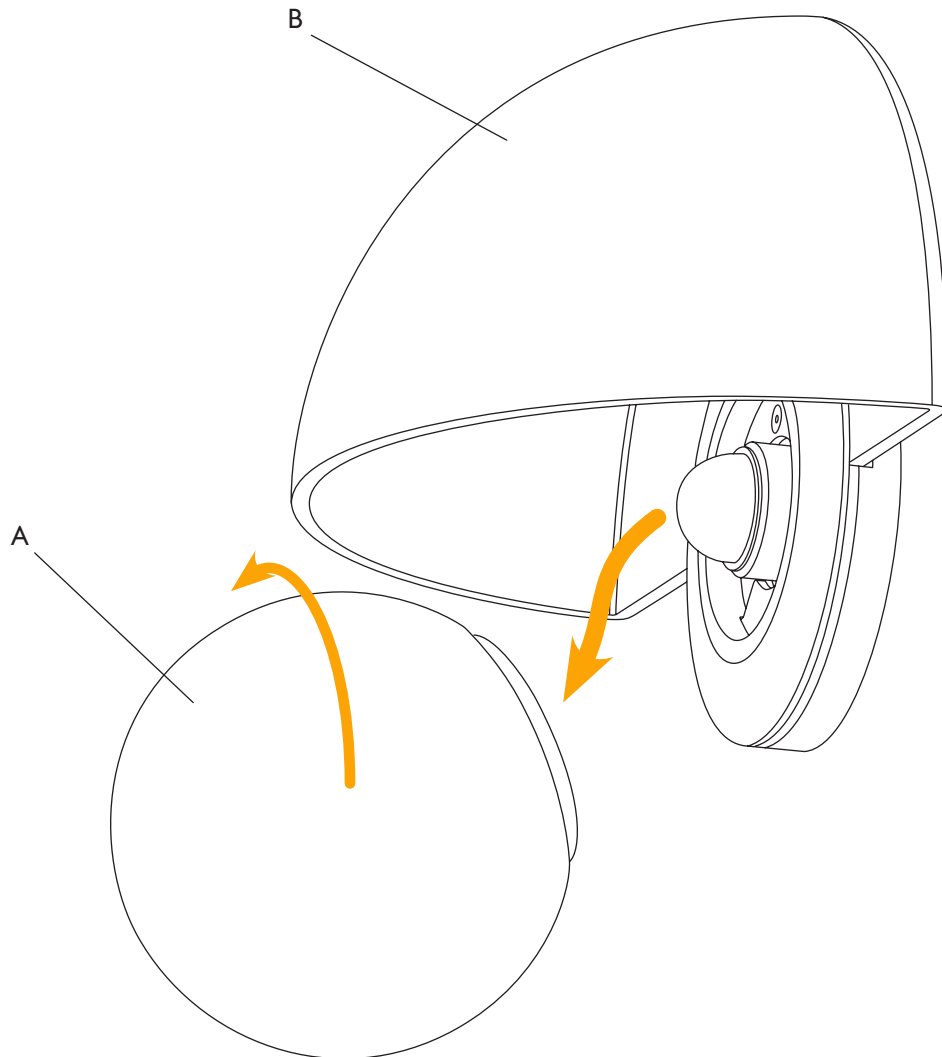

PEARL SCONCE (120V) | INSTALLATION

Note: Please contact a licensed electrician.

02. Take the LED driver (C), and connect the lead wires with the provided 2-port wago (D) from the J-box (E).
03. Optional, make the dimming wire connection (F) with the provided 2-port wago.
04. Fit the LED driver inside the J-box and tuck in the connected wires.

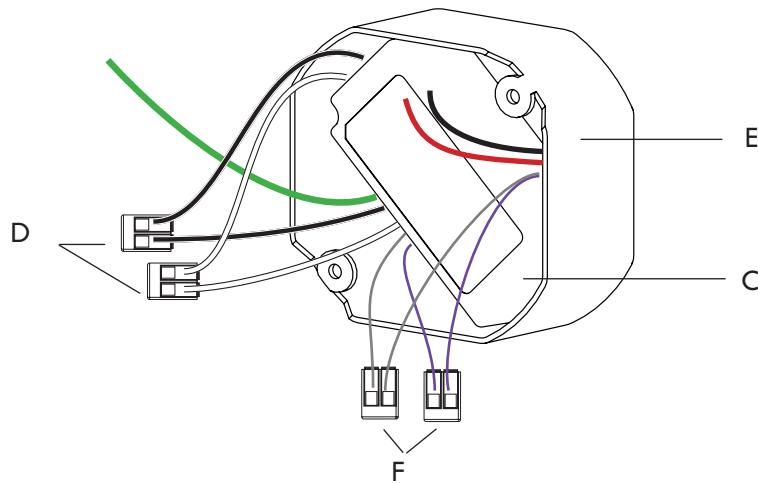

05. Bring the crossbar (F) up to the J-box (E), and make the ground wire connection using the provided 2-port wago (G).
06. Pull the low voltage wires through the cent hole of the crossbar. Then tuck in all the wires into the J-box, and secure the crossbar to J-box with two 8-32 screws (H).

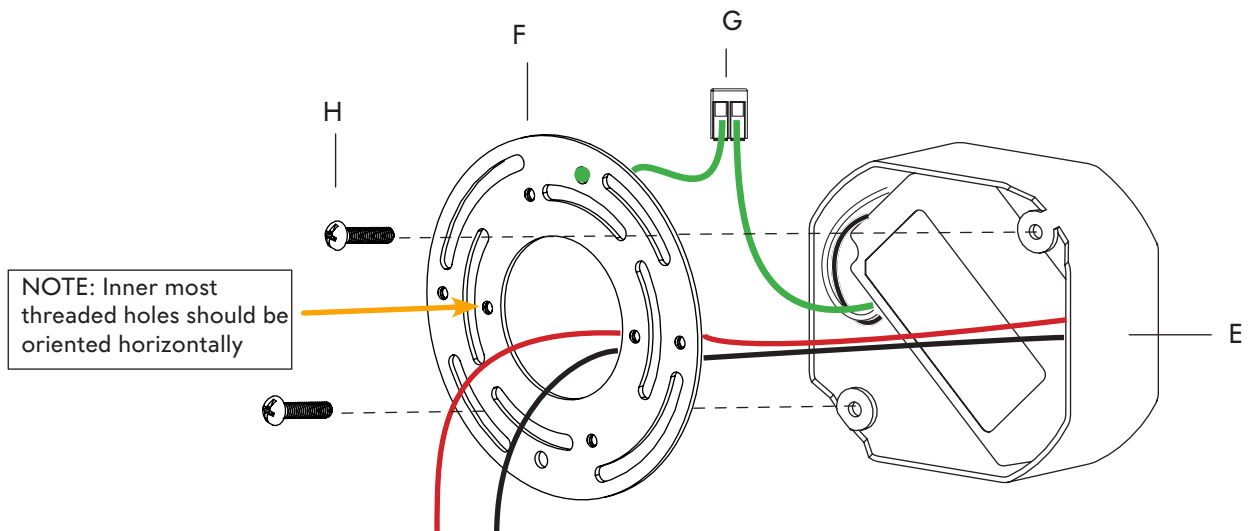

PEARL SCNCE (120V) | INSTALLATION

Note: Please contact a licensed electrician.

07. Bring the sconce (B) up to the J-box (E), and make the low voltage wire connection (I) with the provided 2-port wagos.

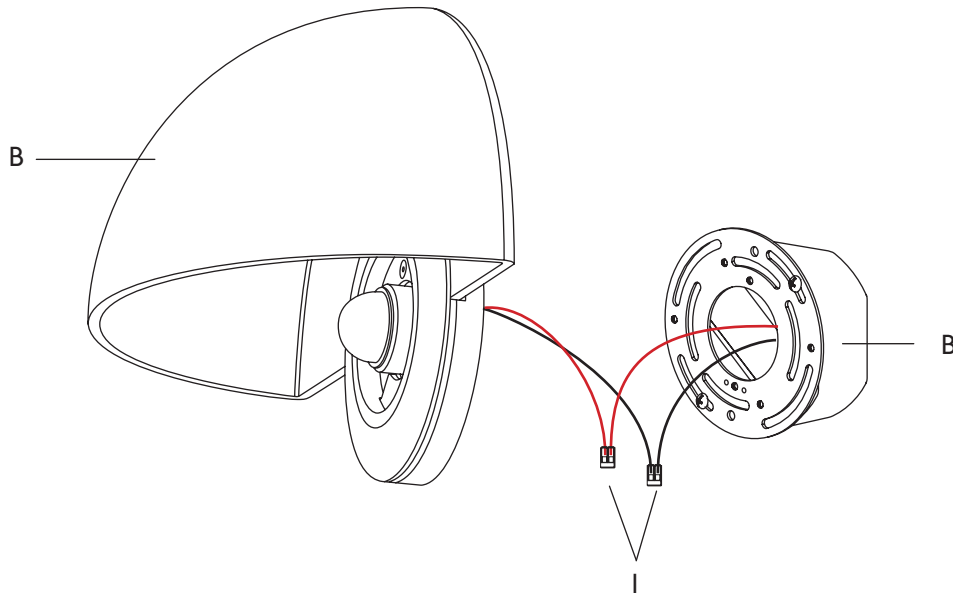

08. Tuck the low voltage wires back into the J-box. Then secure the sconce base (B) to the crossbar (F) with two button head screws (J). Be sure not to pinch any wires.

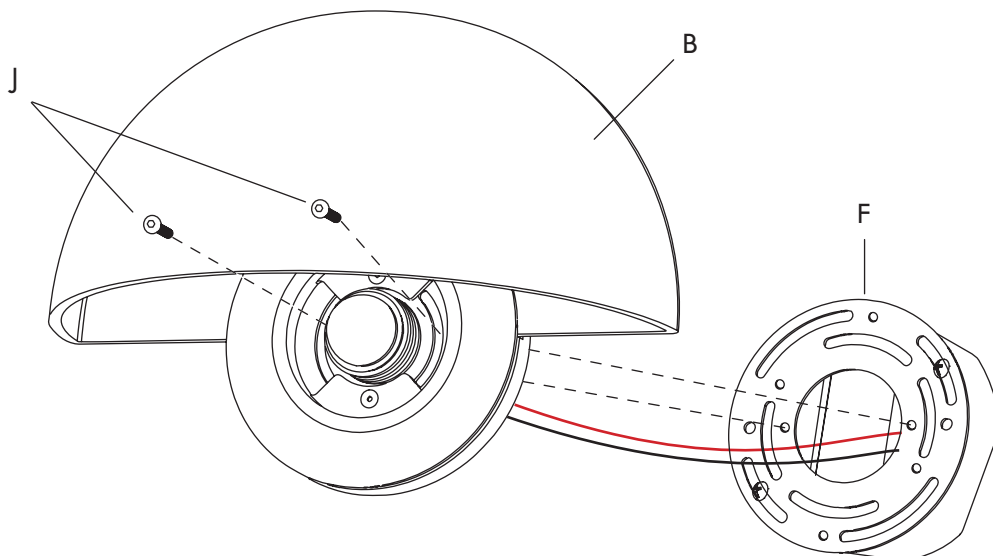

PEARL SCONCE (120V) | INSTALLATION

Note: Please contact a licensed electrician.

09. Fit the glass (A) back onto the sconce base (B) and secure it by screwing it in a clockwise direction.

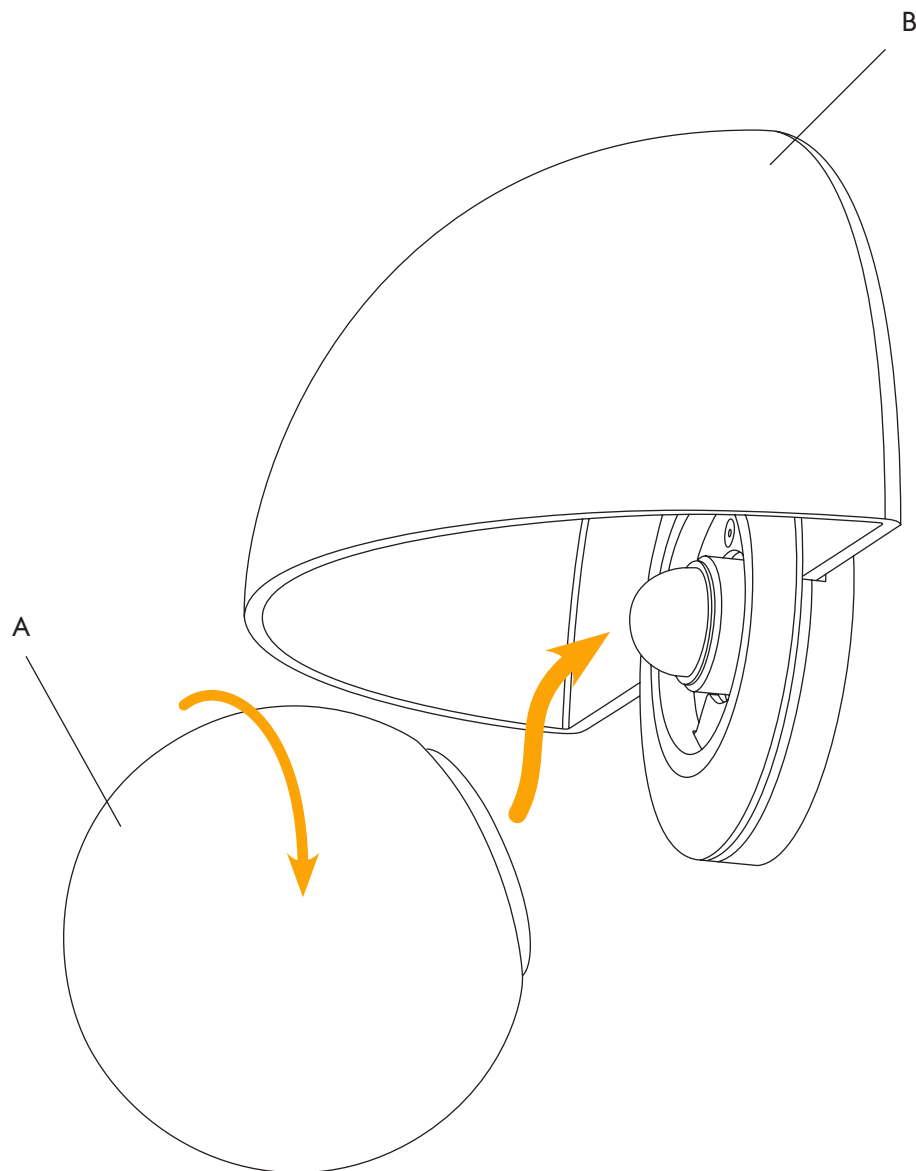

PEARL SCNCE (240V) | INSTALLATION

Note: Please contact a licensed electrician.

01. Unscrew the glass diffuser (A) from the main scone base (B) in a counter clockwise direction.
Then gently slide it out, as there is a very tight clearance.

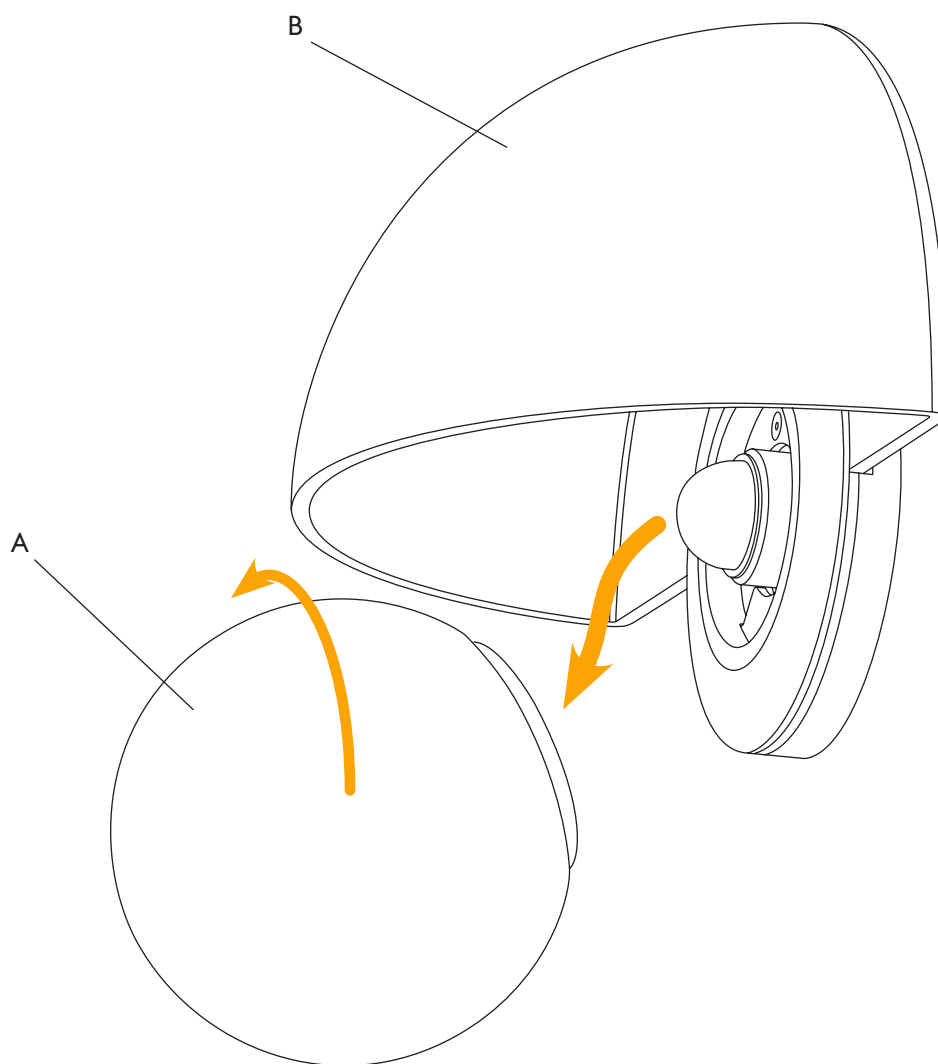

PEARL SCONCE (240V) | INSTALLATION

Note: Please contact a licensed electrician.

02. Unscrew the two button head screws (C) from the main sconce base (B) to release the crossbar with driver box assembly (D) from the back of the fixture.

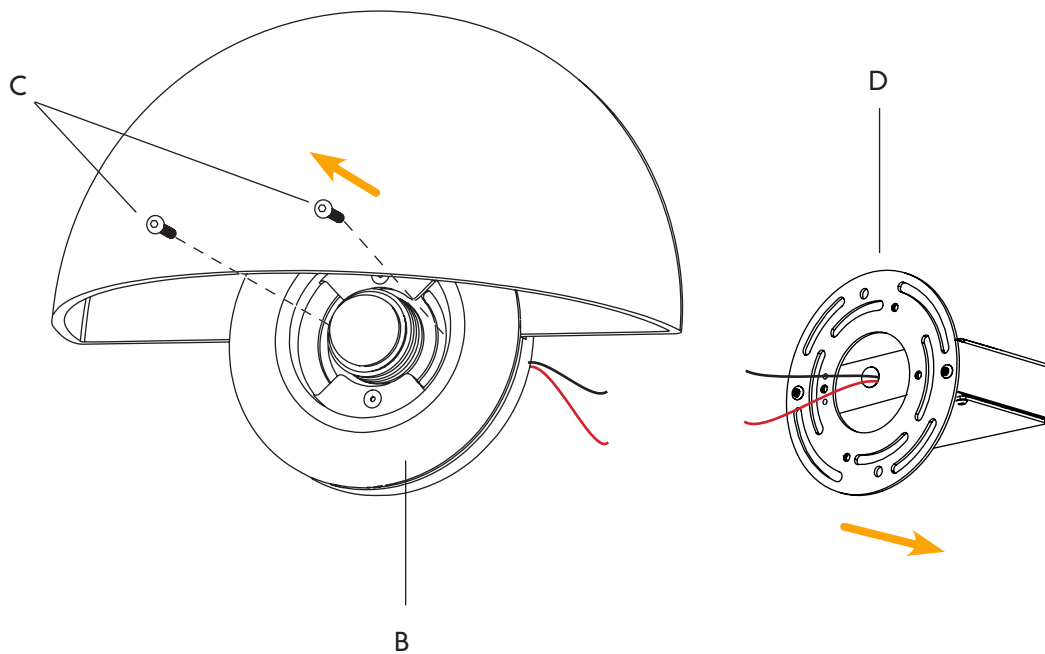

PEARL SCONCE (240V) | INSTALLATION

Note: Please contact a licensed electrician.

03. Connect the lead wires (E) to the power supply wires.
04. Optional: Make the dimming wires connection (F) with the provided 2-port wagos.
05. Mount the crossbar to the wall using the provided 240V screws (G).

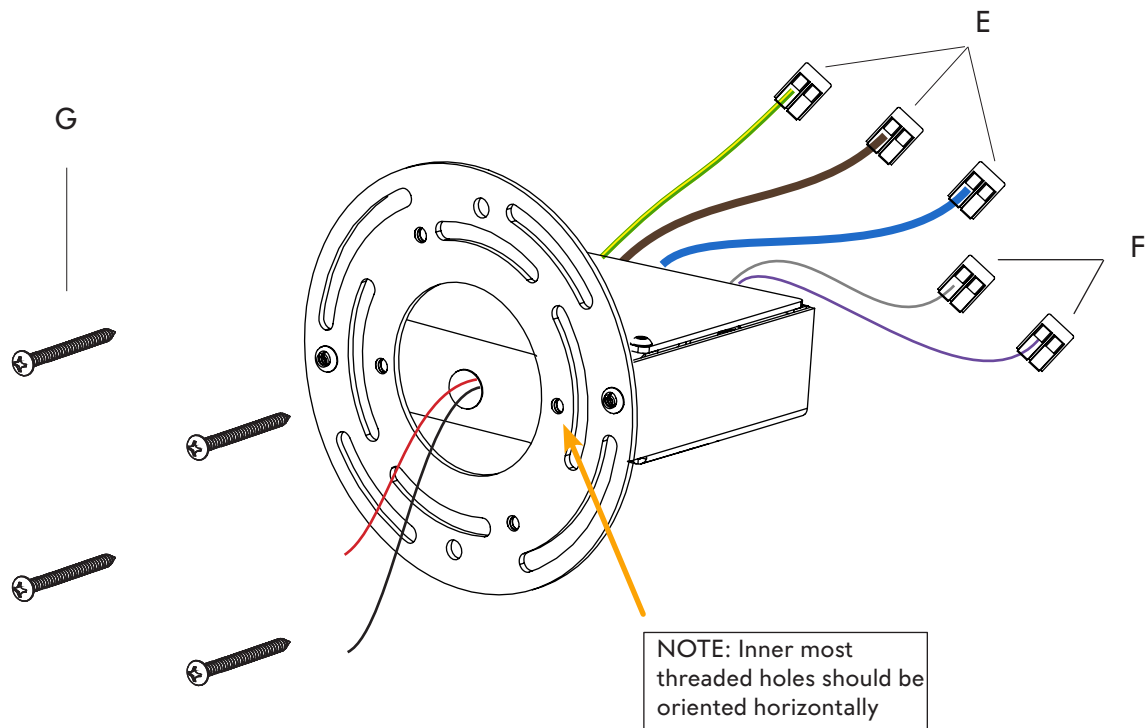

PEARL SCNCE (240V) | INSTALLATION

Note: Please contact a licensed electrician.

06. Bring the sconce base (B) up to the crossbar (D), and make the low voltage wire connection (H) with the provided 2-port wagos. Then tuck in the wires behind the crossbar.

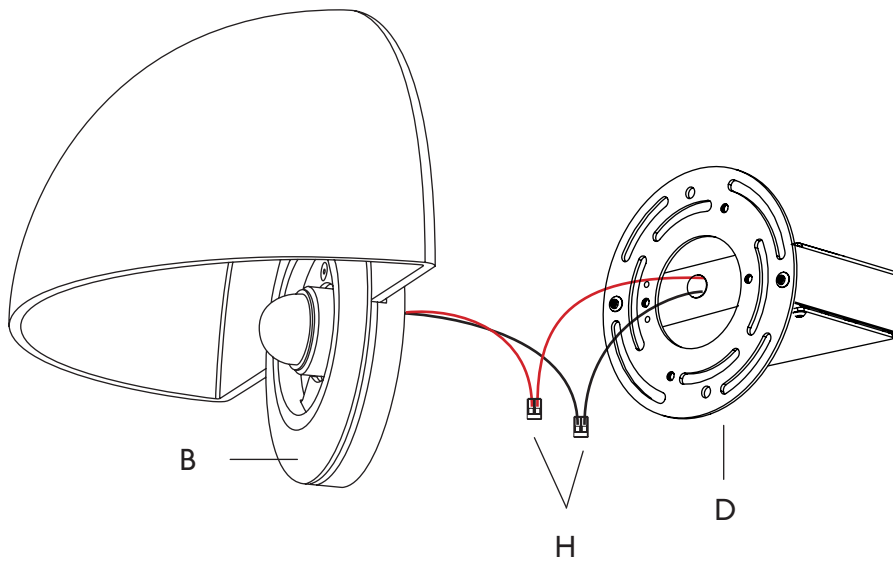

07. Secure the sconce base (B) to the crossbar (D) with two button head screws (C). Be sure not to pinch any wires.

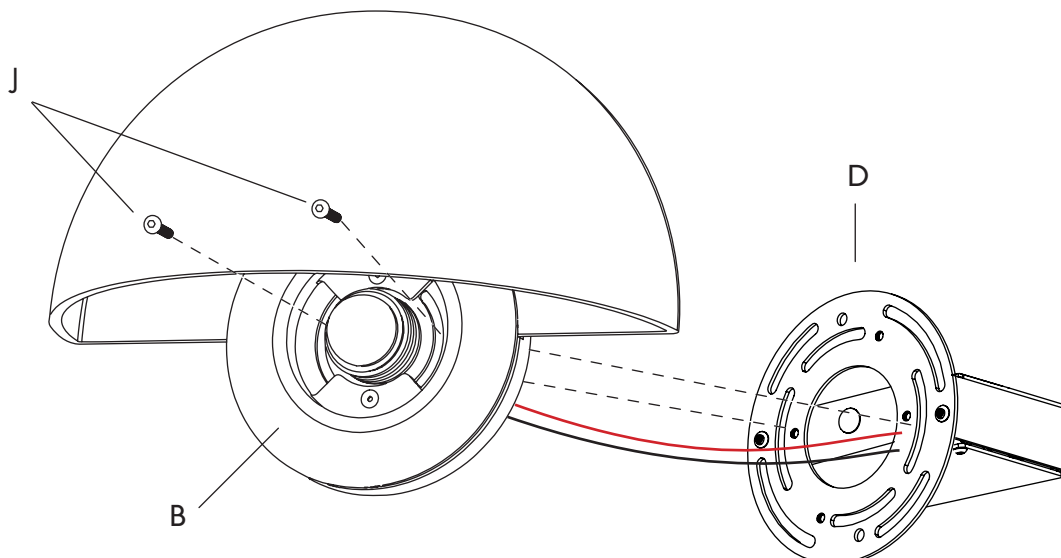

PEARL SCONCE (240V) | INSTALLATION

Note: Please contact a licensed electrician.

08. Fit the glass (A) back onto the sconce base (B) and secure it by screwing it in a clockwise direction.

