

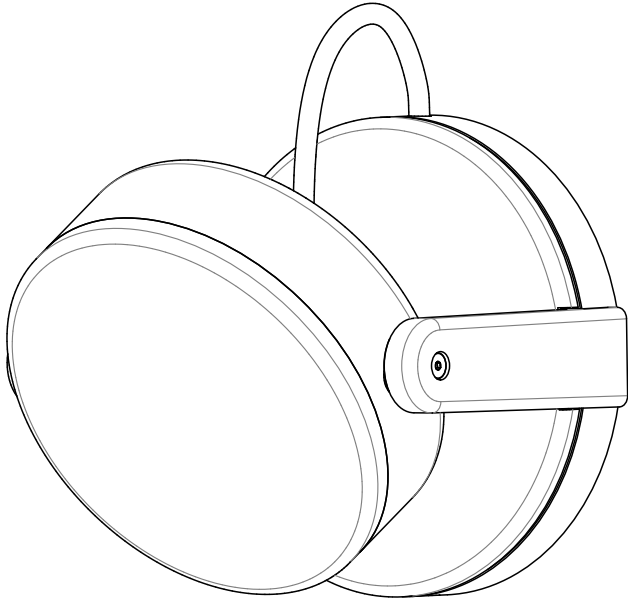

# Monocle Touch 12685 rA

AC Input



## CAUTION:

Before starting, turn off power at main circuit panel.

## ADVERTENCIA:

Antes de comenzar la instalación, apague la corriente en el tablero principal.

## ATTENTION:

Coupez l'alimentation avant de procéder à l'installation.



Calling for backup? Scan above to contact our team.

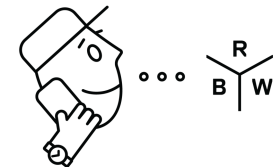
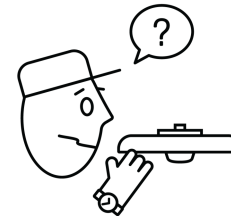

[www.RBW.com](http://www.RBW.com)

+1 212 388 1621

[support@RBW.com](mailto:support@RBW.com)

© RBW Studio LLC, 2013, 2020

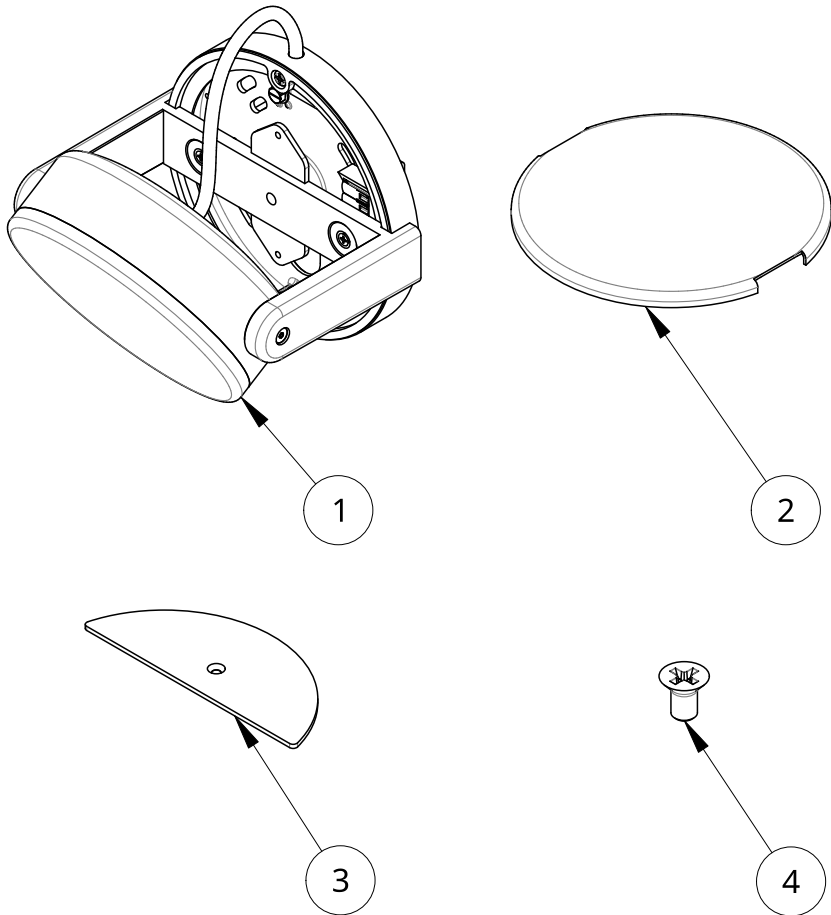

Item	Qty	Part number	Description
1	1	12680-PC20	Monocle Touch Assembly PC20
2	1	12309-PC20	Rotary Base PC20
3	2	12333	Wire Cover
4	2	90471A205	#6-32 x 1/4" Flat head (82) machine screw SS

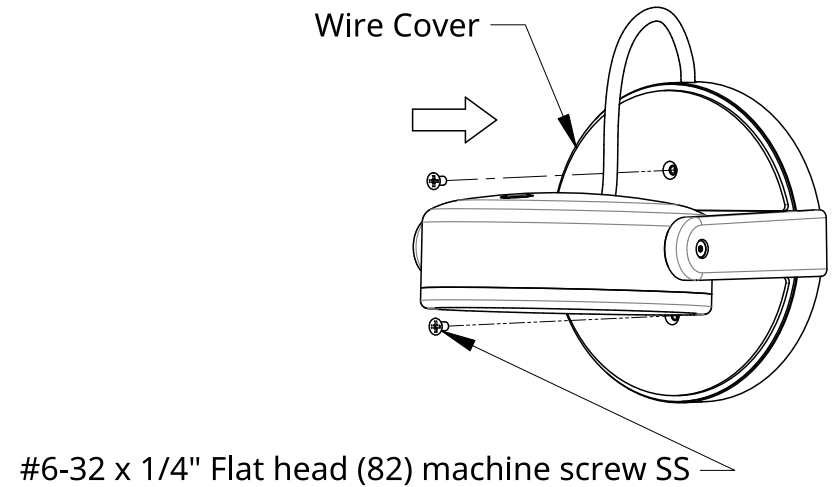
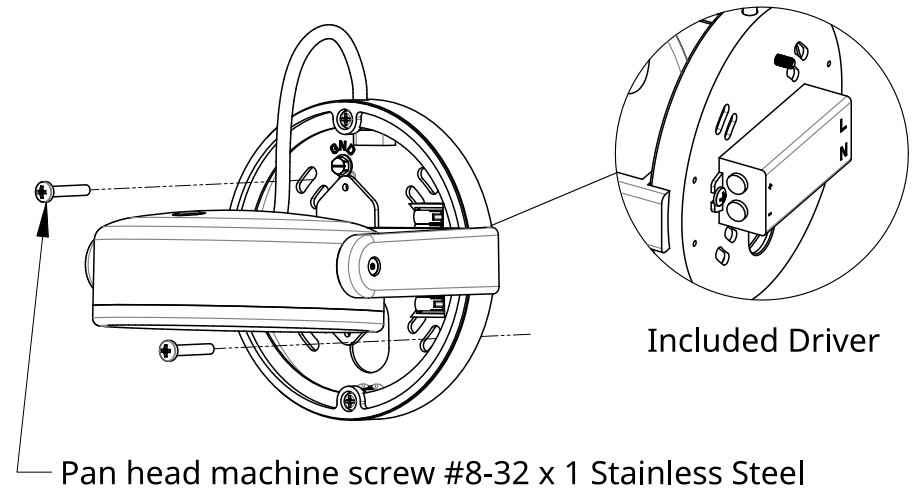

#### Installation - Monocle Touch Assembly

1. Connect Driver leads from Monocle Touch Assembly Driver to mains voltage.
2. Fasten Monocle Touch Assembly to desired mounting location using #8-32 Pan Head Screws.
3. Place Wire Covers on Monocle Touch Assembly.
4. Secure Wire Covers by fastening #6-32 Flat Head Screws.

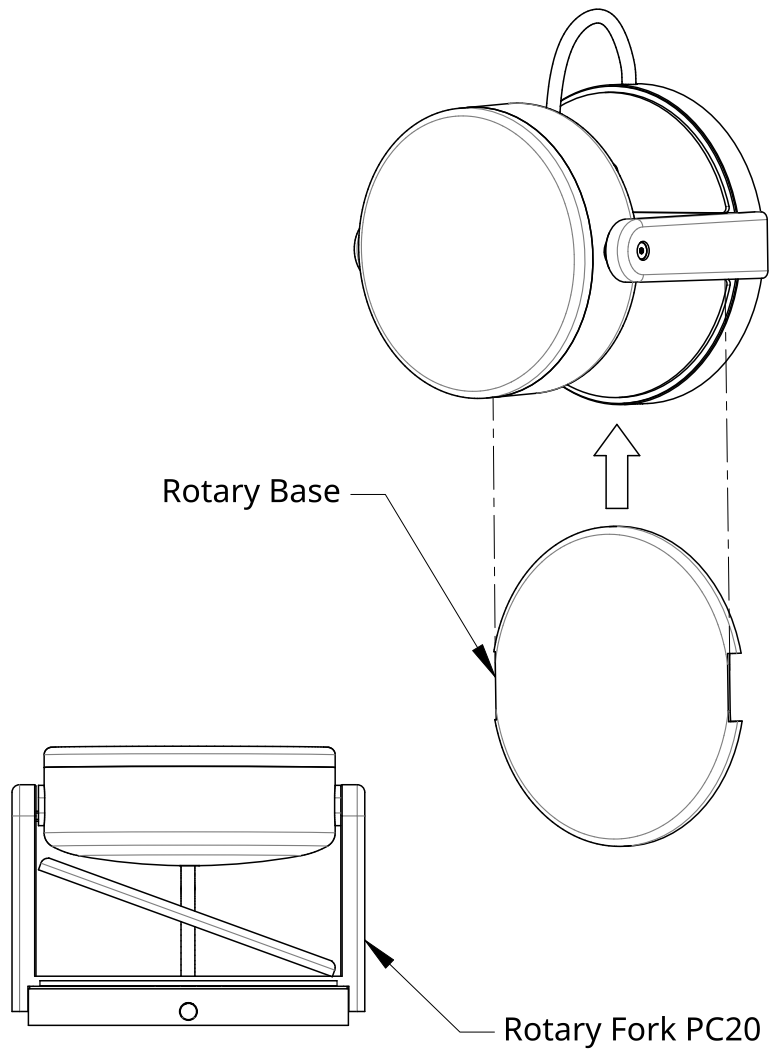

Page intentionally left blank

### Installation - Rotary Base

1. Insert Rotary Base between Rotary Fork on an angle so notches are aligned with Rotary Fork.
2. Rotary Base will connect magnetically, then remove stickers from interior of Fork.
3. Congratulations! End of guide.