

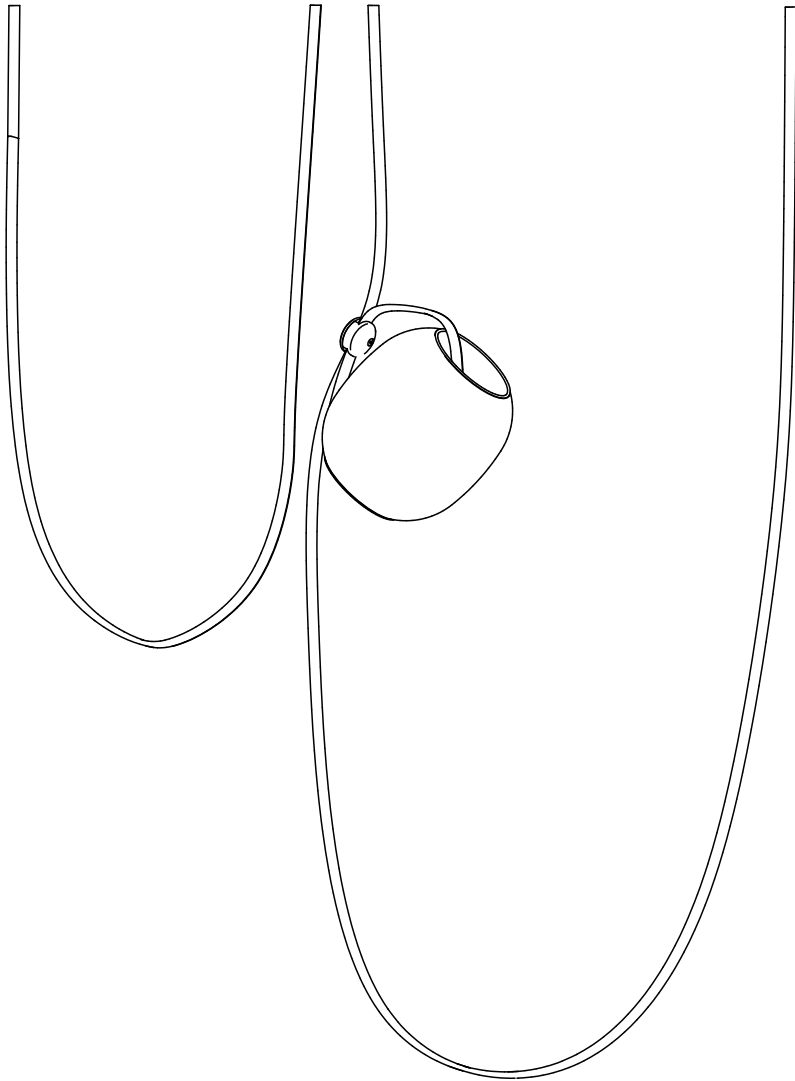

Vitis 7

13090 rB

Low Voltage Input



CAUTION:

Before starting, turn off power at main circuit panel.

ADVERTENCIA:

Antes de comenzar la instalación, apague la corriente en el tablero principal.

ATTENTION:

Coupez l'alimentation avant de procéder à l'installation.



Calling for backup? Scan above to contact our team.

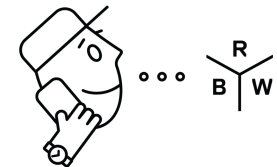

www.RBW.com

+1 212 388 1621

support@RBW.com

© RBW Studio LLC, 2013, 2020

* BOM for Item 2 on page 3

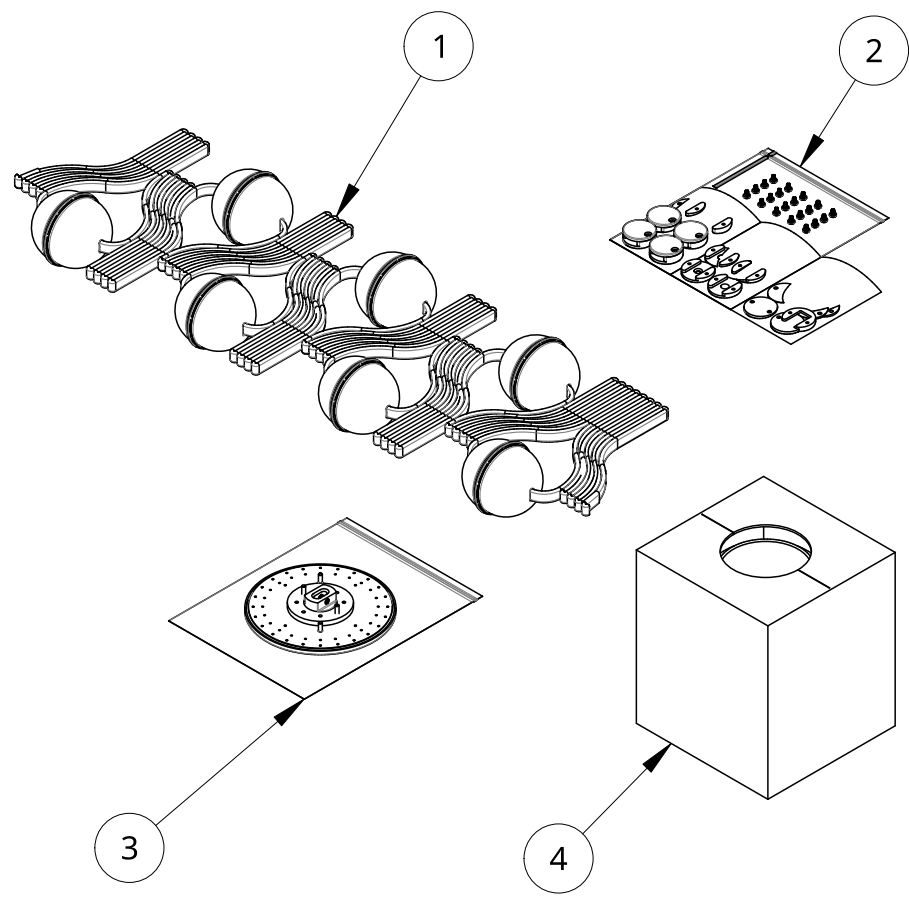

| Item | Qty | Part number | Description |
|------|-----|-------------|------------------------------|
| 1 | 1 | 13015 | Vitis 7 Module Assembly |
| 2 | 1 | 11664 | Vitis 7 Cord Grip Components |
| 3 | 1 | 11660 | Vitis Canopy Packaging |
| 4 | 7 | 13002 | Vitis Glass Box |

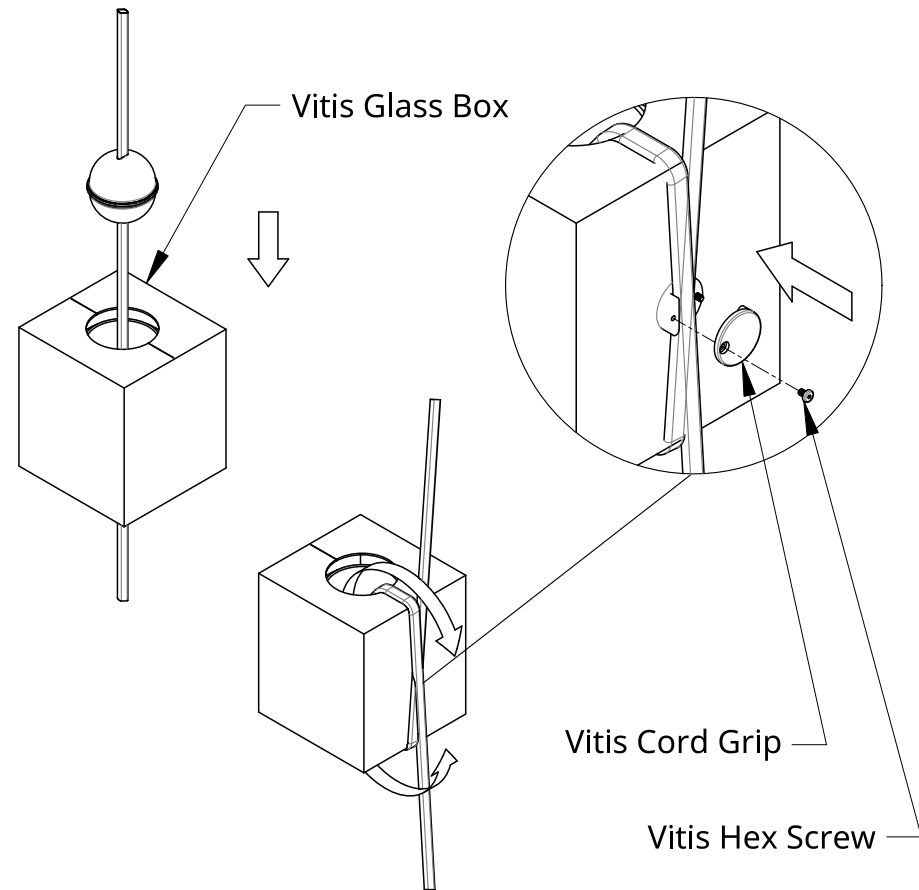

Installation - Glass Assembly in Box

- 1. Remove perforated circles from Glass Assembly Box.
- 2. Starting from one end, feed Vitis Power Cord through Glass Assembly in Box until Glass is centered over Module Assembly.
- 3. Fold Vitis Power Cord sections over edge of Glass Box and overlap Cords.
- 4. Use 2 Vitis Cord Grip parts and 2 Vitis Hex Screws to secure overlapping Cords.
- 5. Before fully securing Cord Grips, pull Power Cord's tight to the Glass Box.

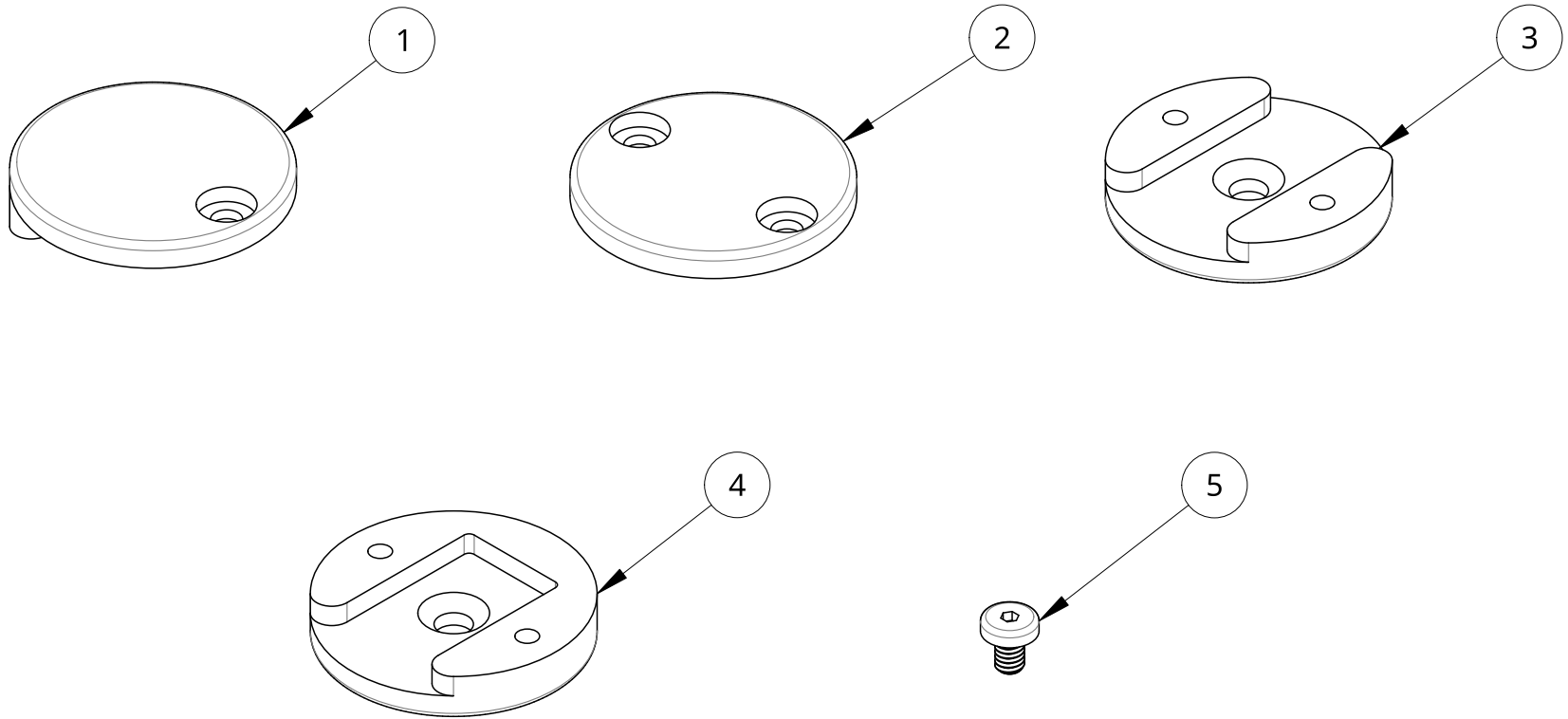

| Item | Qty | Part number | Description |
|------|-----|-------------|-------------------------------|
| 1 | 14 | 12004-XXXX | Vitis Cord Grip |
| 2 | 8 | 12009-XXXX | Vitis Cord Grip Ceiling Cover |
| 3 | 7 | 12005-XXXX | Vitis Cord Grip Ceiling |
| 4 | 1 | 12001-XXXX | Vitis Cord Grip End |
| 5 | 30 | 11644-XXXX | Vitis Hex Screw |

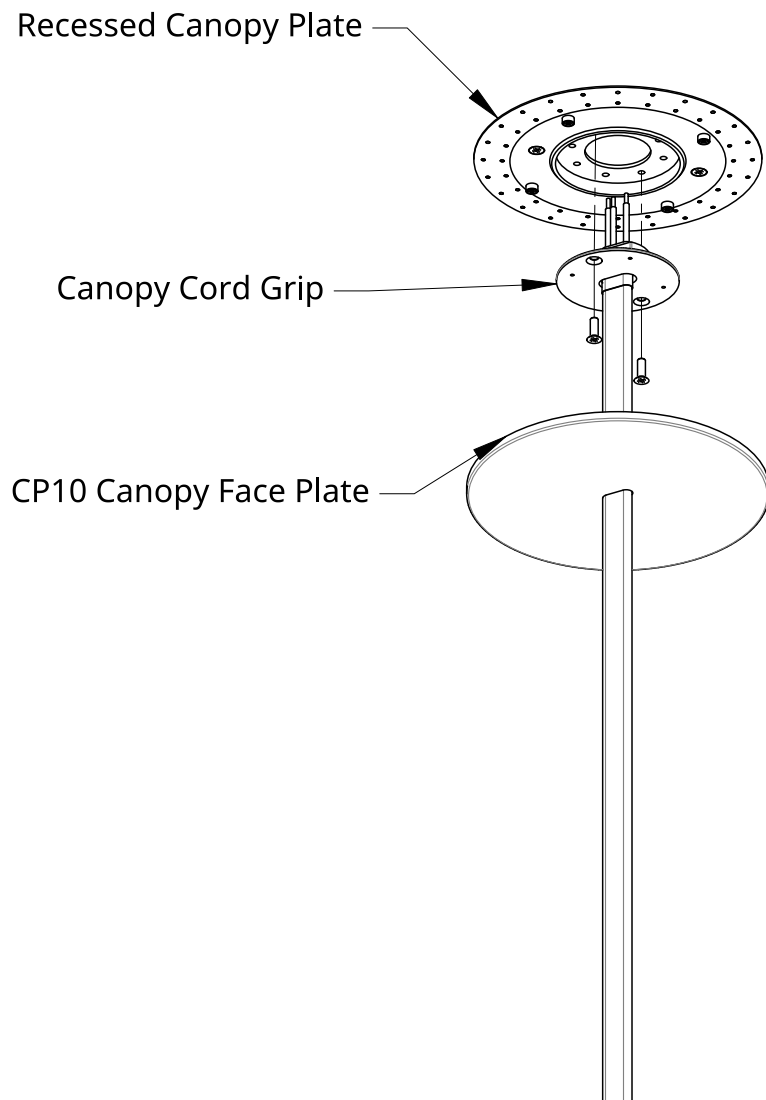

Installation - Canopy

1. Refer to Canopy Instructions Sheet.

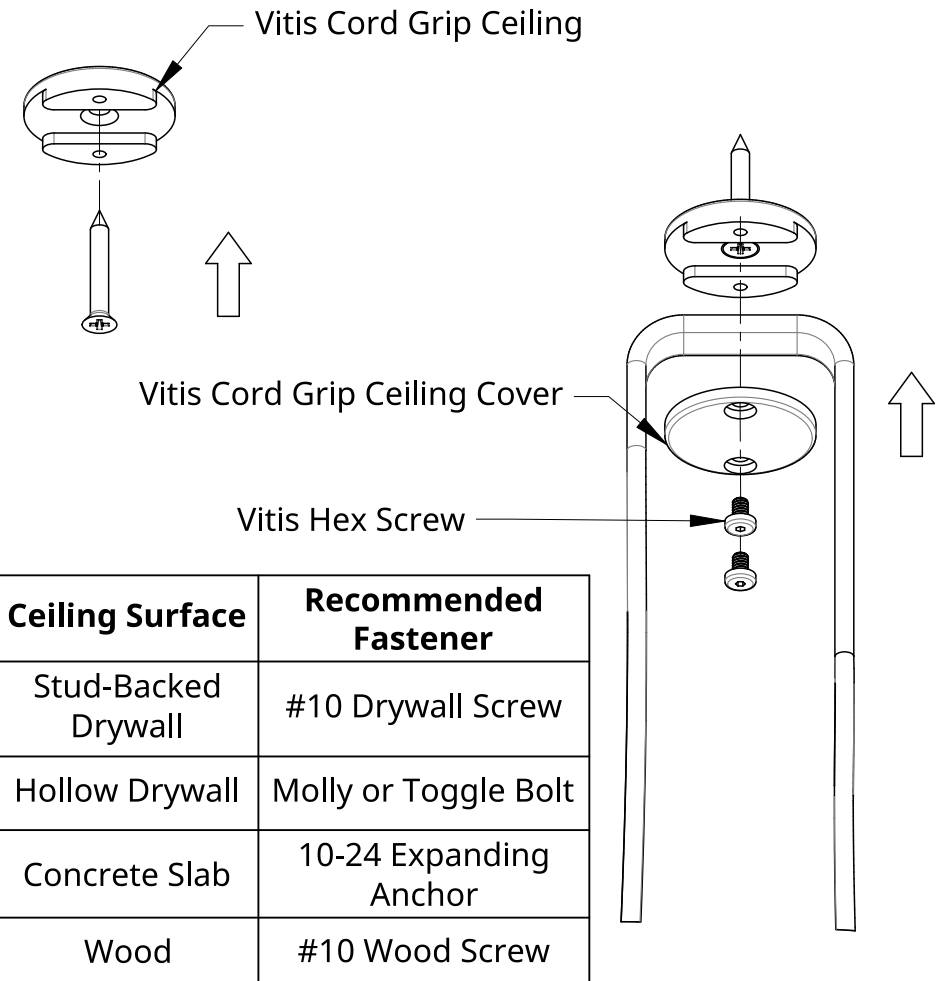

Installation - Cord Grip

1. Depending on your mounting surface, use an appropriate fastener to secure Vitis Cord Grip Ceiling to desired location.
2. Place Vitis Cord in Cord Grip channel and place Cord Grip Ceiling Cover on top.
3. Using 2 Vitis Hex Screws, fasten the two Cord Grip pieces together to secure the Vitis Cord.
4. Repeat this process until desired configuration is achieved.

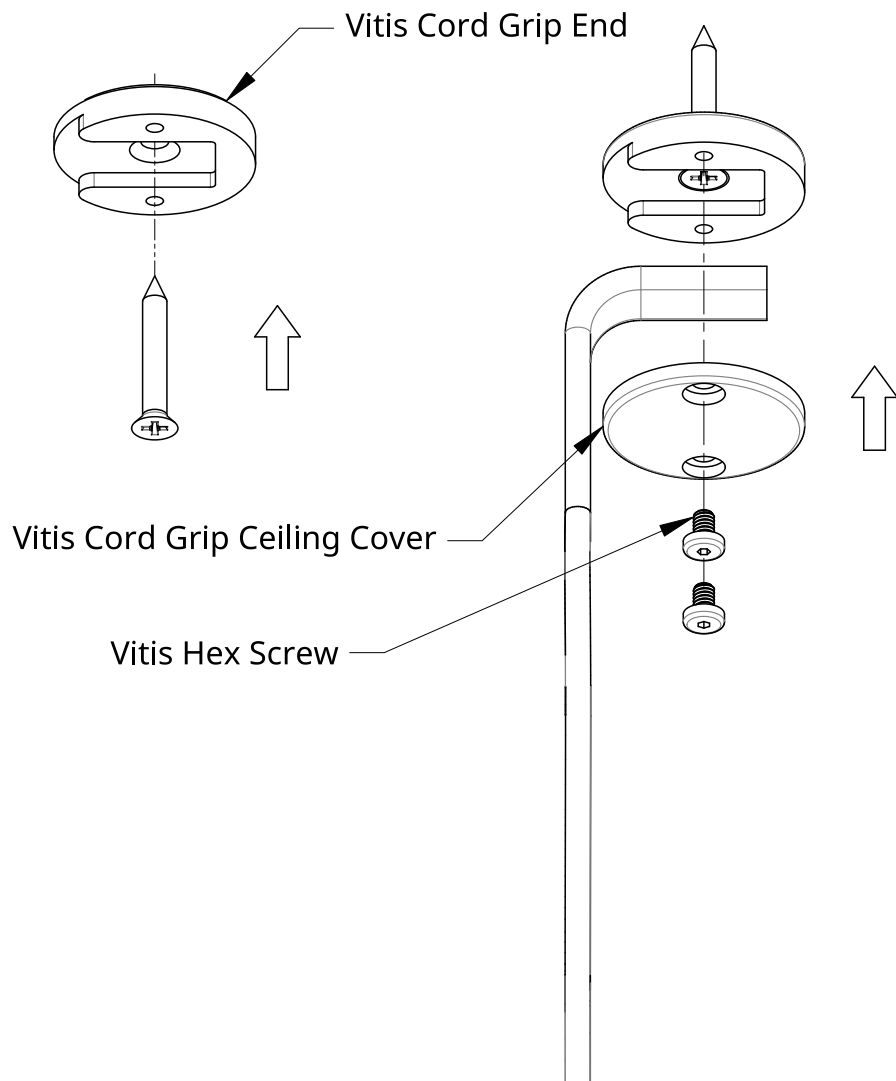

Installation - Cord Grip End

1. Repeat previous Cord Grip steps.

Refer to Vitis configuration drawings for all Vitis orientations.

