

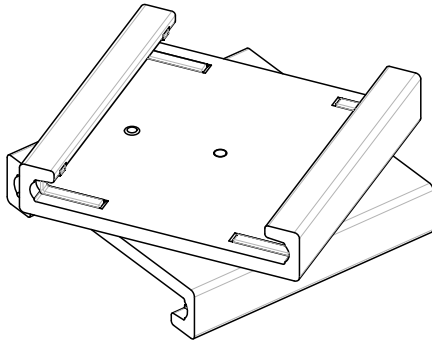

# Latis Angle Connector

rA



# Latis Sliding Hang Point

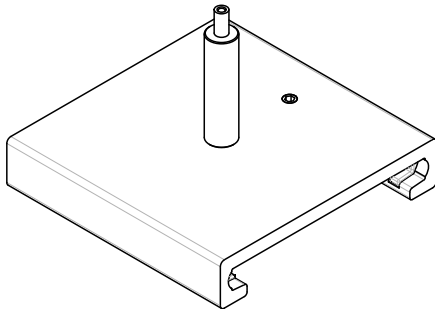

## CAUTION:

Before starting, turn off power at main circuit panel.

## ADVERTENCIA:

Antes de comenzar la instalación, apague la corriente en el tablero principal.

## ATTENTION:

Coupez l'alimentation avant de procéder à l'installation.

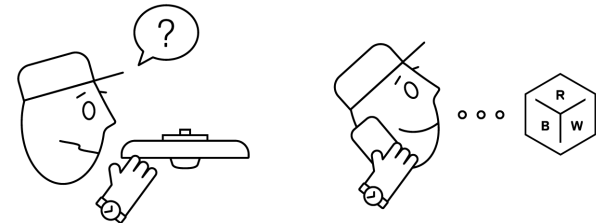

[www.RBW.com](http://www.RBW.com)  
+1 212 388 1621  
[support@RBW.com](mailto:support@RBW.com)

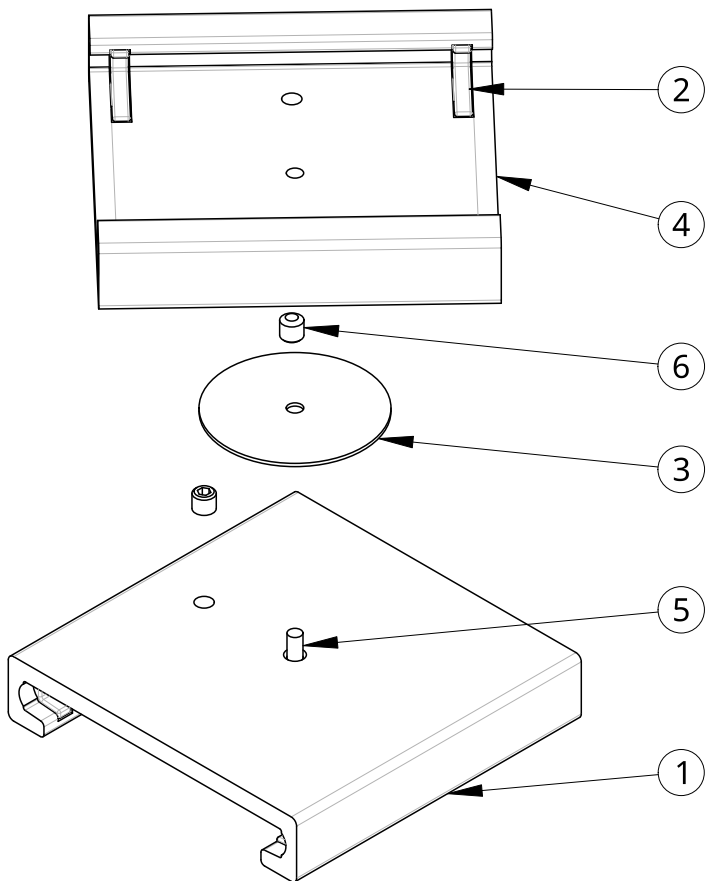

### ANGLE CONNECTOR

Item No.	Qty	Part number	Description
1	1	10111	Latis Connector Bottom
2	8	10112	Latis Sliding Bumper
3	1	10114	Latis Connector Washer
4	1	10110	Latis Connector Top
5	1	G2AE-125-0375-5 00-00-000	Groov-Pin type 2A 1/8" x 3/8" 303 SS pin
6	2	94355A328	Flat-Tip Set Screws, 10-32 x 3/16"

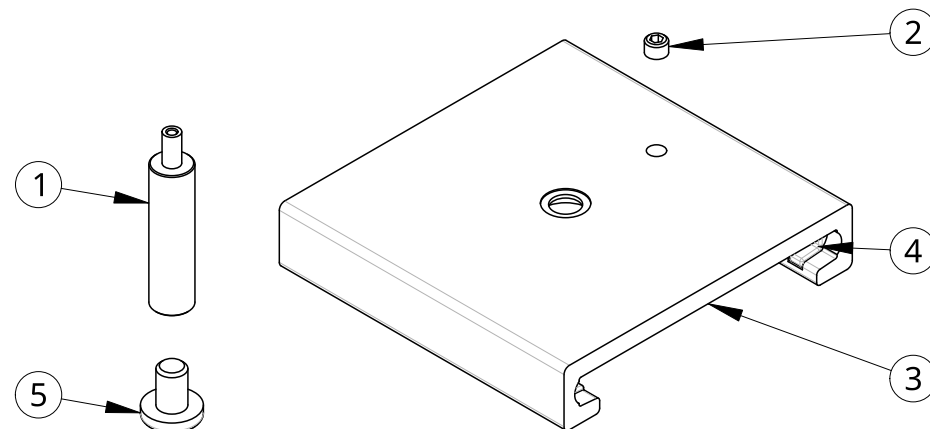

### SLIDING HANG POINT

Item No.	Qty	Part number	Description
1	1	11244	Cable grip for 3/64" – 1/16" cable only
2	1	92785A3 30	Cone-Point Set Screws 10-32 x 3/16" SS 18-8
3	1	10113	Latis Sliding Hang Point
4	4	10112	Latis Sliding Bumper
5	1	91772A5 35	Pan Head Phillips Screw, 1/4"-20 x 3/8" SS 18-8

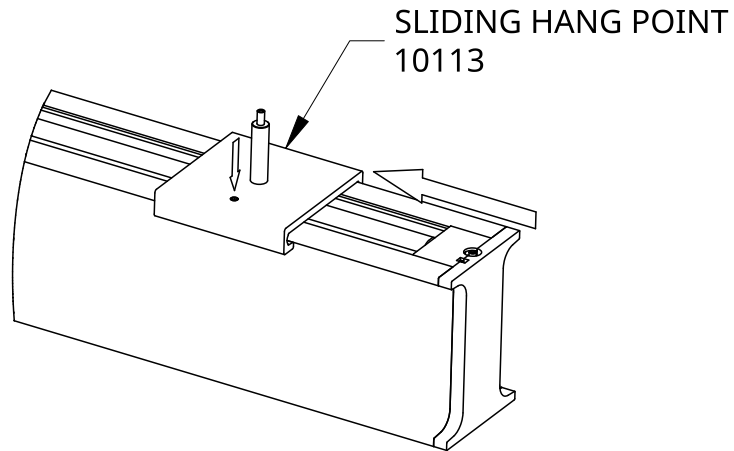

Page Intentionally Left Blank

#### Optional Installation - SLIDING HANG POINT

1. Before hanging fixture attach the sliding Hang Point onto fixture.
2. Tighten set screw to affix.
3. Install fixture with the Sliding Hang Point in the desired location.
4. Congratulations! End of guide.

ANGLE CONNECTOR BOTTOM  
10111

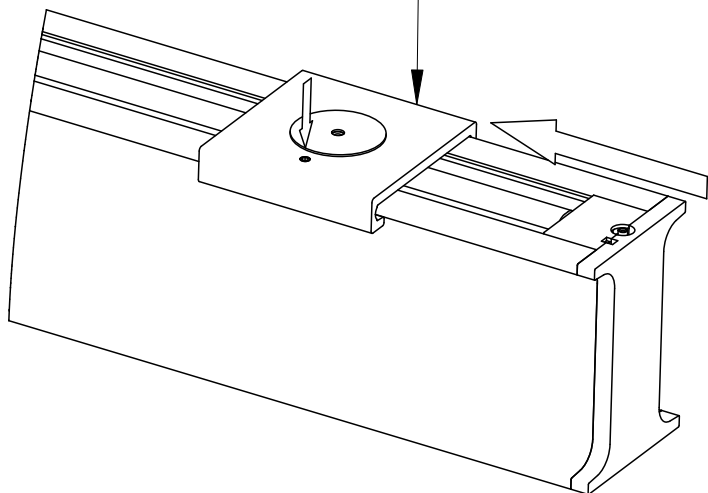

ANGLE CONNECTOR TOP  
10110

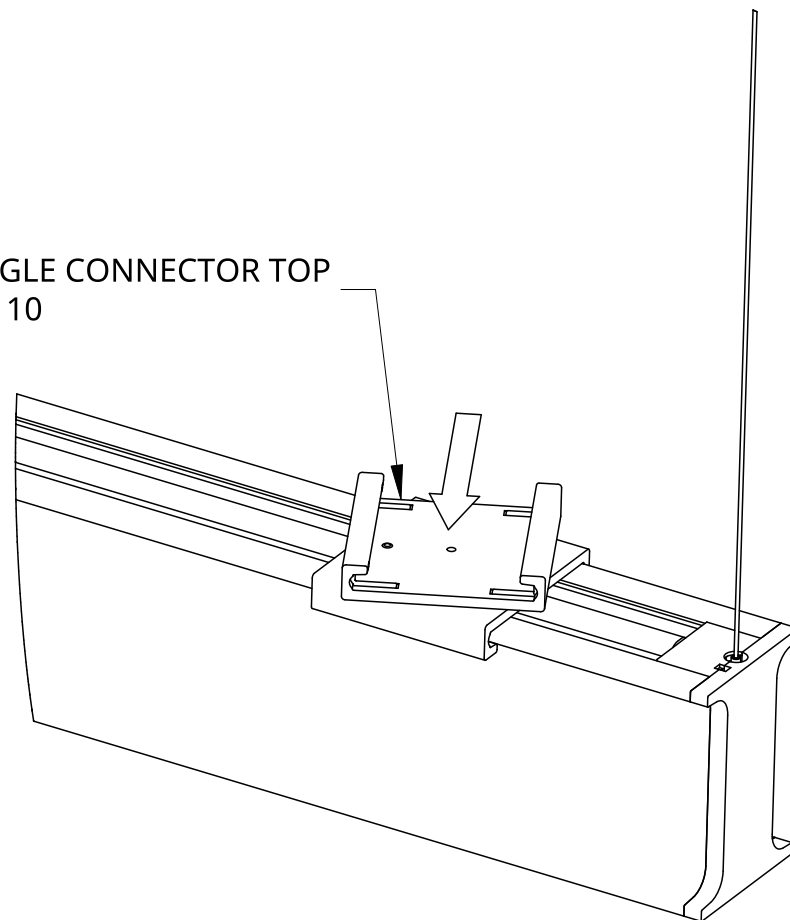

#### Optional Installation - ANGLE CONNECTOR

1. Before hanging luminaire, slide Angle Connector Bottom onto lower of 2 luminaires in the stack.
2. Tighten set screw to affix.
3. Proceed to Luminaire Hanging Instructions for lower of 2 luminaires in the stack.

1. Proceed to Luminaire hanging instructions for upper of 2 luminaire.
2. Attach Angle Connector Top onto lower luminaire.
3. Slide upper luminaire into Angle Connector Top.
4. Congratulations! End of guide.