

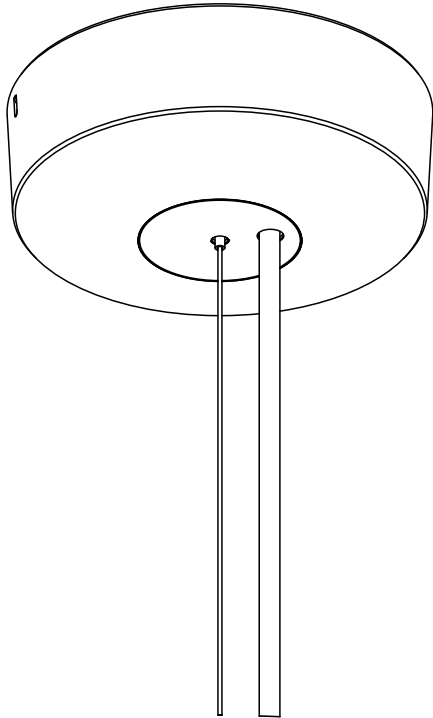

# Deep Canopy

13163 rB

Single Cable Suspension



## CAUTION:

Before starting, turn off power at main circuit panel.

## ADVERTENCIA:

Antes de comenzar la instalación, apague la corriente en el tablero principal.

## ATTENTION:

Coupez l'alimentation avant de procéder à l'installation.



Calling for backup? Scan above to contact our team.

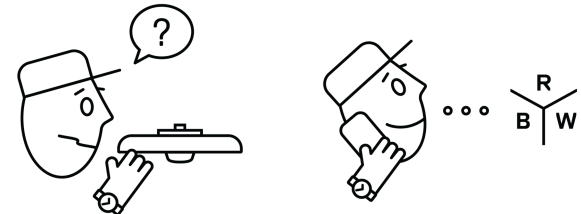

[www.RBW.com](http://www.RBW.com)

+1 212 388 0399

[support@RBW.com](mailto:support@RBW.com)

© RBW Studio LLC, 2013, 2020

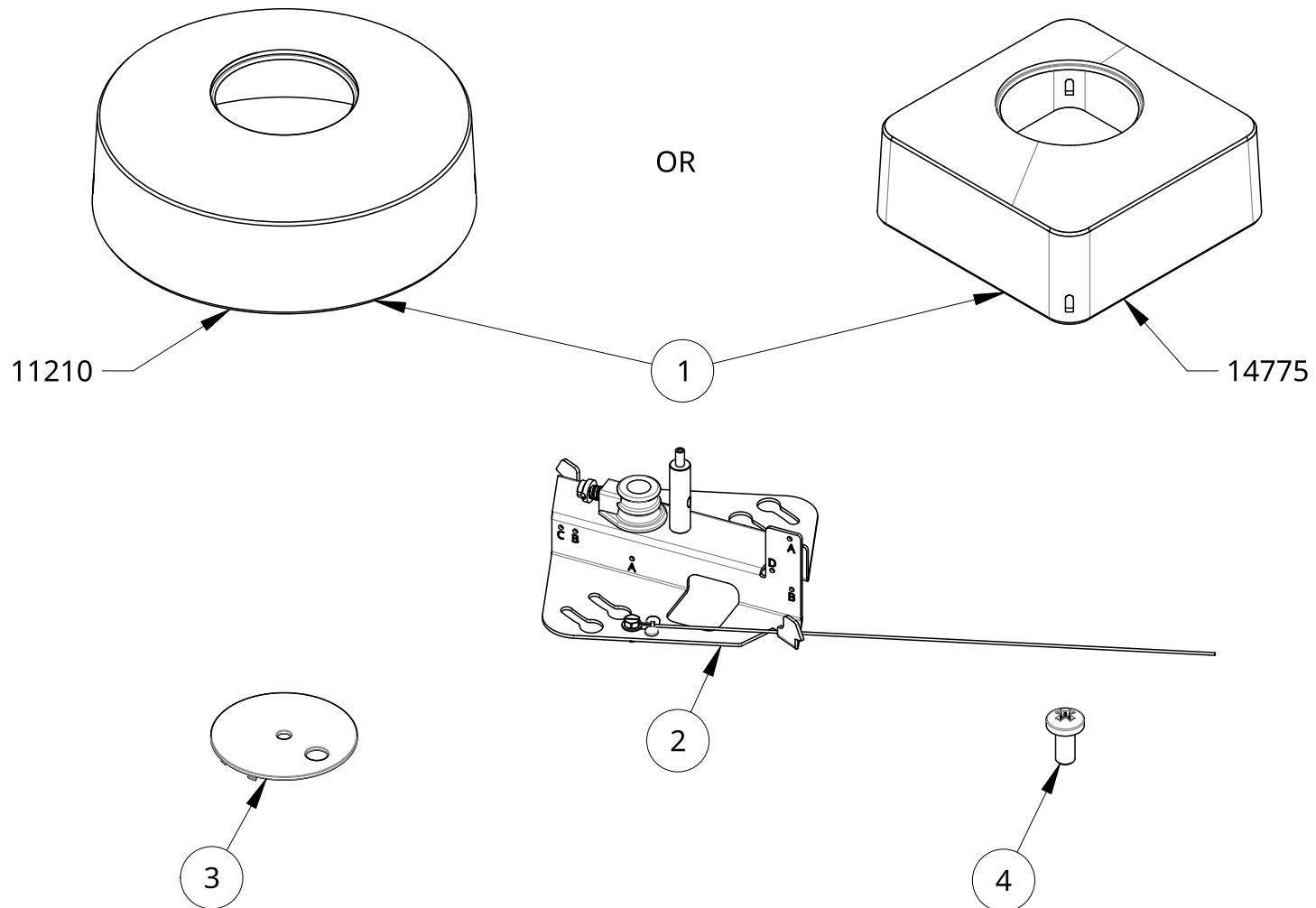

Item	Qty	Part number	Description
1	1	11210	Round Deep Canopy. Matte White
2	1	14230	Assembly: Deep Canopy. Single Cable Suspension
3	1	12671	Canopy: Single Cable Cover. White
4	4	90272A106	#4-40 x 1/4" ZCS Pan Head Phillips

\* If provided driver does not fit in canopy, it must be installed in an external location

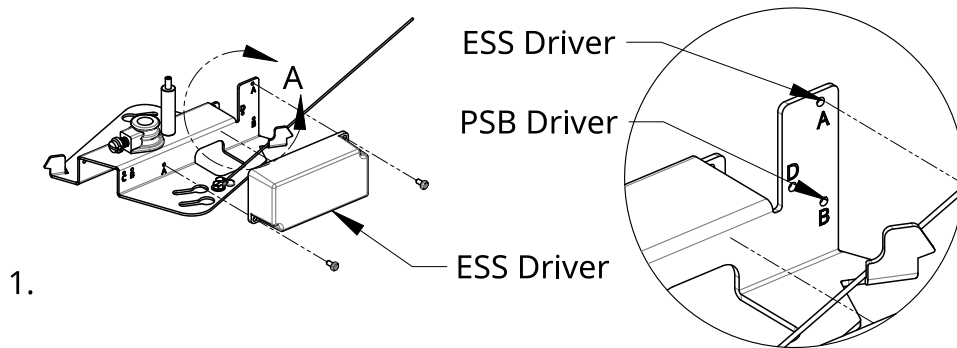
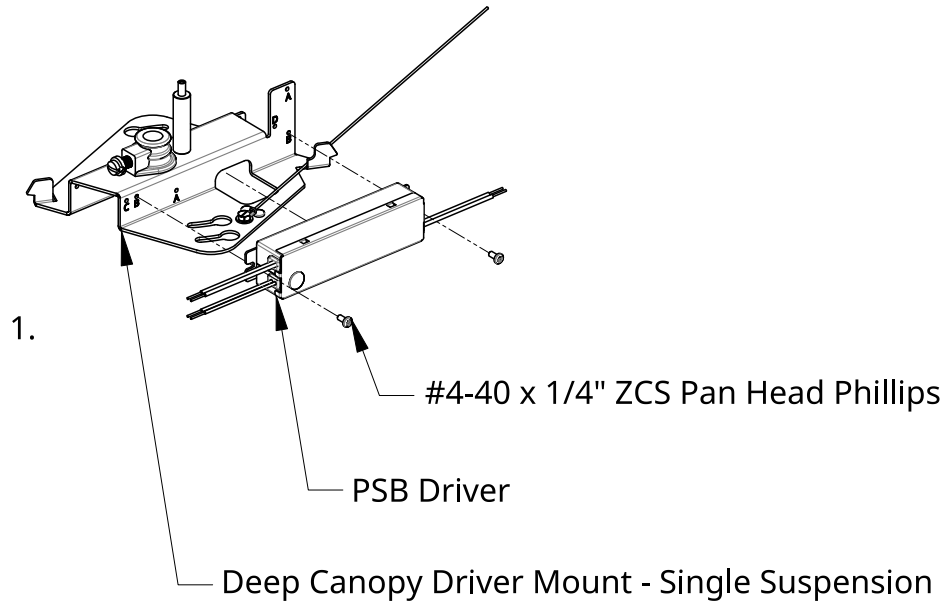

### Installation - Driver

1. Fasten included driver to corresponding hole pattern in Driver Mount with #4-40 x 1/4" Pan Head Screws.

\* Measure approximate hang height, add 3 inches and trim cable and power feed before step 6.

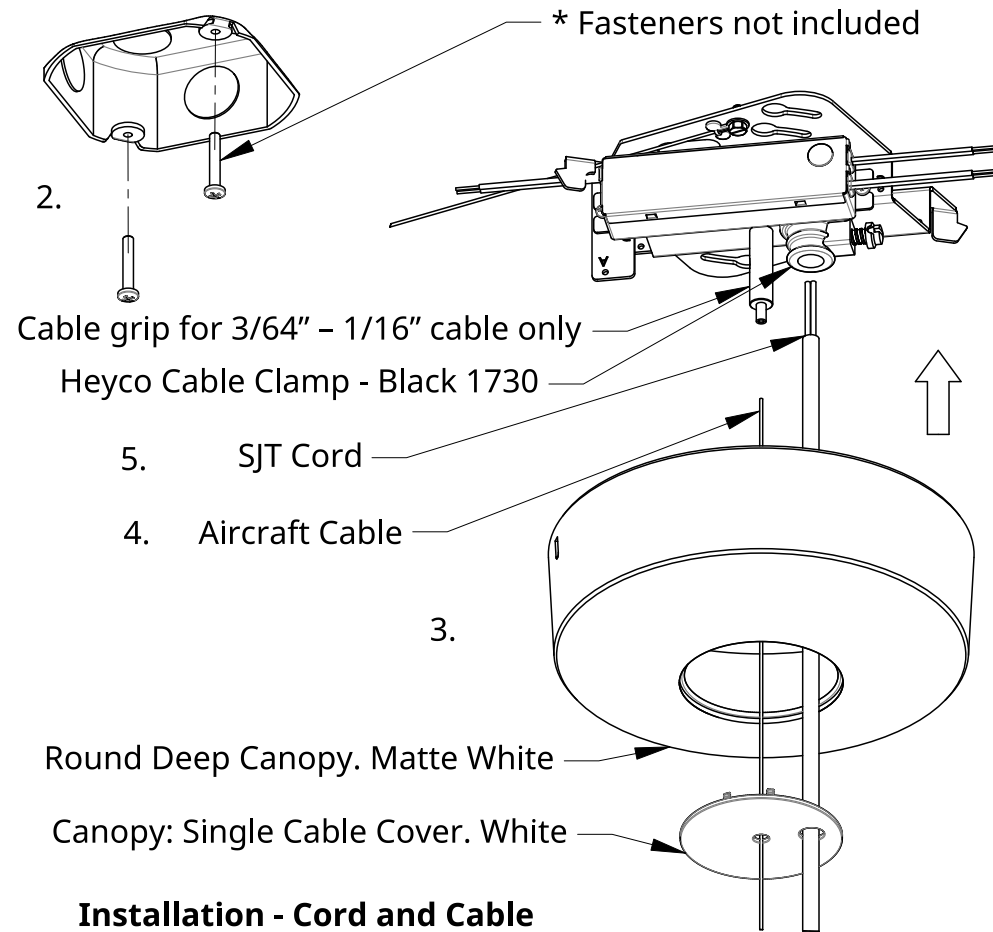

### Installation - Cord and Cable

2. Attach appropriate fasteners to desired mounting location leaving enough clearance to secure Driver Mount.
3. Pass product Power Feed and Aircraft Cable through Single Cable Cover and Round Deep Canopy.
4. Feed Aircraft Cable through Cable Grip and adjust to desired length.
5. Insert Power Cord into Heyco Cable Clamp and tighten Cable Clamp at desired length.

\* Driver Mount installation requires 2 people

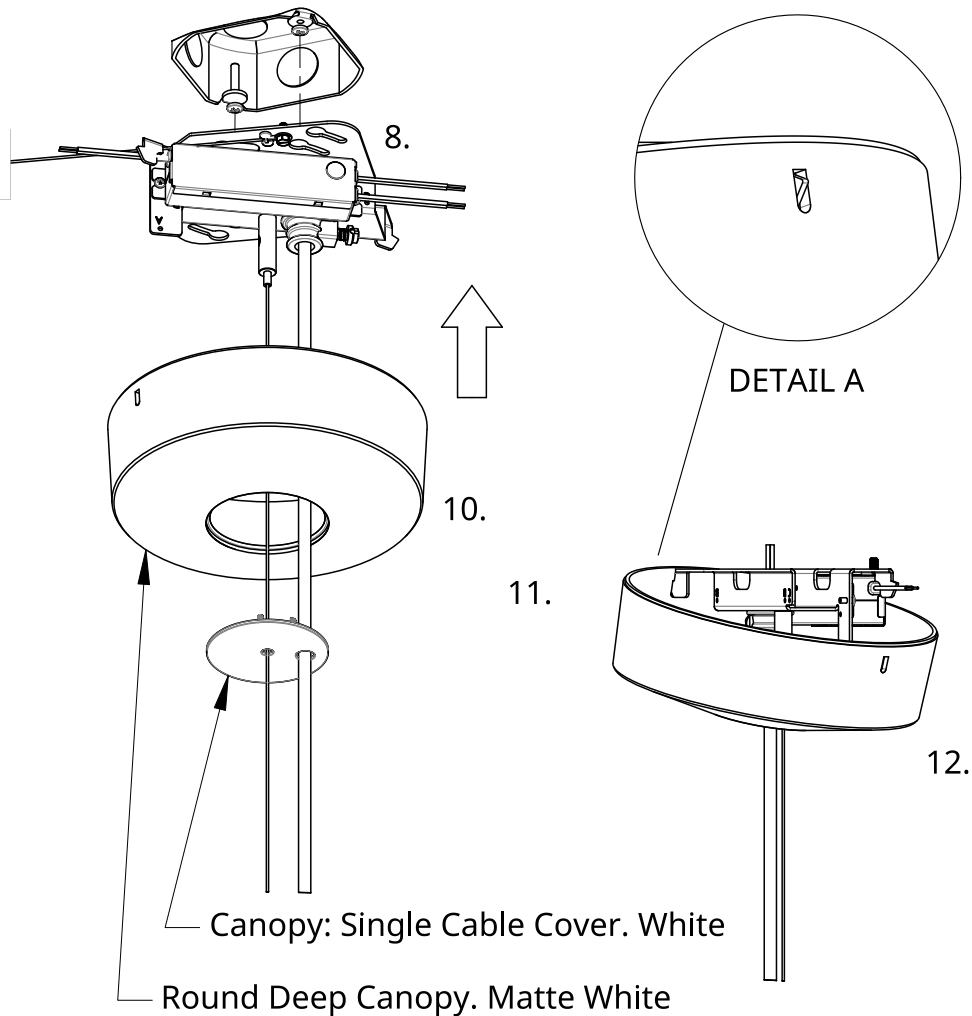

### Installation - Driver Mount

6. Connect Power Feed leads to respective Driver leads and tuck wires into the center of the Driver Mount.
7. Connect mains voltage to Driver.
8. Raise Driver Mount with hanging product to mounting fasteners and rotate.
9. Tighten Fasteners fully to secure Driver Mount to ceiling mounting surface.

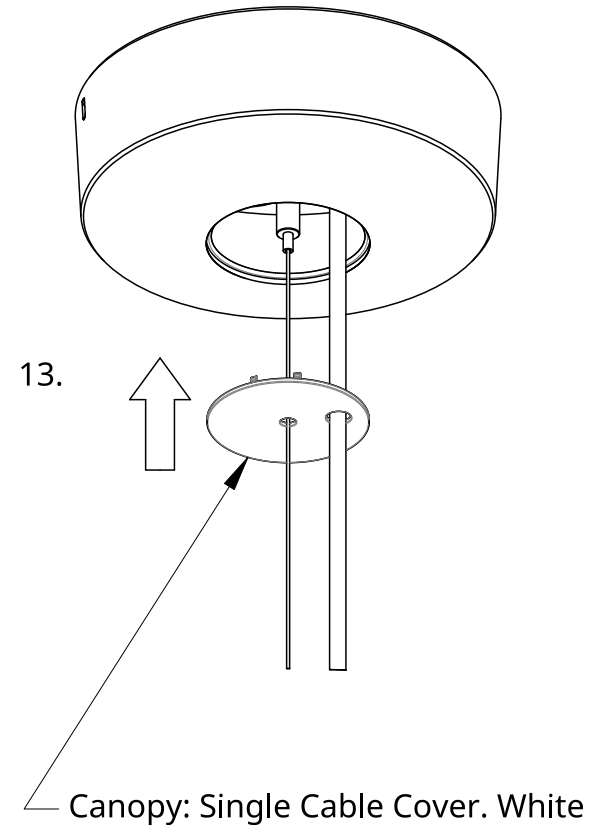

### Installation - Canopy Cover & Single Cable Cover

10. Raise Round Deep Canopy to the Driver mount and locate the back facing slot in Canopy Cover.
11. Insert back facing tab from Driver Mount into Deep Canopy slot.
12. Locate front facing slot in Deep Canopy, raise it to corresponding Driver Mount tab and snap in place.
13. Raise Single Cable Cover to Deep Canopy and snap in place.
14. Congratulations! End of guide.