

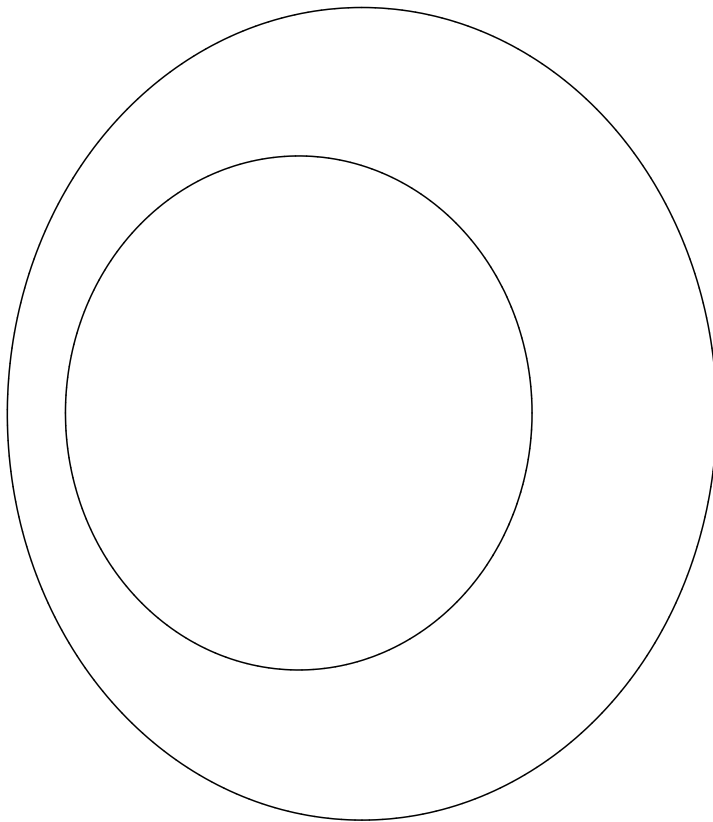

Topo Disc

18704 rA

Low Voltage Input



CAUTION:

Before starting, turn off power at main circuit panel.

ADVERTENCIA:

Antes de comenzar la instalación, apague la corriente en el tablero principal.

ATTENTION:

Coupez l'alimentation avant de proceder à l'installation.



Calling for backup? Scan above to contact our team.

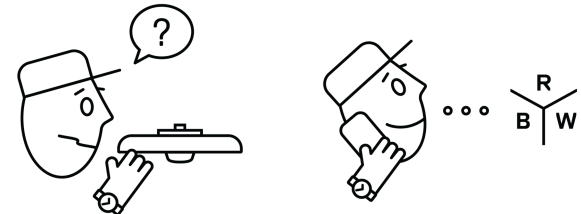

www.RBW.com
+1 212 388 0399
support@RBW.com
© 2023, RBW Studio LLC

What's Included: Part Configurations May Vary

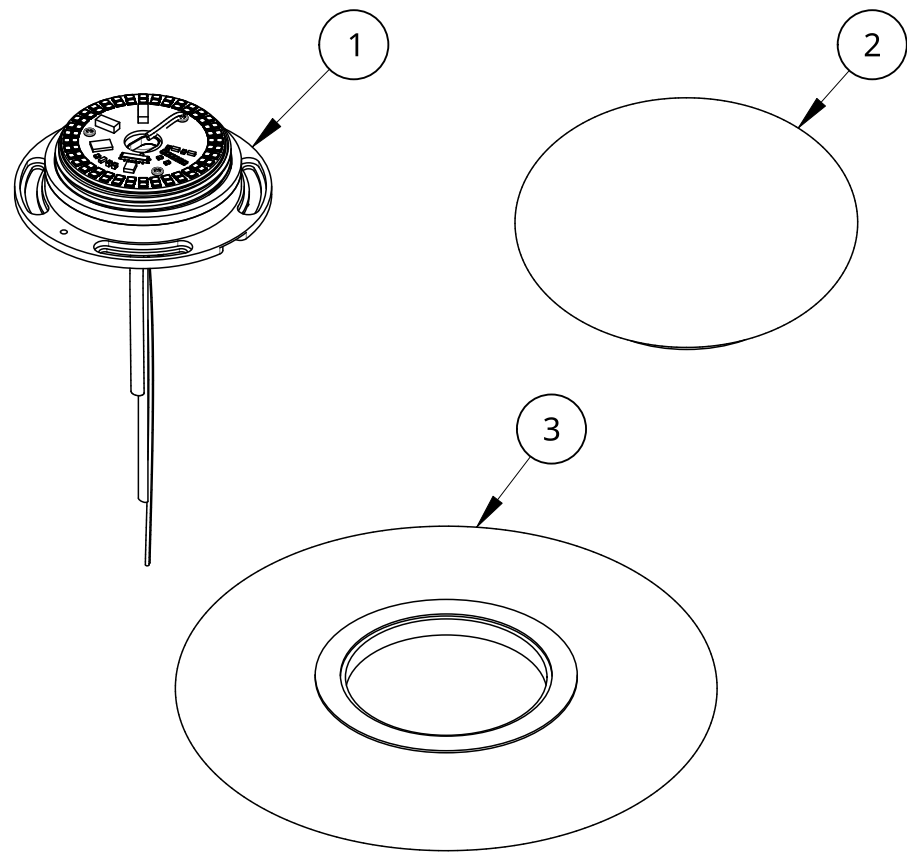

Item	Qty	Part number	Description
1	1	18719-27	Package: Topo Module. Standard DC LED. 2700K CCT
2	1	18468	Package: Elliptical Glass Globe. Small
3	1	18588	Package: Topo Disc. Small

What's Included: Part Configurations May Vary

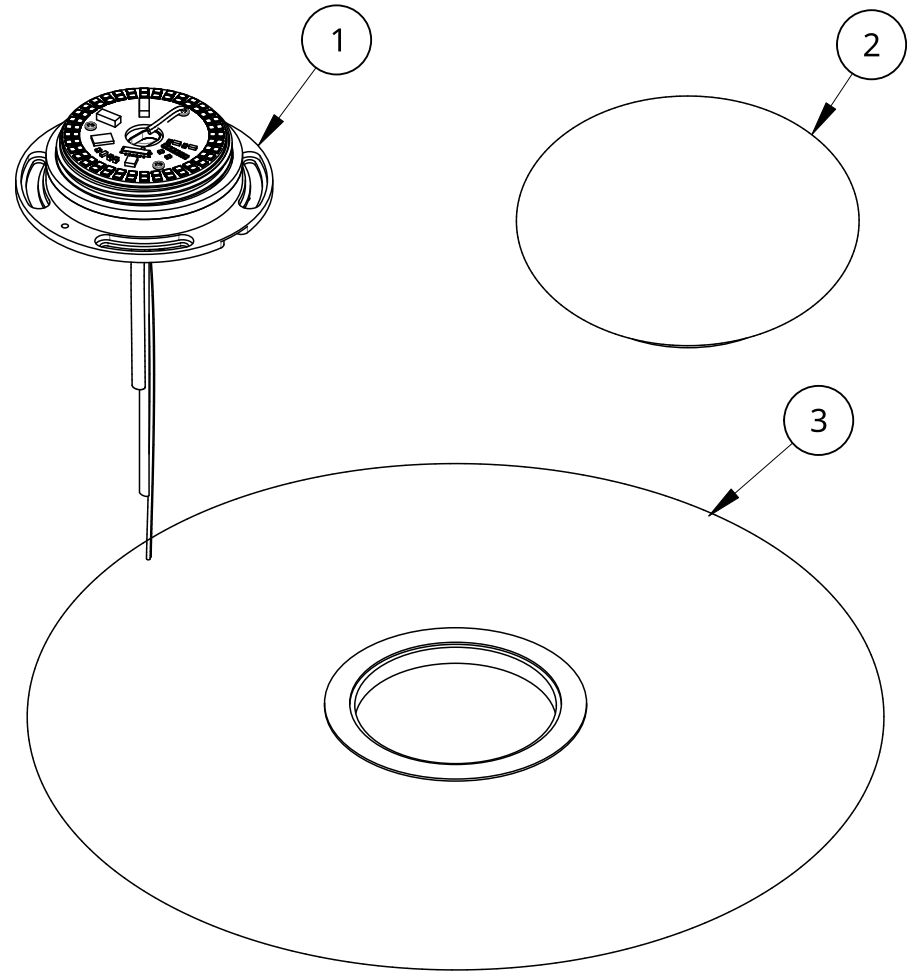

Item	Qty	Part number	Description
1	1	18719-27	Package: Topo Module. Standard DC LED. 2700K CCT
2	1	18468	Package: Elliptical Glass Globe. Small
3	1	18494	Package: Topo Disc. Medium

Disc Small



Driver dimensions and location may vary, consult your order confirmation for details.

* Fasteners not included

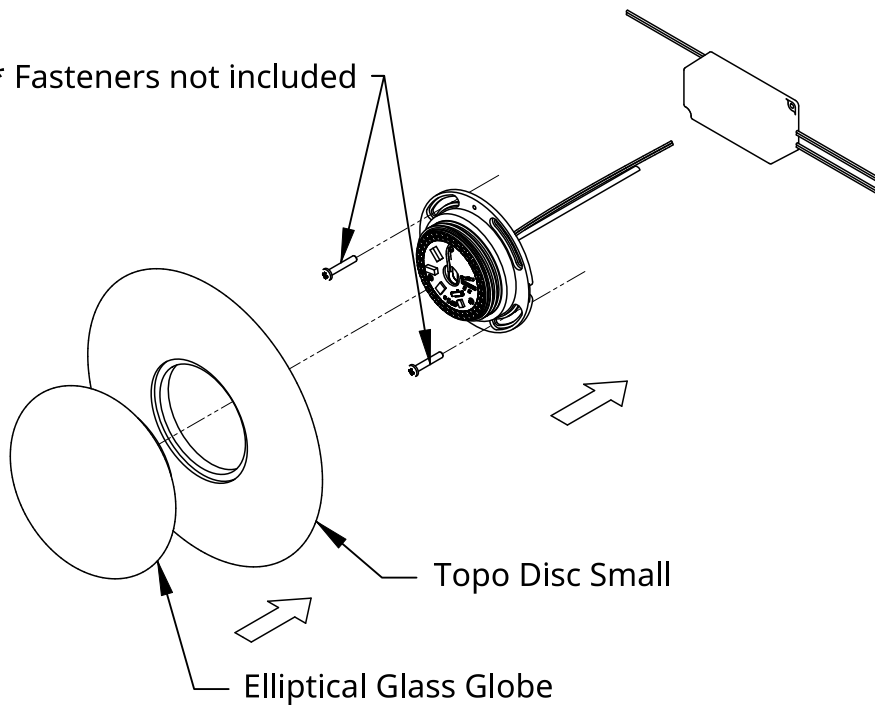

Installation - Topo Disc Small

1. Connect Red (+) and Black (-) leads to low voltage leads from externally located driver.
2. Use appropriate fasteners to fasten the Module to the mounting surface.
3. Place Topo Disc Small or Topo Disc Medium over Module so gasket is facing the wall.
4. Thread Elliptical Glass Globe onto the Module to tightly secure all components.

Disc Medium



Driver dimensions and location may vary, consult your order confirmation for details.

* Fasteners not included

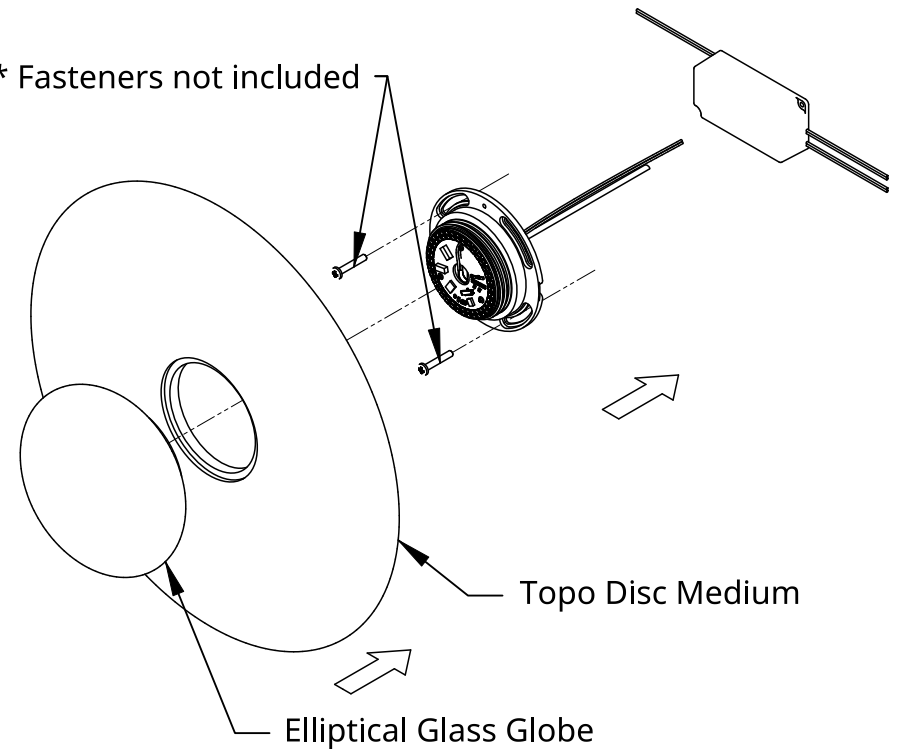

Installation - Topo Disc Medium

1. Refer to previous steps.
2. Congratulations! End of guide.