

# Copia

19493 rA

Low Voltage Input

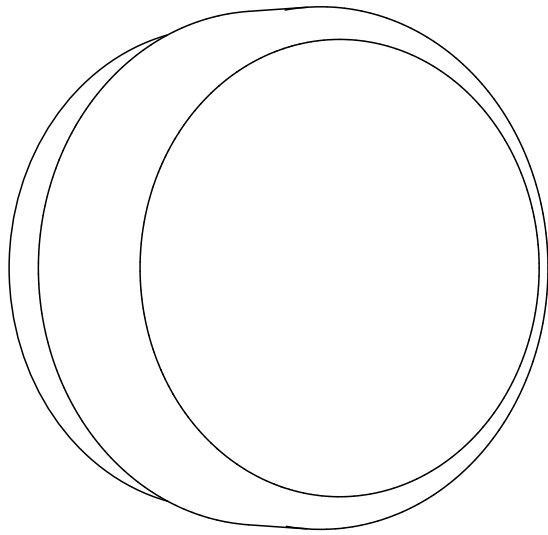

## CAUTION:

Before starting, turn off power at main circuit panel.

## ADVERTENCIA:

Antes de comenzar la instalación, apague la corriente en el tablero principal.

## ATTENTION:

Coupez l'alimentation avant de proceder à l'installation.



Calling for backup? Scan above to contact our team.

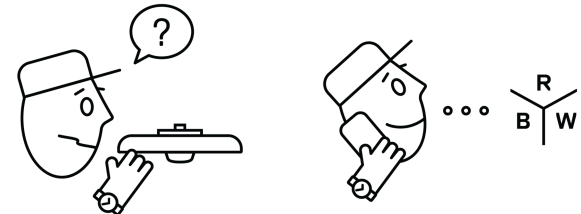

[www.RBW.com](http://www.RBW.com)  
+1 212 388 0399  
[support@RBW.com](mailto:support@RBW.com)  
© 2023, RBW Studio LLC

What's Included: Part Configurations May Vary

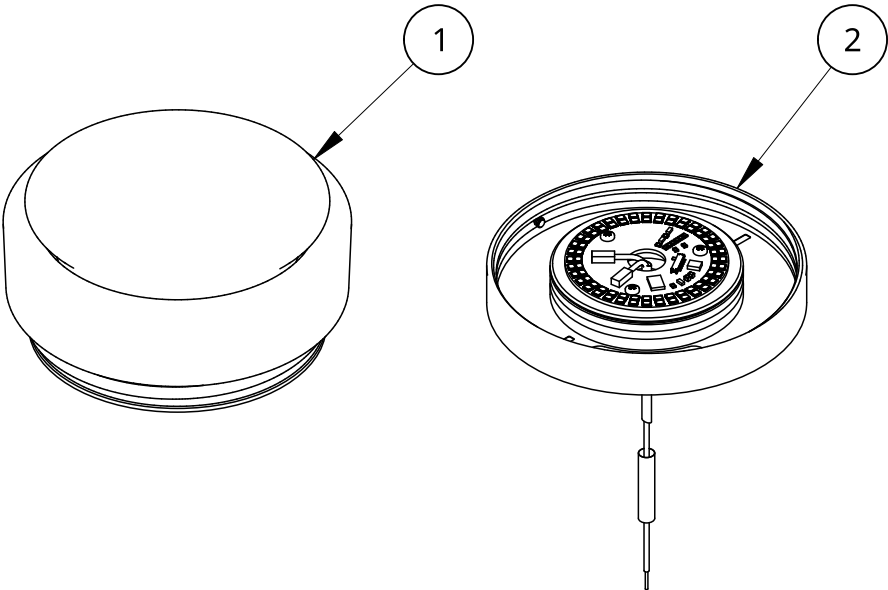

Item	Qty	Description
1	1	Package: Copia Glass and Diffuser
2	1	Package: Copia Round LED Module 5"

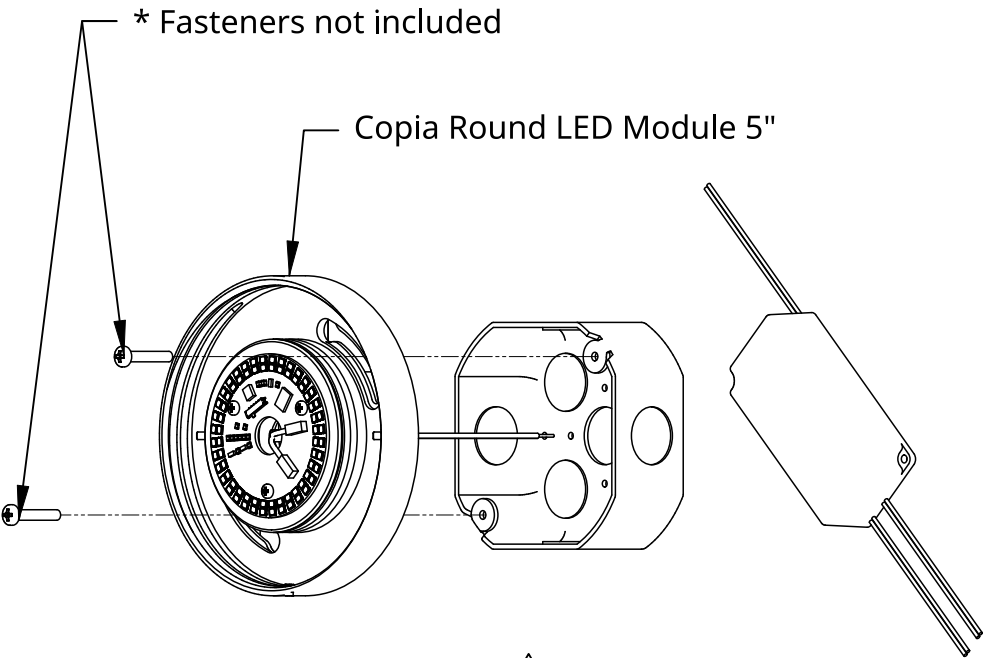

⚠ Driver dimensions and location may vary, consult your order confirmation for details.

Installation - LED Module

- 1. Connect Red (+) and Black (-) Sconce wires to low voltage leads from externally located driver.
- 2. Fix LED Module Assembly to desired mounting surface with appropriate fasteners.

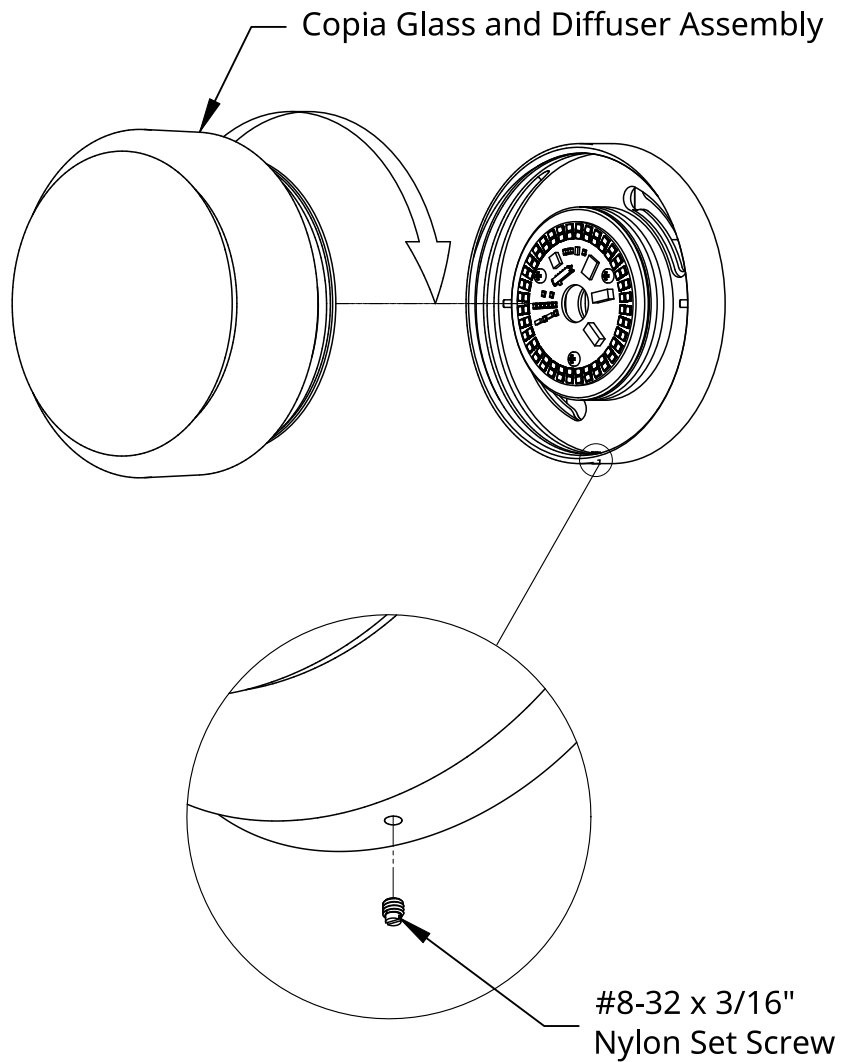

Page Intentionally Left Blank

### Installation - Threaded Glass Diffuser

3. Thread Glass Shade Assembly clockwise into LED Module Assembly until fixture is secure.
4. Drive Nylon Set Screw into LED Module Assembly to secure fixture into place.
5. Congratulations! End of guide.