

Gala Pendant

15737 rA

Low Voltage
Input

Note: External power supply may be required.

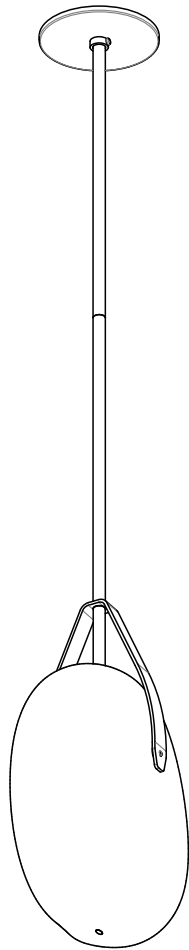

CAUTION:

Before starting, turn off power
at main circuit panel.

ADVERTENCIA:

Antes de comenzar la instalación,
apague la corriente en el tablero
principal.

ATTENTION:

Coupez l'alimentation avant de
procéder à l'installation.



Calling for backup? Scan above
to contact our team.

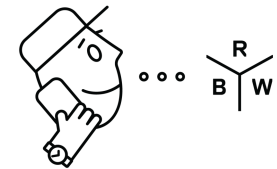
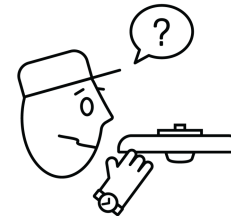

www.RBW.com

+1 212 388 0399

support@RBW.com

© RBW Studio LLC, 2013, 2020

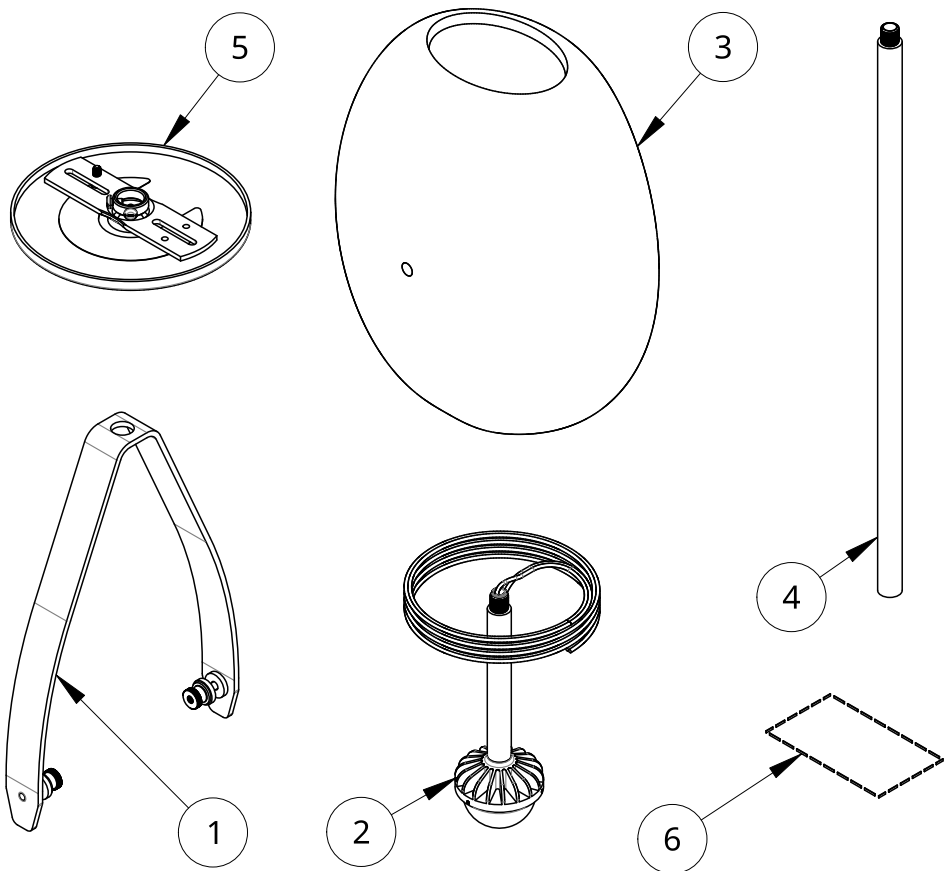

What's Included: Part Configurations May Vary

Item	Qty	Part number	Description
1	1	11418-PC30	Assembly: Gala Pendant Fork & Hardware. Matte Black
2	1	A-10389	Gala Chandelier LED Mount Assembly
3	1	11067	Gala Chandelier Small Globe
4	2	10311	Stem Internal Thread with 1/8 IPS Nipple Assembly
5	1	11022	CP14 Canopy Flat Round w Stem
6	1	Driver	LED Driver

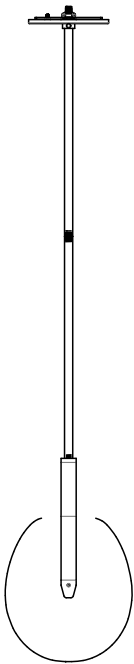

GP-10G

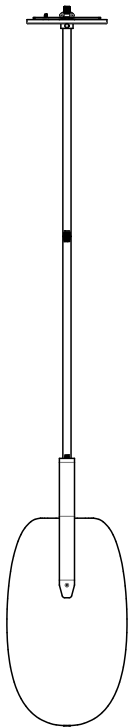

GP-20G

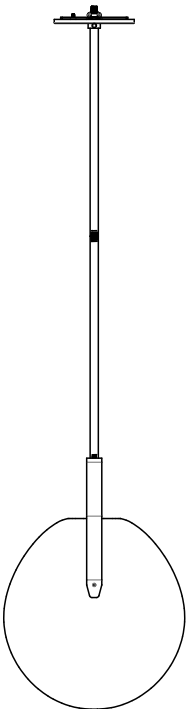

GP-30G

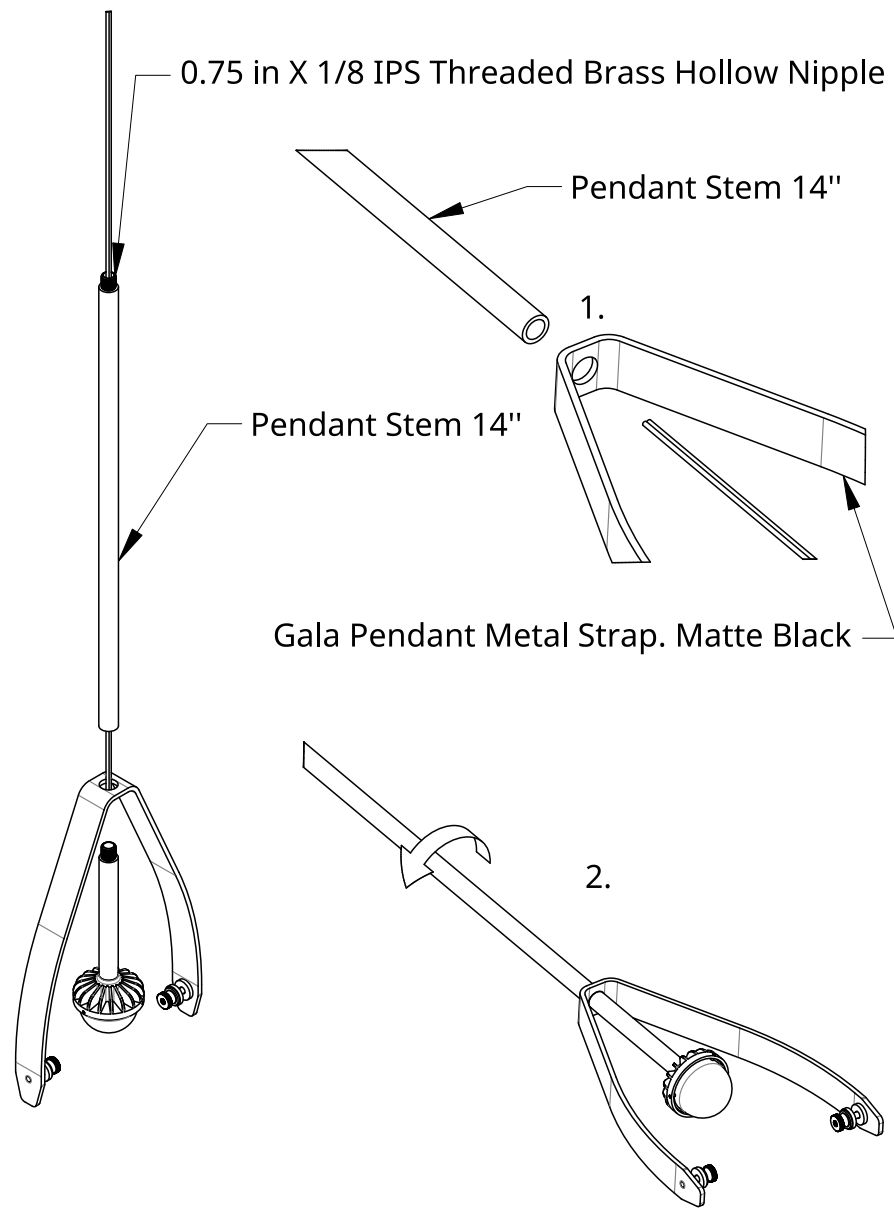

Installation - Stem and LED Mount

1. Feed wires from LED Mount Assembly through hole in Fork and first Stem with 1/8" IPS Brass Nipple.
2. Once the wires are fed through the Stem, thread the LED Mount Assembly to the treaded portion of the Stem, securing the Fork between both parts.

Optional Drop Height Adjustment

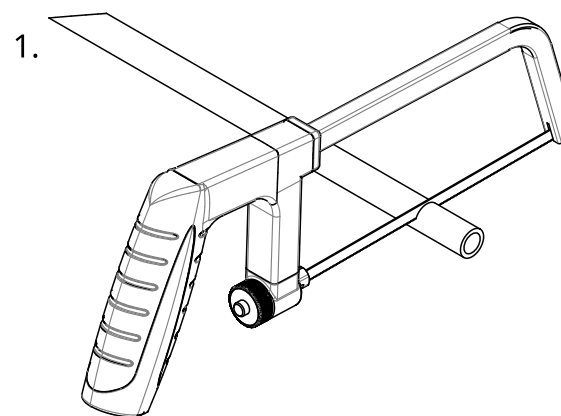

NOTE: Be sure Wires are not present within the Stem when cutting.

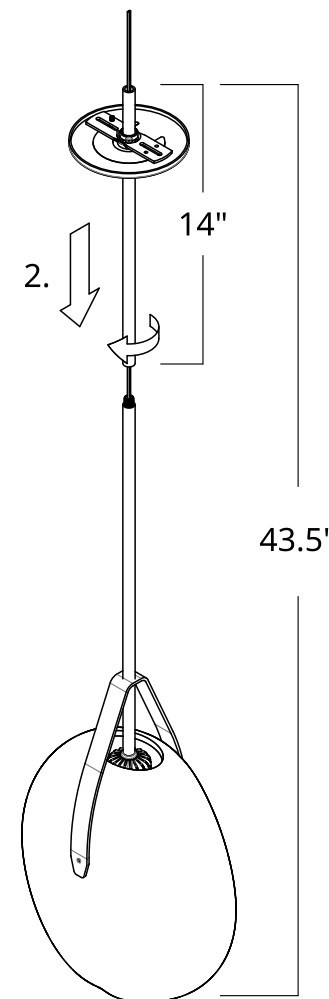

Installation - Stem Trimming

1. Trimming the uppermost Stem is optional. This can be done now or later depending on anticipated height above finished floor.
2. Feed wires through the second Stem and thread Stem onto 1/8" IPS Brass Nipple to fasten both Stems together.

Gala Slip Ring 1/4 IPS with 2X #6/32 Screws

Bracket Crossbar
w/ 1/2" IP Tapped Center Hole

5" Canopy w/ 1/4" IP Slip Ring

Pendant Stem 14"

Installation - Canopy

1. After making sure set screws are backed out to allow clearance, slide Canopy parts onto the Gala Pendant Stem in the correct order (5" Canopy, Bracket Crossbar, and 1/4" IP Slip Ring).
2. Once the parts are on the Stem be careful not to damage the finish.
3. Fasten the 2x 6-32 x .25 Screws in the 1/4" IP Slip Ring at desired height on the Stem.
4. Connect Red (+) and Black (-) Pendant wires to low voltage leads from externally located driver.



Driver dimensions and location may vary, consult your order confirmation for details.

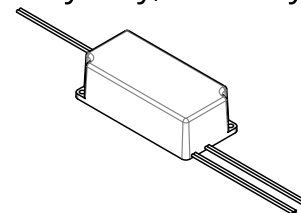

Bracket Crossbar
w/ 1/2" IP Tapped Center Hole

*Fasteners not included

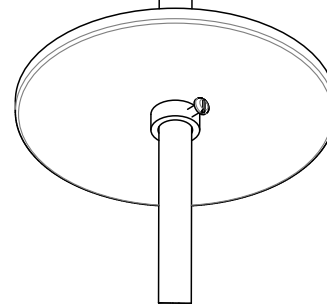
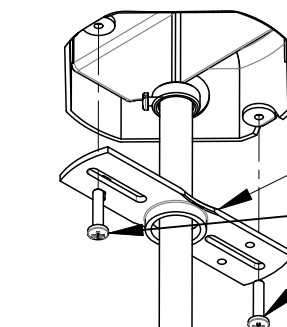

5" Canopy w/ 1/4" IP Slip Ring
Pan head machine screw #6-32 x 0.25
Stainless Steel 18-8

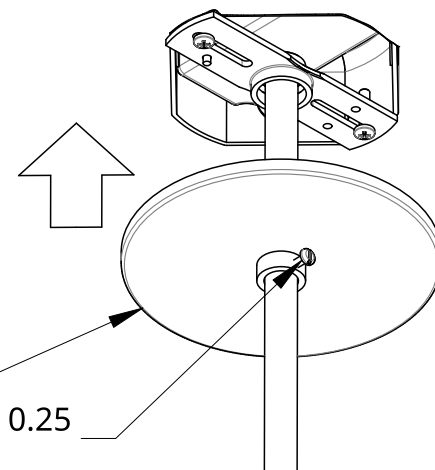

Installation - Crossbar and Canopy

1. Once the Slip Ring is secured to the uppermost Stem, fasten the Crossbar to the junction box using 2x 8-32 screws (not included).
2. After the Crossbar is securely fastened to the junction box you can let the fixture hang freely.
3. At this time you can raise the canopy to be flush with the ceiling.
4. With the Canopy flush to the ceiling, secure the Canopy using the 6-32 x .25 Screw.

1.

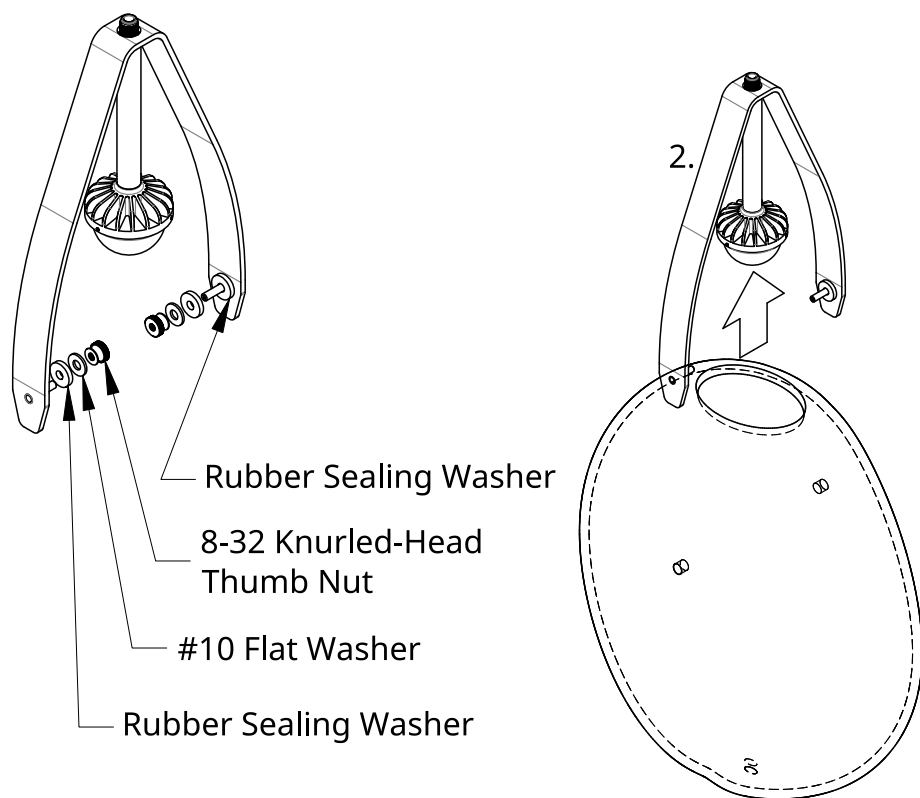

Installation - Hardware and Globe

1. Remove all included hardware from Gala Fork except Rubber Sealing Washers closest to the strap.
2. Gently flex Gala Fork over Globe and carefully insert the LED Module into the Globe until threaded studs line up with holes on the side of the Globe.

Globe and Strap Section View

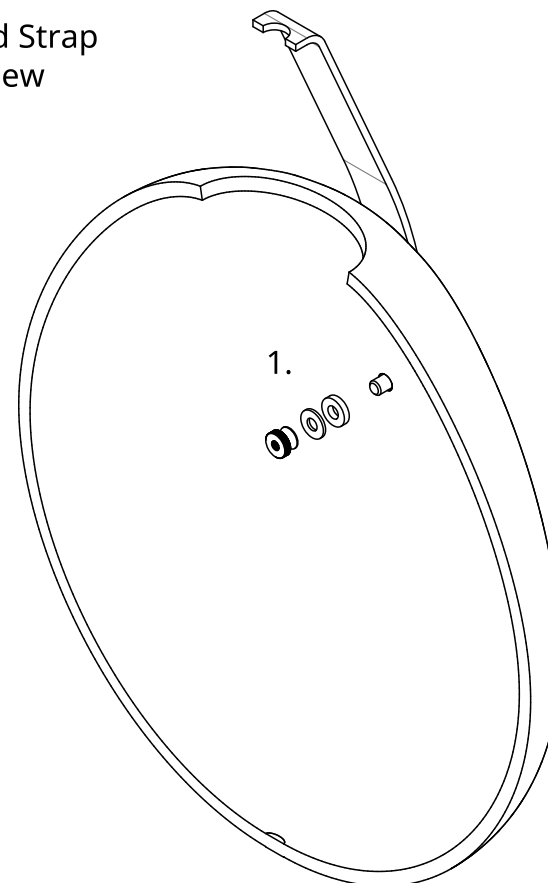

Installation - Hardware and Globe

1. Insert previously removed hardware into the globe in the same order they were shipped in (Rubber Sealing Washer, #10 Flat Washer, 8-32 Knurled-Head Thumb Nut)
2. Do this for both sides being careful not to damage the inside of the globe.
3. Congratulations! End of guide.