

RAVENHILL STUDIO

2122 Cypress Ave, Los Angeles, CA 90065
323.977.8532, contact@ravenhillstudio.com

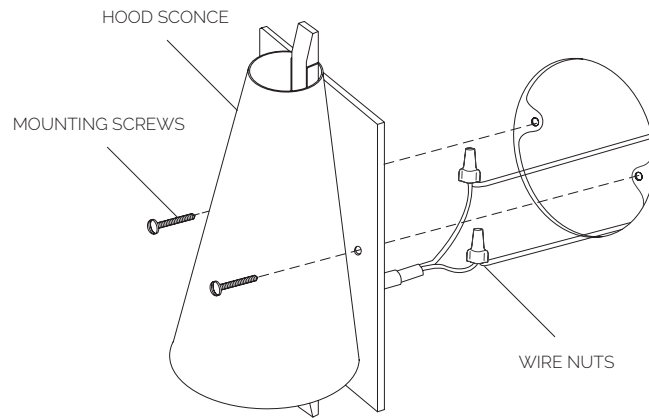
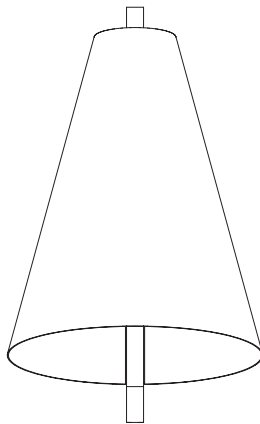

We recommend installation of our Hood Sconce by a professional. Please share this guide with your electrician.

Your Hood Sconce kit consists of **(5)** individual parts:

(1) Hood Sconce

(2) Mounting Screws

(2) Wire Nuts

1. Your Hood Sconce shade should be evenly round. Should any deformation have occurred, bend the shade back into place by pushing or folding along the shade spine seam.

2. Connect electrical cord to power supply with Wire Nuts. Tuck wires/Wires Nuts into junction box.

3. Thread Mounting Screws through wall plate into junction box. Tighten Mounting Screws so that wall plate sits flush with wall.

4. Turn it on and enjoy!

Included with your Hood Sconce is an LED 7 watt light bulb.

The bulb is warm white (2700K) A19 and delivers 800 lumens.

The bulb is JA8 certified and has a 15,000 hr lifetime.

A19 bulb recommended. 10W Max



CAUTION: Before starting, turn off power at main circuit power.

