

# RAVENHILL STUDIO

2122 Cypress Ave, Los Angeles, CA 90065  
323.977.8532, [contact@ravenhillstudio.com](mailto:contact@ravenhillstudio.com)

## Peek Junction Box Requirements

Our Peek Family of fixtures has been designed with two primary canopy options, so some thought must be given to choosing the right junction boxes for successful installation. We encourage you to share this document and our installation instructions with your installer prior to installation to ensure the desired result.

### Peek 3.5" Canopy

Designed for a minimal reveal, the 3.5" Canopy is the Studio's preference. Ensure the canopy mounting holes on the chosen junction box are level or inline with the architecture, as the canopy screws are visible.

Peek 3.5" Canopy

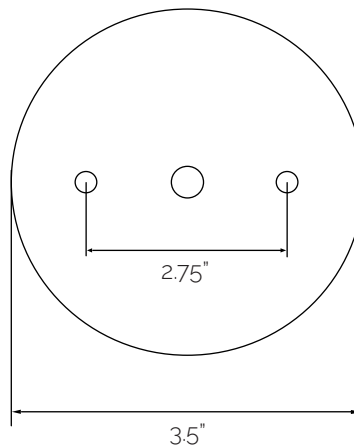

#### MUD RING

For ease and success of installation, we recommend mud rings mounted on 4" hex junction boxes with screw mounting holes spaced 2.75" apart. Ensuring the finish wall opening is kept tight to the mud ring and under 3.5" wide so that the 3.625" canopy fully covers the junction box.

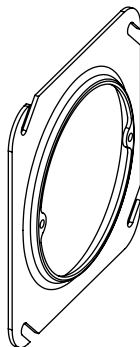

#### 3.5" ROUND PAN

A stock 3.5" round electrical pan with screw mounting holes spaced 2.75" apart is a great option when mounting Peek with a 3.5" canopy. Our Peek 3.5" canopy actually has a 3.625" diameter, and is designed to be installed with tight tolerances to cover a 3.5" round pan, which typically has a 3.375" diameter. Care should be taken to ensure the finish wall opening is kept tight to the pan and under 3.5" wide so that the canopy fully covers the junction box. **Due to limited space within pancake round pans, it is recommended power not enter through the center knockout but instead be routed through one of the side knockouts.**

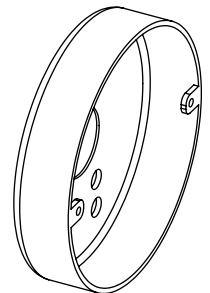

# RAVENHILL STUDIO

2122 Cypress Ave, Los Angeles, CA 90065  
323.977.8532, contact@ravenhillstudio.com

## Peek 4.5" Canopy

Our 4.5" canopies are the best option when installing on an existing junction box where the smaller diameter of our 3.5" canopy will not work. The 4.5" canopies come with a universal plate that can accommodate a number of different junction box types. Ensure the canopy mounting holes on the chosen junction box are level or inline with the architecture, as the canopy screws are visible.

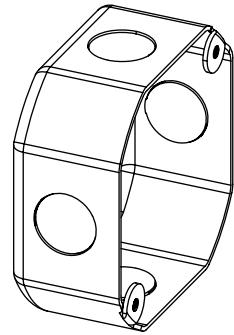
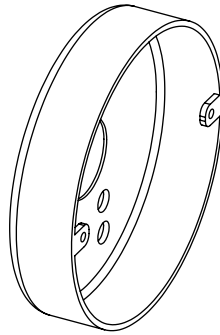
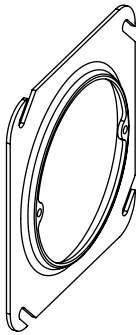
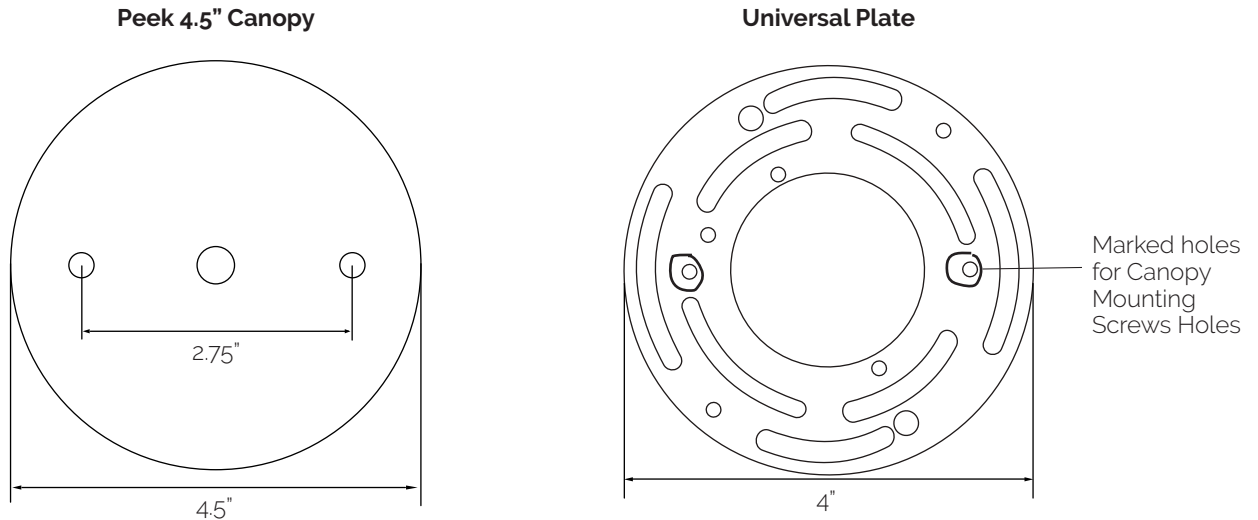

### MUD RING

Mud rings mounted on 4" hex junction boxes with screw mounting holes spaced 2.75" apart. Also works great with Peek 4.5" Canopies.

### 3.5" ROUND PAN

A stock 3.5" round electrical pan with screw mounting holes spaced 2.75" apart is a great option when mounting Peek with a 4.5" canopy. **Due to limited space within pancake round pans, it is recommended power not enter through the center knockout but instead be routed through one of the side knockouts.**

### 4" OCTAGON

Where a larger 4" octagon box is present and no alterations are desired, 4.5" Canopy will cover. Please make sure that the wall is prepared tightly to the box. **Note that 4" square boxes are larger than octagon boxes and will not work.**