

SELETTI

SUPERFURNITURE

design **HELLO AGAIN**

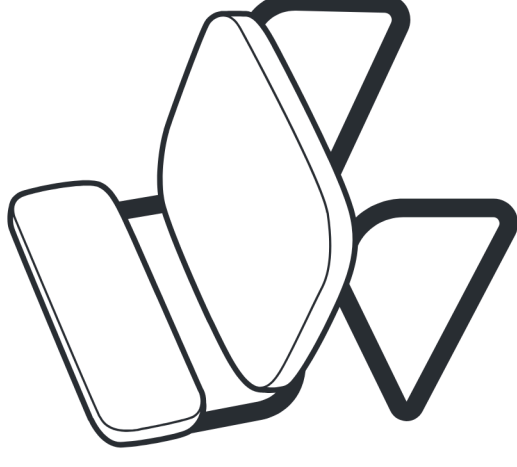

LOUNGECHAIR



FERRAMENTA ALL'INTERNO/HARDWARE INSIDE/HERRAJES EN EL INTERIOR/
QUINCAILLERIE À L'INTÉRIEUR/MONTAGEMATERIAL IM INNEREN

STRUTTURA: Pulire con detergente multi superfici neutro e panno morbido.

FRAME: Clean with a neutral multi-surface cleaner and a soft cloth.

ESTRUTTURA: Limpiar con un limpiador neutro multi-superficie y un paño suave.

STRUCTURE: Nettoyer avec un nettoyant neutre multi-surfaces et un chiffon doux.

STRUKTUR: Mit einem neutralen Mehrflächenreiniger und einem weichen Tuch reinigen.

FODERA REMOVIBILE: lavare solo a mano – utilizzare solo detergenti delicati – evitare eccesso di acqua – se la macchia è fresca e leggera, pulire con un panno morbido e umido.

REMOVABLE LINING: Hand wash only - Use mild detergents only - Avoid excessive water - If the stain is fresh and light, clean with a soft, damp cloth.

FUNDA EXTRAÍBLE: lavar únicamente a mano – utilizar solo detergentes suaves – evitar exceso de agua – si la mancha es reciente y ligera, limpiar con un paño suave y húmedo.

HOUSSE AMOVIBLE: lavage uniquement à la main – utiliser uniquement des détergents doux – éviter l'excès d'eau – si la tache est récente et légère, nettoyer avec un chiffon doux et humide.

ABNEHMBARER BEZUG: nur Handwäsche – nur milde Reinigungsmittel verwenden – übermäßiges Wasser vermeiden – bei frischen, leichten Flecken mit einem weichen, feuchten Tuch reinigen.

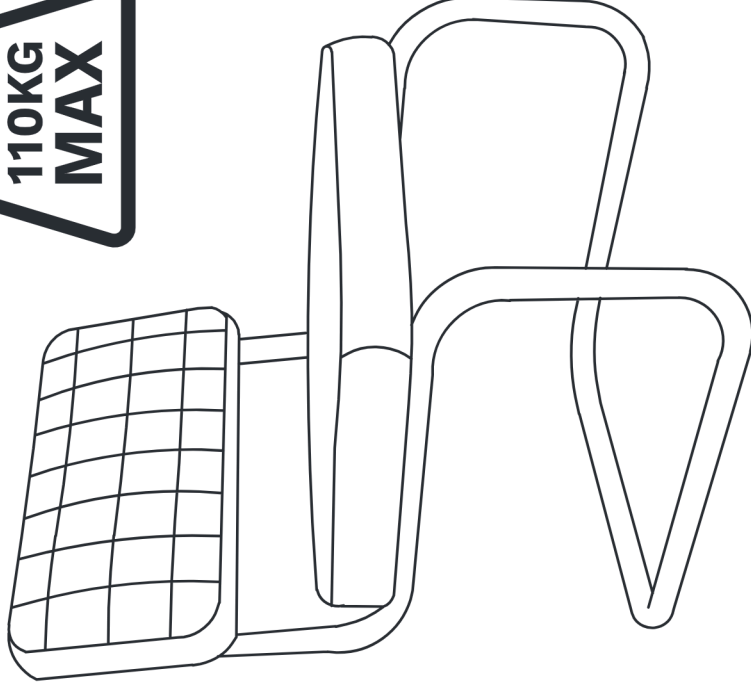



Ax2

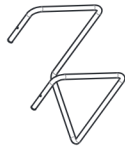

Bx1



Cx1

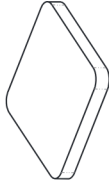

Dx1

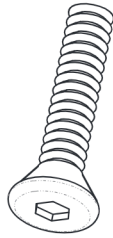

Ex8



Fx1

1

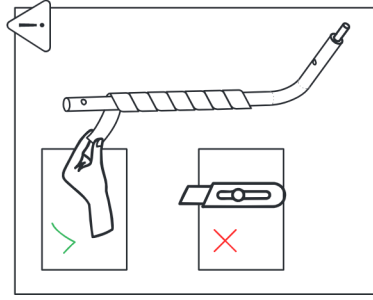
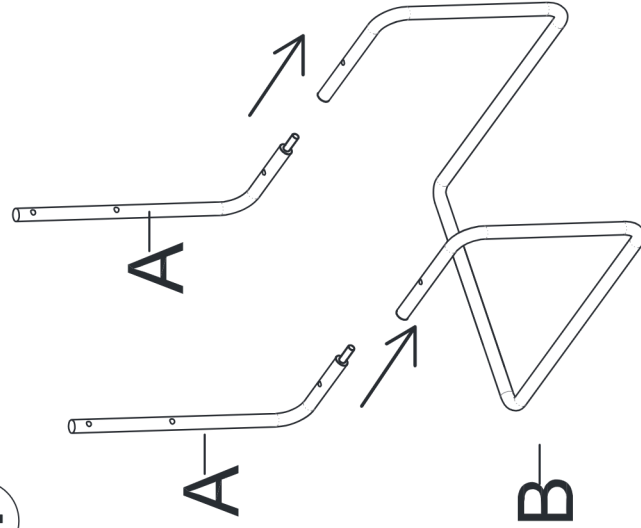

2

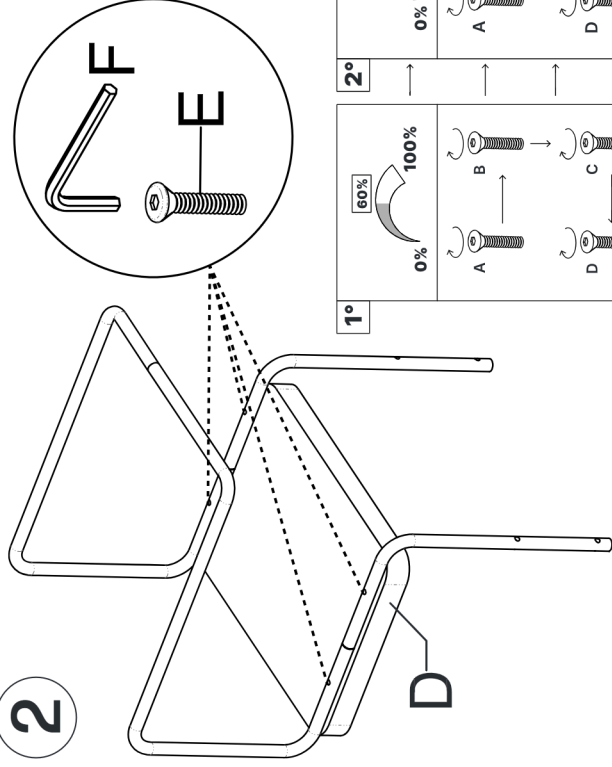

1°

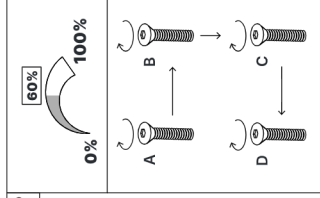

2°

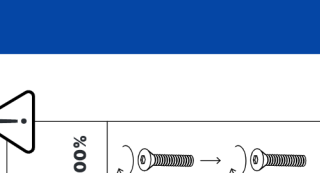

3

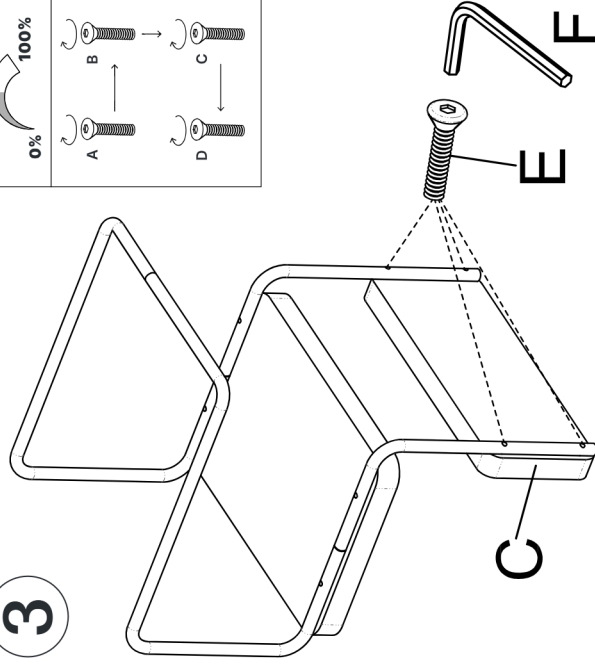

1°

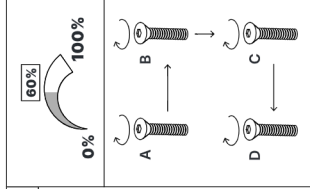

2°

