

# STACK ABL



Installation  
Guide



Safety Notes

This product is to be installed by a qualified electrician only.  
IP20 rating for indoor use only.  
Do not make connections while connected to power source.

Do not make modifications to the pre-assembled fixture.  
Any alterations or deviation from the prescribed guidelines will not only damage the fixture, but will void both the warranty and all of its certifications, unless there is prior consultation with STACKABL.

Always wear clean non-marking gloves when handling the fixture.  
Use caution when removing the fixture from packaging.  
Ensure individual light discs do not spin when handling and installing fixture.

Electrical Notes

Power supply: 12 VDC output Class 2 constant voltage integral power supply  
Controls: 120/227 V input, TRIAC, ELV, 0-10 dimming  
Input voltage: 120 VAC (277 VAC upon request)  
Lamping: 0.4 W per 5” light disc / 0.6 W per 8” light disc, CRI 90, L80 50,000 hours

An additional 18”/ 45cm of power cable is provided to allow height flexibility, slack, and electrical connections inside the canopy during installation  
\*The electrical cord must not bear any weight.

Care Instructions

Lint roll occasionally to remove general airborne debris.  
Should soiling occur, spot clean with with a microfibre cloth, mild soap and lukewarm water.  
Avoid aggressive rubbing of felt as this can change the surface appearance of the felt.  
For replacement parts contact STACKABL directly.

Material Variations

All of our products are individually assembled and finished, meaning minor variations in finish, colour and form can occur. Slight variations in form and part location are to be expected and will be not be accepted as a fault or defect product.



## Standard Canopy Components

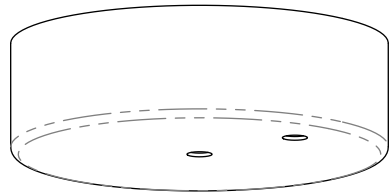

Canopy Cover

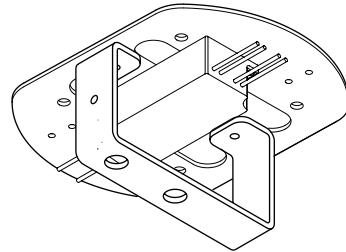

Canopy Assembly

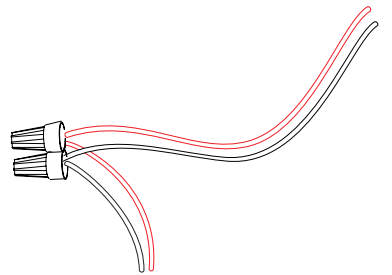

Wire Nut

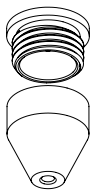
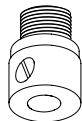
Canopy Screws  
3/8" Stainless Screw 8-32 ThreadStand-off Coupler  
\*For Horizontal Fixture

Metal Strain Relief

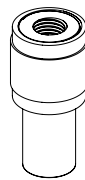

Cable Coupler

## Multi-fixture Canopy Components

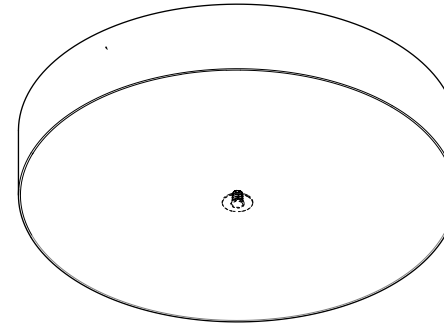

Canopy Cover

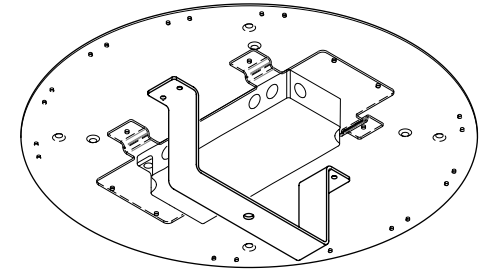

Canopy Assembly

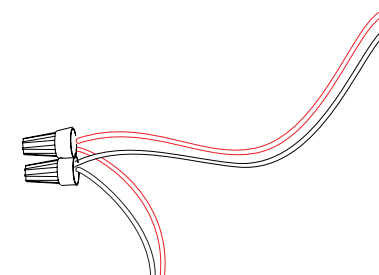

Wire Nut

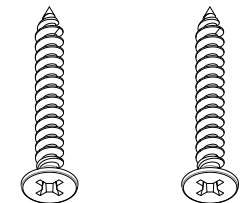

Ceiling Screws

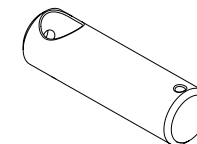
Stand-off Coupler  
\*For Horizontal Fixture

Cable Holder

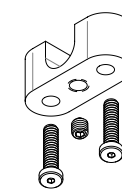
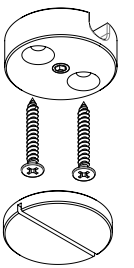

Plate Strain Relief



Ceiling Relief &amp; Cap

# Canopy Assembly

## Standard Canopy

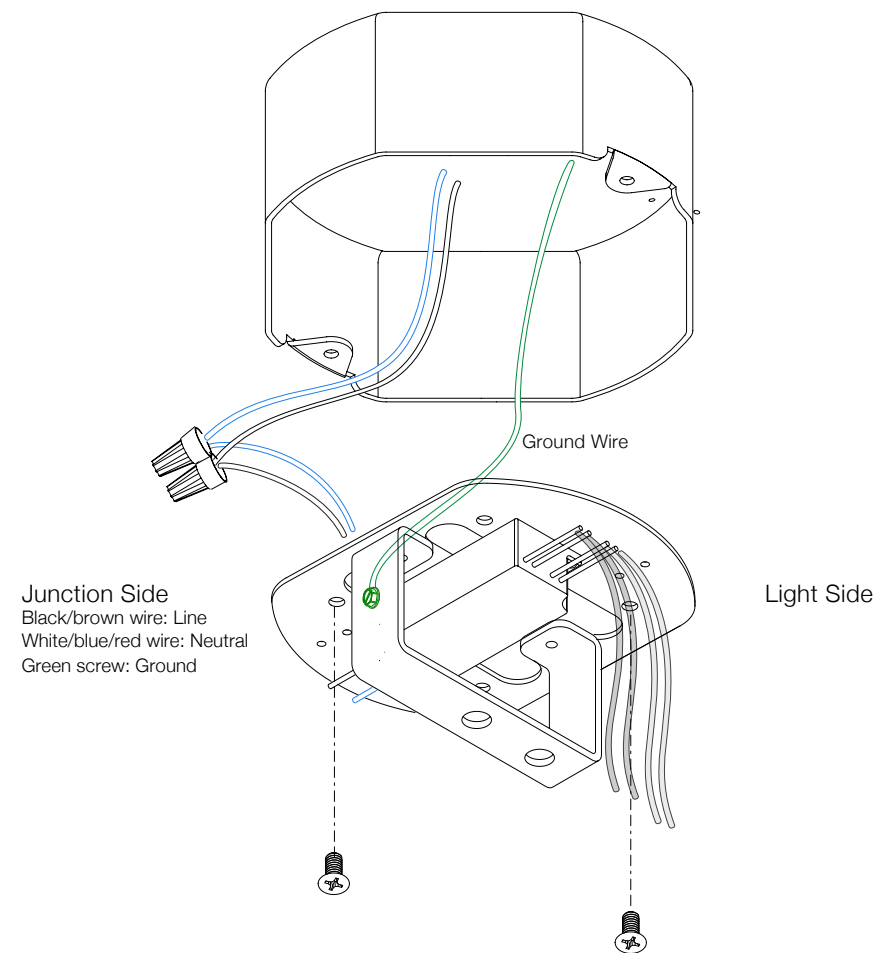

## Multi Fixture Canopy

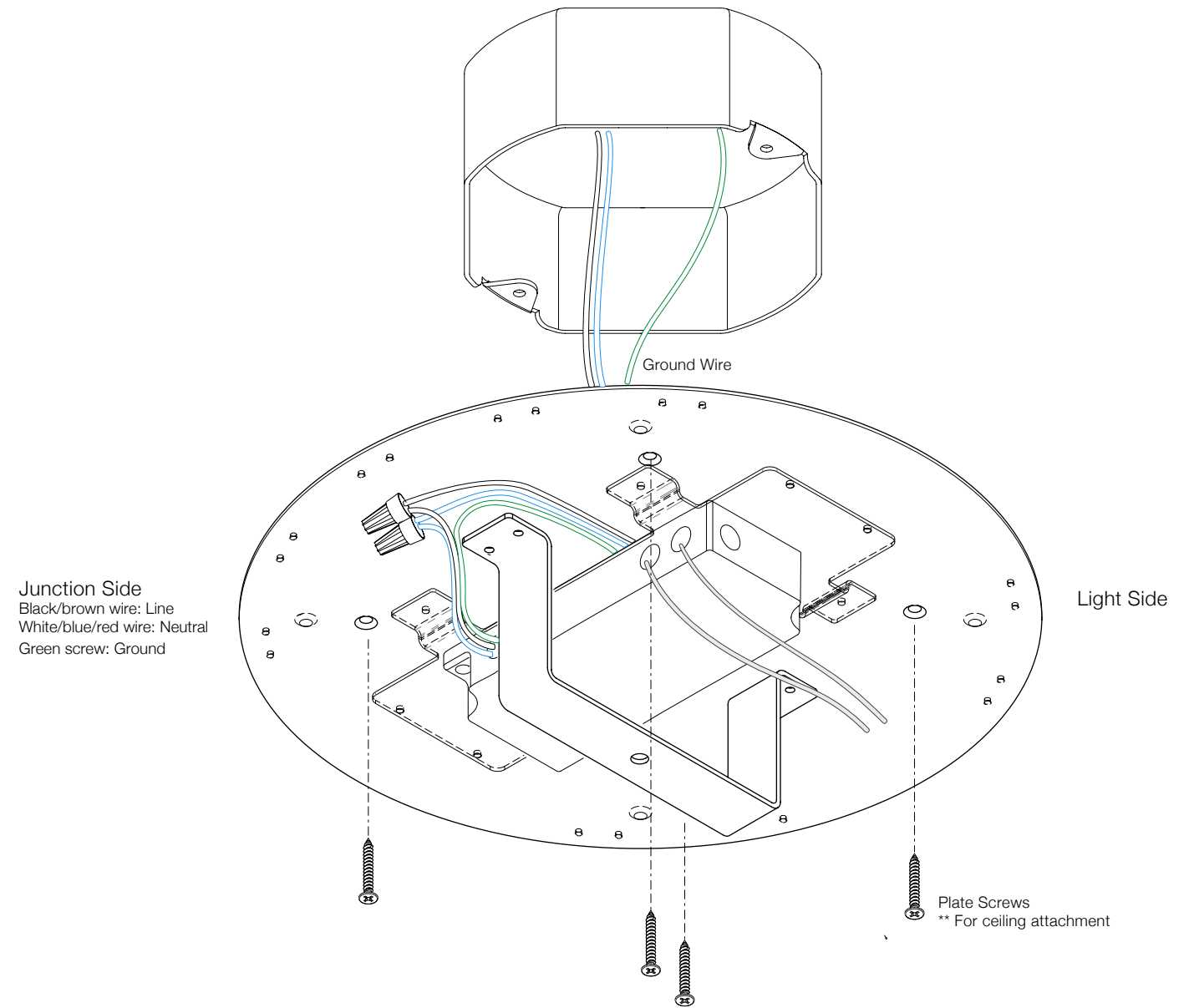

## Vertical Fixture

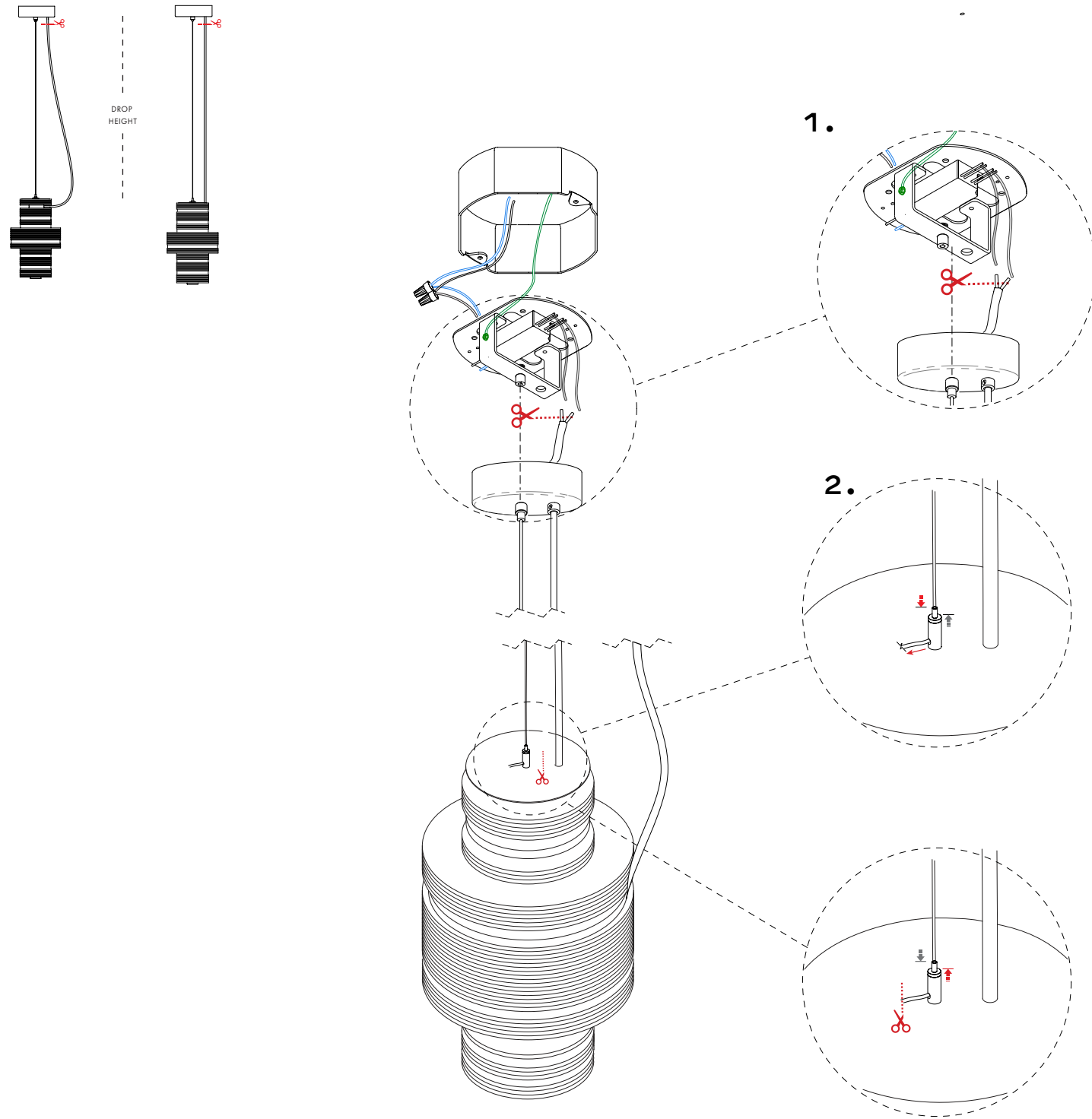

## Horizontal Fixture

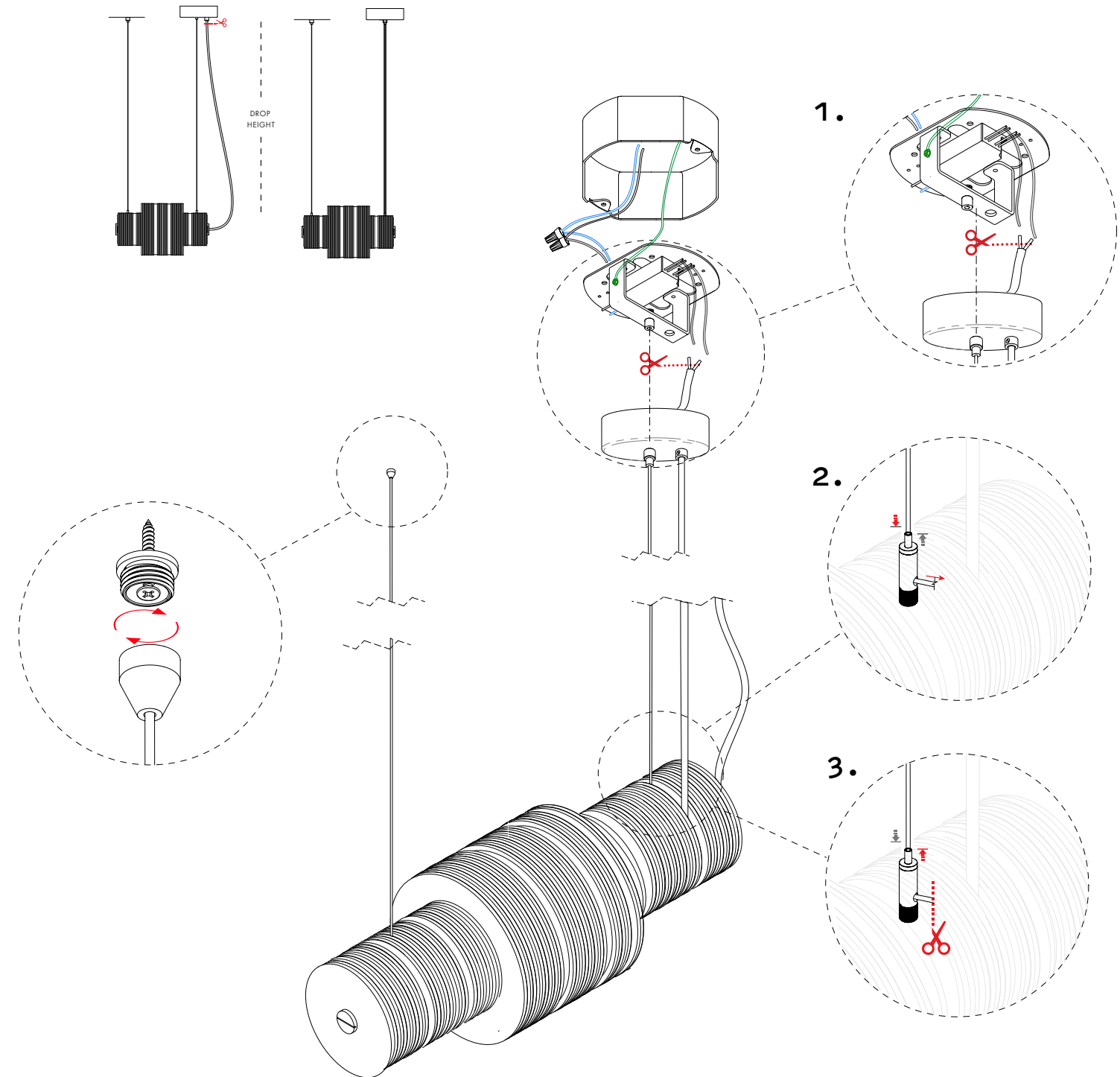

## Standard Fixture Power Cable Wiring

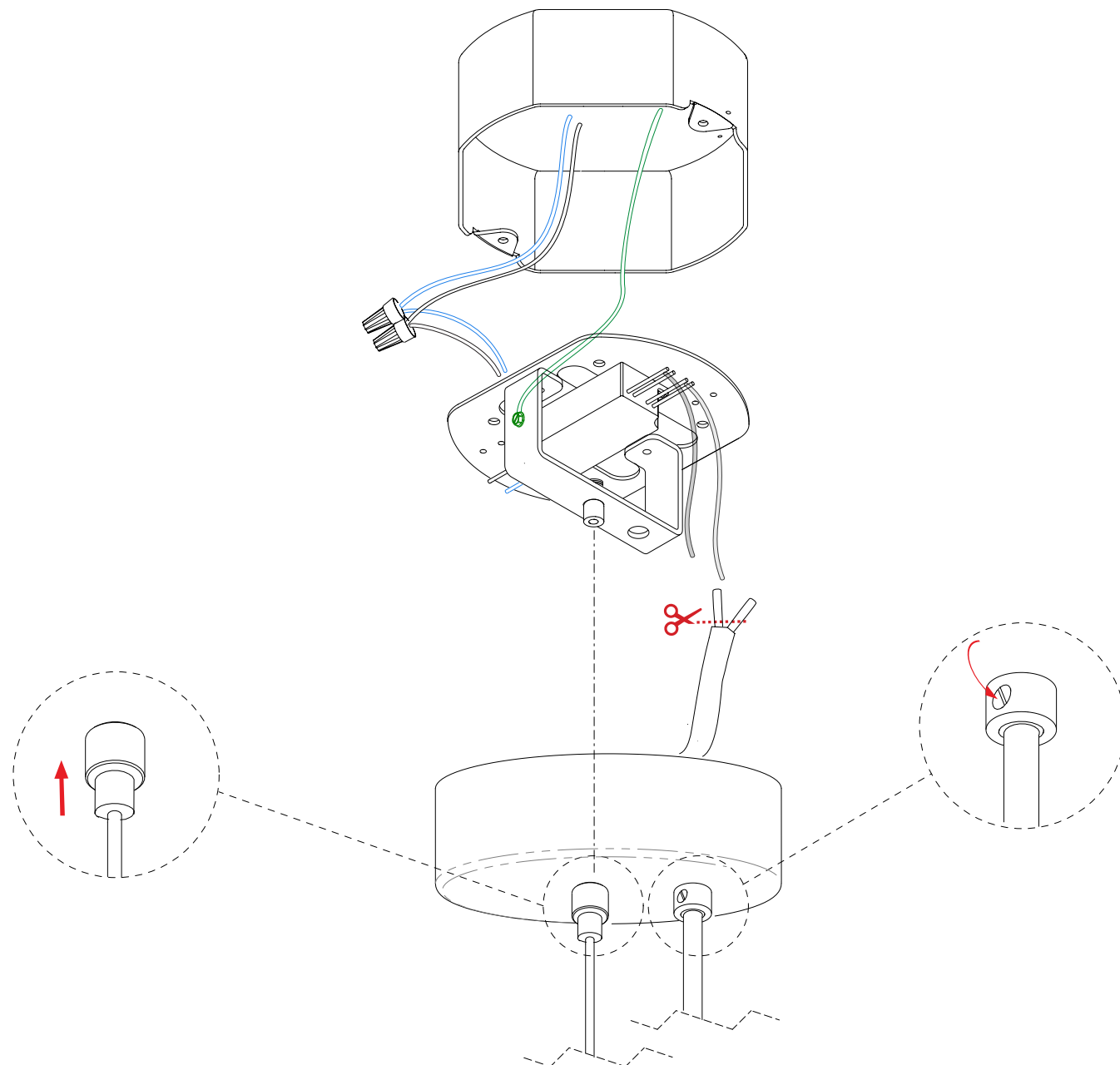

## Multi-fixture Power Cable Wiring

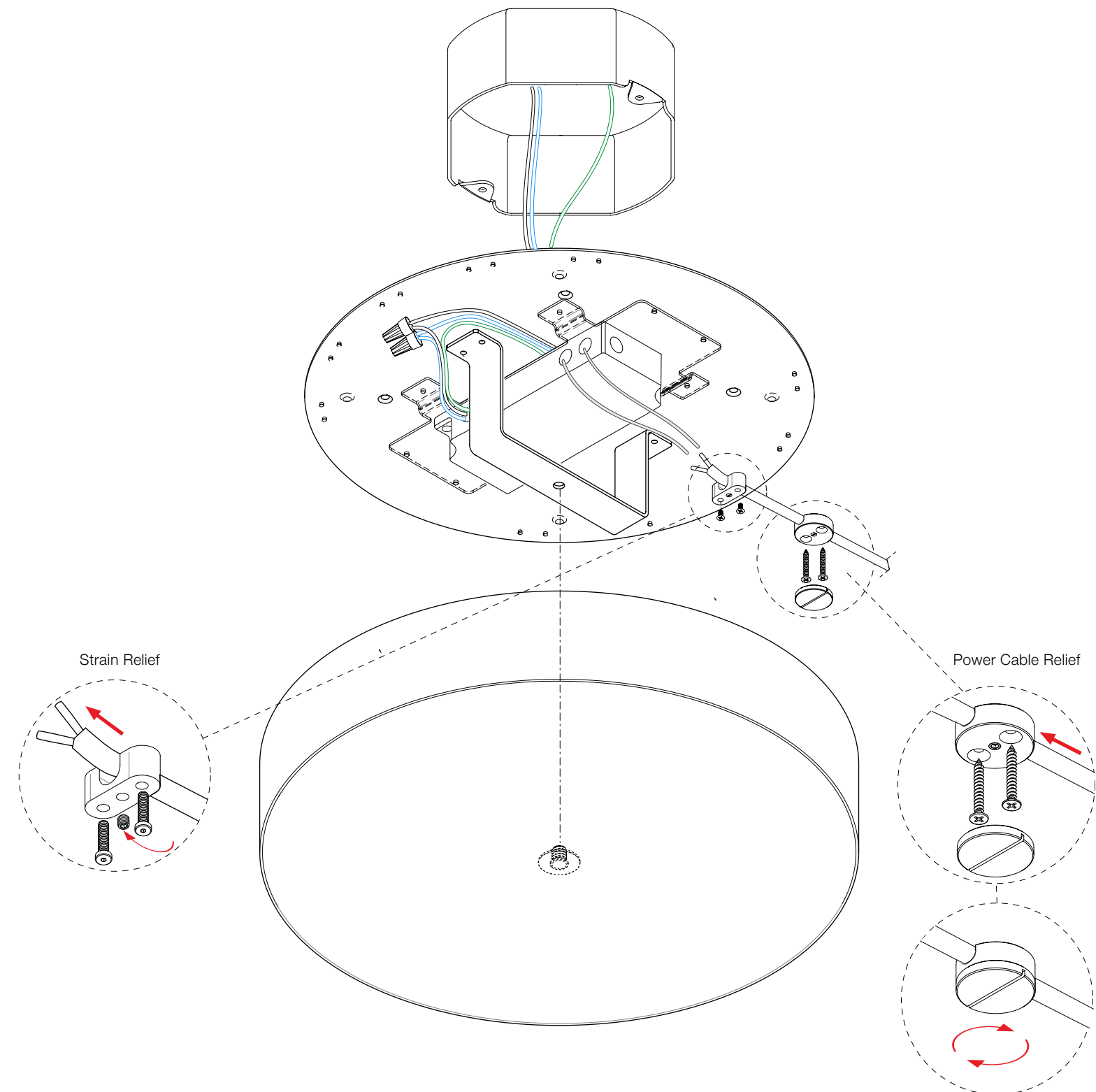

## Pendant Canopy Types - Standard

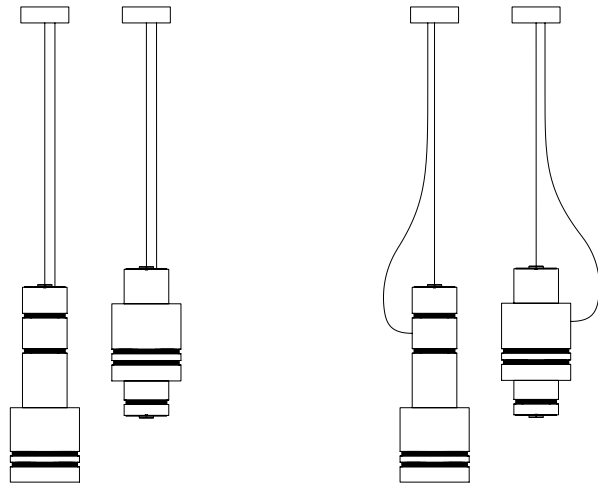

Standard Canopy Concept Diagram  
© Stackabl

Standard Canopy  
Sample In-situ Visualizations  
© Stackabl



## Pendant Canopy Types - Multi-fixture

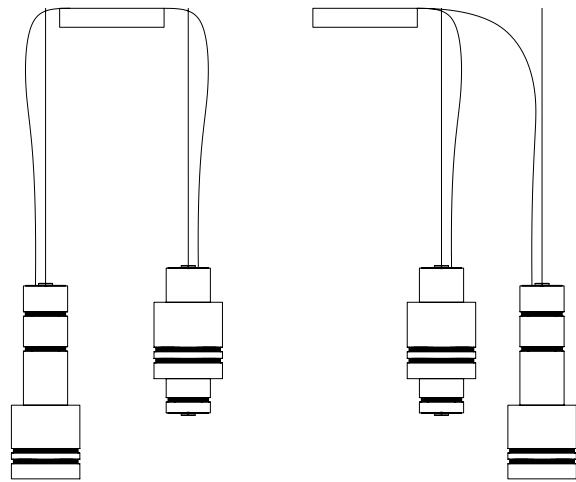

Multi-fixture Canopy Concept Diagram  
© Stackabl

Multi-fixture Canopy  
Sample In-situ Visualizations  
© Stackabl





STACK  
ABL

11#- - - - -