

# 442 Gesture™ Chair - Back and Can Cover Replacement

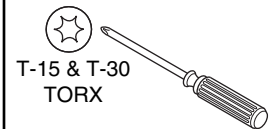

T-15 & T-30  
TORX

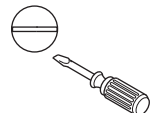
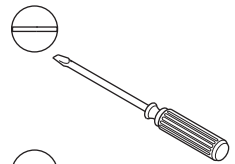
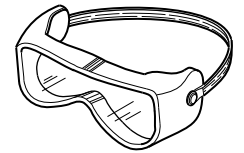
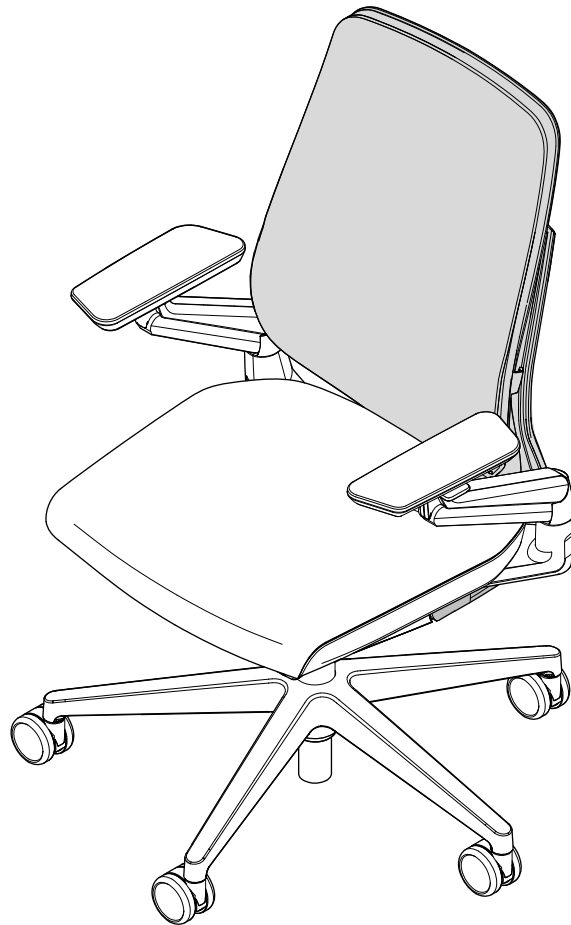

Back Release  
Tool



Safety Pin

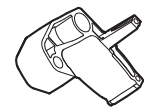

Holding Block

If you have a problem, question, or request, call  
your local dealer, or Steelcase Line 1 at  
**888.STEELCASE** (888.783.3522)  
for immediate action by people who want to help you.

(Outside the U.S.A., Canada, Mexico, Puerto Rico,  
and the U.S. Virgin Islands, call: 1.616.247.2500)

Or visit our website: [www.steelcase.com](http://www.steelcase.com)

© 2016 Steelcase Inc.  
Grand Rapids, MI 49501  
U.S.A.

Printed in U.S.A.

1. Rotate back tension knob counter clock-wise until it stops. Rotate variable back stop lever counter clock-wise until it stops (this allows the back to fully recline).

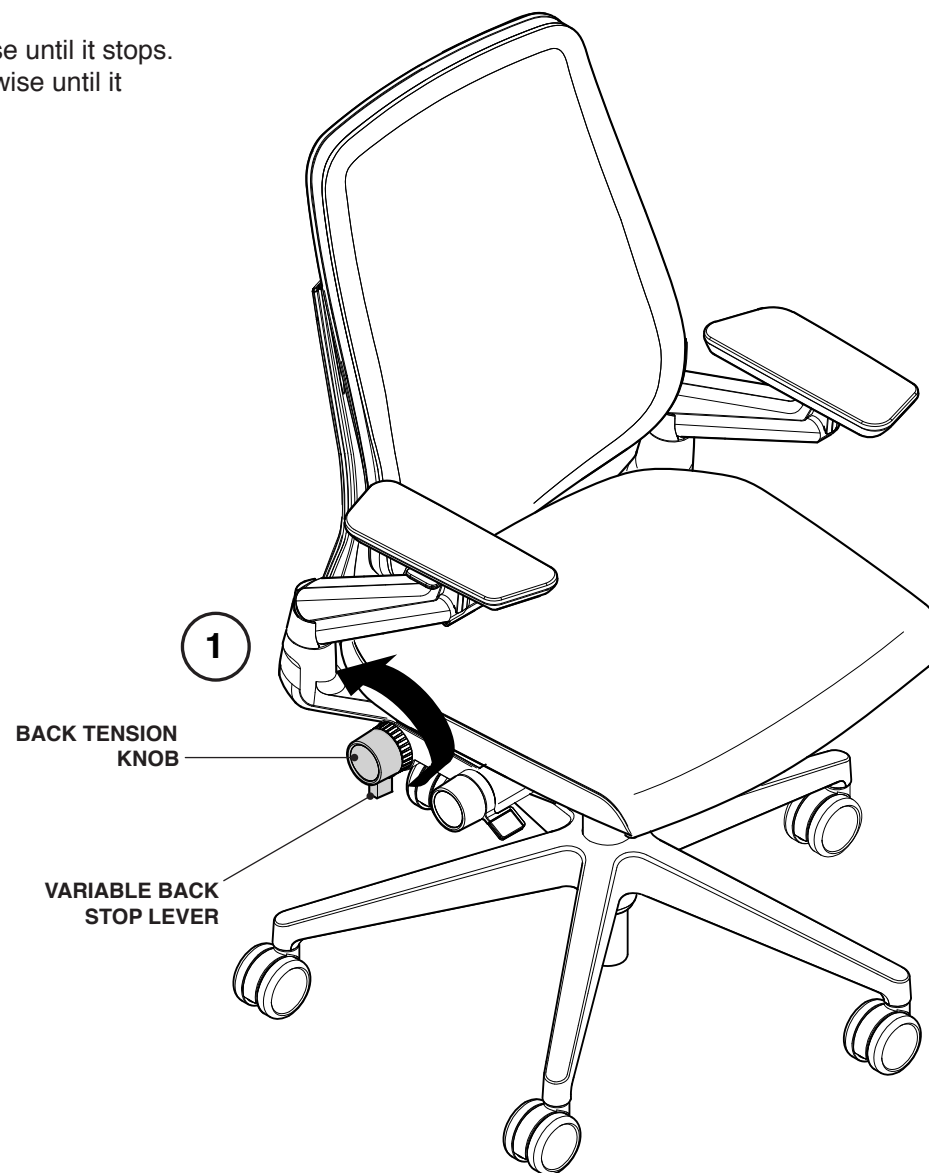

## Optional For: Standard Back Cushions

**a.** Rotate seat depth knob clock-wise to extend seat forward.

**b.** Slip fingers between cushion and outer back shell in the center of the back on both sides. Lift cushion up and forward to unhook from top of back.

**c.** Lay cushion down. Detach two (2) rubber bungees from hooks. Set back cushion aside.

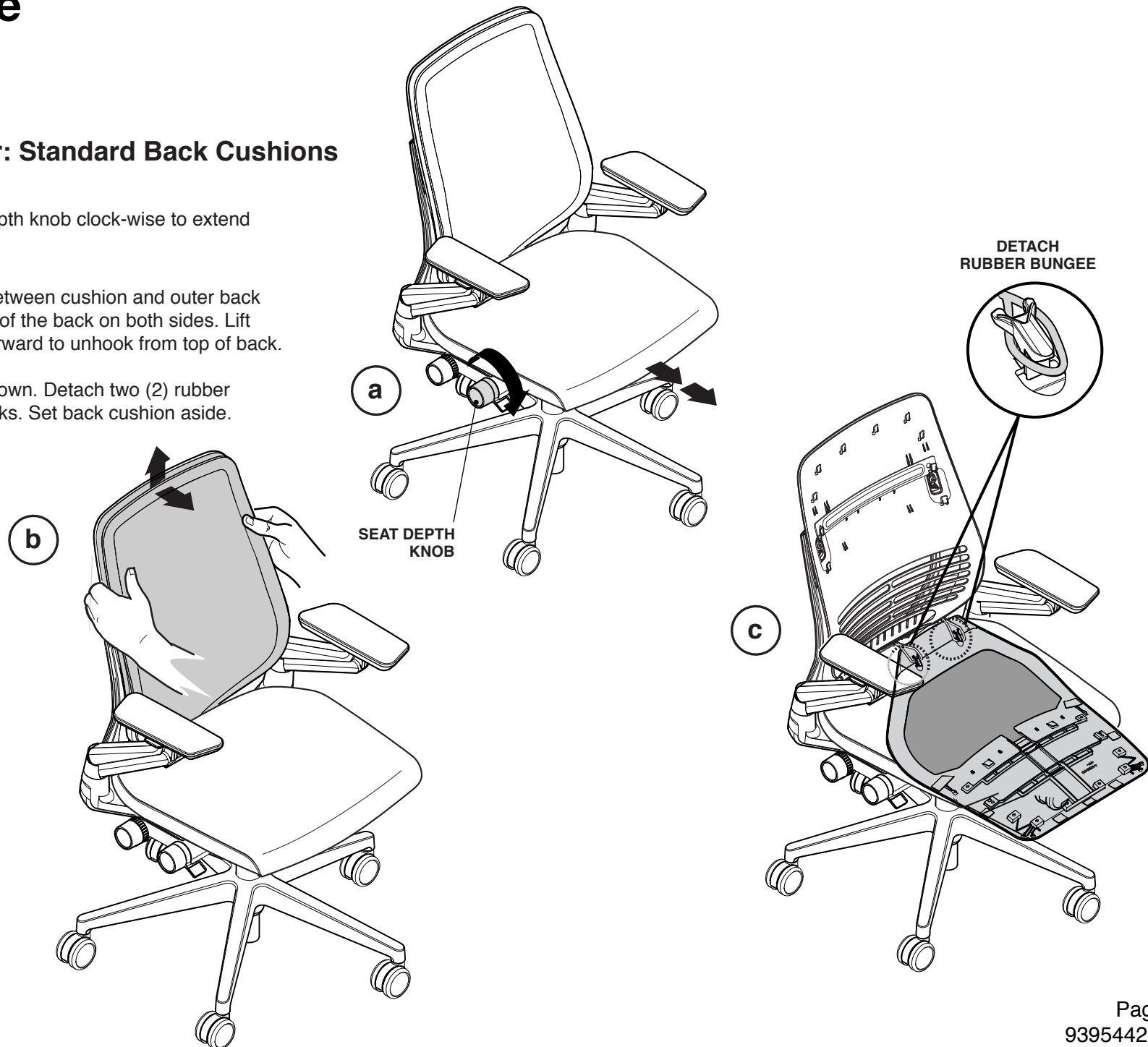

## Optional for: Wrap Back Cushion

**a.** Rotate seat depth knob clock-wise to extend seat forward.

**b.** Slip hands between bottom of back cushion and back shell on both sides. Pull bottom of back cushion forward. Un-hook (2) rubber bungees from inner back side of cushion. (Bungees are hooked over posts that have fingers to retain them.)

**c.** Slip fingers between cushion and outer back shell in the center of the back on both sides. Lift cushion up and forward to unhook from top of back. (Cushion will still be attached across the top).

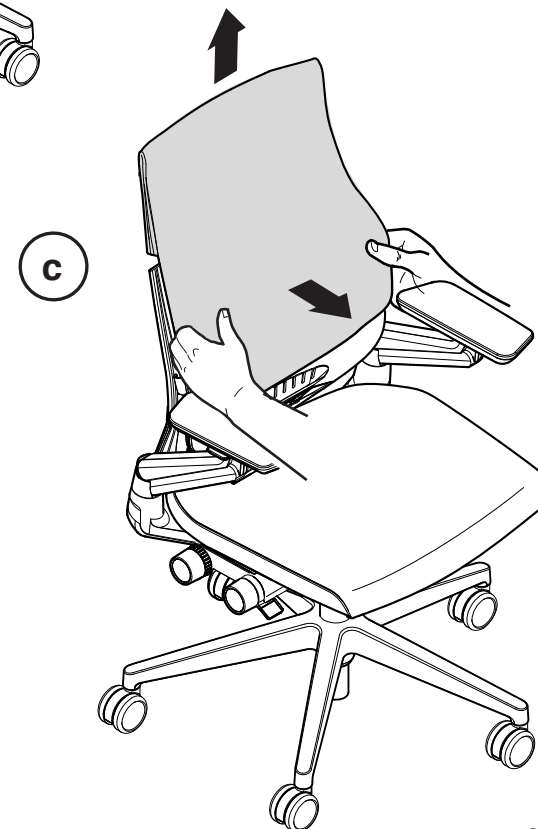
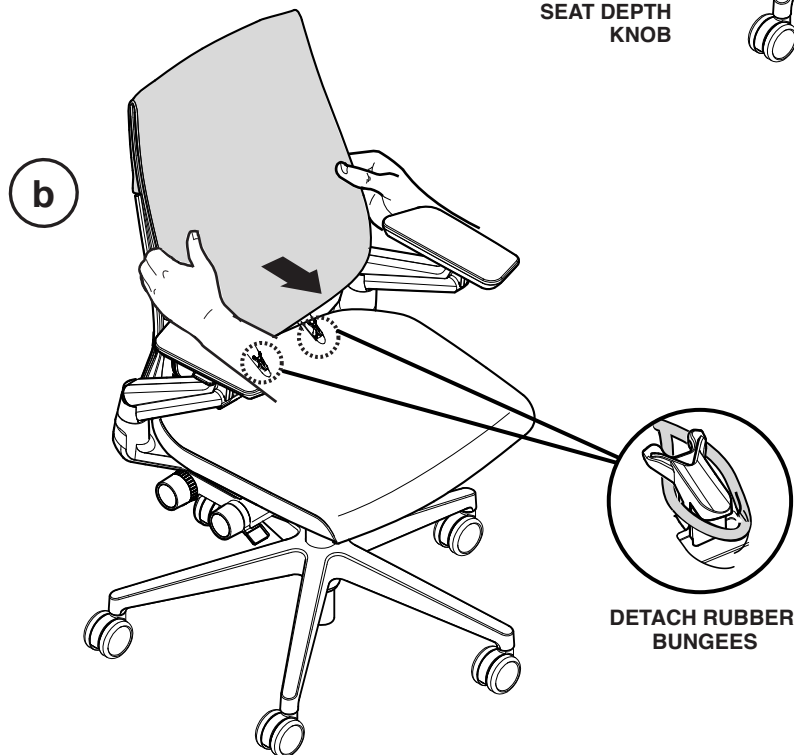
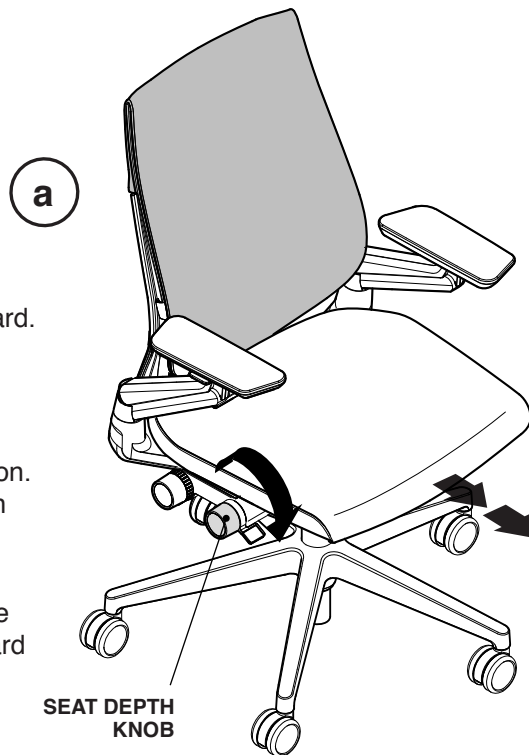



## Optional for: Wrap Back Cushion (continued)

**d.** Flip cushion up and away from back to reveal “T” clips.

**e.** Gently un-snap all (8) of the clips to release cushion flap.

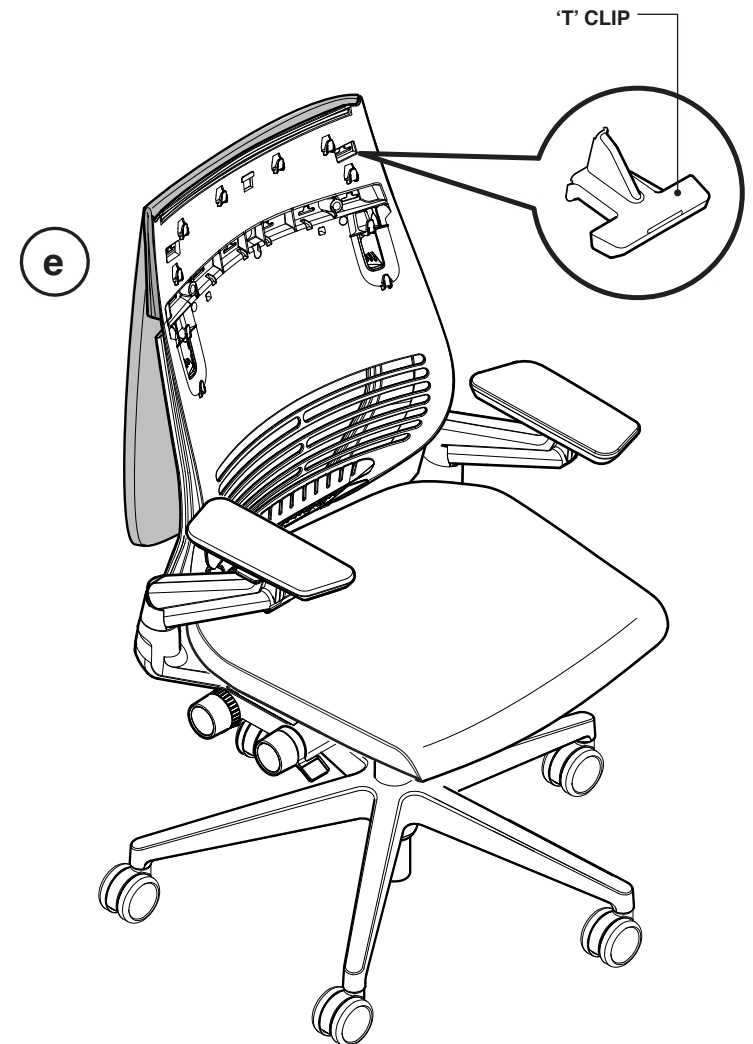
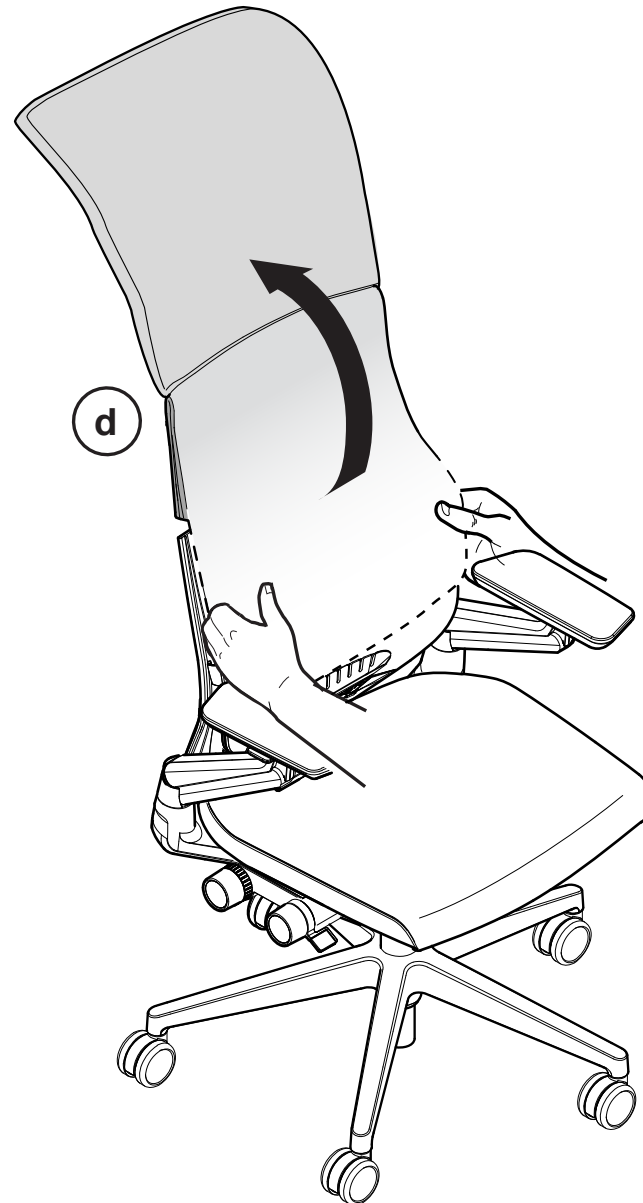

## Optional For: Headrest Cushions

- a.** Rotate seat depth knob clock-wise to extend seat forward.
- b.** Slip large screw driver between upper back cushion and outer back shell. Pull outward to disengage “T” clips. Work from one lower corner to the other. Totally remove the upper back cushion.

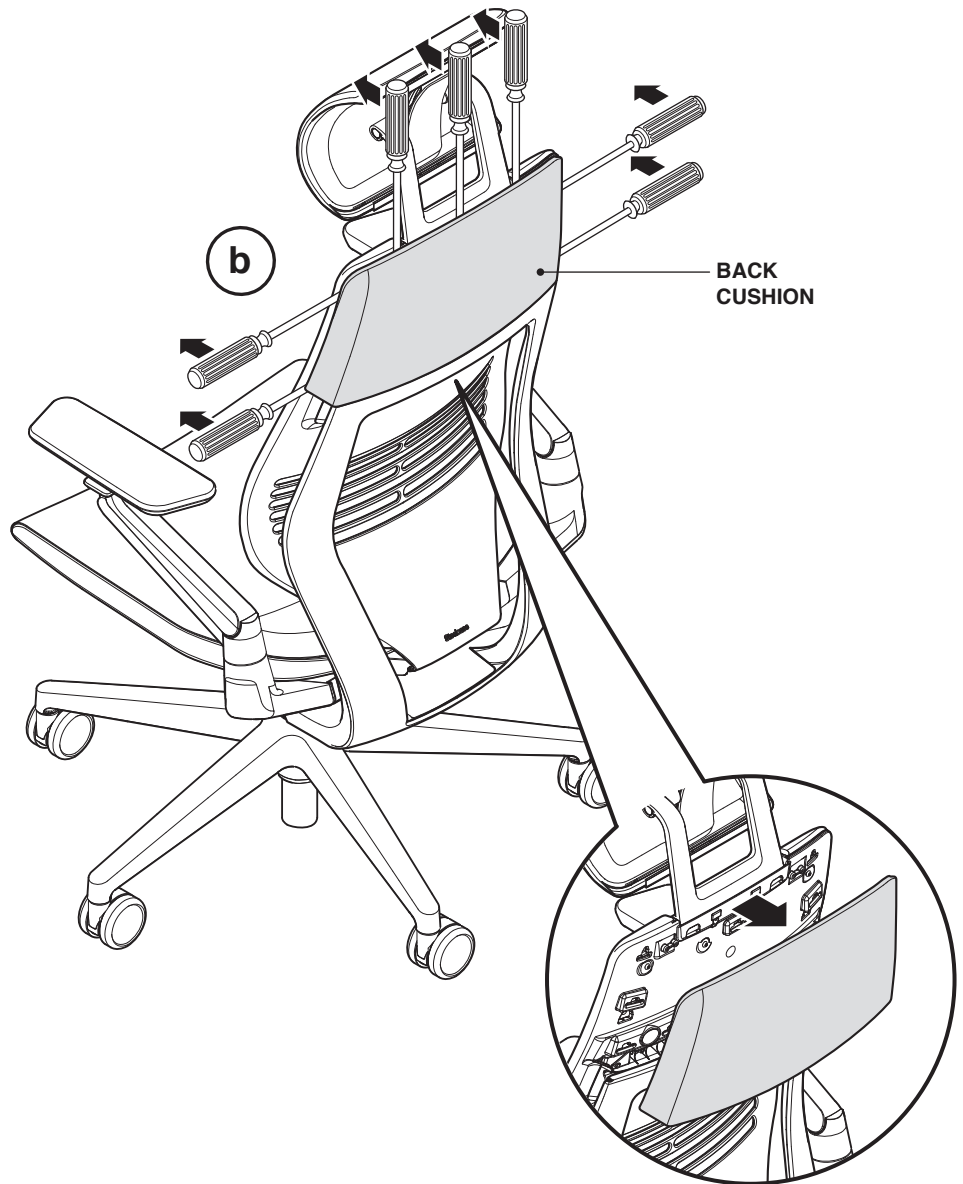
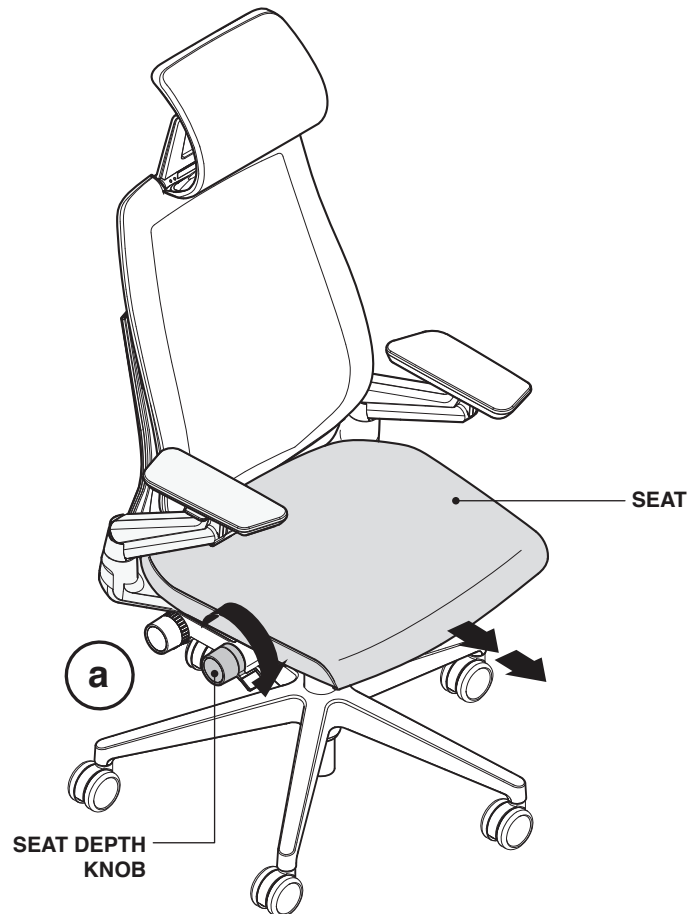

## Optional For: Headrest Cushions (continued)

**C.** Remove four (4) screws from outer back shell using a Torx 15 driver to loosen back cushion.

**d.** Slip fingers between back cushion and outer back shell in the center of the back on both sides. Lift cushion up and forward to unhook from outer back shell.

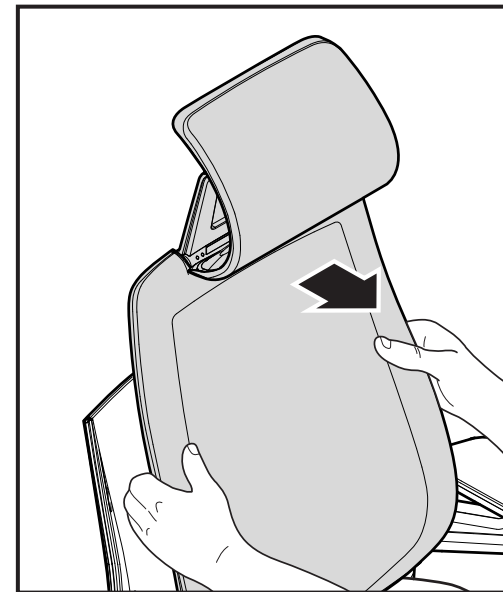
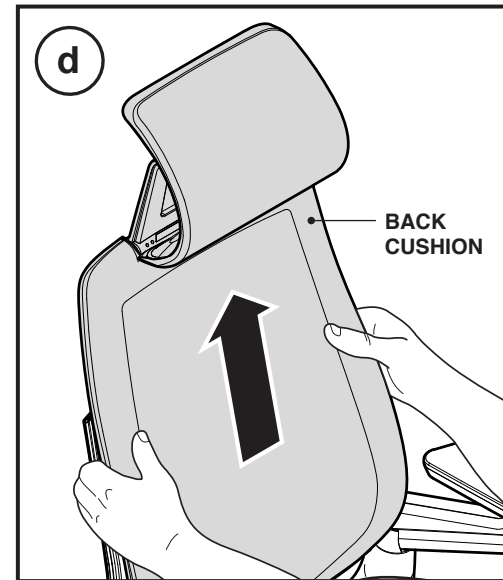
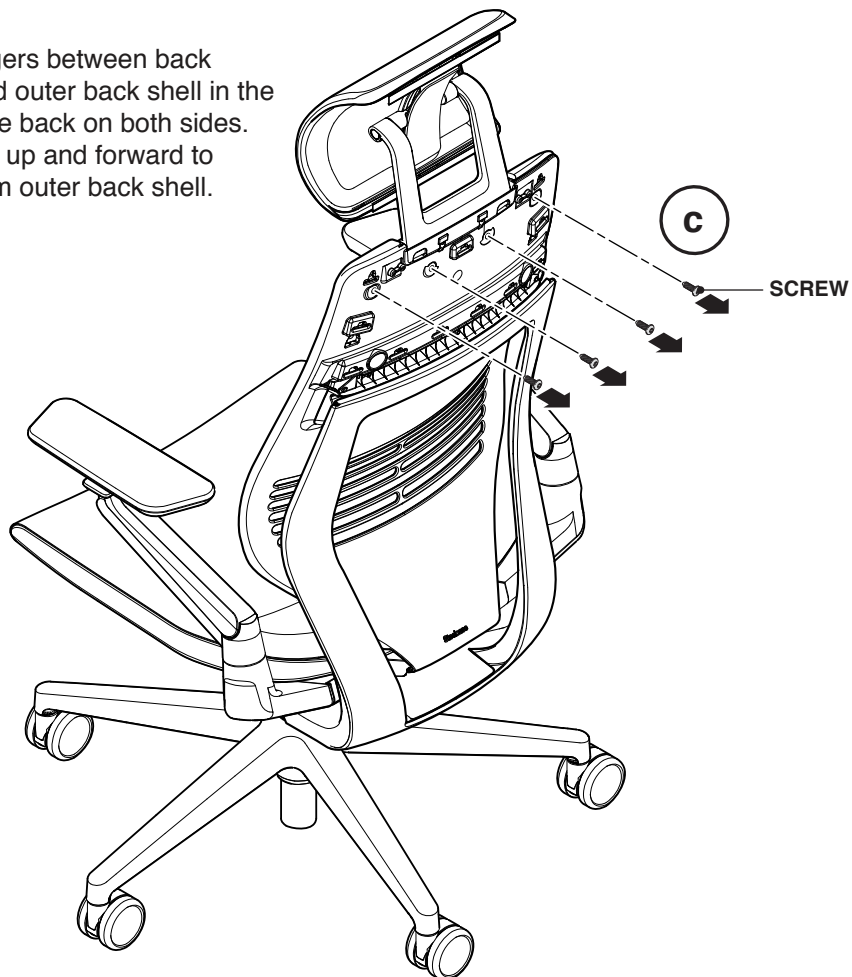

## Optional For: Headrest Cushions (continued)

**e.** Lay cushion down.

**f.** Detach two (2) rubber bungees from hooks.

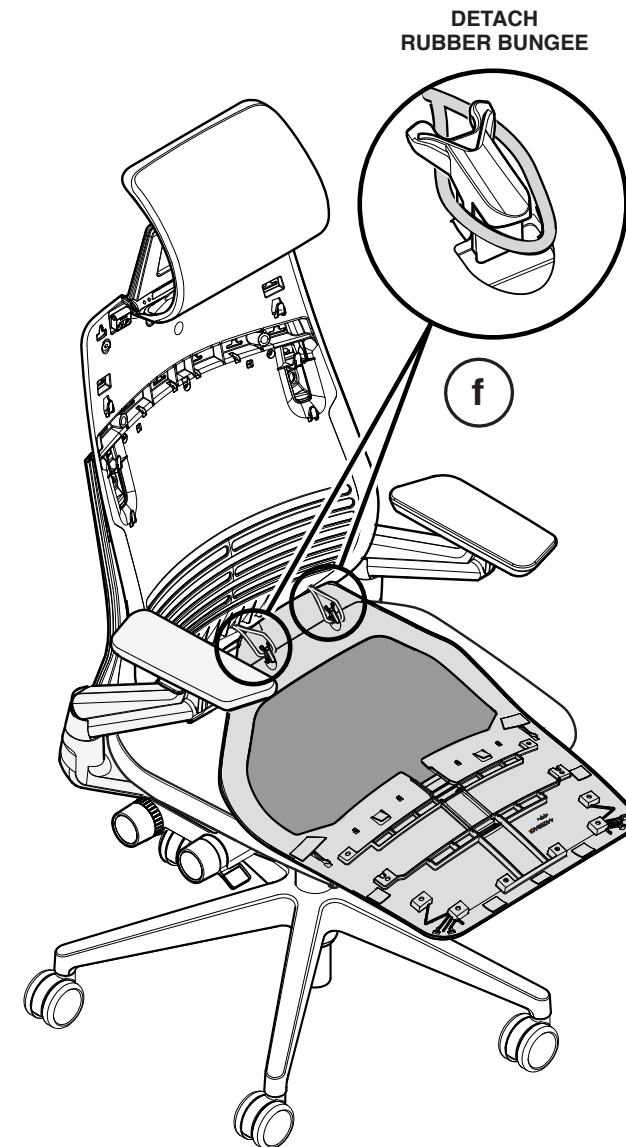
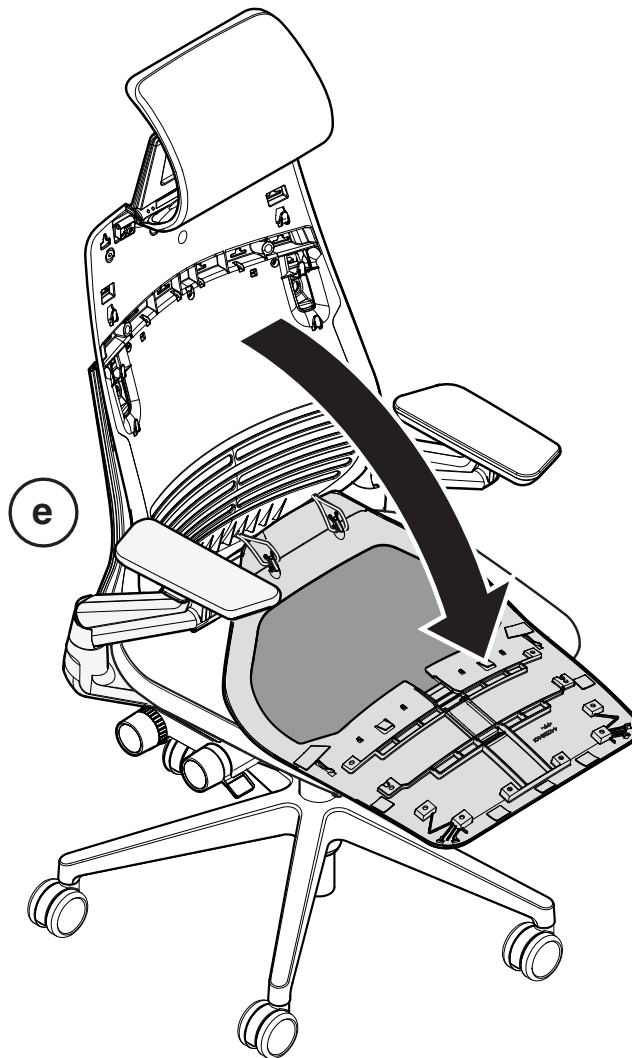

**2.** Place bent end of back release tool (p/n 442B2100) into slot of back buckle latch. Push down on end of back release tool to pivot bent end up, disengaging back buckle latch (2a). Pull bottom of back out of core equalizer (2b).

**3.** Position chair on its front and pry down bottom cover to remove.

**4.** Remove two (2) screws from back frame using a Torx-40 driver.

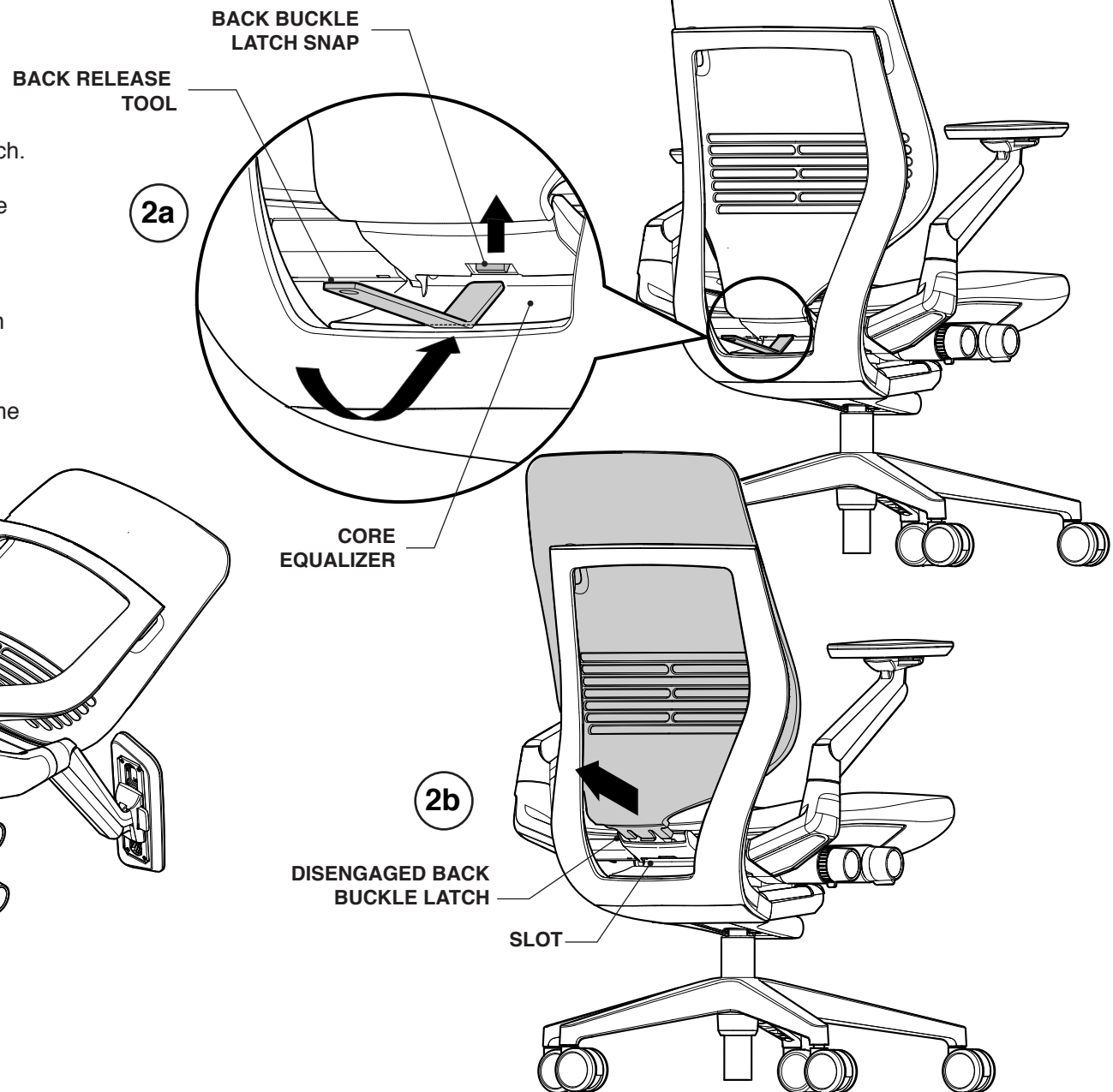

**5.** Rock the top of the back forward to compress the core equalizer spring fully (5a). Insert holding block (P/N 442B8101) and safety pin (P/N 442B9501) as shown (5b).

**6.** Remove back assembly by pulling straight out.

**7.** If you are replacing the can covers, gently pry up back end of can cover using a flat bladed screw-driver. Unhook front end of can cover and slide it off. Repeat for other side. Hook on new can covers and press on from side.

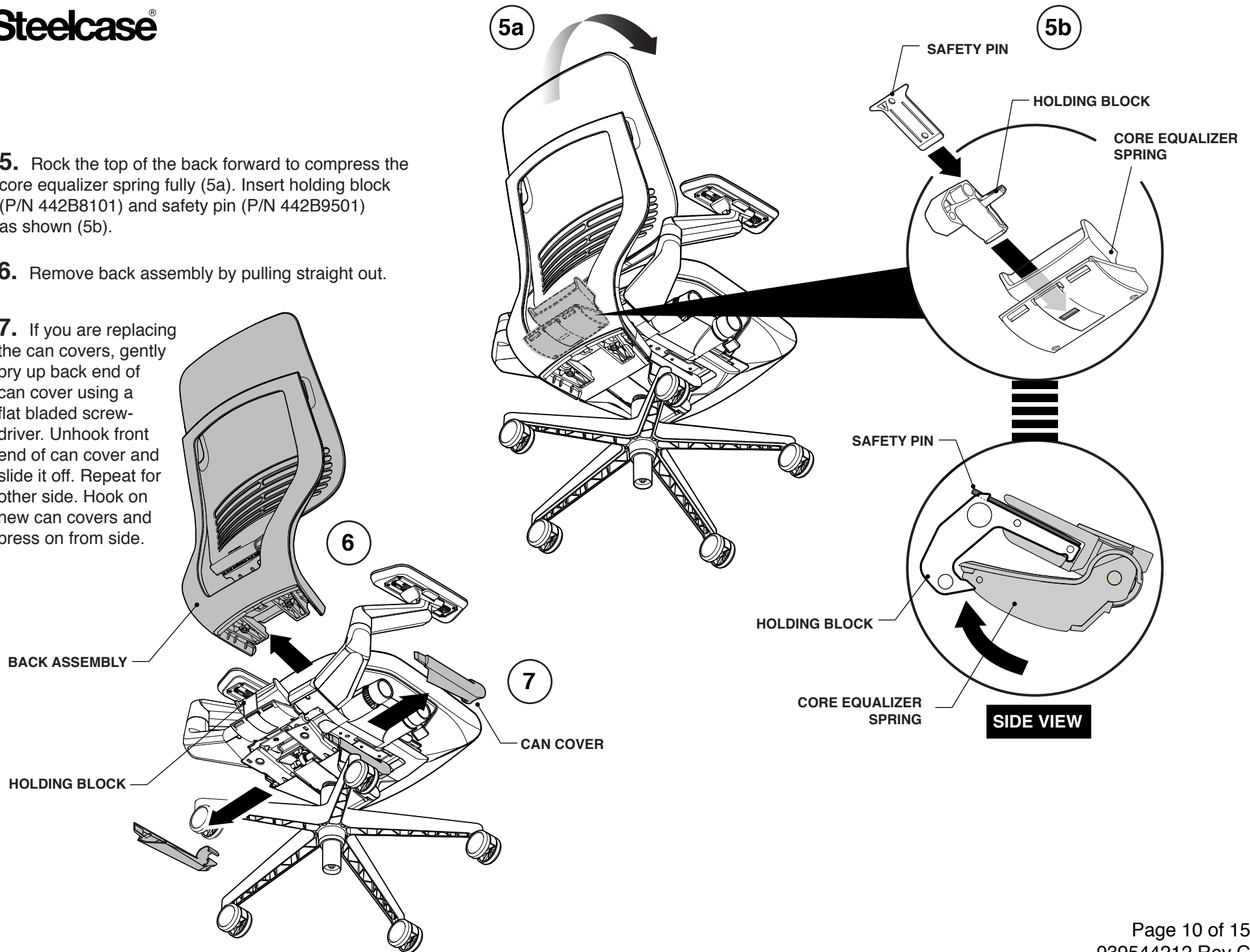



**8.** Insert new back frame. Feed in from back. Rotate it down into place. Holes should align.

**9.** Rock back frame forward to compress core equalizer spring. Remove safety pin and holding block. Carefully rock top of back rearward to release tension on spring.

**10.** Make sure back frame holes align and drive two (2) large back frame screws with T-40 Torx until seated.

**11.** Replace bottom cover by aligning two (2) hooks in cover into steel holes in mechanism. Slide down to engage snaps.

**12.** Snap bottom of lower back into back buckle latch.

**13.** Set chair up and reinstall back cushion to finish.

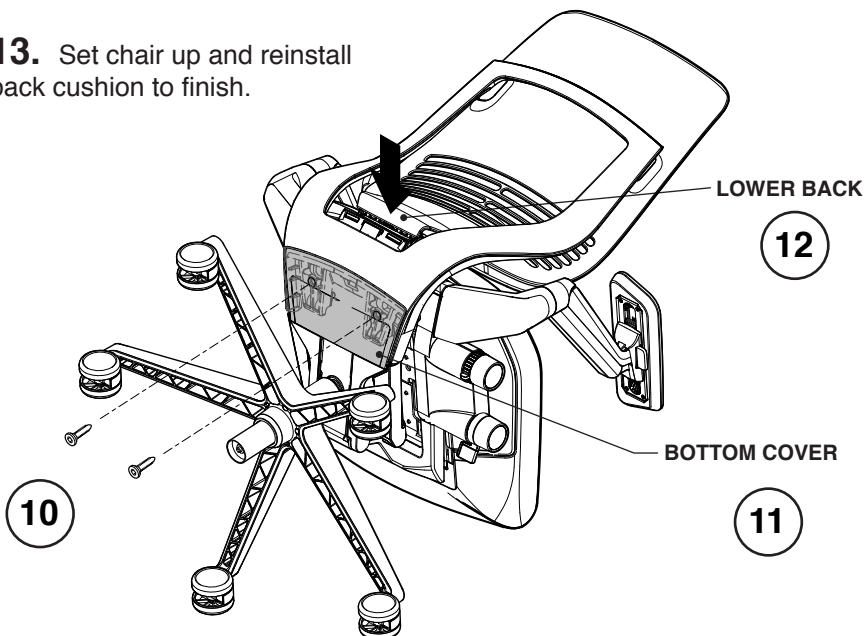
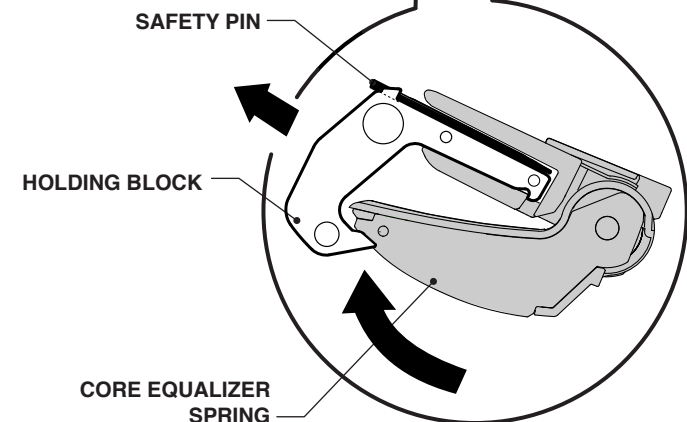
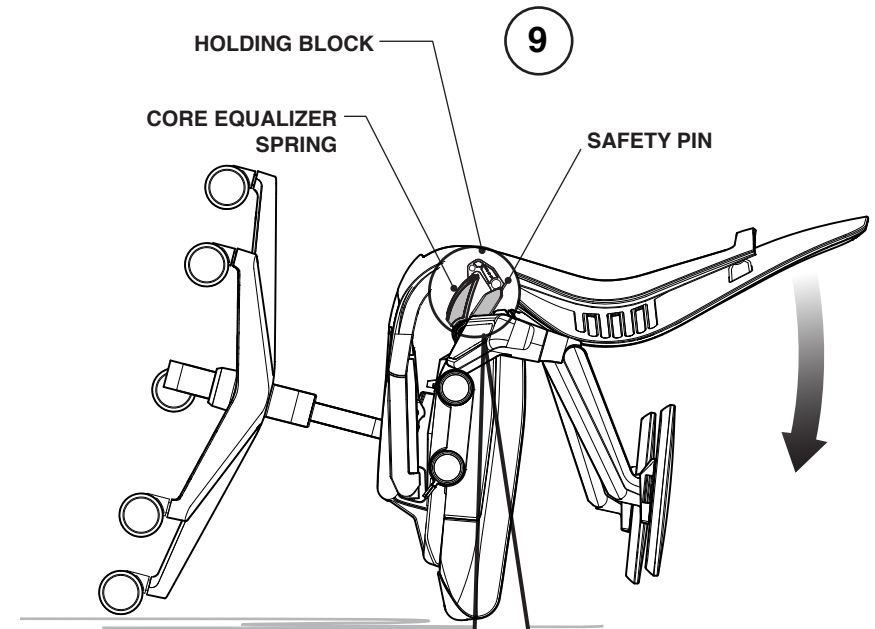
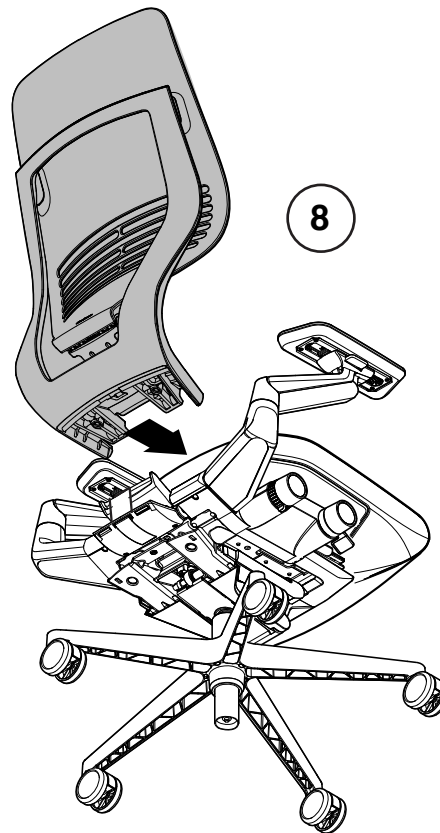

## Standard Cushion Installation

**14.** To reinstall cushion, lay cushion down on seat. Attach (2) rubber bungees. Lift and Pull top of cushion slightly past top of back shell. Hook lumbar handles around back shell on each side. Hold cushion tight against the back shell and slide down onto hooks. Make sure all hooks are engaged and the cushion and shell appear seamless.

## Wrap Cushion Installation

**15.** When bringing the wrap back over the top of the chair, push it towards the back, parallel to the seat so the alignment cones and hooks on the bottom and side snap together. If needed, adjust fabric at top to smooth.

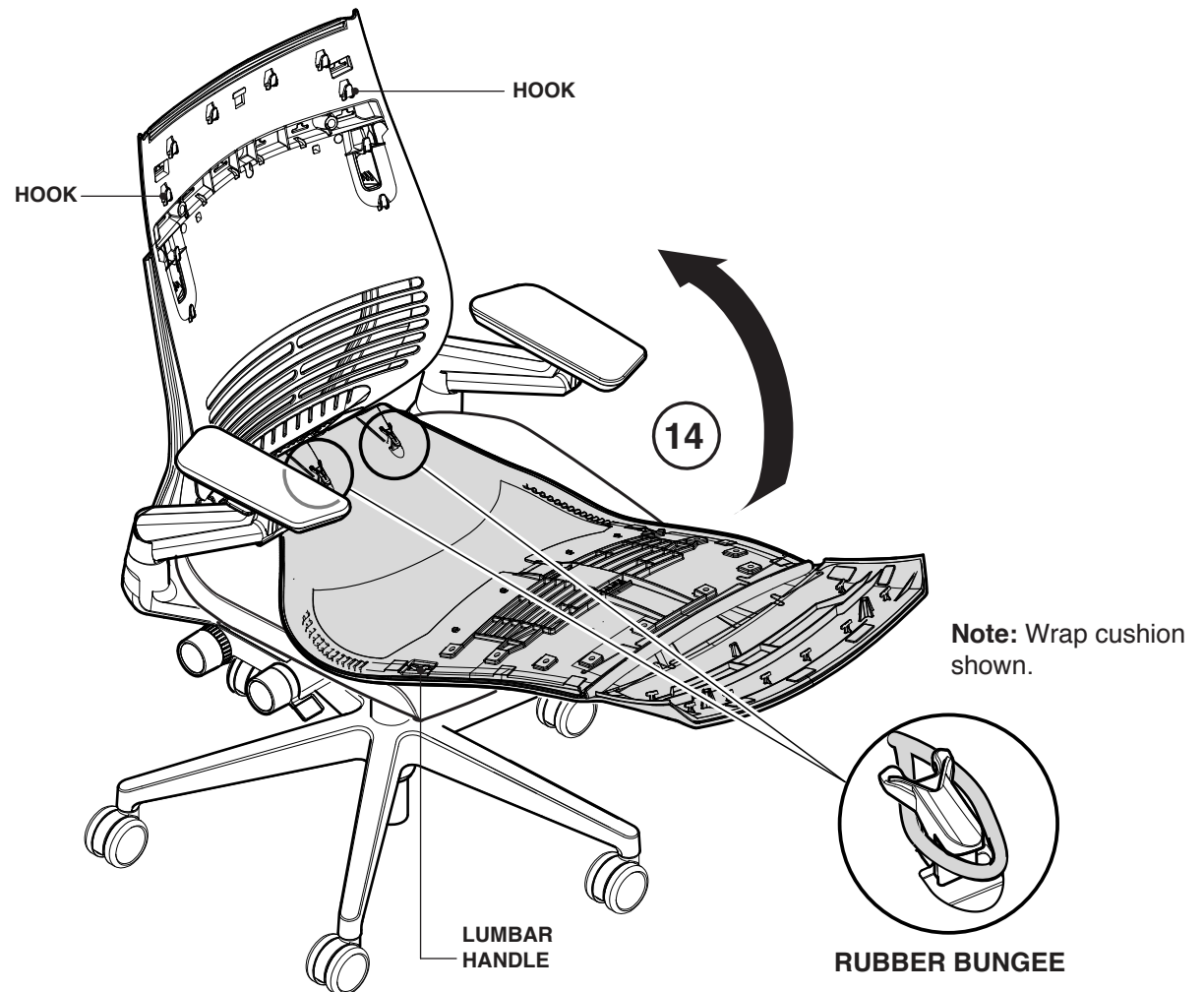



## Headrest Cushions Installation

- a.** Lay cushion down on seat.
- b.** Attach two (2) rubber bungees onto back cushion hooks.
- c.** Lift and pull top of cushion slightly past top of back shell. Hook lumbar handles around back shell on each side. Hold cushion tight against the back shell and slide down onto hooks. Make sure all hooks are engaged and the cushion and shell appear seamless.

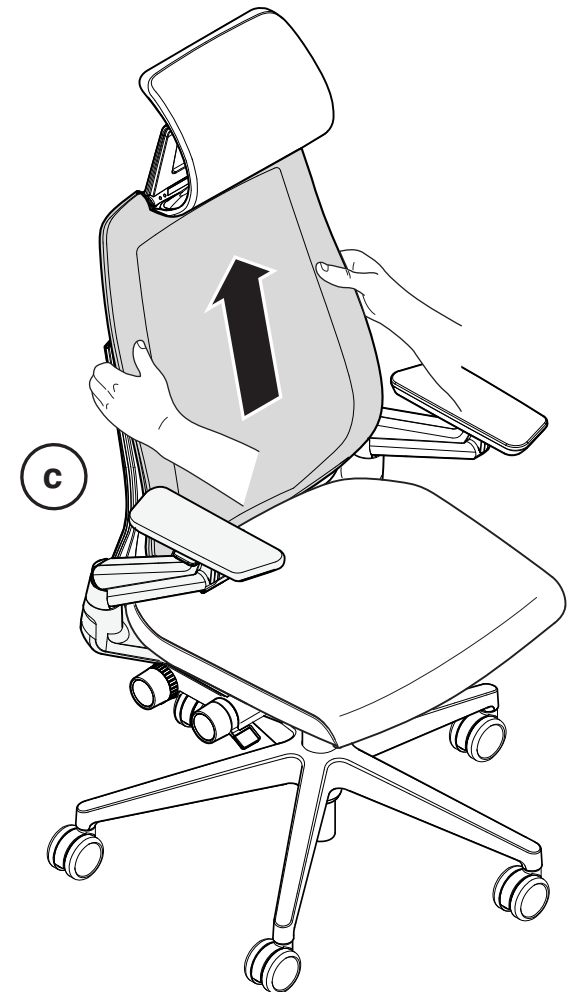
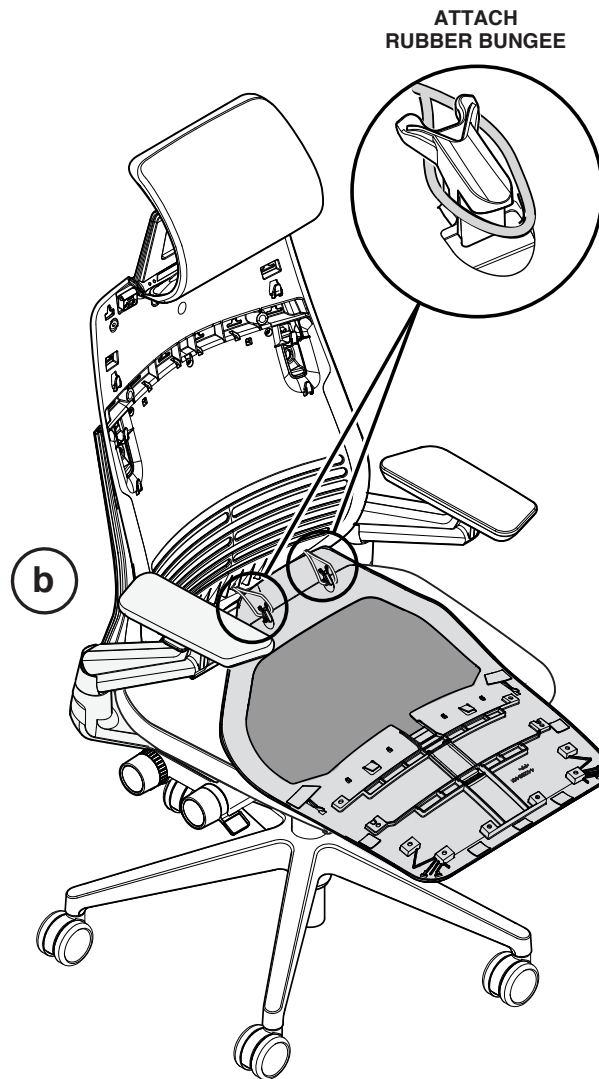

## To Assemble the Headrest Cushions (continued)

**d.** Install four (4) screw through outer back shell using a Torx-15 driver into back cushion.

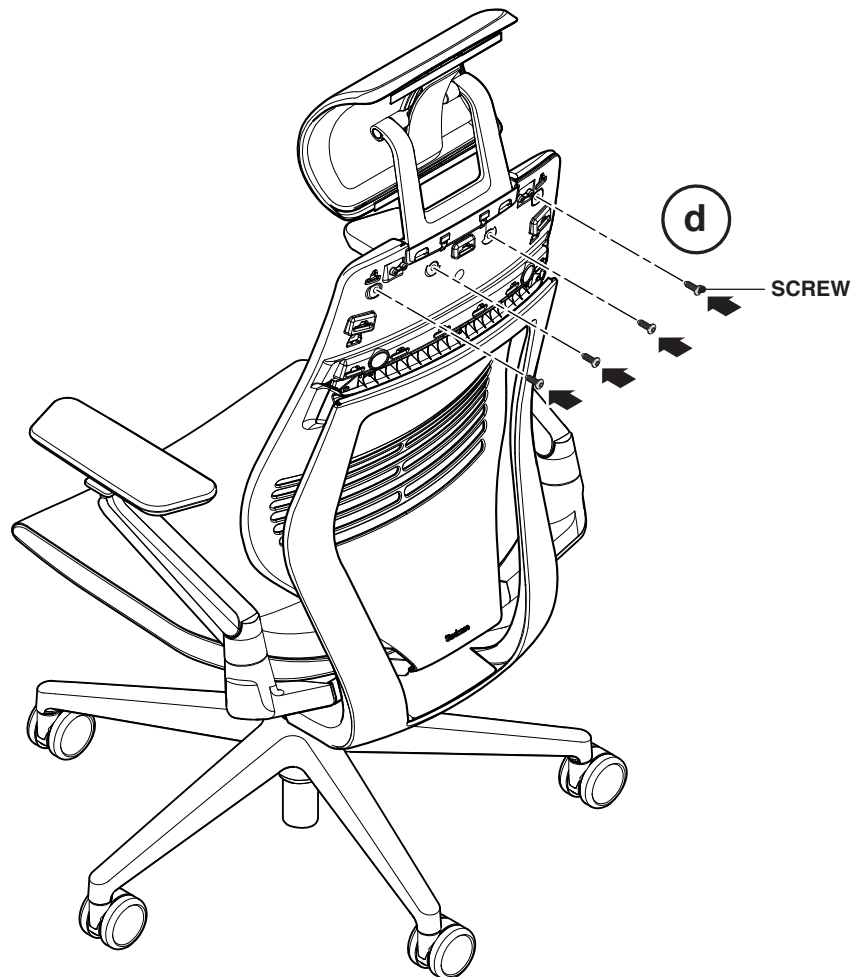

**e.** To assemble the replacement upper back cushion, align the top two, outer corner snaps with their corresponding “T” slots.

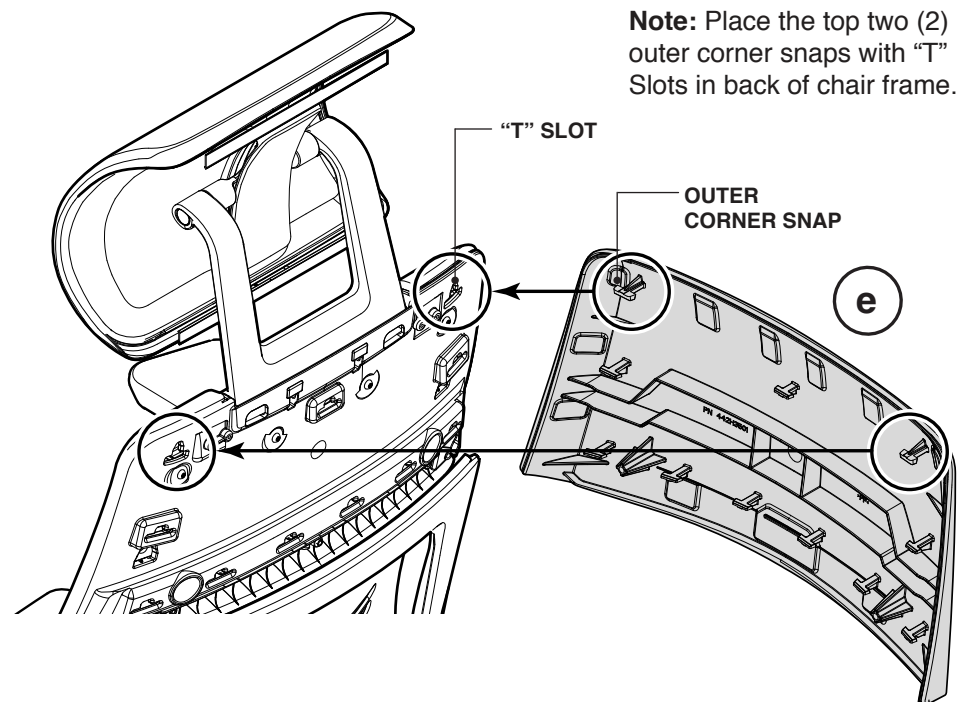

## To Assemble the Headrest Cushions (continued)

**f.** Insert and squeeze both corners. The rest of the snaps will align. Push all of the way around the perimeter to finish the assembly.

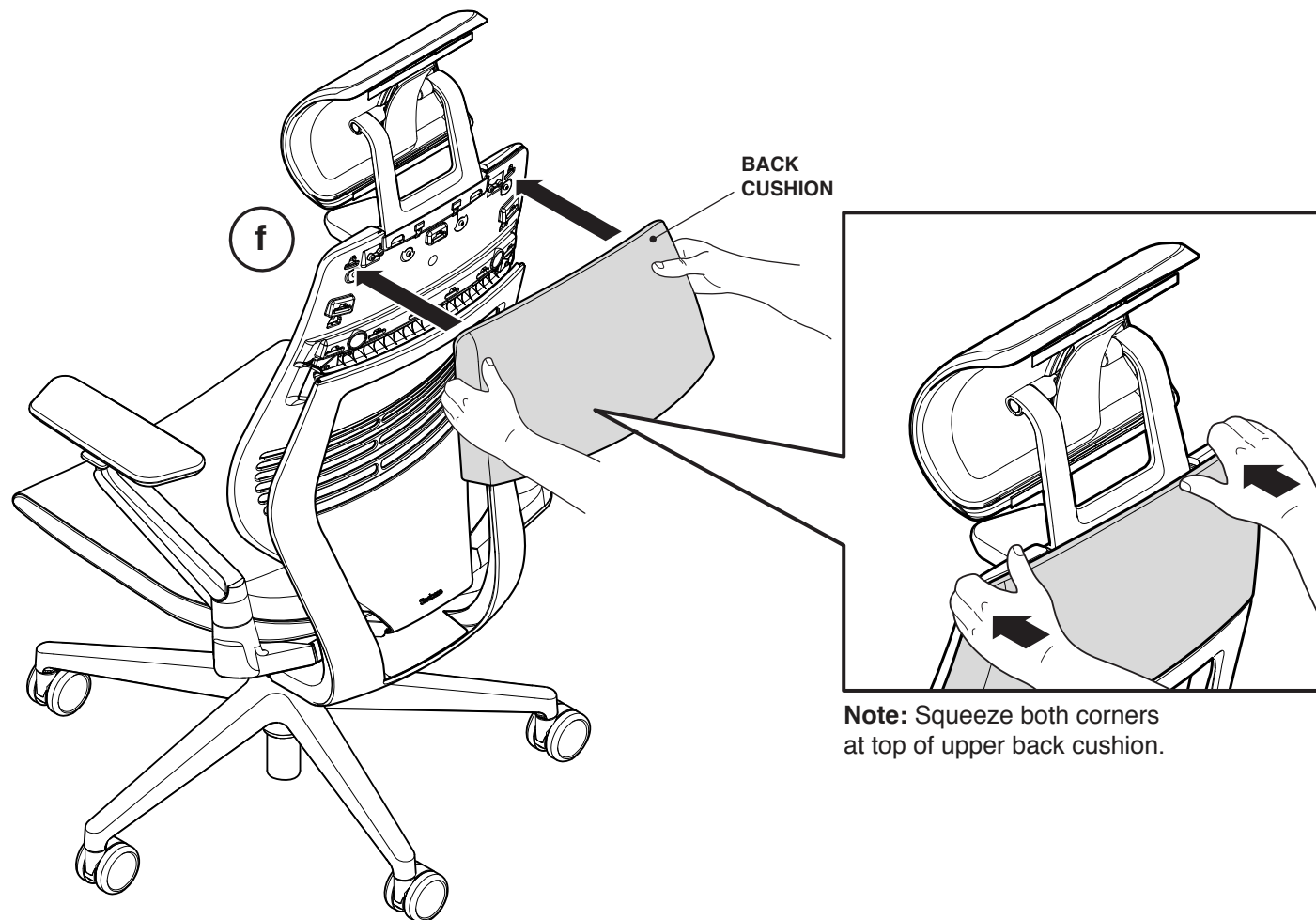

**Note:** Squeeze both corners at top of upper back cushion.