

If you have a problem, question, or request, call
your local dealer, or Steelcase Line 1 at
888.STEELCASE (888.783.3522)
for immediate action by people who want to help you.

(Outside the U.S.A., Canada, Mexico, Puerto Rico,
and the U.S. Virgin Islands, call: 1.616.247.2500)
Or visit our website: www.steelcase.com

© 2016 Steelcase Inc.
Grand Rapids, MI 49501
U.S.A.

Printed in U.S.A.

1. Rotate the top of the headrest backwards (1a). Slip a large screw driver between headrest cushion and shell (1b). Pry upwards to disengage snaps on back of cushion (1c). (There are 2 snaps on each side, top and bottom.) Totally separate them (1d).

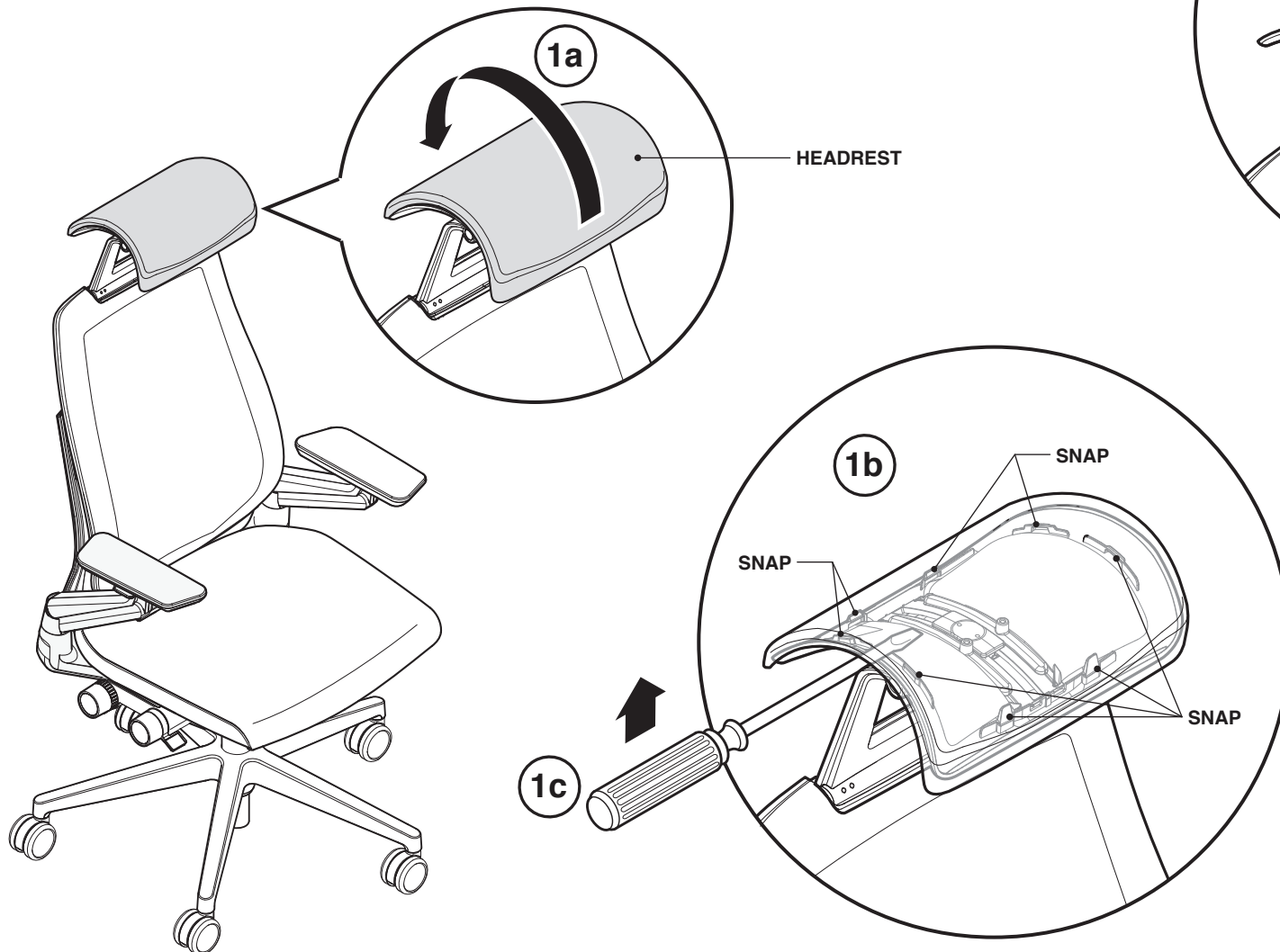

2. Install new cushion by centering side to side and aligning the bottom snaps (2a). Slide the new cushion down into the snaps (2b).

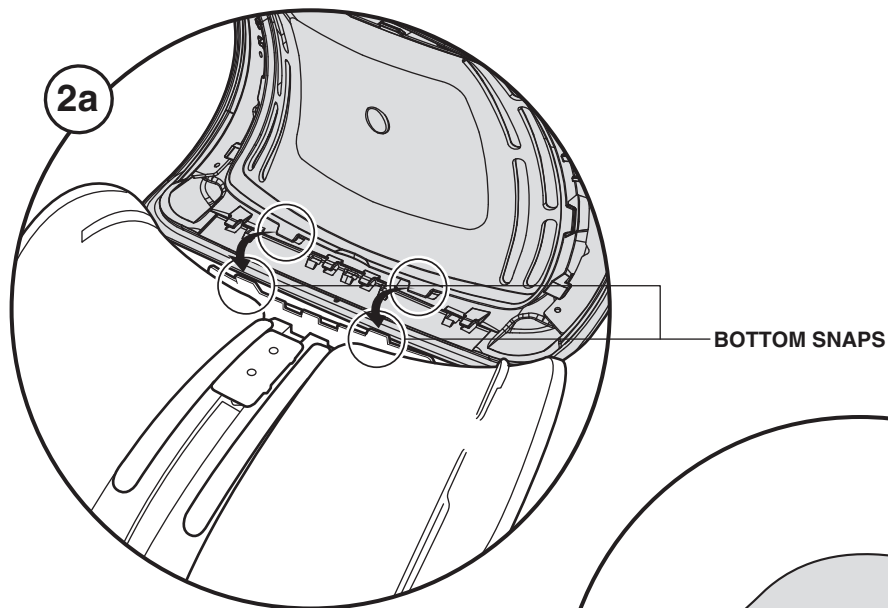

Side View

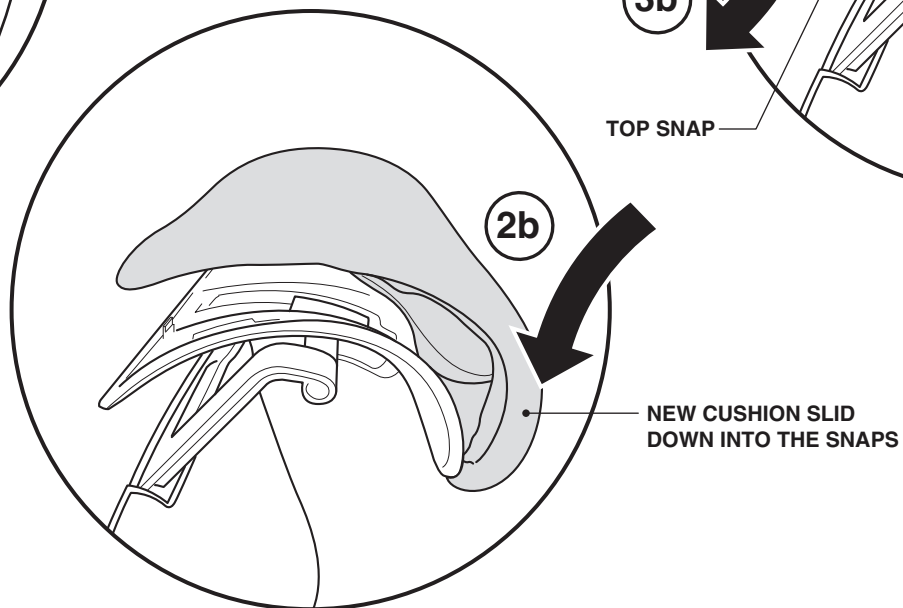

Side View

3. Flex the top of the cushion back to clear the top hooks (3a). Slide top edge down and engage the top snaps (3b).

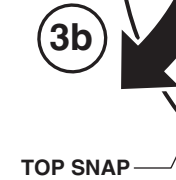
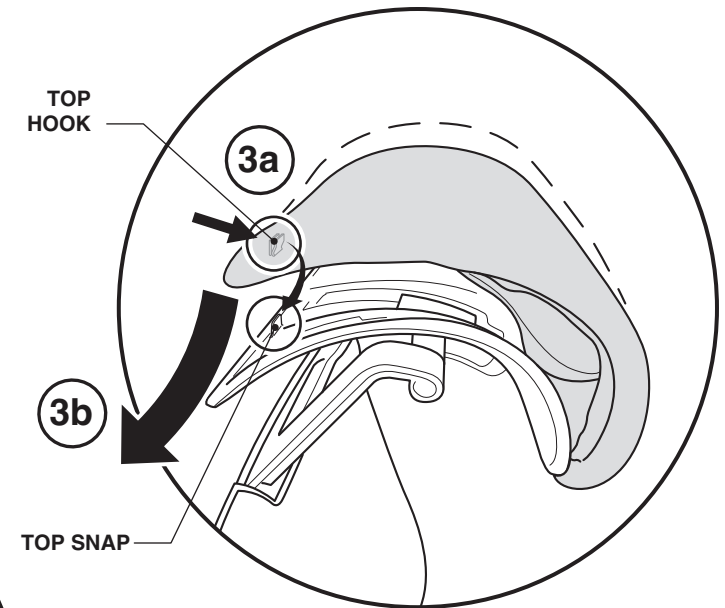

Side View

- 4.** Squeeze both sides of the cushion to engage the side snaps. The cushion will sit tight against the shell all of the way around when properly installed.

