



CHAMBORD EXTRA LARGE PENDANT

LXP10212

General Product Information

 <p>Intertek</p>	 <p>SAVE THESE INSTRUCTIONS!</p>	 <p>INDOOR</p>	 <p>DAMP LOCATION SAFE</p>
 <p>NEC COMPLIANT JUNCTION BOX</p>	 <p>CONVERTS TO LED</p>	 <p>PLEASE SEE visualcomfort.com FOR PRODUCT SPECS</p>	 <p>CLEAN WITH SOFT, DRY CLOTH ONLY. NO HARSH CHEMICALS!</p>

WARRANTY

FCC STATEMENT

Tools Required

 <p>PHILLIPS-HEAD SCREWDRIVER</p>	 <p>WIRE CUTTER</p>
--	--

Safety Information

CAUTION-RISK OF FIRE

This product must be installed in accordance with the applicable installation code by a person familiar with the construction and operation of the product and the hazards involved.

USE MINIMUM 90°C SUPPLY CONDUCTORS.

 Turn off electrical current at the source before working with any lighting fixture or portable lamp.

Install and use this product in adherence with local electrical codes and regulations.



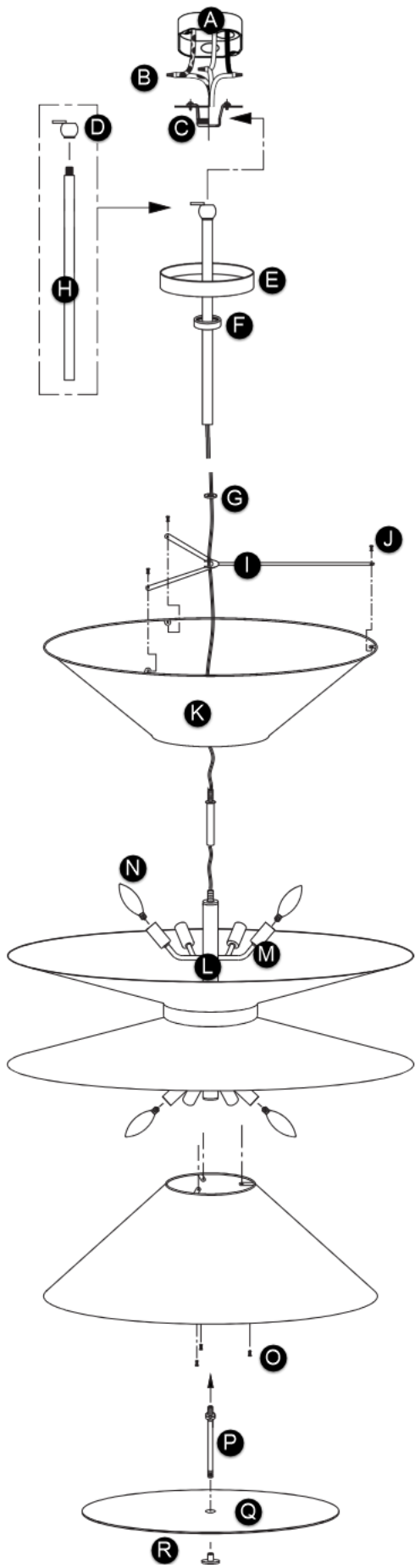

FIXTURE PARTS

- A. Junction Box
- B. Wires and Nuts
- C. Mounting Plate
- D. Half Ball
- E. Canopy
- F. Collar Nut
- G. Shade nut
- H. Top Stem
- I. Shade Spider
- J. Top Shade Screws
- K. Paper Shades
- L. Socket assembly
- M. Socket
- N. Bulb (Not Included)
- O. Bottom shade Screws
- P. Bottom Stem
- Q. Glass Diffuser
- R. Cap Nut

INSTRUCTIONS

I. Preparing for Installation

1. Feed the fixture and ground wires through the upper pipe and secure them onto the socket assembly.
2. Secure the shade spider onto the top paper shade using the provided screws.
3. Feed the fixture and ground wires through the shade and the spider nut.
4. Seat the shade spider onto the upper pipe and secure the shade in place using the spider nut.
5. Screw the half ball to the top stem.
6. Determine the desired height of the fixture using the stems and assemble them, accordingly, by screwing them together.
7. Feed the fixture and ground wires through the stem assembly.
8. Screw the stem assembly onto the threaded nipple on top of the fixture assembly.
9. Feed the fixture and ground wires through the collar nut, canopy, and the half ball assembly.
10. Screw that half ball onto the stem assembly.
11. Align and secure the mounting plate to the junction box.
12. Slide the half ball assembly onto the mounting plate.
13. Trim the cord. Ensure to leave enough length to make the electrical connection.

II. Wiring the Fixture

1. Safety first! Locate the circuit breaker and switch it off to cut off the power supply to the relevant circuits to ensure there's no electricity running through the wiring.
2. In accordance with local electrical codes, connect the fixture ground wire (bare copper or silver wire) to suitable ground. This may be a green ground screw on the mounting plate or a house wire (green or bare copper wire without insulation).
3. Twist the bare ends of the following pairs of wires together using a wire nut to secure a connection:
 - a) Hot fixture wire (round and smooth) and hot power line wire from the junction box (hot to hot)
 - b) Neutral fixture wire (square and rigid) and neutral power line wire from the junction box (neutral to neutral)
4. Carefully tuck all the wires into the junction box.

III. Installing the Fixture

1. Install the canopy to the junction box and secure with the collar nut.
2. Place the bottom paper shade through the lower socket cluster against its base and align and secure it in place using the bottom shade screws.
3. Screw the bottom stem onto the lower socket cluster base.
4. Screw the bulbs into the sockets, referring to the label on the bulb socket for Max Wattage information.
5. Install the glass diffuser onto the bottom paper shade by fastening the cap nut onto the bottom stem (don't overtighten). **Note: The silk screen side of the glass is facing up, and the clear side is facing down.**