

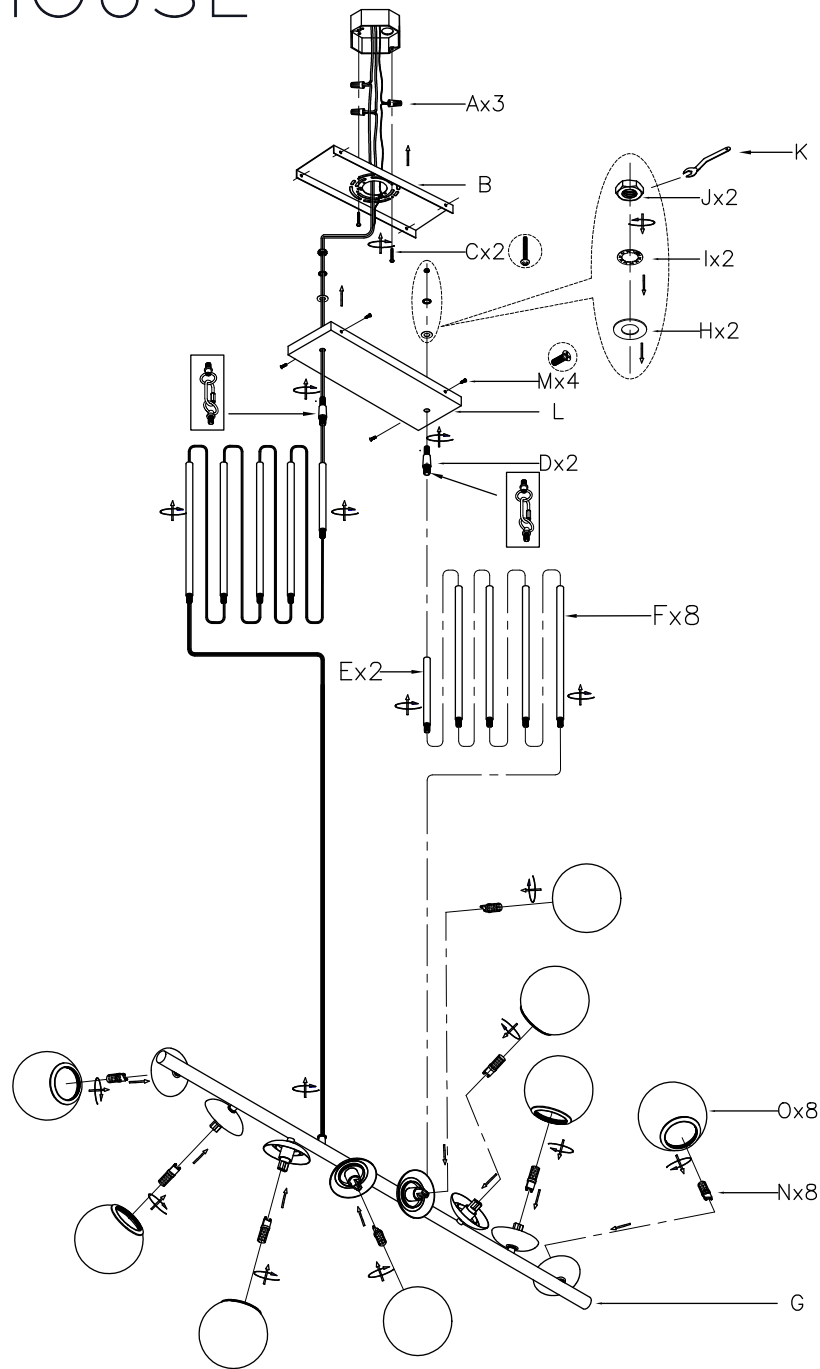

SAVOY
HOUSE

ITEM NO:
1-6524-8-322



ASSEMBLY INSTRUCTIONS

1. Carefully unpack and identify all parts.
2. Turn the power to the installation point OFF.
3. Assemble the tubes (E, F) together, evenly divided between the left and right sides, and thread the bottom ends into the two couplings of the fixture body (G) until snug. Thread the top ends onto the loops (D).
4. Install the hex nuts (J), the serrated lock washers (I) and flat washers (H) at the two couplings of the canopy (L) then using wrench (K) to secure them.
5. Thread the fixture wires through the center hole of the mounting plate (B). Using the wire connectors (A) provided to connect fixture wires and supply wires: black to black, white to white, and ground to copper/bare.
6. Attach the mounting plate (B) to the junction box and secure it by using the two screws (C). The side of the mounting plate marked "GND" must face outward.
7. Attach the canopy (L) to the mounting plate (B) and secure it by using the four screws (M).
8. Install proper bulbs (N) (not included) into the sockets, referring to the markings and/or labels on the fixture for maximum wattage.
9. Place the glass shades (O) onto each socket and tighten them.
10. Restore power to the installation point and retain this sheet for future reference.