

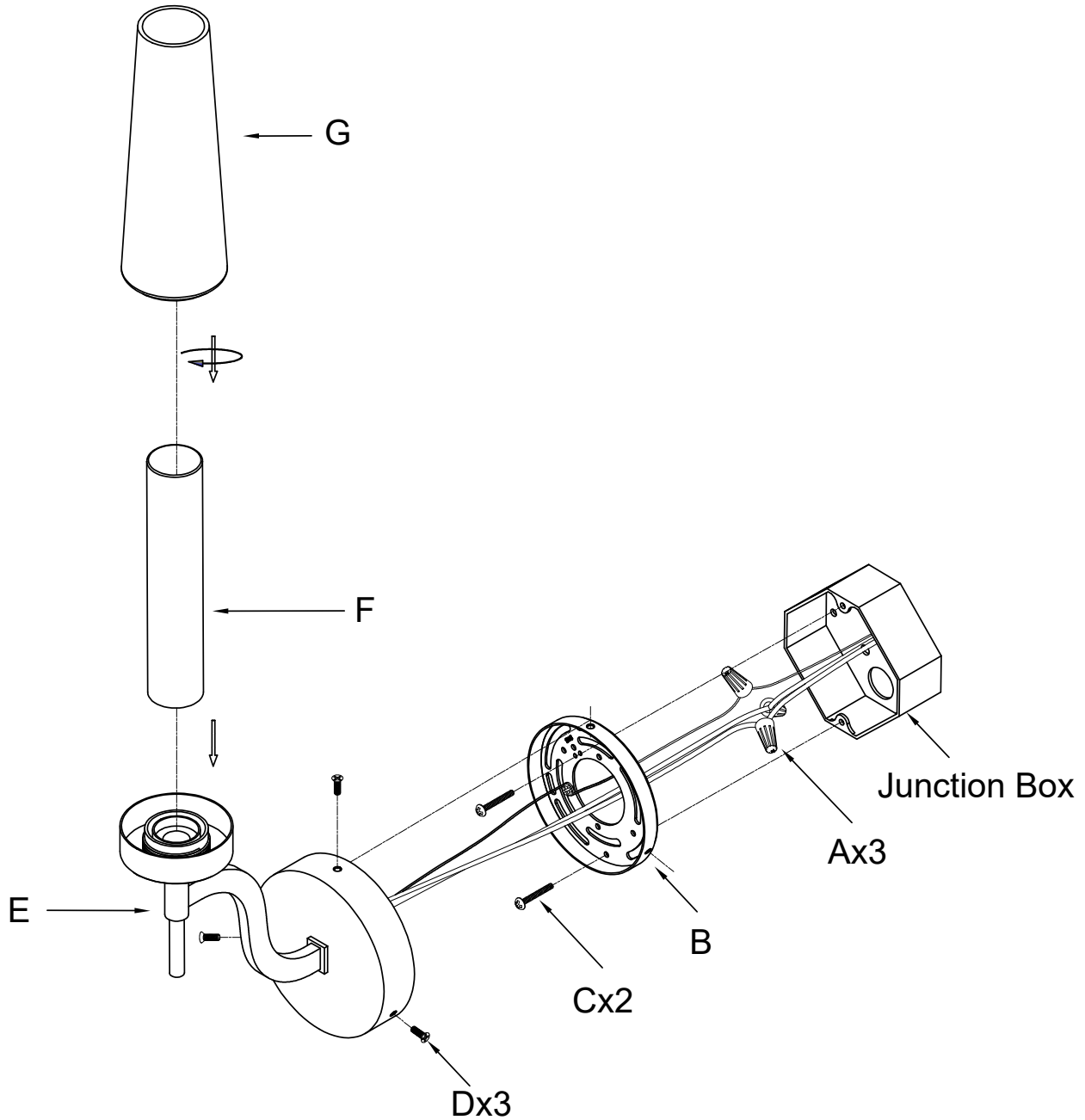

SAVOY
HOUSE

ITEM NO:
9-1463-1-15
9-1463-1-322



ASSEMBLY INSTRUCTIONS

1. Carefully unpack and identify all parts referring to illustration for parts identification.
2. Turn the power to the installation point OFF.
3. Attach the mounting plate (B) to the junction box and secure it by using the two screws (C).
4. Connect the white wire from the fixture to the white wire of the junction box.
Connect the black wire from the fixture to the black wire of the junction box.
Connect the ground wire from the fixture to the ground wire of the junction box by using the wire connectors (A) provided.
5. Install the fixture (E) onto the mounting plate (B) using side screws (D).
6. Place the inner glass shade (F) onto the socket. Then place the outer glass shade (G) on and tighten it firmly.
7. Restore power to the installation point and retain this sheet for future reference.