

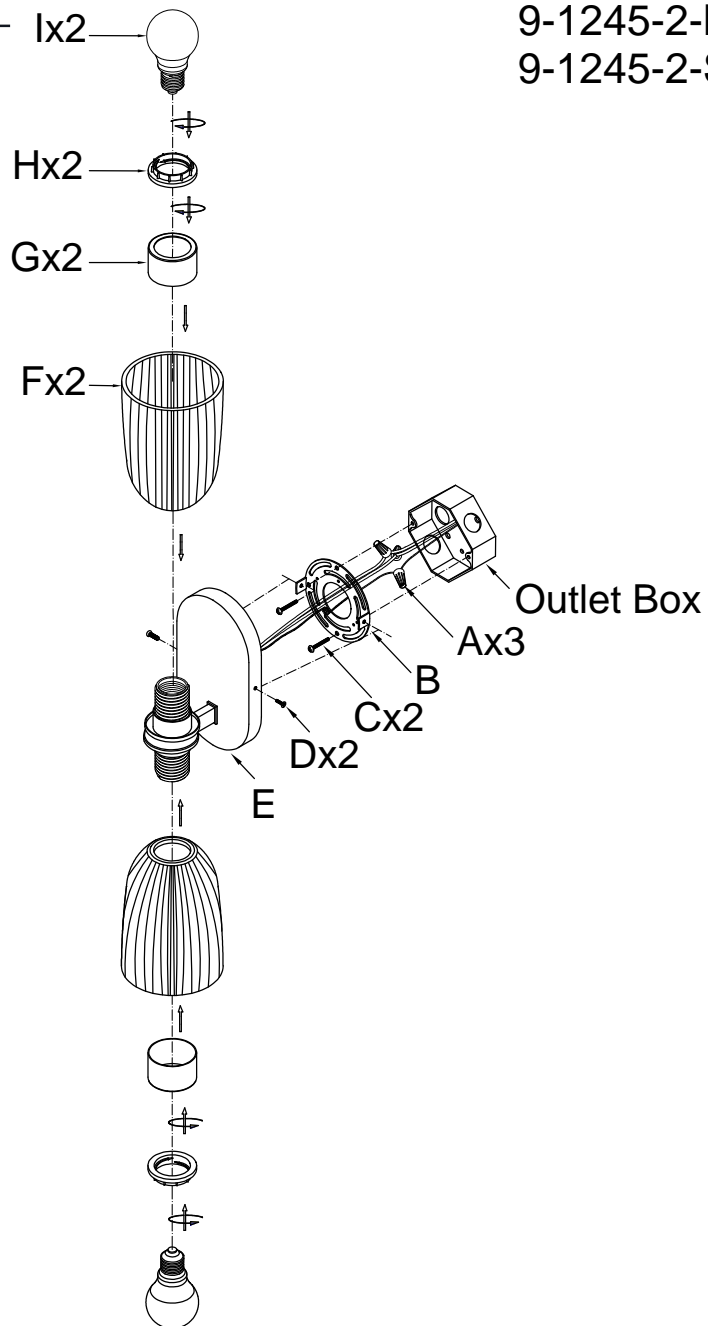

SAVOY
HOUSE

ITEM NO:
9-1245-2-127
9-1245-2-BK
9-1245-2-SN



ASSEMBLY INSTRUCTIONS

1. Carefully unpack and identify all parts referring to illustration for parts identification.
2. Turn the power to the installation point OFF.
3. Attach the mounting plate (B) to the outlet box and secure by using the two screws (C).
4. Connect the white wire from the fixture to the white wire of the outlet box.
Connect the black wire from the fixture to the black wire of the outlet box.
Connect the ground wire from the fixture to the ground wire of the outlet box by using the wire connectors (A) provided.
5. Install the fixture (E) onto the mounting plate (B) using side screws (D).
6. Place the glass shades (F) and the spacers (G) onto the lamp sockets and secure them with the socket rings (H).
7. Install the bulbs (I) (not included).
8. Restore power to the installation point and retain this sheet for future reference.