

# Combination FreeJack and Power Jack Round Multi-Port Canopy

700FJPJRD11\_

1.1

VISUAL COMFORT & Co.

MODERN COLLECTION

## GENERAL PRODUCT INFORMATION:

This product is suitable for dry locations only.



**IMPORTANT!** If the canopy is wood, do not install any head or pendant closer than 12 inches to this canopy. Heat from the lamp may damage the wood.



### CAUTION — RISK OF FIRE

This product requires installation by a qualified electrician. Before installing be sure to read all instructions and **TURN OFF POWER TO THE ELECTRICAL BOX.**

## Install the Backplate

1A

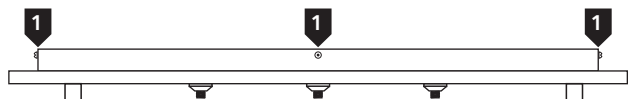

**1** Remove all the button head screws around the canopy.

1B

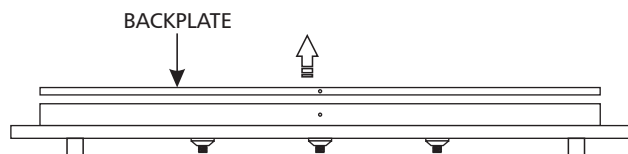

**2** Lift the backplate out of the canopy.

1C

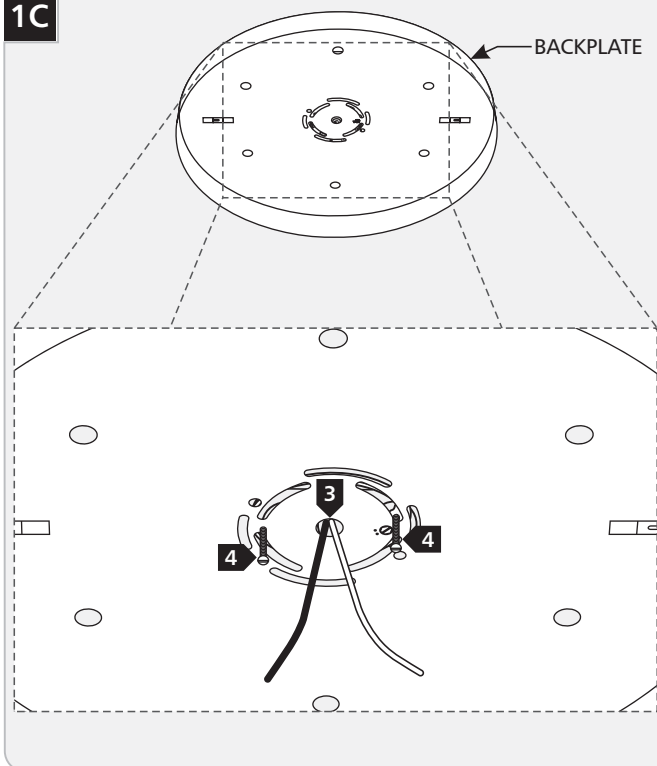

**3** Feed the power line wires through the hole in the middle of the backplate.

**4** Mount the backplate to the electrical box with the two long #8-32 screws provided.

## Install the Canopy

1D

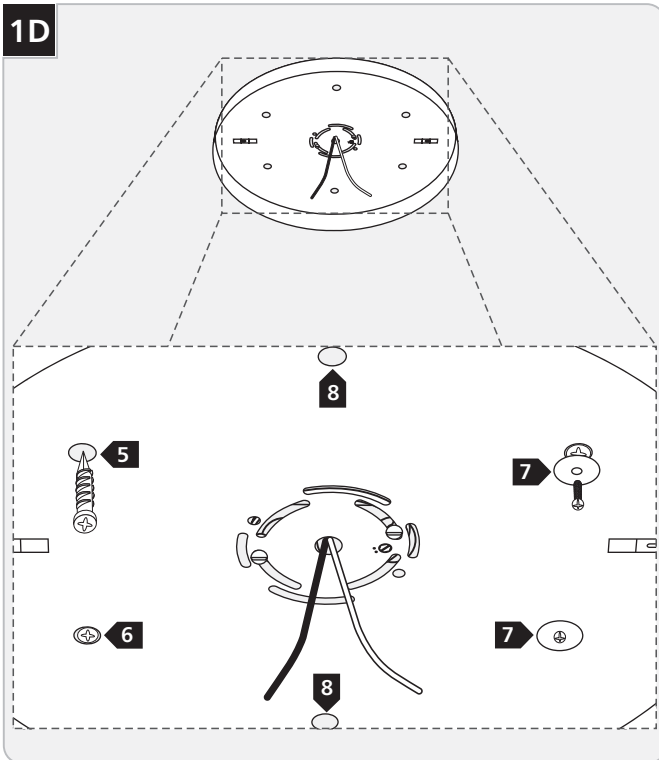

- 5 Line up an anchor with the center of a backplate hole and push the anchor in up to the threads.
- 6 Screw the anchor the rest of the way in with a screwdriver.
- 7 Secure the backplate to the anchor with a screw and washer.
- 8 Repeat steps 5-7 for all six anchor holes.

2A

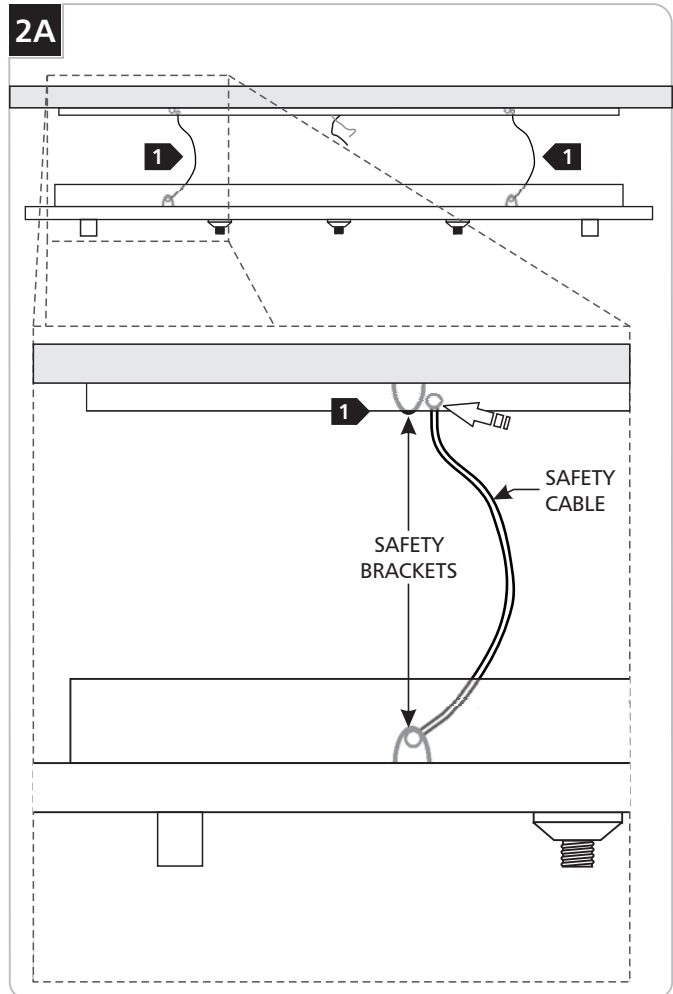

- 1 Hook a safety cable through the safety brackets on each end of the canopy and backplate.

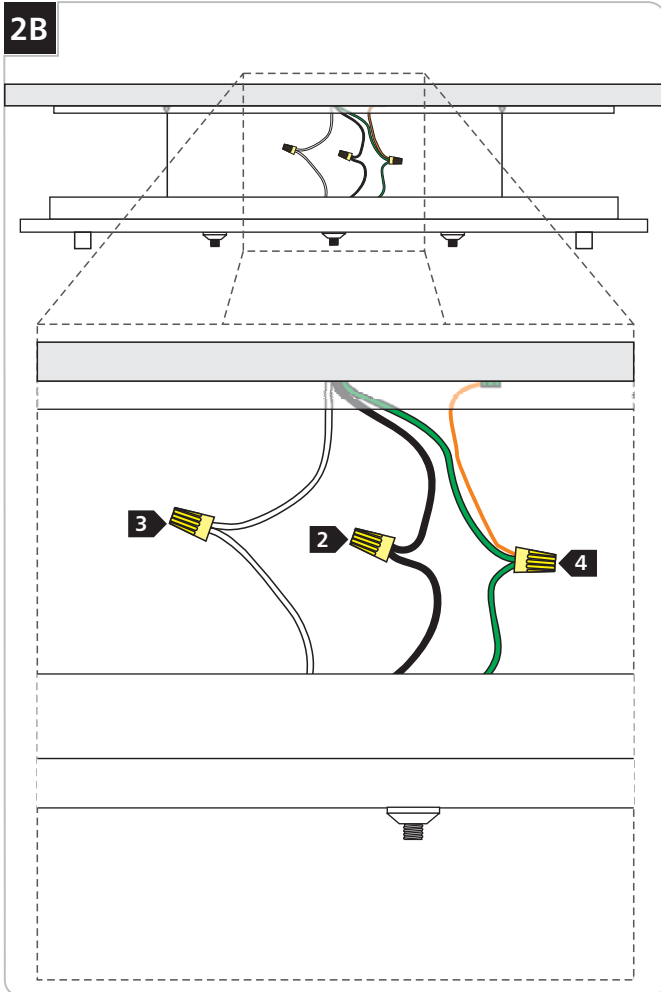

- 2** Connect the black fixture wire to the hot power line wire with a wire nut.
- 3** Connect the white fixture wire to the neutral power line wire with a wire nut.
- 4** Connect the canopy to a suitable ground in accordance with local electrical codes.

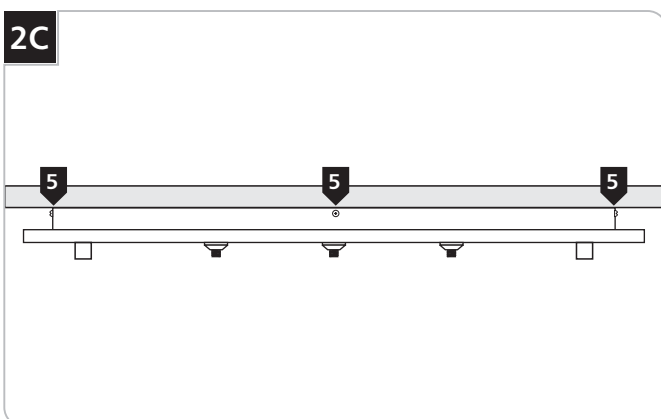

- 5** Line up the canopy to the backplate and reinstall all the button head screws.

## Install the FreeJack Fixtures

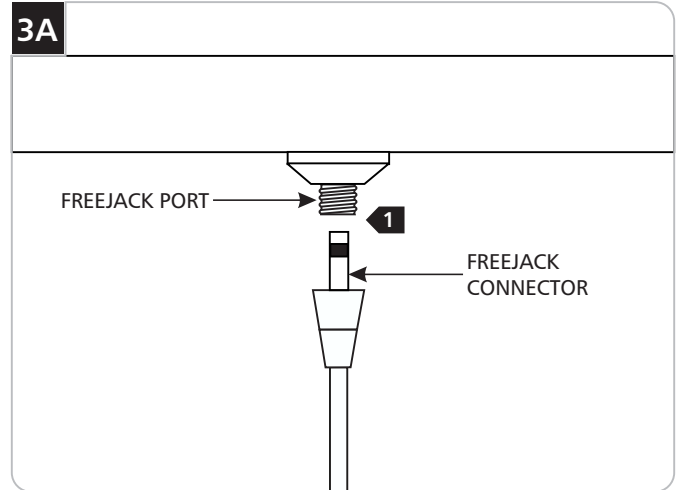

- 1** Screw a FreeJack connector into each FreeJack port.

## Install the Power Jack Fixtures

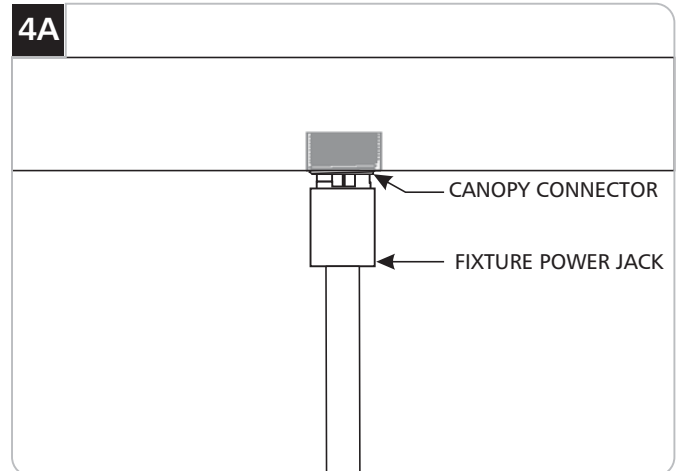

- 1** Line up the fixture Power Jack with the canopy connector.
- 2** Screw the Power Jack tightly onto the canopy connector.

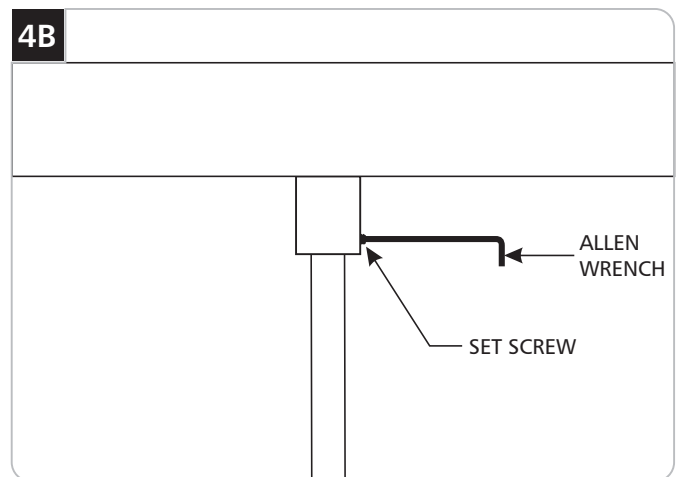

- 3** **Optional (heads only):** To lock the fixture head in a permanent position, tighten the set screw on the fixture Power Jack housing with the provided Allen wrench. This feature is not available on pendants.

**SAVE THESE INSTRUCTIONS!**

VISUAL COMFORT & CO.

7400 Linder Ave, Skokie, IL 160077

800.969.3347

**[www.visualcomfort.com](http://www.visualcomfort.com)**

©2023 Visual Comfort & Co.. All rights reserved. The Visual Comfort & Co. logo is a registered trademark of Visual Comfort & Co. Visual Comfort & Co. reserves the right to change specifications for product improvements without notification