

# Sphere Flush Mount (LED)

700FMSPH

1.0

## VISUAL COMFORT & Co.

MODERN COLLECTION

### GENERAL PRODUCT INFORMATION:

These fixtures are intended to be installed utilizing NEC compliant junction boxes.

This product is suitable for damp locations.

This product may be dimmed with a low-voltage electronic dimmer.

This instruction shows a typical installation.

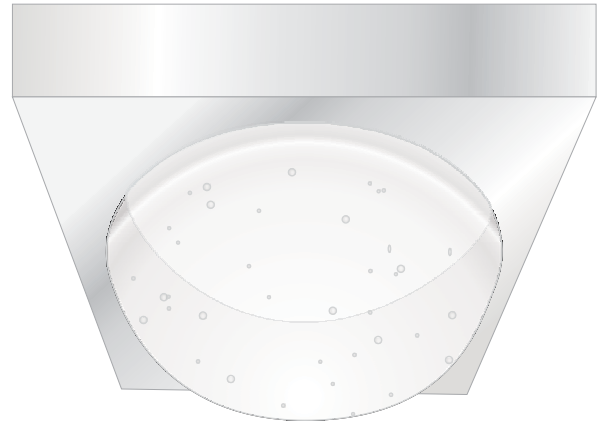

### CAUTION - RISK OF FIRE

This product must be installed in accordance with the applicable installation code by a person familiar with the construction and operation of the product and the hazards involved.

Use minimum 90°C supply conductors.

## Install the Fixture

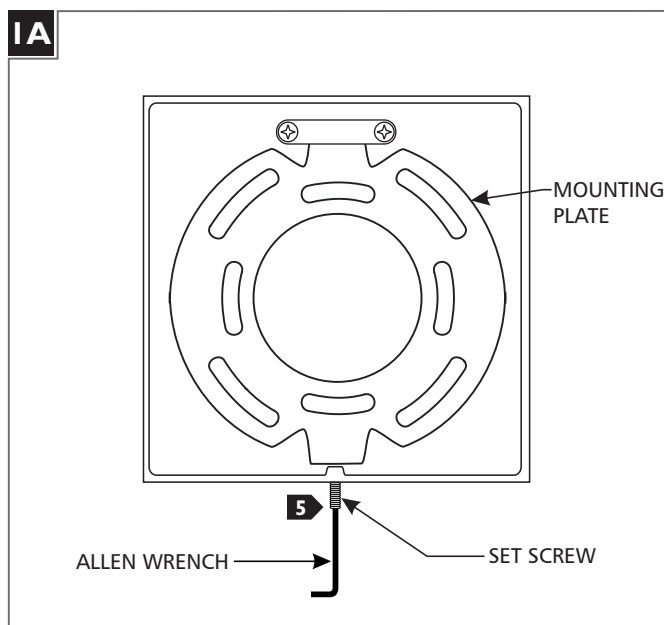

- 1** With the Allen wrench provided, back out (do not fully remove) the set screw at the base of the fixture and remove the mounting plate.

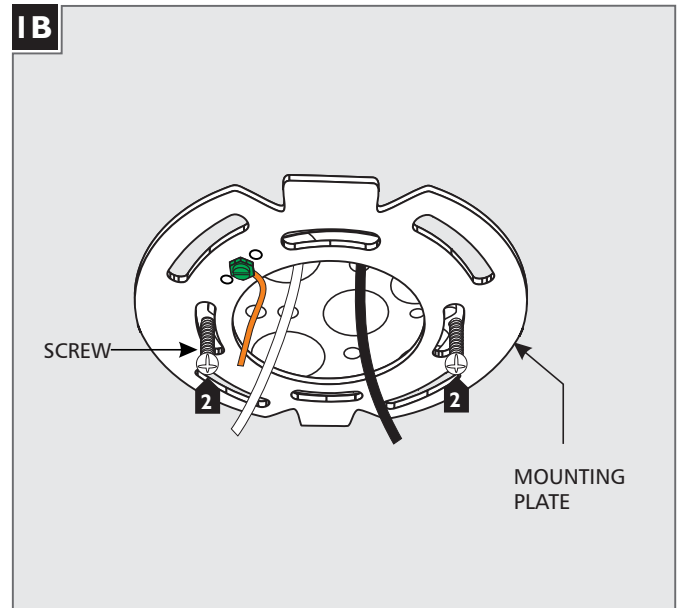

- 2** Attach the mounting plate to the electrical box using the two #8-32 screws provided.

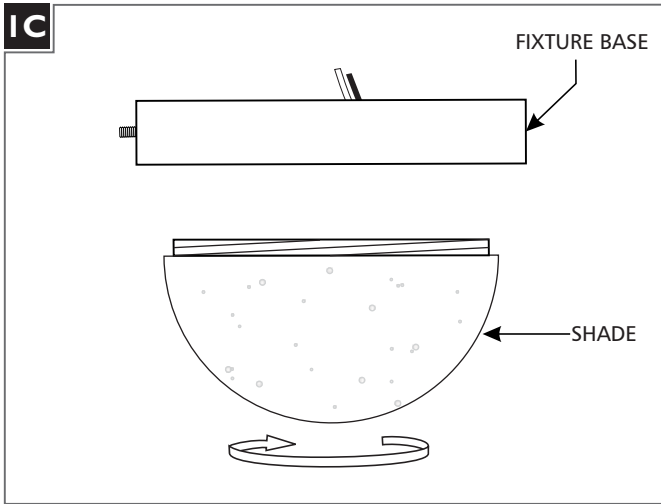

- 3** Screw the shade securely into the fixture base.

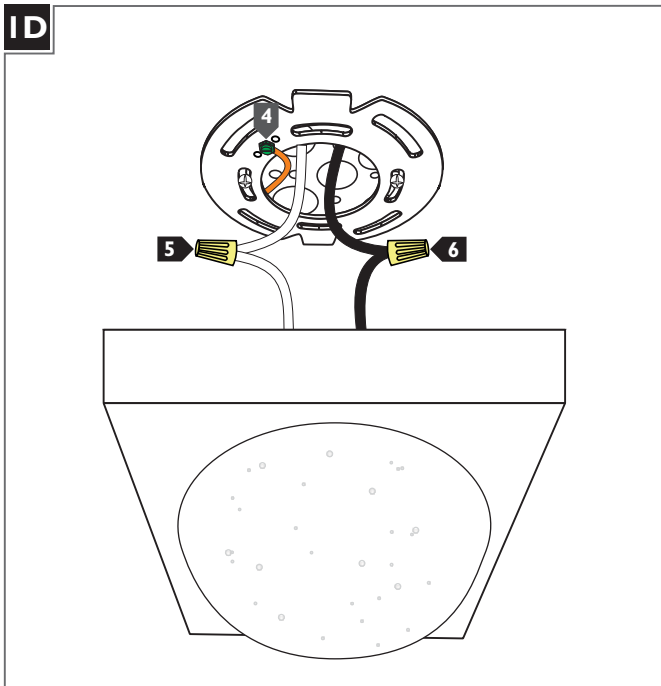

- 4** Connect the fixture to a suitable ground in accordance with local electrical codes.
- 5** Connect the white fixture wire to the neutral power line wire with a wire nut.
- 6** Connect the black fixture wire to the hot power line wire with a wire nut.

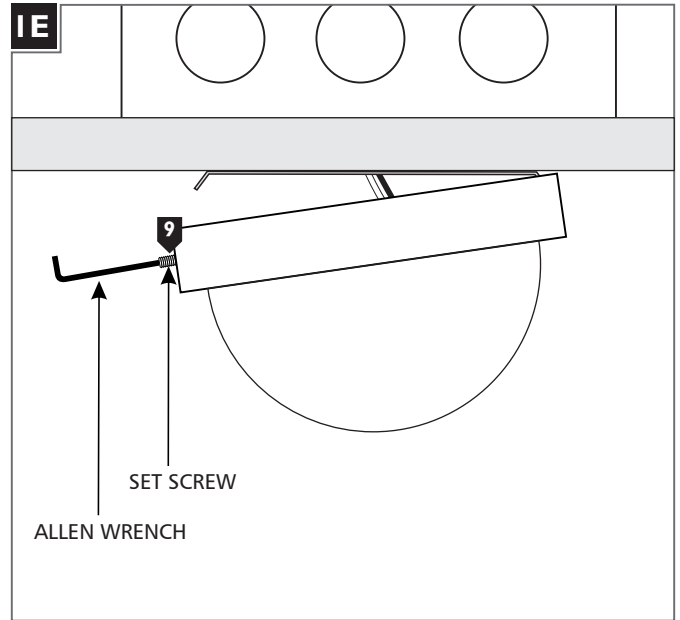

- 7** Properly place all wires and wire nut connections into the electrical box.
- 8** Hook the fixture to the mounting plate and swing the bottom of the fixture toward the plate until it is flush with the wall.
- 9** Tighten the set screw at the side of the fixture.

**CAUTION:** ensure that the fixture is secure to the

**SAVE THESE INSTRUCTIONS!**

VISUAL COMFORT & CO.

7400 Linder Ave, Skokie, IL 160077

800.969.3347

**www.visualcomfort.com**

©2023 Visual Comfort & Co.. All rights reserved. The Visual Comfort & Co. logo is a registered trademark of Visual Comfort & Co. Visual Comfort & Co. reserves the right to change specifications for product improvements without notification