

Milley 7 Wall**700WSMLY7**

1.0

VISUAL COMFORT & CO.**MODERN COLLECTION****GENERAL PRODUCT INFORMATION:**

This product is suitable for damp locations.

These fixtures are intended to be installed utilizing NEC compliant junction boxes.

This product can be dimmed with most ELV or TRIAC dimmers.

This instruction shows a typical installation.

**CAUTION - RISK OF FIRE**

This product must be installed in accordance with the applicable installation code by a person familiar with the construction and operation of the product and the hazards involved.

Use minimum 90°C supply conductors.

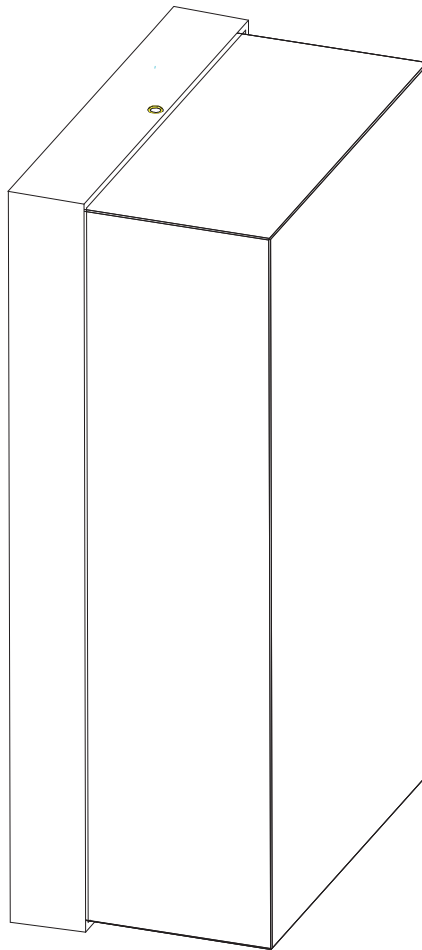
**SAVE THESE INSTRUCTIONS!**

Install the Fixture

1A

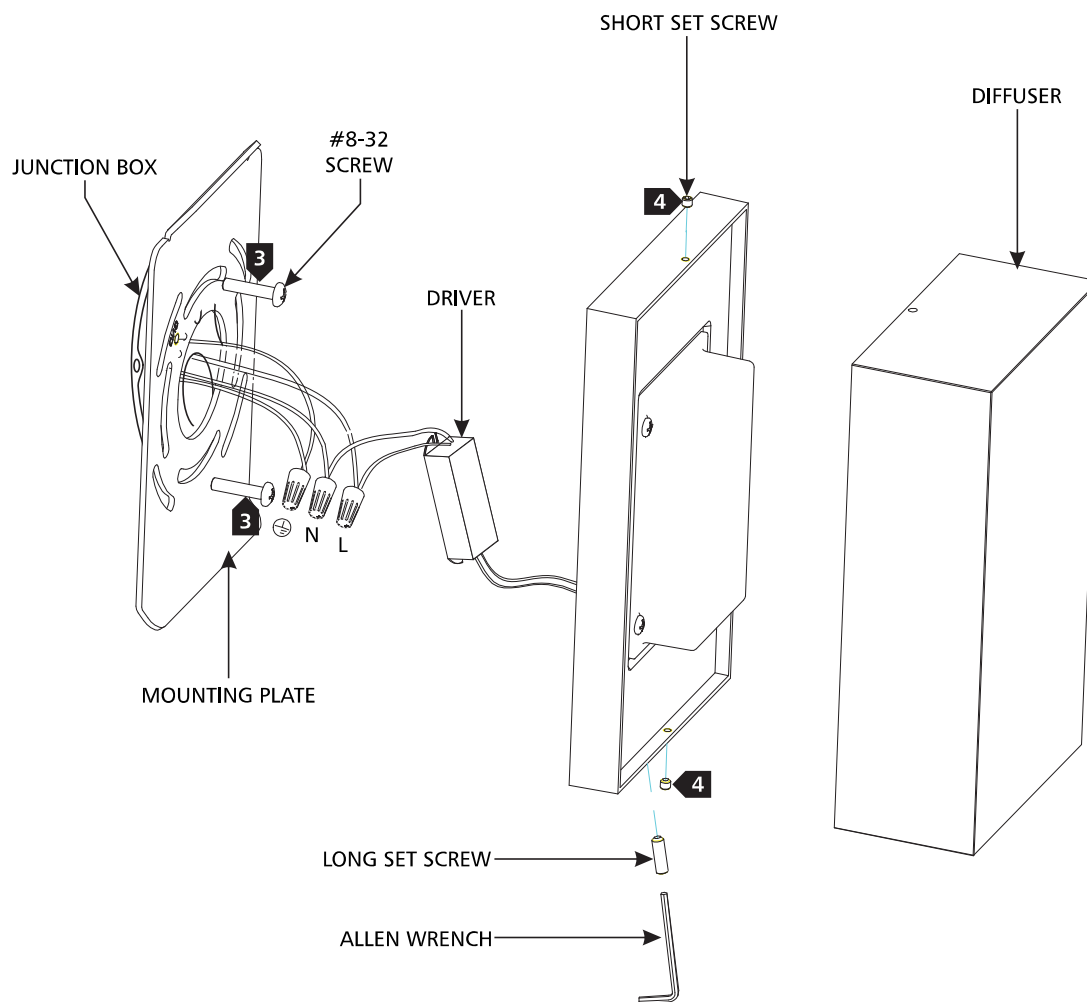

- 1** With the provided Allen wrench, remove the long set screw at the bottom of the fixture base.
- 2** Remove the mounting plate from the fixture base.
- 3** Install the mounting plate to the junction box with the two #8-32 screws provided.
- 4** Install the diffuser to the fixture base and secure it in place with the short set screws on the top and bottom of the fixture base using the provided Allen wrench.
- 5** Connect the black driver wire to the black fixture wire with a wire nut.
- 6** Connect the red driver wire to the red fixture wire with a wire nut.
- 7** Connect the fixture to a suitable ground in accordance with local electrical codes.
- 8** Connect the white driver wire to the neutral power line with a wire nut.
- 9** Connect the black driver wire to the hot power line with a wire nut.
- 10** Properly place the driver, all wires, and wire nut connections into the junction box, mount the fixture base onto the mounting plate, and secure it in place by reinstalling the Allen screws using the provided Allen wrench.