

Dessau Linear Suspension

700LSDES48, 700LSDES72

1.0

VISUAL COMFORT & Co.

MODERN COLLECTION

GENERAL PRODUCT INFORMATION:

This product is suitable for damp locations.

These fixtures are intended to be installed utilizing NEC compliant junction boxes.

This product can be dimmed with most ELV or TRIAC dimmers.

This instruction shows a typical installation.



CAUTION - RISK OF FIRE

This product must be installed in accordance with the applicable installation code by a person familiar with the construction and operation of the product and the hazards involved.

Use minimum 90°C supply conductors.

Two Person Installation Recommended

VISUAL COMFORT & Co.

7400 Linder Ave, Skokie, IL 160077

800.969.3347

www.visualcomfort.com

©2023 Visual Comfort & Co.. All rights reserved. The Visual Comfort & Co. logo is a registered trademark of Visual Comfort & Co. Visual Comfort & Co. reserves the right to change specifications for product improvements without notification

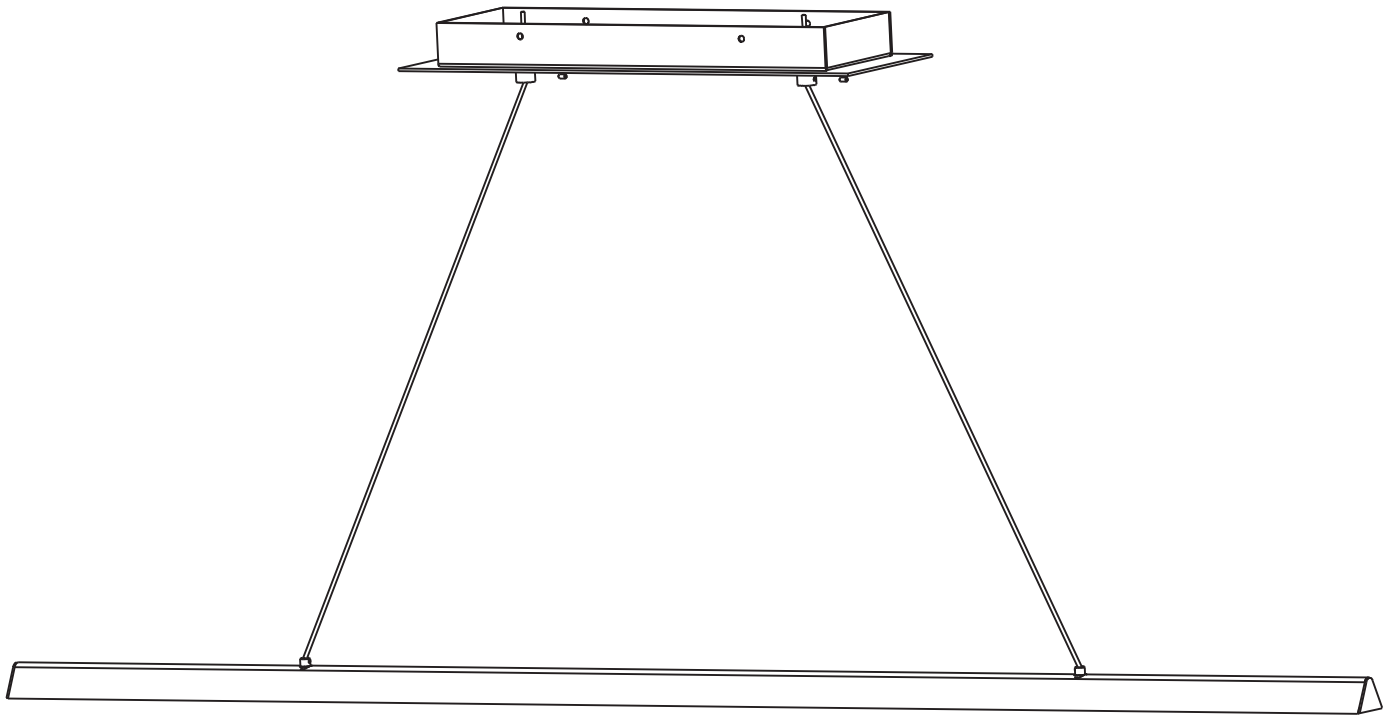

SAVE THESE INSTRUCTIONS!

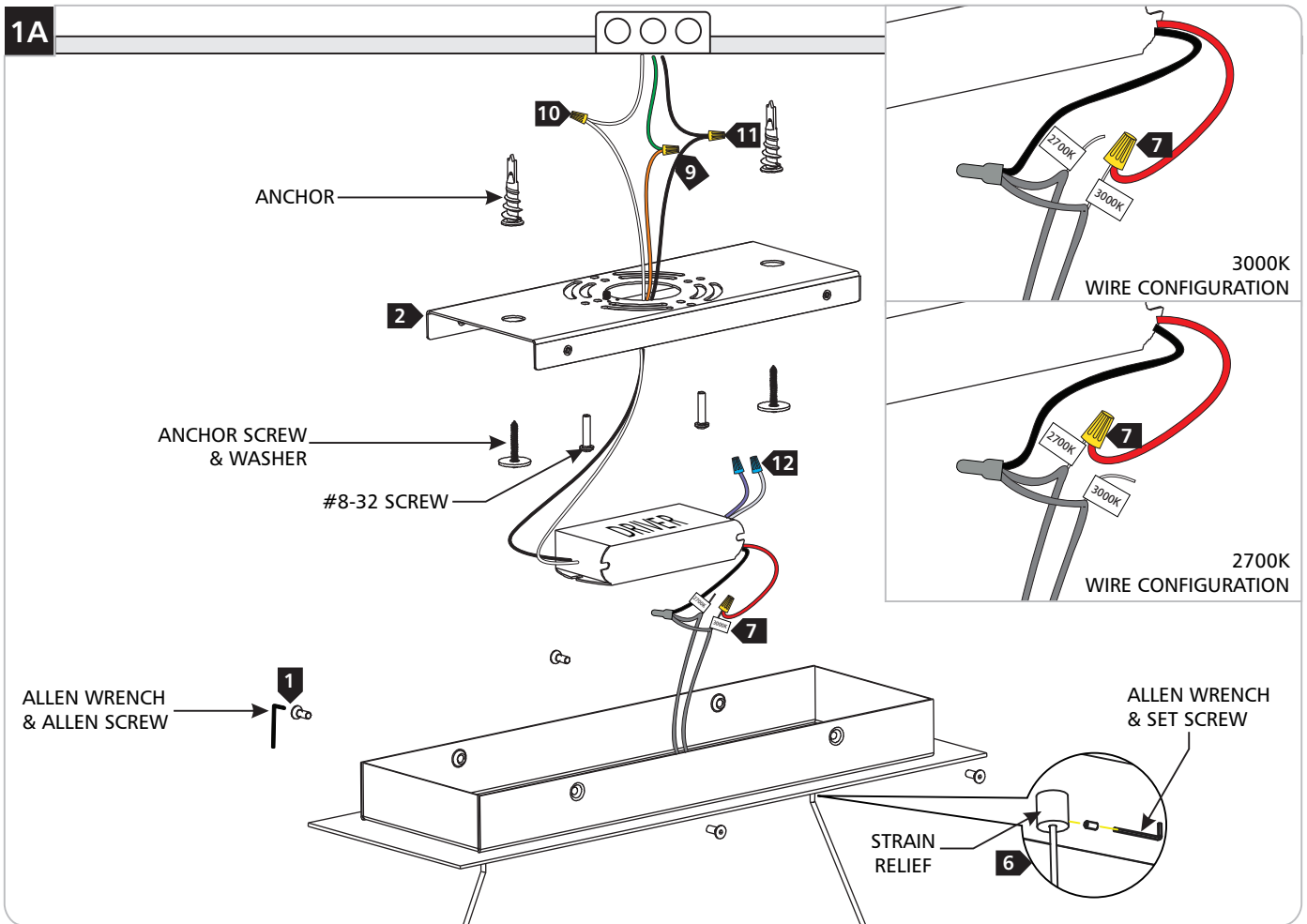

- 1 Remove the Allen screws on the sides of the canopy using the provided Allen wrench, then remove the mounting plate from the canopy.
- 2 Install the mounting plate to the junction box with the two #8-32 screws provided.
- 3 Verify that the mounting plate is level before continuing. Line up an anchor tip with the center of an anchor hole, and push the anchor into the wall up to the threads.
- 4 Screw the anchor in the rest of the way with a Phillips-head screwdriver.
- 5 Slide an anchor screw through a washer, and screw it into an anchor to secure the fixture base to the wall. Repeat steps 3-5 for remaining anchors.
- 6 To adjust the Fixture Height place the fixture on a level surface. With the provided Allen wrench, loosen (do not remove) the set screws on the strain reliefs. Then evenly pull the cables up through the strain reliefs to raise the fixture to the desired height. Ensure that the canopy is level and re-tighten the set screws on the strain reliefs.
- 7 (For Optional CCT:) The fixture will come with the 3000K option pre-configured. To change to 2700K, disconnect the wire marked 3000k from the wire nut or Wego connected to the red wire. Then connect the wire marked 2700K to the red wire with the wire nut or Wego. **WARNING:** Do not connect both 2700K and 3000K wires simultaneously, as it may result in damaging the fixture.
- 8 Connect the fixture to a suitable ground in accordance with local electrical codes.
- 9 Connect the white driver wire to the neutral power line with a wire nut.
- 10 Connect the black driver wire to the hot power line with a wire nut.
- 11 For 277V Only: If using 0-10V dimming, connect the purple and gray wires to a compatible dimmer. If not using 0-10V dimming, cap off the purple and gray wires.
- 12 Properly place the driver, all wires, and wire nut connections into the canopy/junction box, mount the fixture back onto the mounting plate, and reinstall Allen screws (reversal of step 1).
- 13 **Fine Leveling (Optional):** Loosen (do not remove) the set screws on the necessary strain relief and gently pull or push the cable in very small increments through the strain relief to adjust the height of the fixture. Re-tighten the set screw on the strain relief using the provided Allen Wrench.