

# Ikon Step Light

700OSIKN92730\_ 1.1

## VISUAL COMFORT & Co.

MODERN COLLECTION

### GENERAL PRODUCT INFORMATION:



This product is suitable for wet locations.

These fixtures are intended to be installed utilizing NEC compliant junction boxes.

We do not recommend using greater than 70% of the maximum wattage specified for the low voltage transformer due to inrush current requirements.

This product can be dimmed with most MLV dimmers (12v only). 120v version is not dimmable.

This instruction shows a typical installation.

**CAUTION - RISK OF FIRE**  
 This product must be installed in accordance with the applicable installation code by a person familiar with the construction and operation of the product and the hazards involved.  
**Use minimum 90°C supply conductors.**

**SAVE THESE INSTRUCTIONS!**

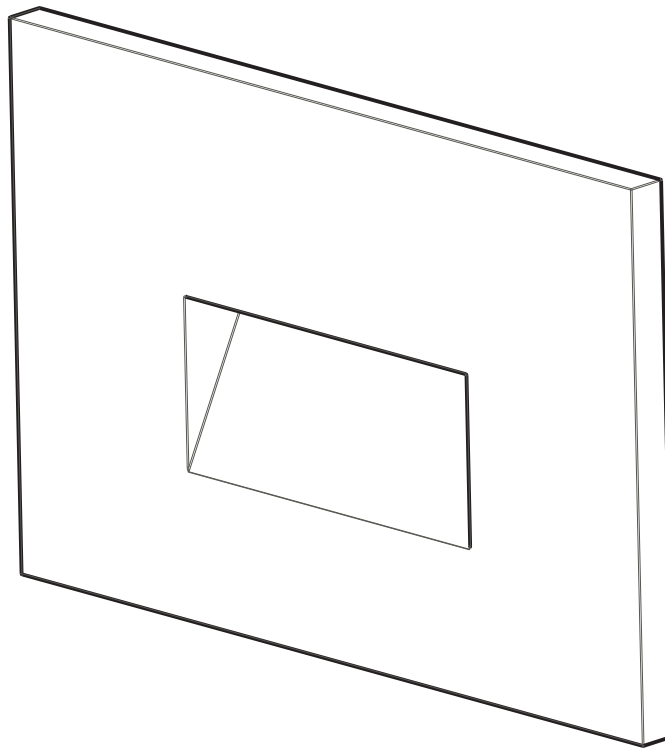

VISUAL COMFORT & Co.

7400 Linder Ave., Skokie, IL 60077

T 847.410.4400 | F

847.410.4500

www.visualcomfort.com

# Install the Fixture

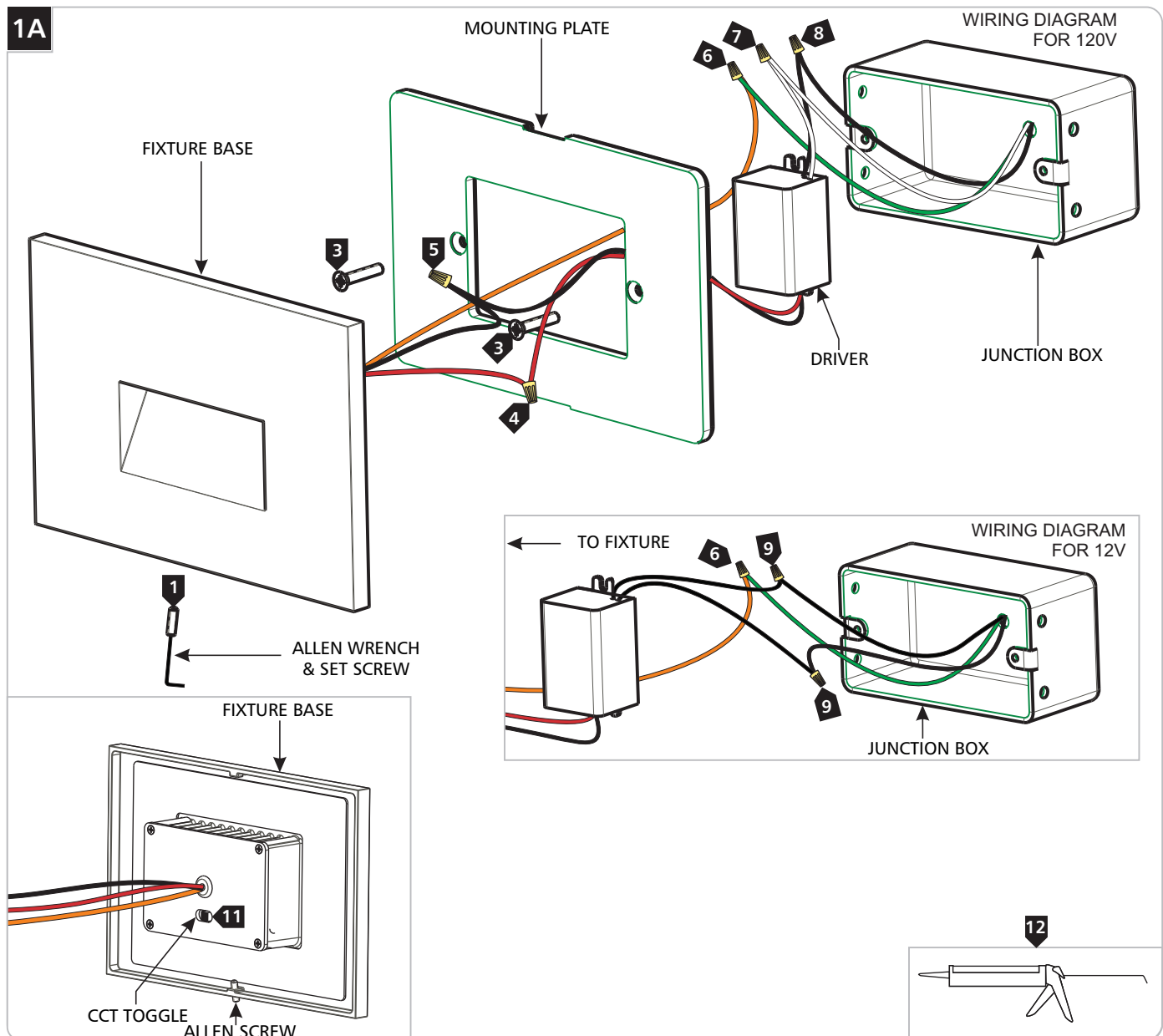

- 1 With the provided Allen wrench, loosen the set screw from the bottom of the fixture base.
- 2 Remove the mounting plate from the fixture base.
- 3 Install the mounting plate to the junction box with the two #6-32 screws provided and ensure the mounting plate is level.
- 4 Connect the red driver output wire to the red fixture wire.
- 5 Connect the black driver output wire to the black fixture wire.
- 6 Connect the fixture to a suitable ground in accordance with local electrical codes.
- 7 **For 120v fixtures only:** Connect the white wire to the neutral power line with a wire nut.
- 8 **For 120v fixtures only:** Connect the black wire to the hot power line with a wire nut.
- 9 **For 12v fixtures only:** Connect the black driver wires to the black junction box wires (from the remote transformer) with wire nuts.
- 10 Properly place all wires, driver and wire nut connections into the junction box, mount the fixture base onto the mounting plate, and secure it in place by tightening the set screw using the provided Allen wrench.
- 11 **(Optional):** To adjust the CCT, access the CCT toggle on the back of the fixture base loosen the allen screw at the bottom of the fixture. Then access the back of the fixture base by removing it from the mounting plate. Select the desired color temperature. Then reinstall the fixture base and secure with the allen screw. It is recommended to do this before applying sealant.
- 12 For wet locations, caulk around the base of the fixture with waterproof construction sealant.