

Windfall 8 Outdoor Wall**7000WWND8_ 1.1**

VISUAL COMFORT & Co.

MODERN COLLECTION

GENERAL PRODUCT INFORMATION:

This product is suitable for wet locations.

For wet location installation, fixture must be installed vertically, see label on fixture for direction.

These fixtures are intended to be installed utilizing NEC compliant junction boxes.

This product can be dimmed with most ELV, TRIAC or 0-10V dimmers.

This instruction shows a typical installation.

**CAUTION - RISK OF FIRE**

This product must be installed in accordance with the applicable installation code by a person familiar with the construction and operation of the product and the hazards involved.

Use minimum 90°C supply conductors.

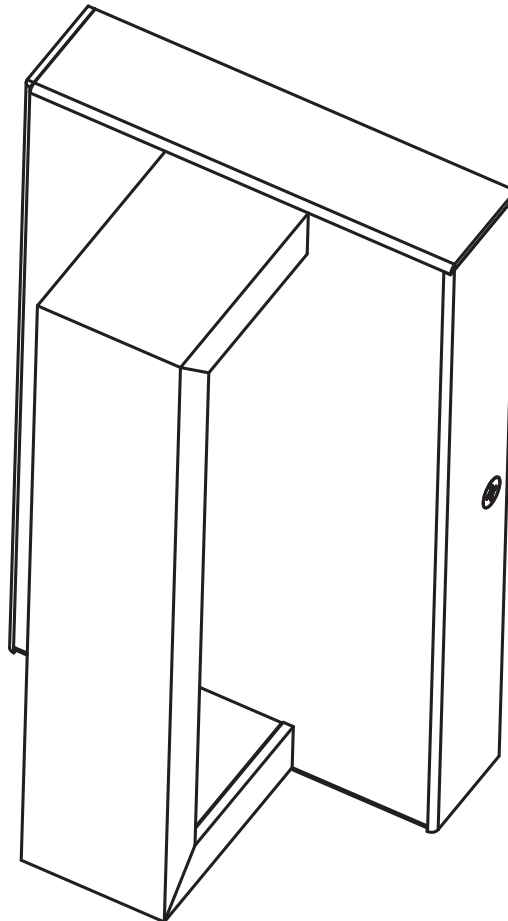
SAVE THESE INSTRUCTIONS!

VISUAL COMFORT & Co.

7400 Linder Ave., Skokie, IL 60077

T 847.410.4400 | F

847.410.4500

www.visualcomfort.com

Install the Fixture

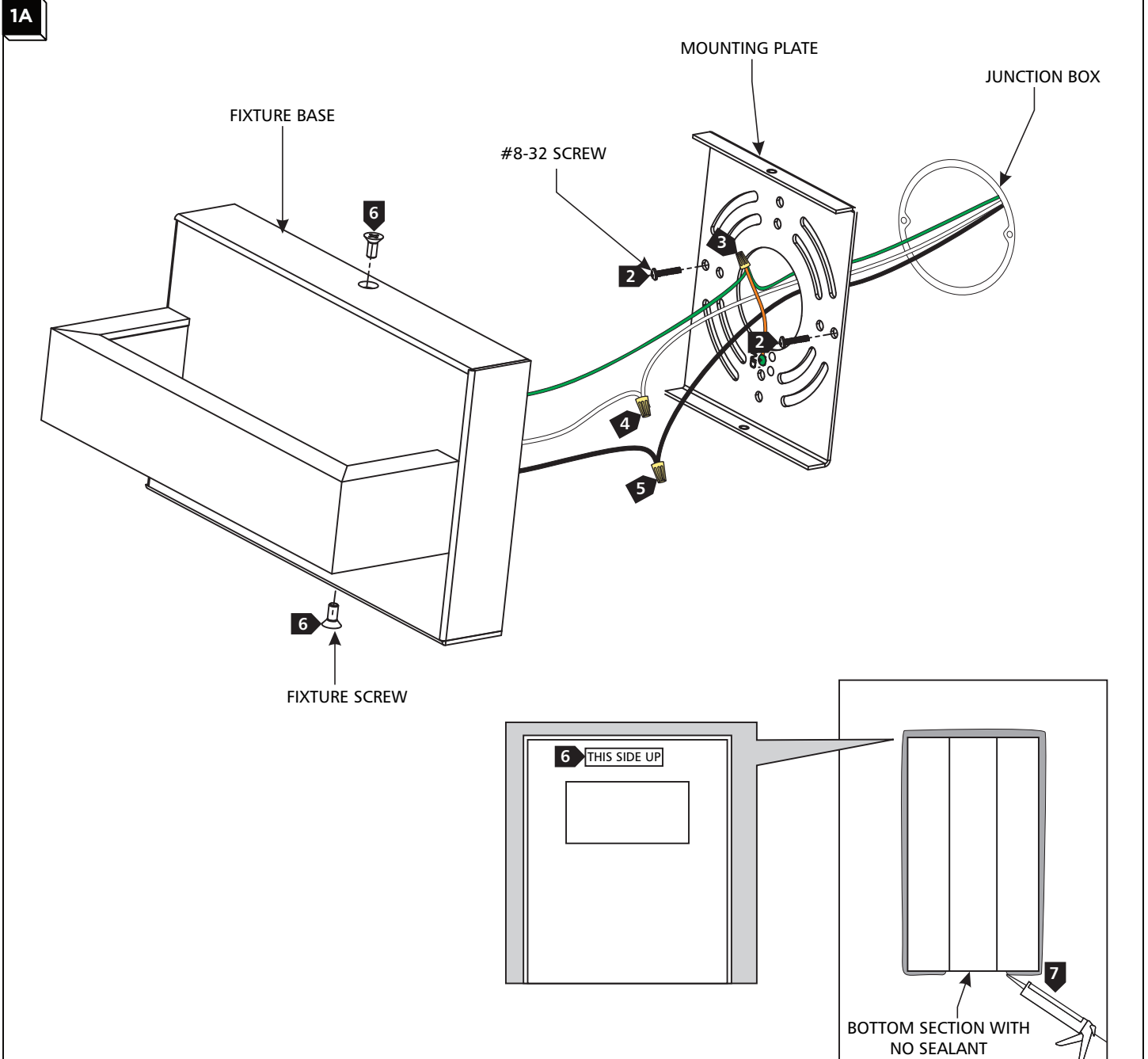

- 1 Remove the fixture screws from the fixture base and remove the mounting plate.
- 2 Install the mounting plate to the junction box with the two #8-32 screws provided and ensure the mounting plate is level. **For wet locations:** align the mounting plate so the fixture install the vertically.
- 3 Connect the fixture to a suitable ground in accordance with local electrical codes.
- 4 Connect the white wire to the neutral power line with a wire nut.
- 5 Connect the black wire to the hot power line with a wire nut.
- 6 Properly place all wires and wire nut connections into the junction box or fixture base, mount the fixture base onto the mounting plate, and secure it in place with the fixture screws. **For wet locations:** identify the top of the fixture by the label behind/inside of the fixture.
- 7 **For wet locations,** caulk around the perimeter of the fixture with waterproof construction sealant excluding the a section at the bottom of the to all water/moisture to exit.