

Esfera Pendant

700TDESF

1.0



PENDANTS

GENERAL PRODUCT INFORMATION:



This product is suitable for indoor locations.

This product can be dimmed with a standard electronic dimmer.

This instruction shows a typical installation.

CAUTION - RISK OF FIRE

This product must be installed in accordance with the applicable installation code by a person familiar with the construction and operation of the product and the hazards involved.

Use minimum 90°C supply conductors.

SAVE THESE INSTRUCTIONS!

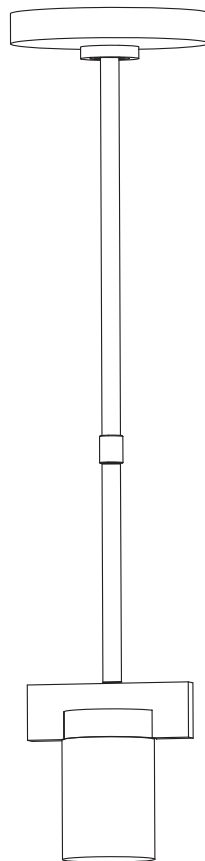

7400 Linder Ave., Skokie, IL 60077
T 847.410.4400 | F 847.410.4500
www.techlighting.com

Install the Fixture

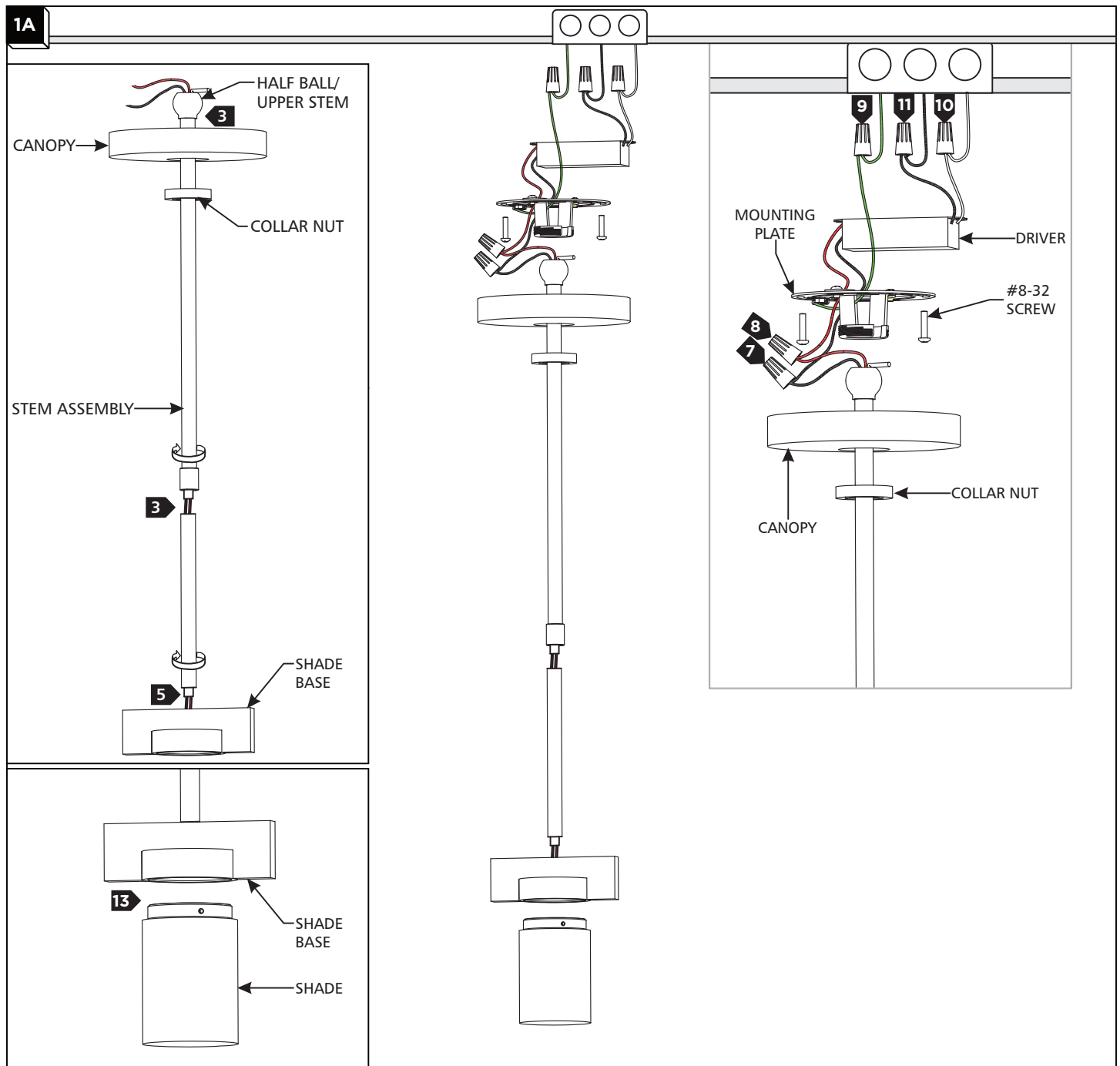

- 1 Remove the mounting plate and driver from the canopy.
- 2 Secure the mounting plate to the junction box with the provided #8-32 screws.
- 3 Determine the desired height of the fixture using the provided stems and half ball/upper stem and assemble them by screwing them together.
- 4 Slide the collar nut over the half ball/stem assembly.
- 5 Feed the fixture wires through the stem assembly, then screw the stem assembly to the top of the shade base.
- 6 Feed the fixture wires and half ball/stem assembly through the canopy, then seat the half ball into the mounting plate ensuring no wires are being pinched.
- 7 Connect the black driver wire to the black fixture wire with a wire nut.
- 8 Connect the red driver wire to the red fixture wire with a wire nut.
- 9 Connect the fixture to a suitable ground in accordance with local electrical codes.
- 10 Connect the white driver wires to the neutral power line wire with a wire nut.
- 11 Connect the black driver wires to the hot power line wire with a wire nut.
- 12 Neatly place the drivers, all wires, and wire nut connections inside the canopy, slide the canopy up to over the mounting bracket and secure in place with the collar nut.
- 13 Install the shade by screwing it into the shade base.