

PRESSA SQUARE & ROUND SMALL, MEDIUM, LARGE & X-LARGE WALL SCONCES

SLOWS292; SLOWS293; SLOWS294; SLOWS295; SLOWS28827; SLOWS28927; SLOWS29027; SLOWS29127

General Product Information



Tools Required



Safety Information

CAUTION-RISK OF FIRE

This product must be installed in accordance with the applicable installation code by a person familiar with the construction and operation of the product and the hazards involved.

USE MINIMUM 90°C SUPPLY CONDUCTORS.

 Turn off electrical current at the source before working with any lighting fixture or portable lamp.

Install and use this product in adherence with local electrical codes and regulations.



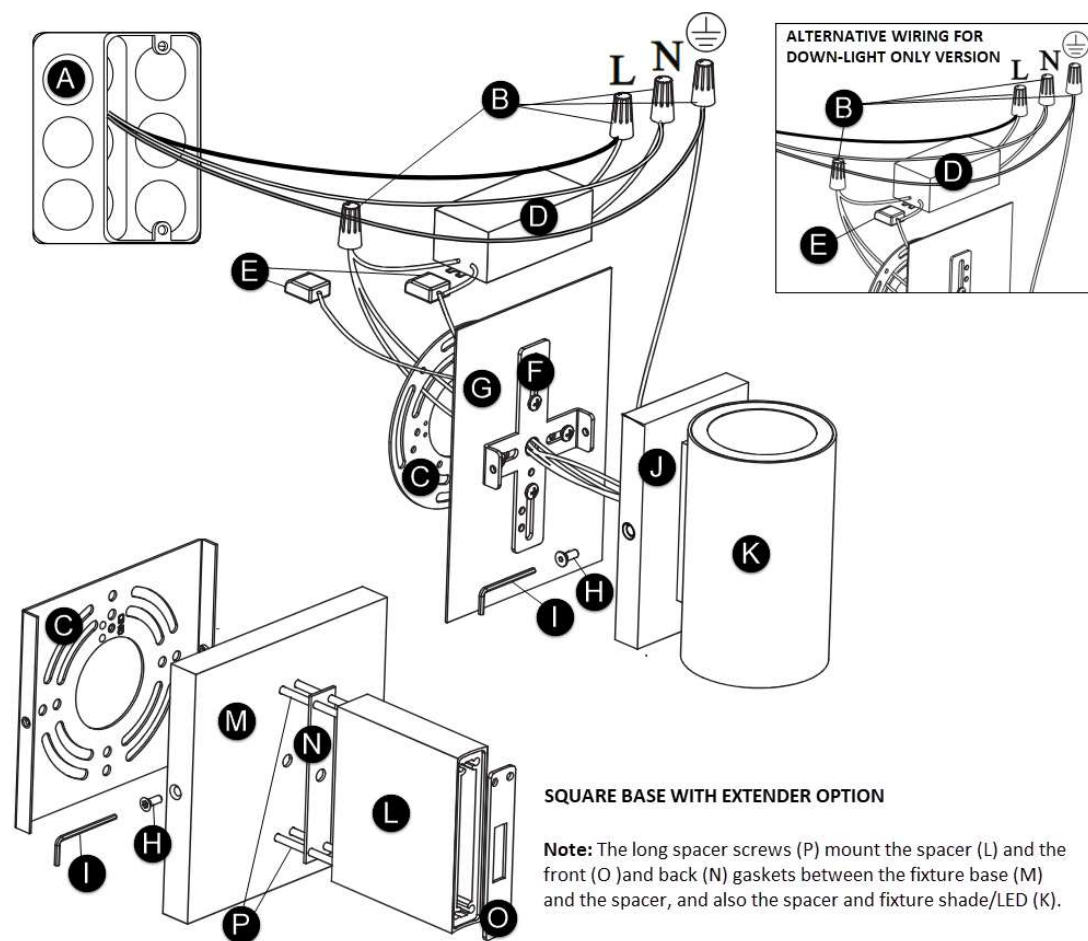

FIXTURE PARTS

- A. Junction box
- B. Wire Nut Connections
- C. Mounting Plate with Mounting Screws (Not Pictured)
- D. Driver
- E. WEGO Connector(s)
- F. Mounting Bracket
- G. Goof Plate
- H. Fixture Screws
- I. Allen Wrench
- J. Rectangular Fixture Base
- K. Fixture Shade/LED
- L. Extended Spacer Option
- M. Square Fixture Base Option
- N. Back Gasket
- O. Front Gasket
- P. Long Spacer Screws

INSTRUCTIONS

I. Preparing the Fixture

1. Separate the mounting and goof plates from the fixture body by removing the fixture screws with the provided Allen wrench.
2. Secure the mounting plate to the junction box using the mounting screws.

II. Wiring the Fixture

1. Safety first! Locate the circuit breaker and switch it off to cut off the power supply to the relevant circuits to ensure there's no electricity running through the wiring.
2. In accordance with local electrical codes, connect the fixture ground wire (bare copper or silver wire) to suitable ground. This may be a green ground screw on the mounting plate or a house wire (green or bare copper wire without insulation).
3. Twist the bare ends of the following pairs of wires together using a wire nut to secure a connection:
 - a) Negative (-) driver wire to the negative (-) power line wire (negative to negative)
 - b) Positive (+) driver wire to the positive (+) power line wire (positive to positive)
4. Carefully tuck the driver and all the wires inside the junction box.
5. Secure the goof plate to the mounting plate.

III. Installing the Fixture

1. Mount the fixture onto the bracket on the goof plate and secure it in place by reinstalling the fixture screws to finish.
2. For wet locations, caulk around the base of the fixture with waterproof construction sealant.

Please Note: This fixture comes in various finishes and styles that include canopy and extender options, and rectangular, square, and round fixture bases with uplight and downlight (dark-sky friendly) options.