

# Arkay Bollard

7000BARK\_

1.0

## VISUAL COMFORT & Co.

MODERN COLLECTION

### GENERAL PRODUCT INFORMATION:

This product is suitable for wet locations.

Refer to product specsheet for dimming information.



#### CAUTION - RISK OF FIRE

This product must be installed in accordance with the applicable installation code by a person familiar with the construction and operation of the product and the hazards involved.

Use minimum 90°C supply conductors.

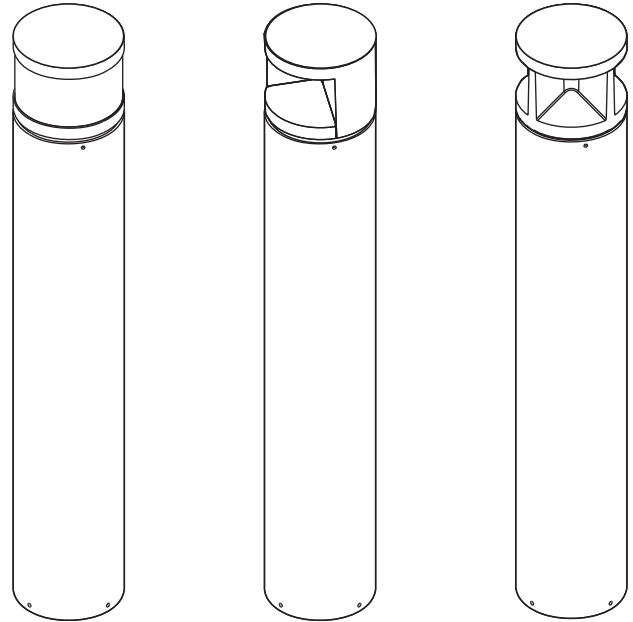

## Prepare the Fixture

1A

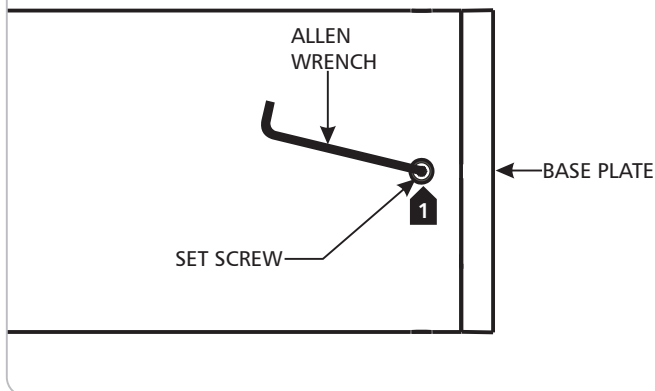

- 1 Loosen (**Do Not Remove**) the set screws on fixture base with the provided Allen wrench and remove the base plate.

1B

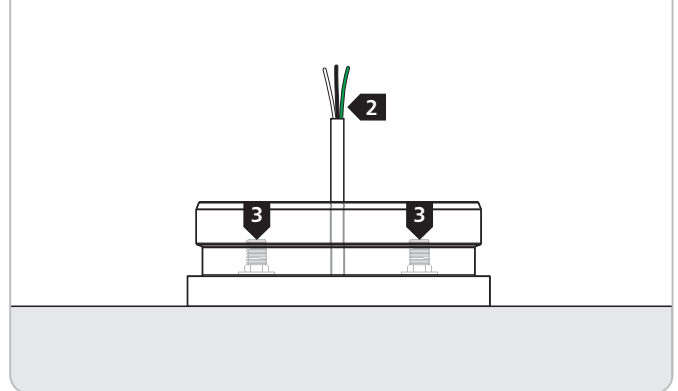

- 2 Bring the power wires to the fixture location in accordance with local electrical codes.
- 3 Mount the base plate to an even and smooth surface using the provided template on page 4.

## Wire the Fixture

1C

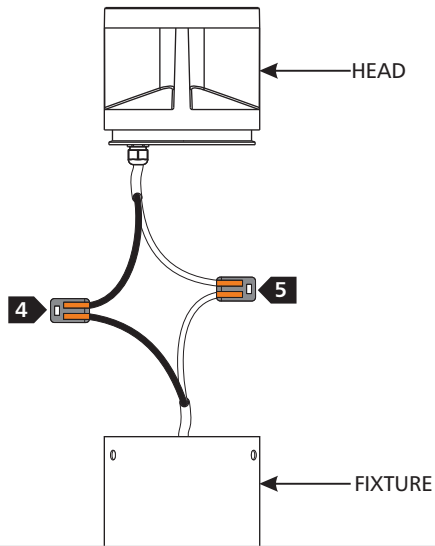

**Note:** If necessary, use the following steps to install the head onto the fixture. If head is already installed, skip this step.

- 4 Connect the white wire from the head to the white fixture wire using a provided connector.
- 5 Connect the black wire from the head to the black fixture wire using a provided connector.
- 6 Place the head on the fixture and secure them together by tightening the set screws using the provided Allen wrench.

2A

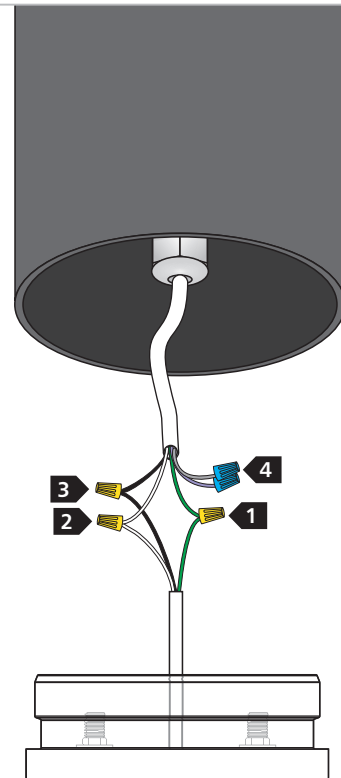

- 1 Connect the fixture to a suitable ground in accordance with local electrical codes.
- 2 Connect the white fixture wire to one of the low-voltage power line wires with a wire nut.
- 3 Connect the black fixture wire to the remaining low-voltage power line wire with a wire nut.
- 4 Use the gray and purple dimming wires for 0-10v dimming application (if not in use, make sure to cap these wires off).

**Warning:** The purple and gray wires are only used for 0-10v dimming. For all other applications, do not connect the gray and purple wires.

2B

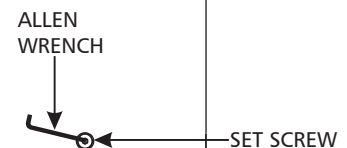

- 5 Carefully install the fixture onto the base plate and secure it in place by tightening all set screws.

## Ground Fault Circuit Interrupter Models Only (GFCI)

3A

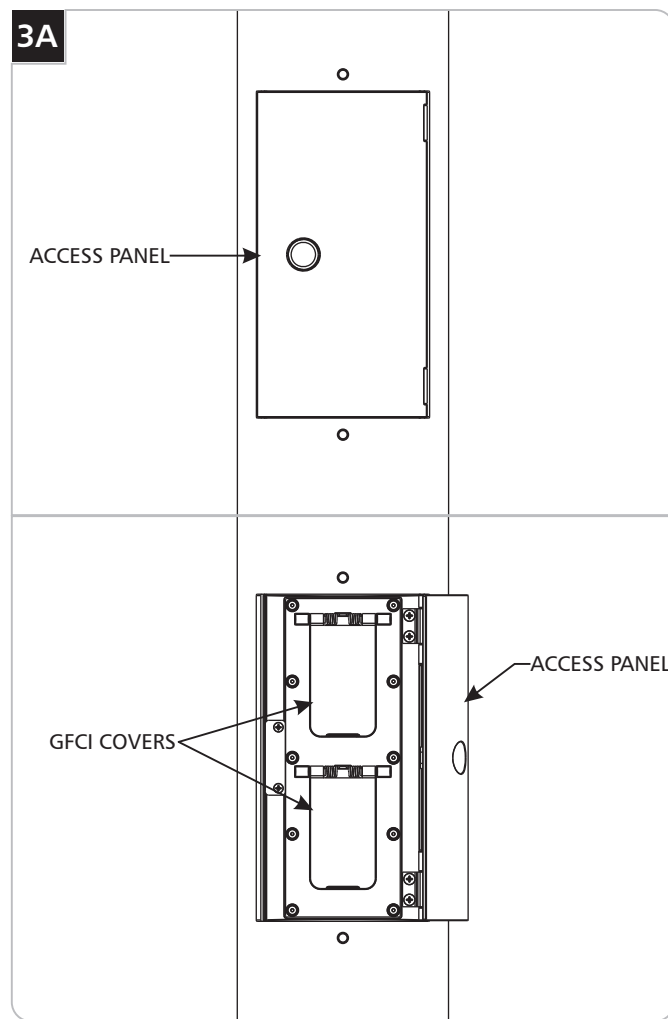

- 1 To use Ground Fault Circuit Interrupter (GFCI), open the access panel and lift the GFCI cover.

## Install Lock GFCI Models Only (optional)

4A

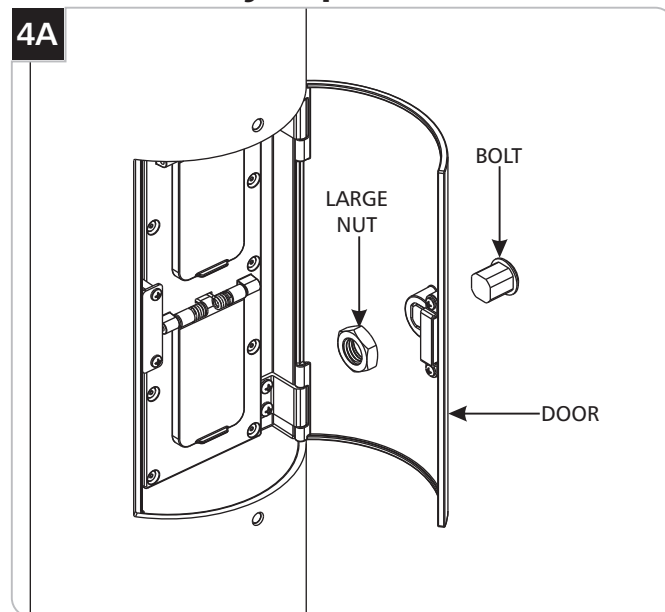

- 1 Unscrew the nut from the bolt, then remove the bolt from the door.

4B

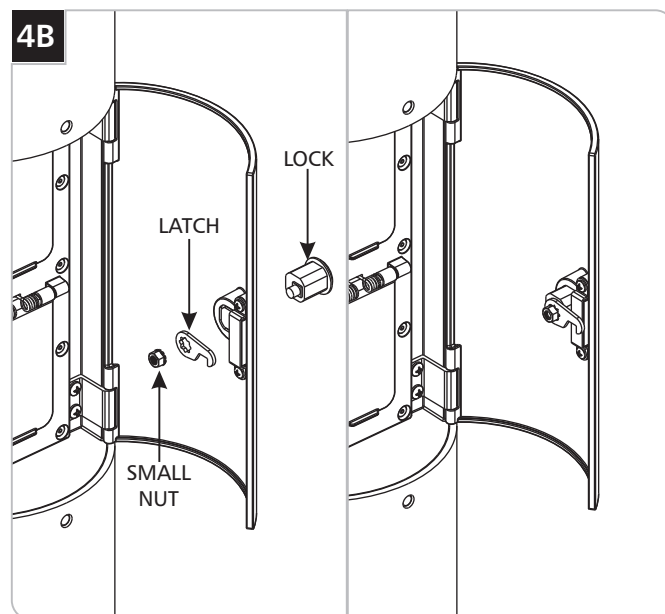

- 2 Unscrew and remove the small nut from the lock followed by the latch.
- 3 Install the lock to the door using the latch and small nut as shown.

**SAVE THESE INSTRUCTIONS!**

VISUAL COMFORT & CO.

7400 Linder Ave, Skokie, IL 160077

800.969.3347

[www.visualcomfort.com](http://www.visualcomfort.com)

©2023 Visual Comfort & Co.. All rights reserved. The Visual Comfort & Co. logo is a registered trademark of Visual Comfort & Co. Visual Comfort & Co. reserves the right to change specifications for product improvements without notification

# ARKAY BOLLARD MOUNTING PLATE TEMPLATE

**WARNING:** If printing this template, ensure printer settings are set to actual size.

