

ALUDE 24, 36, & 45 WALL

MDOWS724; MDOWS732; MDOWS733

General Product Information



Tools Required/Suggested



Safety Information

CAUTION-RISK OF FIRE

This product must be installed in accordance with the applicable installation code by a person familiar with the construction and operation of the product and the hazards involved.

USE MINIMUM 90°C SUPPLY CONDUCTORS.

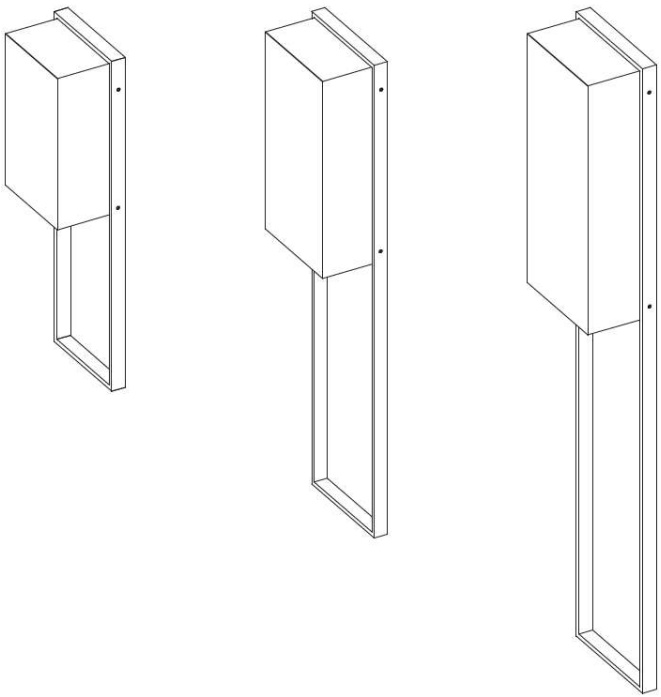
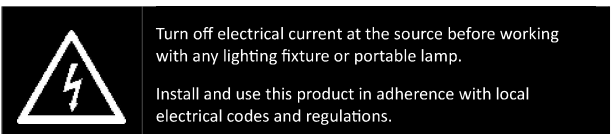

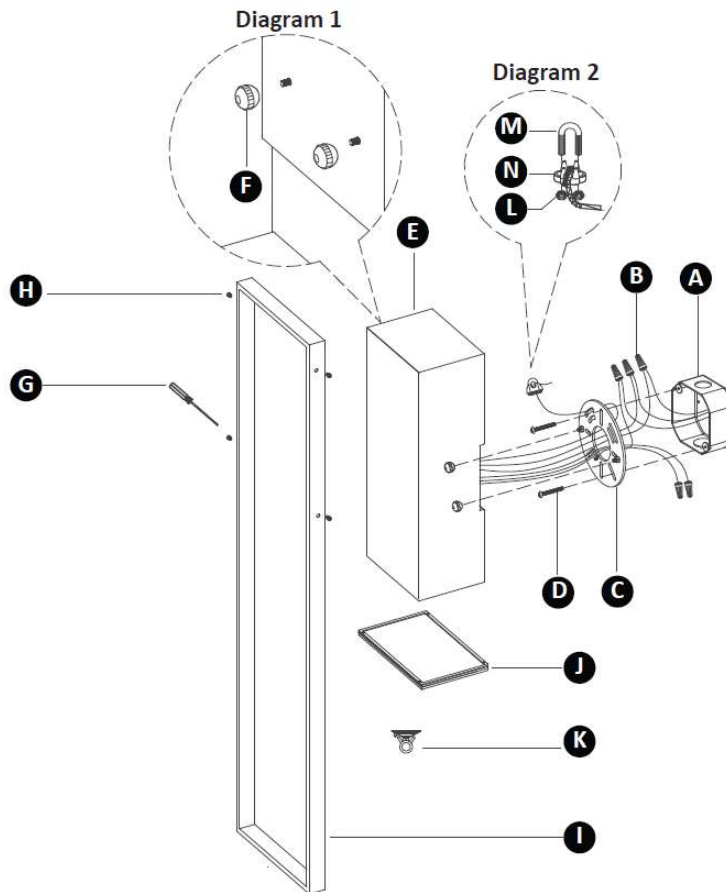

## FIXTURE PARTS

- A. Junction Box
- B. Wire Nut Connections
- C. Mounting Plate
- D. Mounting Screws
- E. Fixture
- F. Ball Nuts
- G. Screwdriver
- H. Set Screws
- I. Fixture Frame
- J. Diffuser
- K. Tool
- L. Hex Nut
- M. U-bolt
- N. Saddle

## INSTRUCTIONS

### I. Preparing the Fixture

1. Unbox and inspect all items included in the fixture's packaging. Gently place all parts on a clean, soft surface.
2. Carefully remove the diffuser from the fixture using the provided tool.
3. Unscrew the ball nuts from the fixture to remove the mounting plate (see diagram 1).
4. Attach the mounting plate to the junction box using the provided mounting screws.

### II. Wiring the Fixture

1. Safety first! Locate the circuit breaker and switch it off to cut off the power supply to the relevant circuits to ensure there's no electricity running through the wiring.
2. For 0-10V dimming capabilities, connect the purple and pink wires to a compatible dimmer. Cap off these wires if not in use.
3. Feed the support cable through the hole on the back of the mounting plate. Loop it around the saddle, then secure it using the U-bolt and hex nuts (see diagram 2).
4. In accordance with local electrical codes, connect the fixture ground wire (bare copper or silver wire) to a suitable ground. This may be a green ground screw on the mounting plate, which the ground wire should be tightly wrapped around, or a house wire (green or bare copper wire without insulation).
5. Twist the bare ends of the following pairs of wires together with a wire nut to secure a connection:
  - a. Hot driver wire (black) and hot power line wire (usually black) from the junction box (hot to hot)
  - b. Neutral driver wire (white) and neutral power line wire (usually white) from the junction box (neutral to neutral)
6. Carefully tuck all wires behind the mounting plate into the junction box.

### III. Installing the Fixture

1. Install the fixture to the mounting plate and secure it using the ball nuts (see diagram 1). Then reattach the diffuser to the fixture using the provided tool.
2. Secure the fixture frame to the fixture with the set screws and provided screwdriver.  
**NOTE:** Overtightening may damage the fixture.
3. For outdoor/wet locations, apply a small bead of waterproof construction sealant where the backplate meets the wall to prevent water from entering. Please note that large gaps will need to be corrected before applying silicone compound.