

LAJOS 21 SCONCE

SLWS817

General Product Information

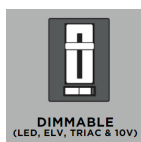
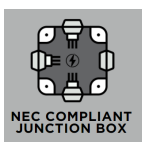
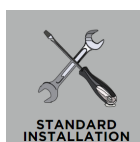
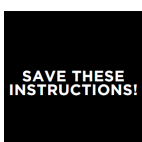

Suggested/Required Tools

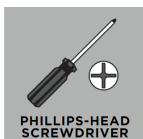

Safety Information

CAUTION-RISK OF FIRE

This product must be installed in accordance with the applicable installation code by a person familiar with the construction and operation of the product and the hazards involved.

USE MINIMUM 90°C SUPPLY CONDUCTORS.



Turn off electrical current at the source before working with any lighting fixture or portable lamp.

Install and use this product in adherence with local electrical codes and regulations.

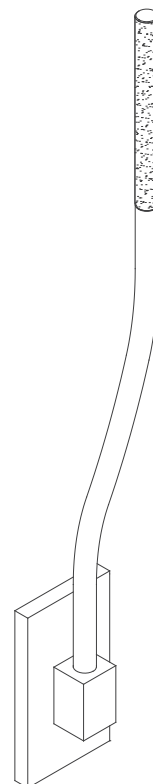

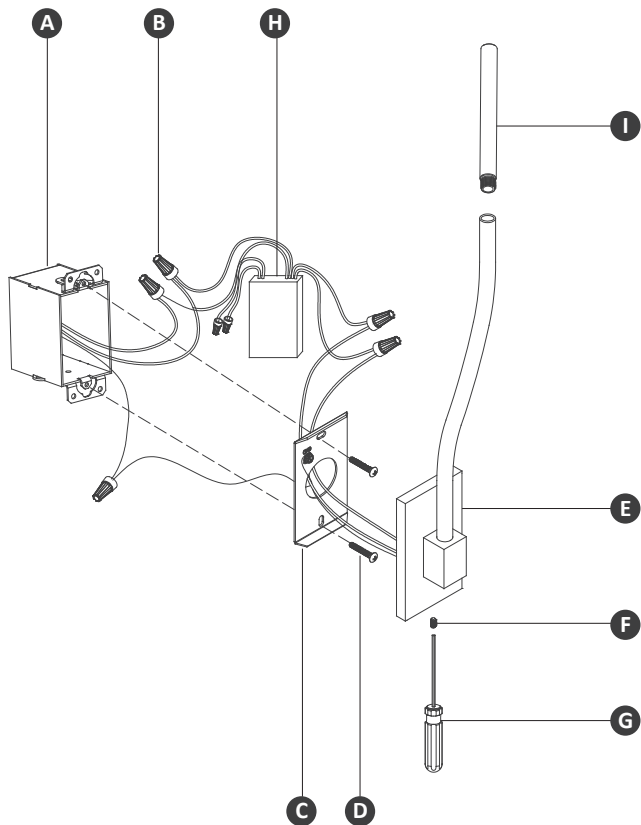

FIXTURE PARTS

- A. Junction Box (Not Included)
- B. Wire Nut Connections
- C. Mounting Plate
- D. Mounting Screws
- E. Fixture
- F. Set Screw
- G. Screwdriver
- H. Driver
- I. Shade

INSTRUCTIONS

I. Preparing the Fixture

1. Unbox and inspect all items included in the fixture's packaging. Carefully place all parts on a clean, soft surface.
2. Use the screwdriver to unscrew the set screw on the fixture, then remove the mounting plate from the fixture.

II. Wiring the Fixture

1. Safety first! Locate the circuit breaker and switch it off to cut off the power supply to the relevant circuits to ensure there's no electricity running through the wiring.
2. Connect the LED driver input wires to the local power line wires. Twist the bare ends of the following pairs of wires together using a wire nut to secure a connection:
 - a. Hot driver wire (black) and hot power line wire (usually black) from the junction box (hot to hot)
 - b. Neutral driver wire (white) and neutral power line wire (usually white) from the junction box (neutral to neutral)
3. For 0-10V dimming capabilities, connect the purple and pink wires to a compatible dimmer. Cap off these wires if not in use.
4. Place the driver in the junction box, ensuring the output driver wires are accessible.
5. Attach the mounting plate to the junction box using the mounting screws.
6. In accordance with local electrical codes, connect the fixture ground wire (bare copper or silver wire) to a suitable ground. This may be a green ground screw on the mounting plate, which the ground wire should be tightly wrapped around, or a house wire (green or bare copper wire without insulation).
7. Twist the bare ends of the following pairs of wires together using a wire nut to secure a connection:
 - a. Negative (- / blue) fixture wire to the negative (-) output driver wire
 - b. Positive (+ / red) fixture wire to the positive (+) output driver wire

III. Installing the Fixture

1. Secure the fixture to the mounting plate with the set screw and screwdriver.
2. Thread the shade to the fixture.