

## ASSEMBLY INSTRUCTIONS

### Linen Shade Version

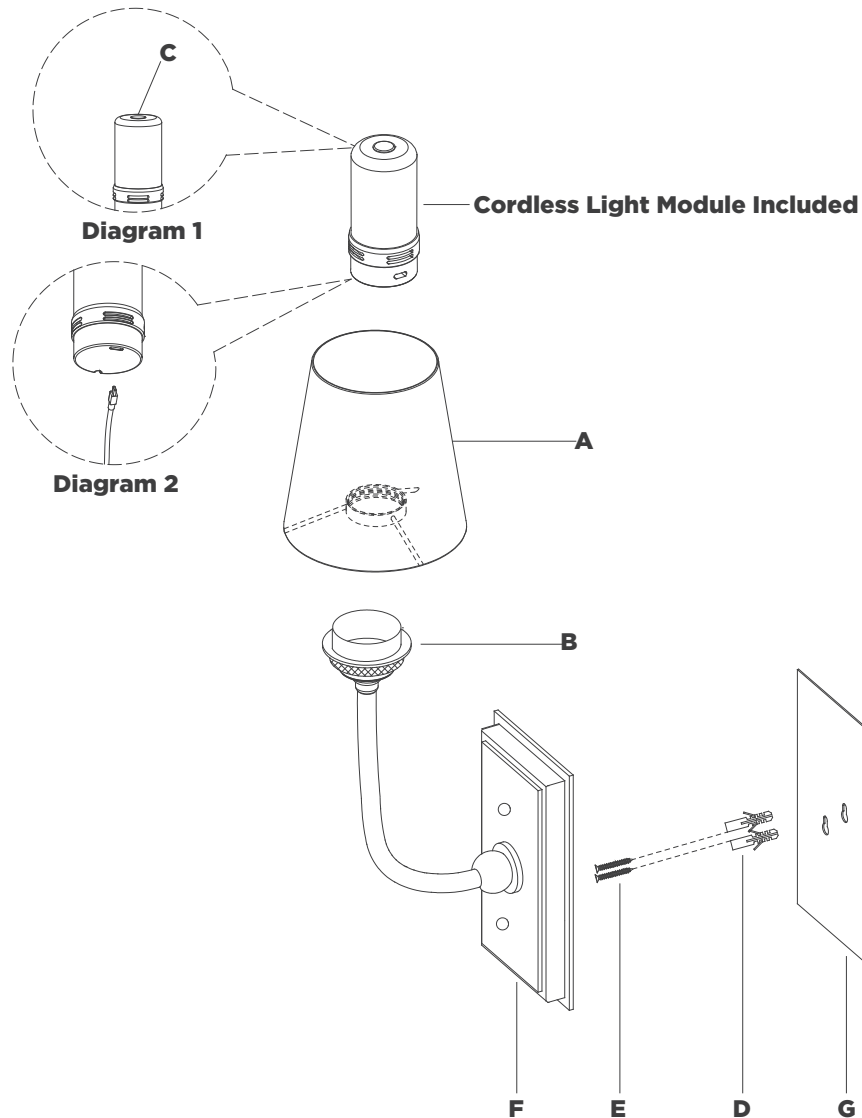

## Hulton 17" Cordless Single Sconce

Item # TOB2189

### NOTICE:

Inspect item carefully before attempting to install. If there is any damage or obvious defect, do not install. Item may not be returned once it has been installed.

### TOOLS REQUIRED (NOT INCLUDED):

Pencil

Hammer

Drill

1. Carefully remove all parts from the box. Place on a clean, soft surface.
2. Using card template **(G)** as a guide, mark anchor positions.
3. Using a drill bit slightly smaller than the anchor, drill holes in the marked positions. Install anchors **(D)** into the holes using a hammer.
4. Secure wood screws **(E)** to anchors **(D)**, leaving 1/8" of exposed thread in order to hang fixture.
5. Hook fixture **(F)** to wood screws **(E)**.
6. Place cordless light module into cordless module holder **(B)**.
7. Clip shade **(A)** onto cordless light module.

**NOTE:** If shade has additional packaging, carefully cut from interior of shade to avoid damage.

8. For best results fully charge battery before use.

9. Test the lamp.

**Dimmer switch operation:** Touch dimmer **(C)** to adjust between high, medium, low and off settings (see diagram 1).

**Charging Instructions:** Remove cordless light module from lamp and charge using provided USB-C cord (see diagram 2).

**NOTE:** For convenience, USB-C to USB-A adapter is included.

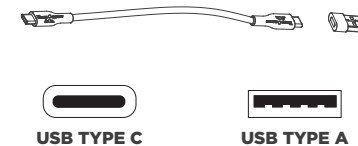

**CARE INSTRUCTIONS:** Clean only with a soft dry cloth or feather duster. Do not use abrasive or chemical agents.

VISUAL COMFORT & Co.



## ASSEMBLY INSTRUCTIONS

### WG Glass Shade Version

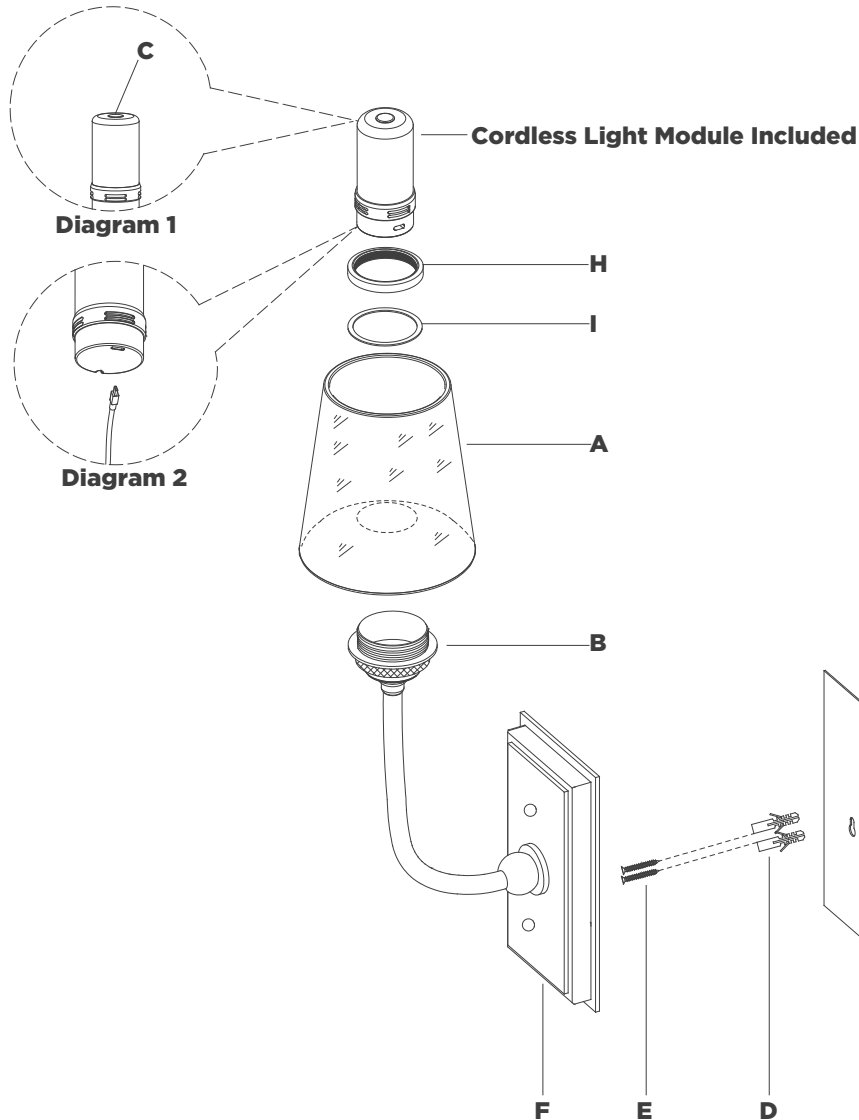

## Hulton 17" Cordless Single Sconce

Item # TOB2189

### NOTICE:

Inspect item carefully before attempting to install. If there is any damage or obvious defect, do not install. Item may not be returned once it has been installed.

### TOOLS REQUIRED (NOT INCLUDED):

Pencil

Hammer

Drill

1. Carefully remove all parts from the box. Place on a clean, soft surface.
2. Using card template **(G)** as a guide, mark anchor positions.
3. Using a drill bit slightly smaller than the anchor, drill holes in the marked positions. Install anchors **(D)** into the holes using a hammer.
4. Secure wood screws **(E)** to anchors **(D)**, leaving 1/8" of exposed thread in order to hang fixture.
5. Hook fixture **(F)** to wood screws **(E)**.
6. Remove socket ring **(H)** and rubber washer **(I)** from cordless module holder **(B)**, then install shade **(A)** to cordless module holder **(B)** and secure with rubber washer **(I)** and socket ring **(H)**.
7. Place cordless light module into cordless module holder **(B)**.
8. For best results fully charge battery before use.
9. Test the lamp.

**Dimmer switch operation:** Touch dimmer **(C)** to adjust between high, medium, low and off settings (see diagram 1).

**Charging Instructions:** Remove cordless light module from lamp and charge using provided USB-C cord (see diagram 2).

**NOTE:** For convenience, USB-C to USB-A adapter is included.



USB TYPE C



USB TYPE A

VISUAL COMFORT & CO.

**CARE INSTRUCTIONS:** Clean only with a soft dry cloth or feather duster. Do not use abrasive or chemical agents.

