

# TEAR SHEET



## Runia 49" Sculpted Side Table Floor Lamp

Item # AMB 1100ECL-MTB

Designer: Anne-Marie Barton

Height: 48.75"

Width: 18.75"

Finishes: ECL

Shade Treatments: MTB

Shade Details: 5" x 8" x 20.5"

Socket: E26 Pull Chain

Wattage: 15 LED A19

Weight: 39 Pounds

Note: UL Only | Table Height 21.5"

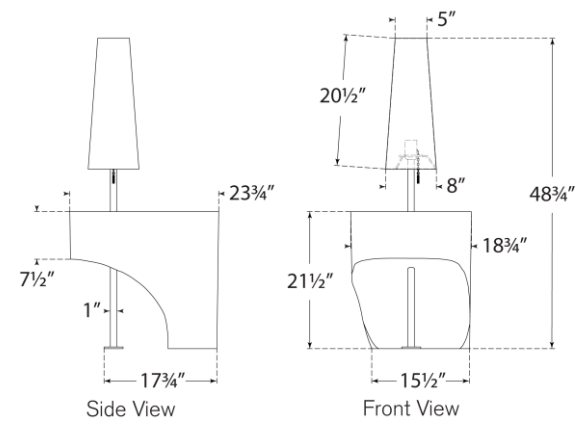

VISUAL COMFORT & Co.

