

VISUAL COMFORT & Co.

Item # TOB2804

This light fixture should be installed in accordance with all applicable, local installation codes, and by a person familiar with the construction and operation of it, as well as the hazards involved. Inspect item and contents carefully. If any damage or defect is found, do not install. Retain all packaging material until installation is complete and approved.

Phillips Screwdriver	Slotted Screwdriver	Hammer
Pencil	Drill	

7. Apply the provided threaded-locking adhesive **(O)** to set screws **(I)**, then install shade **(J)** to fixture arm **(F)** and secure with set screw **(I)** using provided screwdriver **(H)**.
8. Wrap fixture ground wire (bare copper) around the green grounding screw (see diagram 2). Tighten. Continue fixture ground wire and connect to supply ground wire (usually green or bare copper) using wire nut **(A)**.

NOTE: It is imperative that the fixture is grounded.

9. Connect fixture neutral wire (white) to the supply neutral wire (usually white) using wire nut **(A)**.

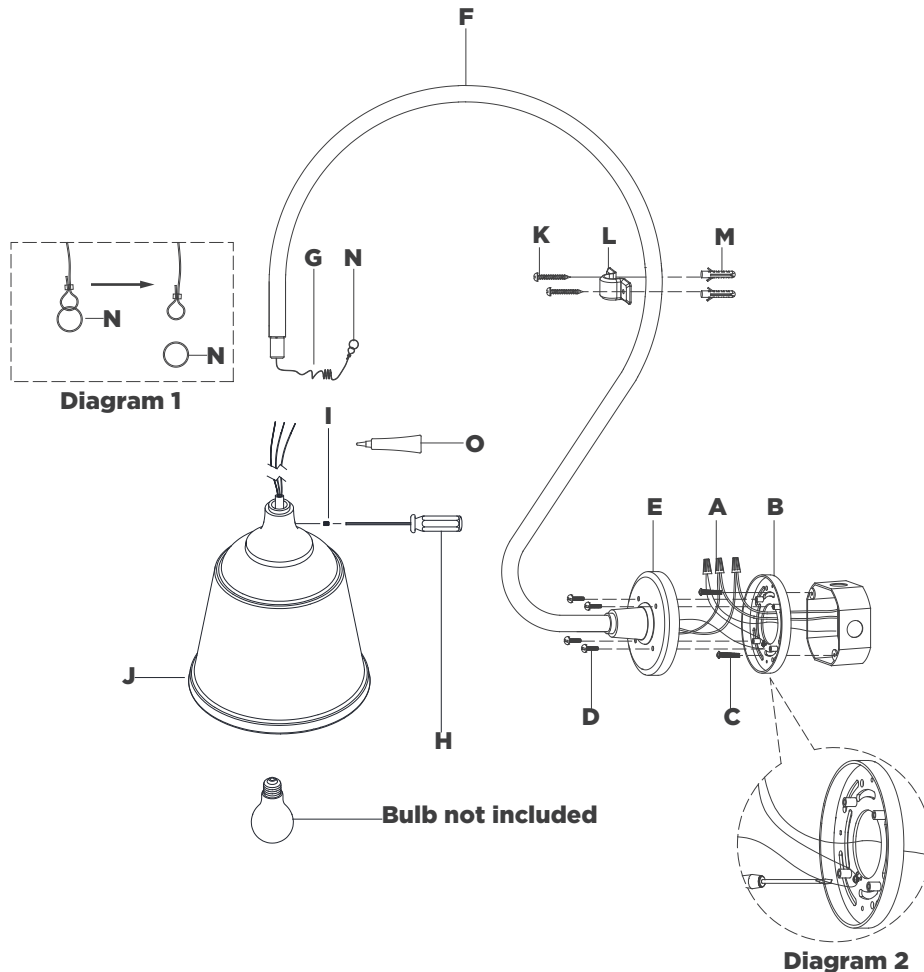

ASSEMBLY INSTRUCTIONS

Shade Option

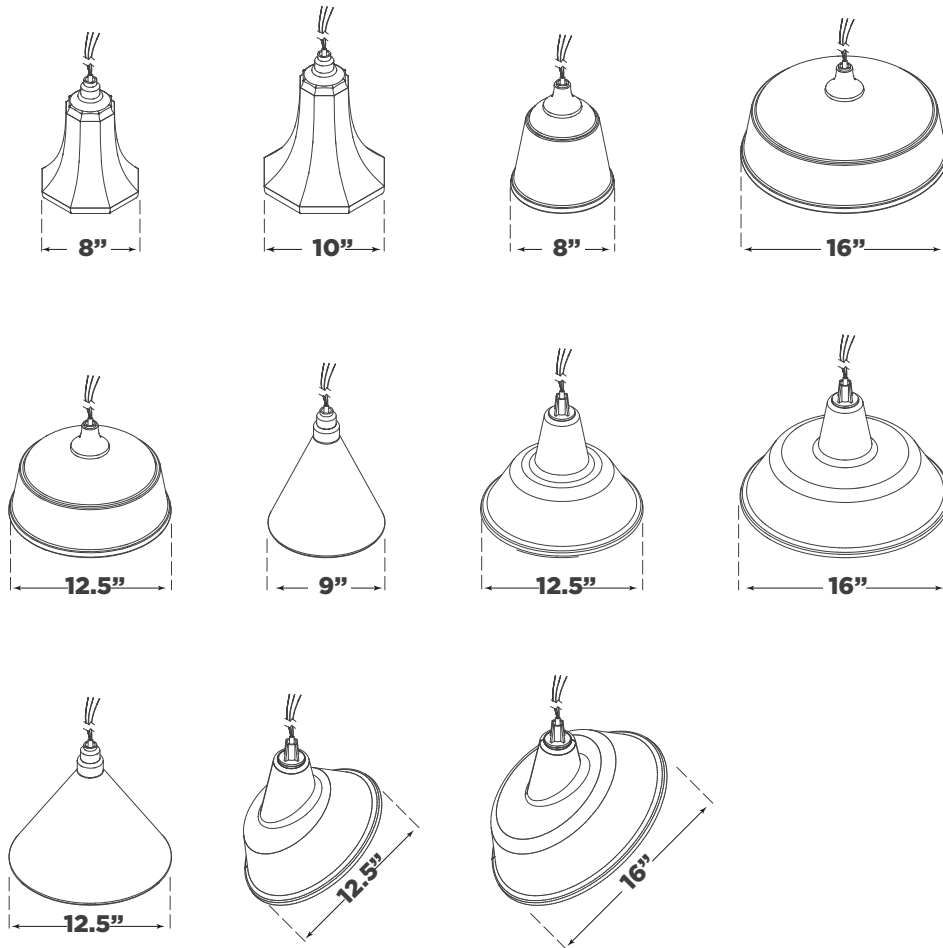

Academy 15" Larrabee Barn Light

Item # TOB2804

NOTICE:

This light fixture should be installed in accordance with all applicable, local installation codes, and by a person familiar with the construction and operation of it, as well as the hazards involved. Inspect item and contents carefully. If any damage or defect is found, do not install. Retain all packaging material until installation is complete and approved.

10. Connect fixture hot wire (black) to the supply hot wire (usually black) using wire nut **(A)**.
CAUTION: Do not reverse the hot and neutral connections.
11. Make sure all wire connections are tight, then carefully tuck into the junction box.
12. Install backplate **(E)** to mounting plate **(B)** and secure with screws **(D)**.
13. Fix fixture arm **(F)** to wall by securing bracket **(L)** to anchor **(M)** using wood screws **(K)**.
14. Install light bulb into the socket.

FOR OUTDOOR/WET LOCATION INSTALLATION:

15. Using silicone compound, apply a small bead where backplate meets the wall to prevent water from entering.
NOTE: Large gaps will need to be corrected before applying silicone compound.

CARE INSTRUCTIONS: Clean only with a soft dry cloth or feather duster. Do not use abrasive or chemical agents.