

RALPH LAUREN



Item # RL2045

This light fixture should be installed in accordance with all applicable, local installation codes, and by a person familiar with the construction and operation of it, as well as the hazards involved. Inspect item and contents carefully. If any damage or defect is found, do not install. Retain all packaging material until installation is complete and approved.

Phillips Screwdriver Slotted Screwdriver

- CAUTION:** Do not reverse the hot and neutral connections.

- NOTE:** It is imperative that the fixture is grounded.

- CAUTION:** Do not reverse the hot and neutral connections.

- ETL US
Intertek
- DRY
- LED
- 4

ASSEMBLY INSTRUCTIONS

Hudson St. 8" Sconce

Item # RL2045

NOTICE:

This light fixture should be installed in accordance with all applicable, local installation codes, and by a person familiar with the construction and operation of it, as well as the hazards involved. Inspect item and contents carefully. If any damage or defect is found, do not install. Retain all packaging material until installation is complete and approved.

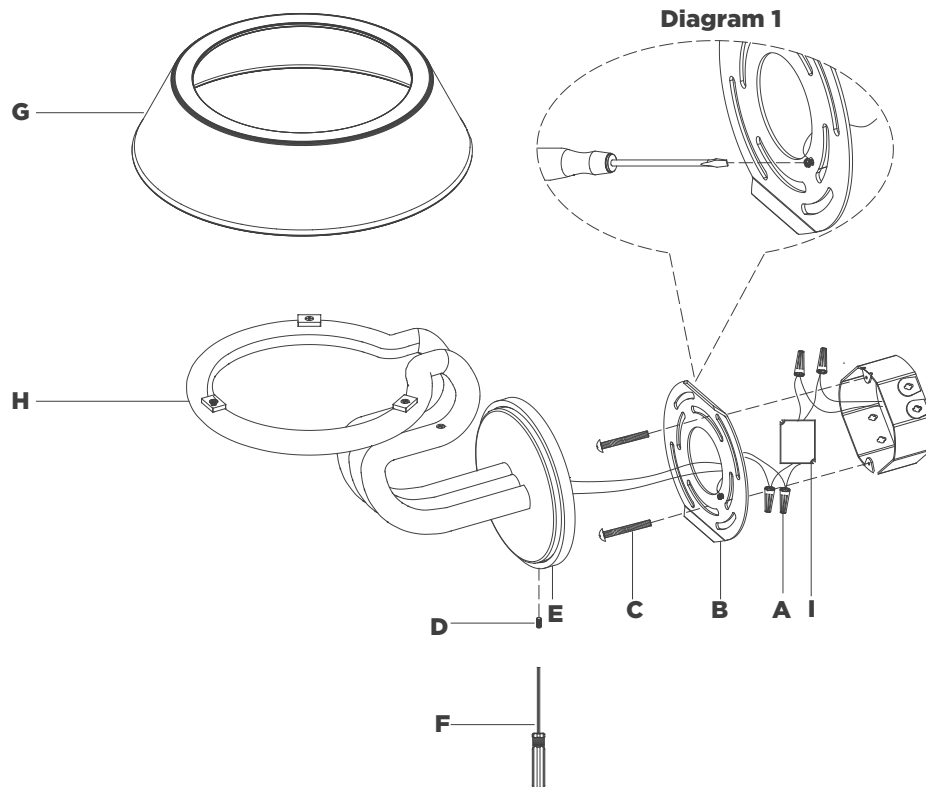

11. Install fixture **(E)** to mounting plate **(B)** and secure with set screws **(D)** using provided screwdriver **(F)**.
12. Place shade **(G)** onto fixture arm **(H)**.

CARE INSTRUCTIONS: Clean only with a soft dry cloth or feather duster. Do not use abrasive or chemical agents.

RALPH LAUREN