

ASSEMBLY INSTRUCTIONS

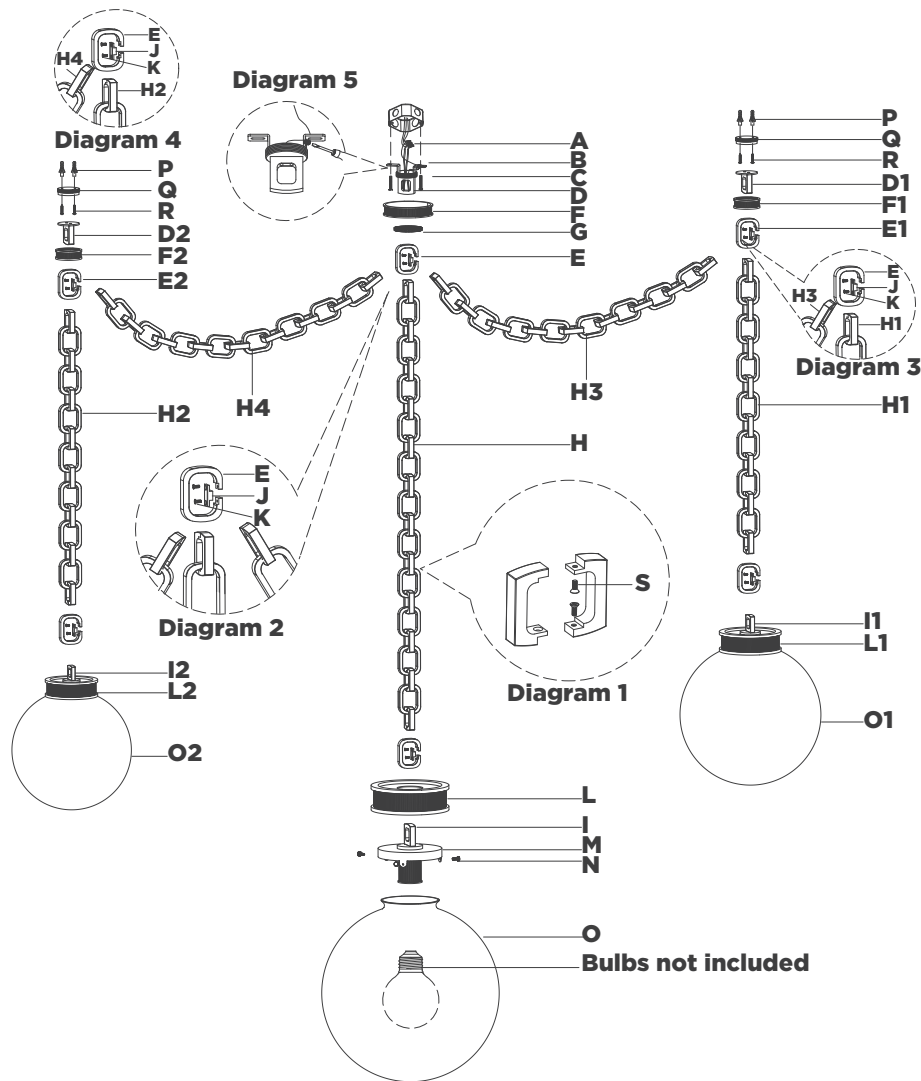

Bulbs not included

Bellamy 3 Light Statement Chain Multi Globe Chandelier Item # MF5415

NOTICE:

This light fixture should be installed in accordance with all applicable, local installation codes, and by a person familiar with the construction and operation of it, as well as the hazards involved. Inspect item and contents carefully. If any damage or defect is found, do not install. Retain all packaging material until installation is complete and approved.

TOOLS REQUIRED (NOT INCLUDED):

Phillips Screwdriver	Slotted Screwdriver	Wire Strippers
Slip Joint Pliers	Measuring Tape	Chain Pliers
Wire Cutters	Drill	Hammer
Pencil		

1. Carefully remove all parts from the box. Place on a clean, soft surface.
2. Remove canopy (F) from collar loop (D) by removing collar ring (G).
3. Install mounting plate (B) to junction box and secure with mounting screws (C).
4. Secure collar loop (D) to mounting plate (B) using pliers to tighten locknut.
5. Install canopy (F) to collar loop (D) and secure with collar ring (G).
6. Using metal plates (Q) as a guide, line up with the junction box and mark anchor positions.
7. Using a drill bit slightly smaller than the anchor, drill holes in the marked positions. Install anchors (P) into the holes using a hammer.
8. Install metal plates (Q) to ceiling and secure with wood screws (R) to anchors (P).
9. Place collar loops (D1 & D2) to canopies (F1 & F2), then thread canopies (F1 & F2) to metal plates (Q).
10. Determine desired overall length, and amount of chains (H & H1 & H2 & H3 & H4) needed. Shorten chain by removing screws (S) (see diagram 1). (Keep extra chain)

VISUAL COMFORT & Co.



11. Place metal covers **(L & L1 & L2)** on top of fixtures **(M)**.
12. Attach chains **(H & H1 & H2)** to collar loops **(D & D1 & D2)** and fixture loops **(I & I1 & I2)** using quick links **(E & E1 & E2)**, then attach chain **(H3 & H4)** to top quick links **(E & E1 & E3)**. Secure quick links by securing metal part **(J)** to quick links using screws **(K)** (see diagram 2 & 3 & 4).
13. Thread fixture wires and ground wires through chain **(H & H1 & H2 & H3 & H4)**.
NOTE: When you reach the collar loop **(D)**, ensure there is no tension on the wires. Cut excess wires, being sure to leave enough to reach the junction box.
14. Separate two sides of molded wire, and strip insulation on each 5/8".
15. Loosen collar ring **(G)** and let canopy **(F)** slip down chain **(H)** carefully.
16. Twist all fixture wires together, and slip through center hole of collar loop **(D)**.
NOTE: Untwist wires and separate to prepare for connection.
17. Wrap fixture ground wires (bare copper) around the green grounding screw (see diagram 5). Tighten. Continue fixture ground wires and connect to supply ground wire (usually green or bare copper) using wire nut **(A)**.
NOTE: It is imperative that the fixture is grounded.
18. Connect fixture neutral wires (ribbed) to the supply neutral wire (usually white) using wire nut **(A)**.

ASSEMBLY INSTRUCTIONS

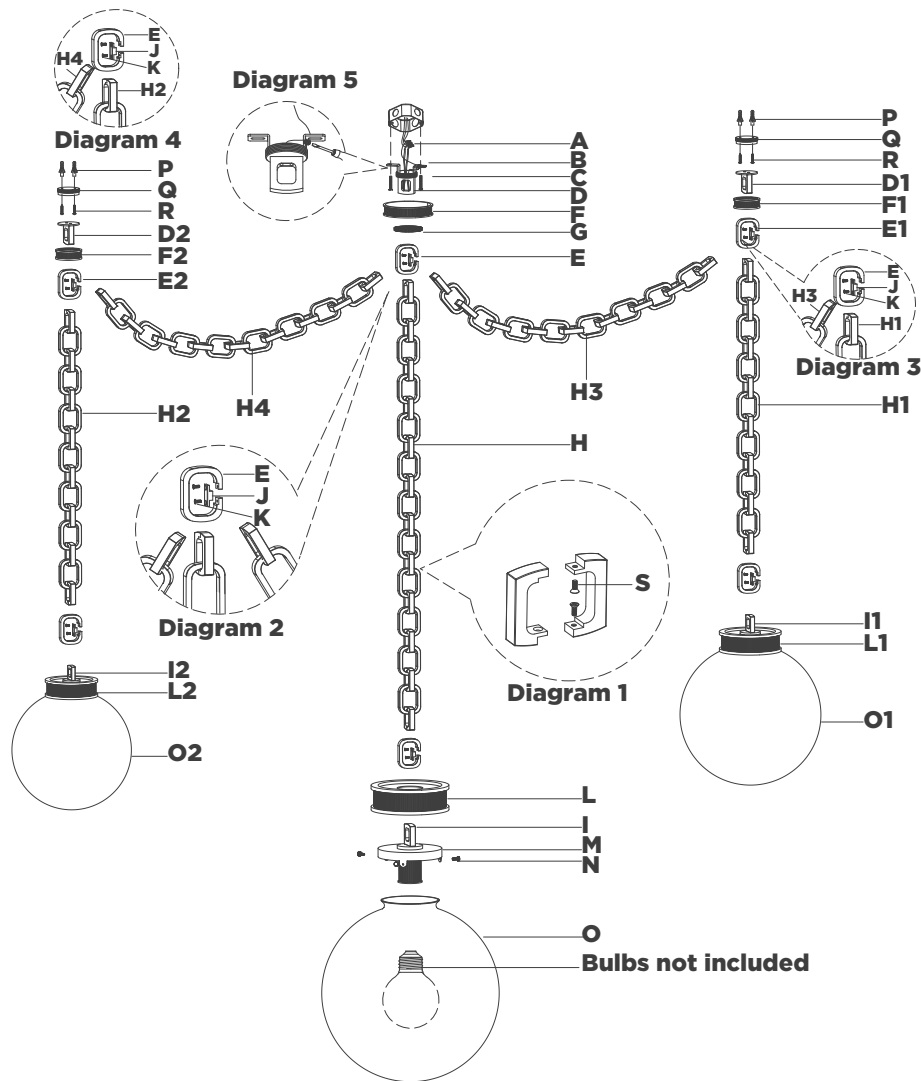

Bellamy 3 Light Statement Chain Multi Globe Chandelier Item # MF5415

NOTICE:

This light fixture should be installed in accordance with all applicable, local installation codes, and by a person familiar with the construction and operation of it, as well as the hazards involved. Inspect item and contents carefully. If any damage or defect is found, do not install. Retain all packaging material until installation is complete and approved.

19. Connect fixture hot wires (smooth with markings) to the supply hot wire (usually black) using wire nut **(A)**.
CAUTION: Do not reverse the hot and neutral connections.
20. Make sure all wire connections are tight, then carefully tuck into the junction box.
21. Install canopy **(F)** to collar loop **(D)** and secure with collar ring **(G)**.
22. Install light bulbs into the sockets.
23. Remove thumbscrews **(N)** from fixtures **(M)**, then install shades **(O & O1 & O2)** to fixtures **(M)** and secure with thumbscrews **(N)**.
NOTE: Do not overtighten otherwise glass shade could be damaged.

CARE INSTRUCTIONS: Clean only with a soft dry cloth or feather duster. Do not use abrasive or chemical agents.