

ASSEMBLY INSTRUCTIONS

Windchime 12" 3 Light Chandelier

Item # BBL5242

NOTICE:

This light fixture should be installed in accordance with all applicable, local installation codes, and by a person familiar with the construction and operation of it, as well as the hazards involved. Inspect item and contents carefully. If any damage or defect is found, do not install. Retain all packaging material until installation is complete and approved.

TOOLS REQUIRED (NOT INCLUDED):

Phillips Screwdriver	Slotted Screwdriver	Wire Strippers
Wire Cutters	Measuring Tape	
Pencil	Drill	

- Carefully remove all parts from the box. Place on a clean, soft surface.
- Place driver **(F)** into ceiling and route all wires through one of the knockouts in the junction box.
- Remove canopy **(D)** from mounting plate **(B)** by removing screws **(E)**.
- Using mounting plate **(B)** as a guide, line up with the junction box and mark anchor positions.
- Using a drill bit slightly smaller than the anchor, drill holes in the marked positions. Install anchors **(P)** into the holes using a hammer.
- Install mounting plate **(B)** to the junction box and secure with mounting screws **(C)**, then secure wood screws **(Q)** to anchors **(P)**.
- Gently set fixture on a flat, non-abrasive surface to assemble and adjust fixture hanging wires.
- Connect quick connector **(O1 & O2)** together (see diagram 1).
- Install the glass **(L1 & L2 & L3)** to fixture **(G1 & G2 & G3)** and secure with rubber washers **(M)** and screws **(N)** (see diagram 2).

NOTE: Do not overtighten otherwise glass shade could be damaged.

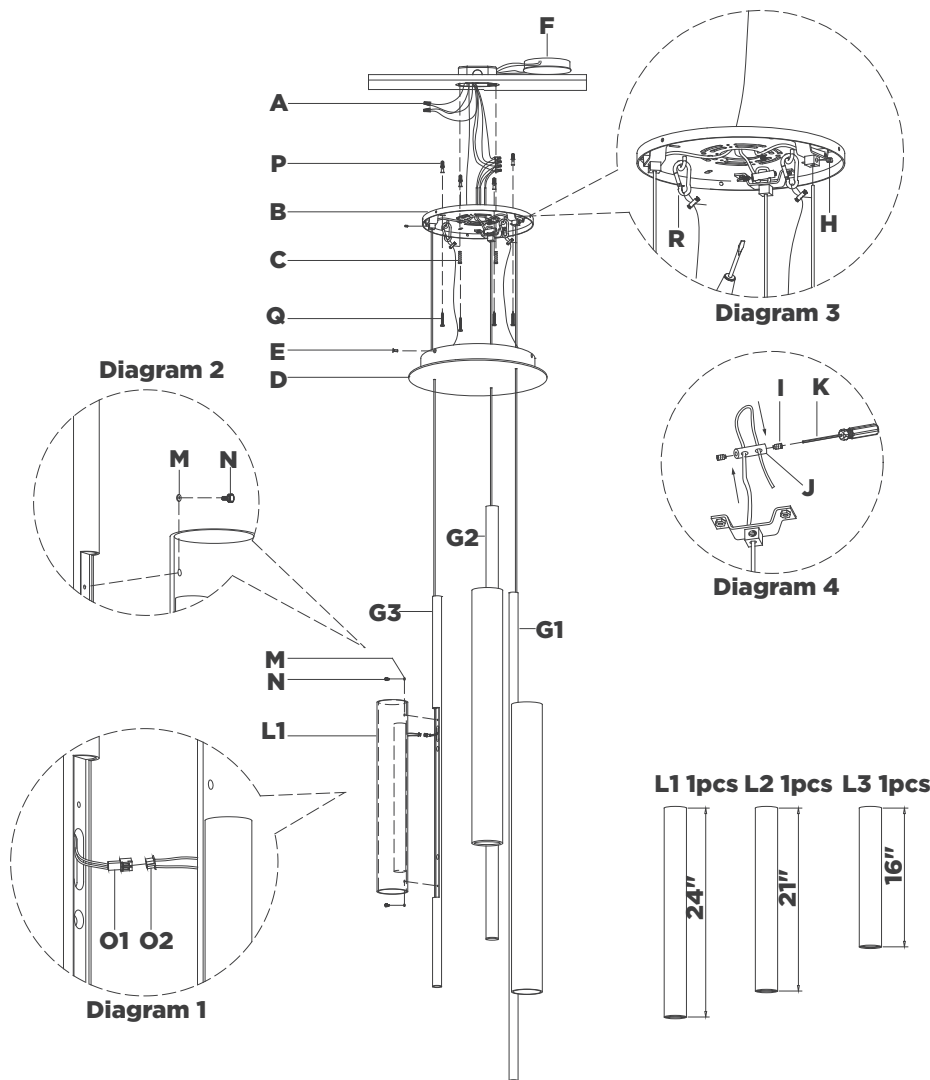

ASSEMBLY INSTRUCTIONS

Windchime 12" 3 Light Chandelier

Item # BBL5242

NOTICE:

This light fixture should be installed in accordance with all applicable, local installation codes, and by a person familiar with the construction and operation of it, as well as the hazards involved. Inspect item and contents carefully. If any damage or defect is found, do not install. Retain all packaging material until installation is complete and approved.

10. Feed fixture cables through canopy (**D**), then hang the hanging cables (**R**) to the loops on bottom of mounting plate (**B**) (see diagram 3).
 11. Insert fixture cables through the center hole of mounting plate (**B**) brackets and secure with set screws (**H**), then loosen cable locks (**J**) and install to end of fixture cables. Insert other end (**I**) of cables through the cable locks (**J**) and tighten ends (**I**) with a screwdriver (**K**) to secure (see diagram 4).
- NOTE:** Set fixture to desired height before moving to next step.
12. After fixture height is achieved shorten wires by using a pair of cutters, leaving enough wire to connect to driver (**F**) output wires.
 13. Remove outer housing of wire by making a neat cut all the way around, about 1" from the end. Once cut is made, remove and discard the 1" piece of housing, exposing the electrical wires.
- NOTE:** Make sure not to cut too deep into housing or electrical wires could become damaged.
14. Separate wires and strip insulation on each 5/8".
 15. Connect driver (**F**) output neutral wire (black) to the fixture neutral wires (marked "-") using wire nut (**A**).
 16. Connect driver (**F**) output hot wire (red) to the fixture hot wires (marked "+") using wire nut (**A**).

CAUTION: Do not reverse the hot and neutral connections.

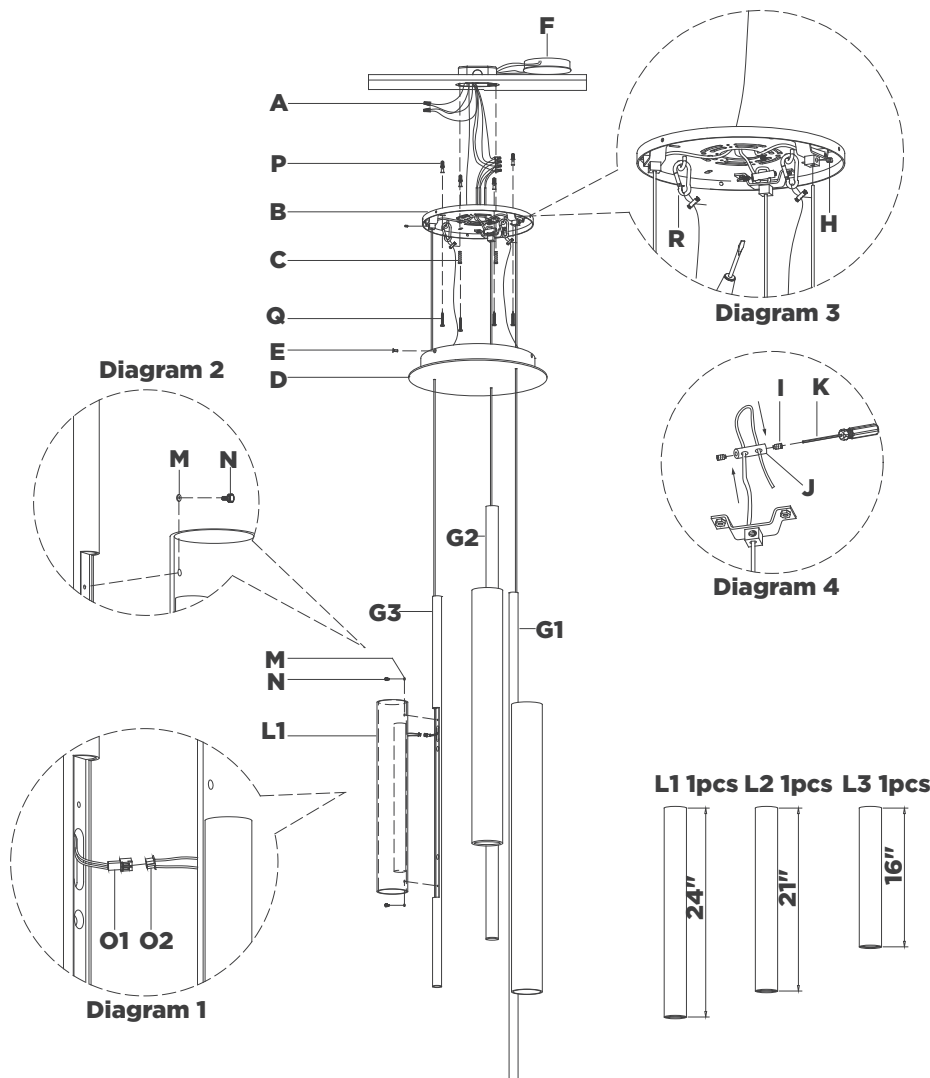

ASSEMBLY INSTRUCTIONS

Windchime 12" 3 Light Chandelier

Item # BBL5242

NOTICE:

This light fixture should be installed in accordance with all applicable, local installation codes, and by a person familiar with the construction and operation of it, as well as the hazards involved. Inspect item and contents carefully. If any damage or defect is found, do not install. Retain all packaging material until installation is complete and approved.

17. Connect supply ground wire (usually green or bare copper) around the green grounding screw (see diagram 4).
Tighten.
NOTE: It is imperative that the fixture is grounded.
18. Connect driver **(F)** input neutral wire (white) to the supply neutral wire (usually white) using wire nut **(A)**.
19. Connect driver **(F)** input hot wire (black) to the supply hot wire (usually black) using wire nut **(A)**.
CAUTION: Do not reverse the hot and neutral connections.
20. Make sure all wire connections are tight, then carefully tuck into the junction box.
21. Install canopy **(D)** to mounting plate **(B)** and secure with screws **(E)**.

CARE INSTRUCTIONS: Clean only with a soft dry cloth or feather duster. Do not use abrasive or chemical agents.

