

INSTALLATION INSTRUCTIONS

Outdoor Track Luminaire

X-10



CAUTION: TO PREVENT ELECTRICAL SHOCK, ENSURE ELECTRICITY HAS BEEN TURNED OFF AT THE CIRCUIT BREAKER BEFORE BEGINNING.

- Read all instructions before installing.
- System is intended for installation by a licensed electrician in accordance with the National Electrical Code (NEC) and local regulations.
- When handling the fixture, do not apply pressure to the LEDs. Hold the fixture by the base only.
- Retain installation instructions for future maintenance reference.

WARNING: All parts must be used as indicated in these instructions. This product is designed for use only with the supplied parts and/or accessories designated for use by WAC Lighting. Substitution of parts or accessories not designated for use with this product by WAC Lighting could result in personal injury or property damage, and will void the warranty. Contact an authorized dealer or the manufacturer if any parts are damaged or missing.

MISE EN GARDE: POUR ÉVITER TOUT CHOC ÉLECTRIQUE, ASSUREZ-VOUS QUE LE DISJONCTEUR SOIT MIS HORS TENSION AVANT DE COMMENCER.

- Lisez toutes les instructions avant l'installation.
- Le système doit être installé par un électricien licencié conformément au code national de l'électricité (NEC), et également aux règlements locaux.
- Lors de la manipulation du luminaire, n'appuyez pas sur les LED. Tenez-le uniquement par la base.

ATTENTION: Toutes les pièces doivent être utilisées comme indiqué dans ces instructions. Ce produit est conçu pour être utilisé seulement avec les pièces et/ou accessoires fournis pour être utilisés avec les produits WAC Lighting. Remplacer des pièces ou accessoires non conçus pour ce produit WAC Lighting pourrait causer des dommages corporels ou matériels et pourrait également causer l'annulation de la garantie. Veuillez contacter un revendeur autorisé ou le fabricant si des pièces manquent ou sont endommagées.

OVERALL FIXTURE DIMENSIONS

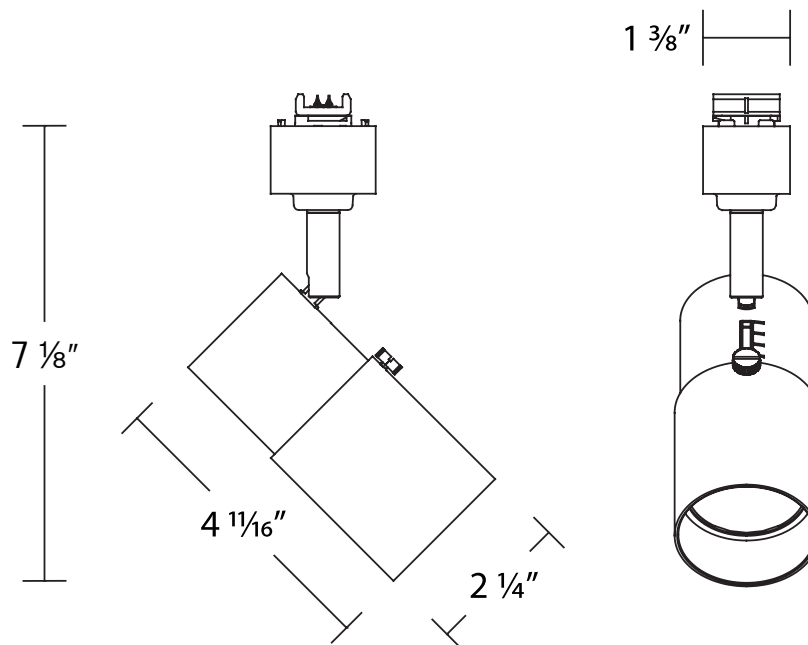

NOTE: All parts must be used as indicated in these instructions. Do not substitute any parts, leave parts out, or use any parts that are worn out or broken. Failure to follow this instruction could invalidate the ETL/cETL listing of this fixture.

waclighting.com
Phone (800) 526.2588
Fax (800) 526.2585

Headquarters/Eastern Distribution Center
44 Harbor Park Drive
Port Washington, NY 11050

Central Distribution Center
1600 Distribution Ct
Lithia Springs, GA 30122

Western Distribution Center
1750 Archibald Avenue
Ontario, CA 91760



INSTALLATION INSTRUCTIONS

Outdoor Track Luminaire X-10

WAC

FIXTURE INSTALLATION INTO X-TRACK:

1. Ensure the indicator lines on the adapter are properly aligned. If they are misaligned, rotate the upper U-shaped bracket 90° counter clockwise (see **FIG. 1**)

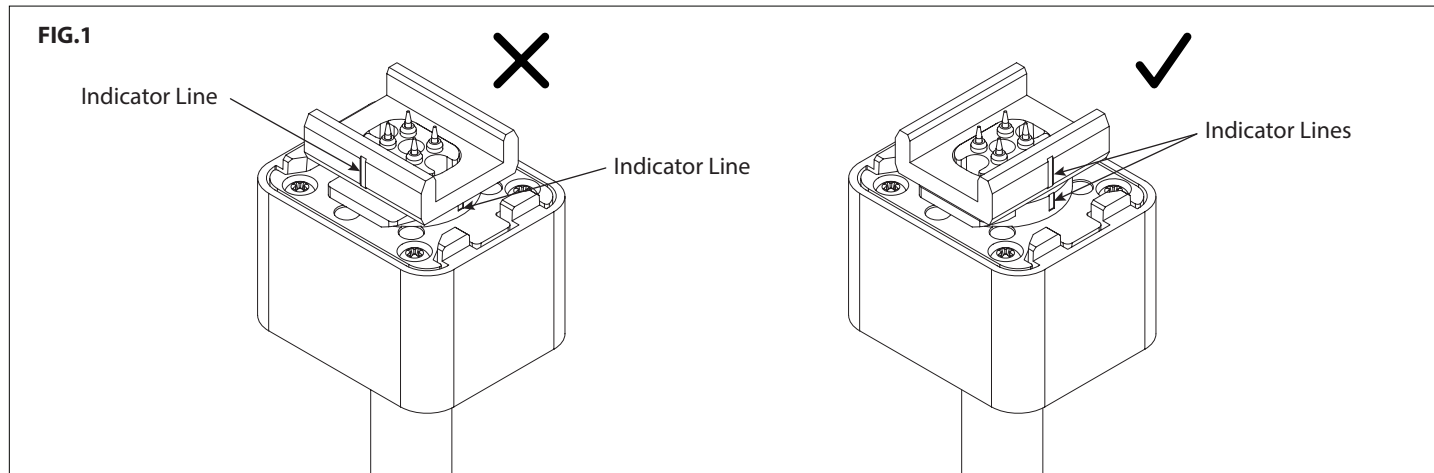

2. Raise fixture to the track. U-shaped bracket fits over the center cable channel. Using the stem, push upwards (See **FIG. 2**).

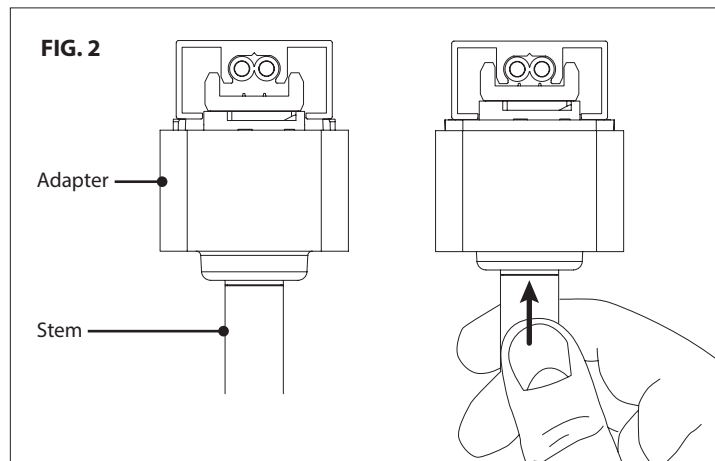

3. With the stem still pushed up, grab the base of the adapter and twist 90° clockwise. The spring-loaded outer collar should click into place to lock the fixture to the track (See **FIG. 3**).

NOTE: Be sure to twist from the adapter (rectangular base), do not twist the fixture head during installation.

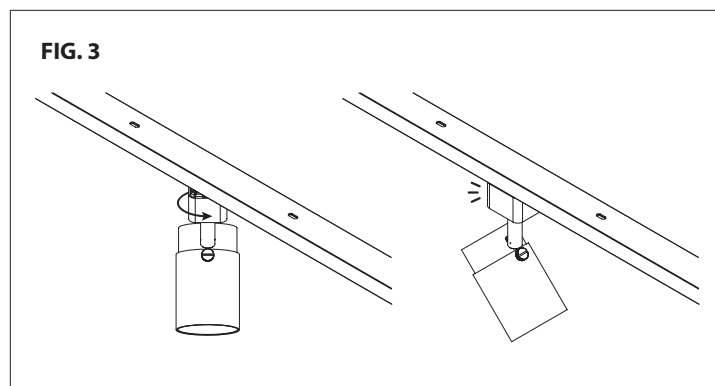

INSTALLATION INSTRUCTIONS

Outdoor Track Luminaire

X-10

WAC

4. To remove the fixture, pull down on the adapter and rotate 90° counter clockwise (See **FIG. 4**)

FIG. 4

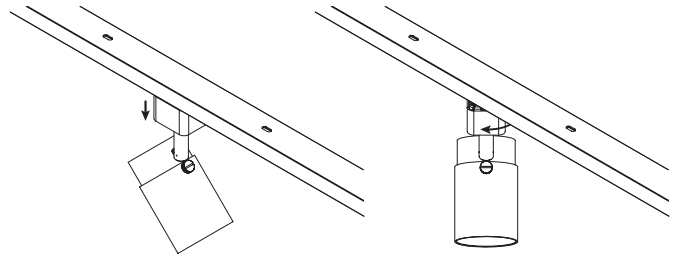

FIXTURE AIMING AND ADJUSTMENT:

1. Fixture is capable of 90° vertical tilt and 360° horizontal rotation (See **FIG. 5**)

FIG. 5

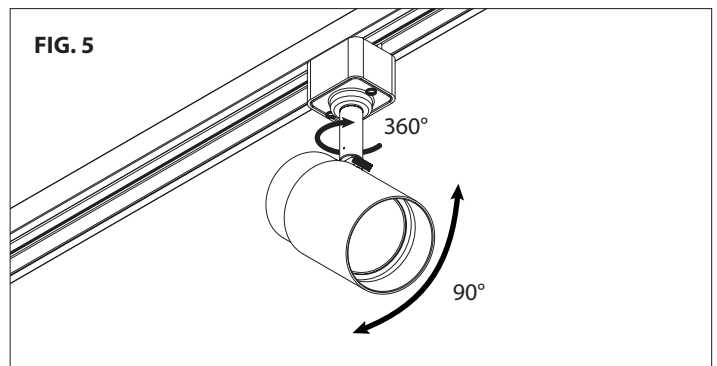

2. To adjust the beam angle, loosen thumb screw. Slide the shroud forward or back to until desired beam is achieved. Tighten thumb screw to lock (See **FIG. 6**).

FIG. 6

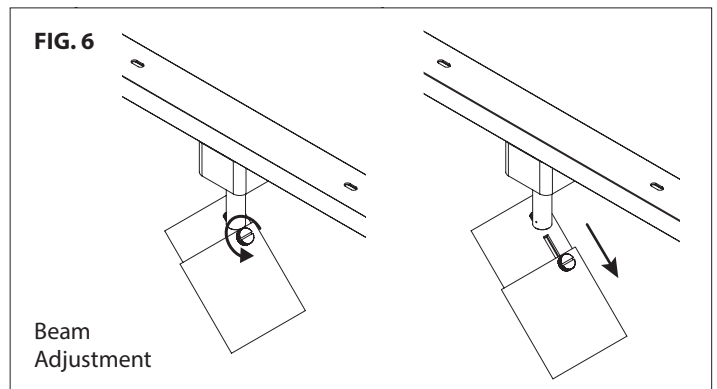

ADDING ACCESSORIES:

1. To add accessories to the fixture, an accessory holder is required (sold separately).

Remove inner ring. Place up to two accessories inside holder. Replace inner ring to secure (See **FIG. 7**).

FIG. 7

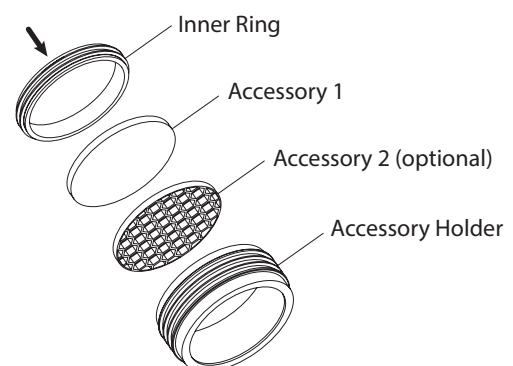

INSTALLATION INSTRUCTIONS

Outdoor Track Luminaire

X-10

WAC

2. Press fit accessory holder into the front of the fixture (See **FIG. 8**).

To remove, gently press on the accessory in the center until a gap appears between the accessory and the accessory holder's front edge. Gently pull the accessory holder out from the front edge.

FIG. 8

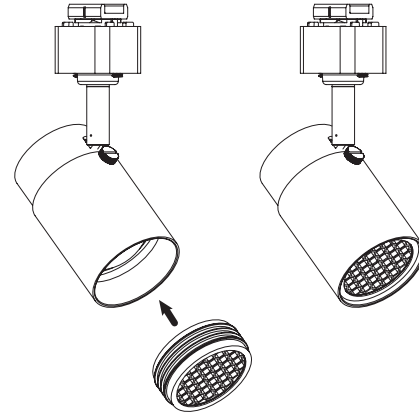

wacighting.com
Phone (800) 526.2588
Fax (800) 526.2585

Headquarters/Eastern Distribution Center
44 Harbor Park Drive
Port Washington, NY 11050

Central Distribution Center
1600 Distribution Ct
Lithia Springs, GA 30122

Western Distribution Center
1750 Archibald Avenue
Ontario, CA 91760

