

ASSEMBLY INSTRUCTION

# Logs mirror

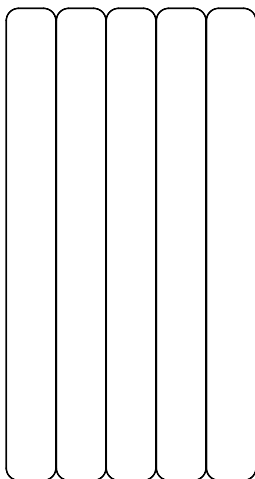

**WOUD**

DID YOU ONCE WALK THROUGH THE NORDIC  
BIRCH FORESTS? DID YOU ALSO FEEL RELEA-  
SED AND OVERWHELMED BY THE BEAUTY AND  
CALMNESS AROUND YOU? I TRIED TO CAPTURE  
THIS MYTH IN A PRODUCT. WITH LOGS MIRROR,  
YOU CAN IMAGINE STANDING IN A FOREST  
WITH MANY TREES OF SIMILAR YET SLIGHTLY  
DIFFERENT SHAPES AND COLOUR TONES

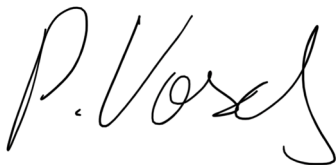
A stylized, handwritten signature in black ink, reading 'P. Vossel'. The letters are fluid and connected, with a large 'P' and a long, sweeping tail on the 'V'.

VOSDING INDUSTRIAL DESIGN

**TAKE CARE**

**WE HAVE NOW HANDED OVER  
ONE OF OUR DARLINGS TO YOU.  
NOW IT IS YOURS. TAKE GOOD  
CARE OF IT. YOU CAN READ THE  
CARE INSTRUCTIONS FOR ALL  
OUR MATERIALS AT OUR WEBSITE.**

**WOUD.DK/TAKECARE**

# **ASSEMBLY INSTRUCTION**

**PLEASE GO THROUGH THE FOLLOWING  
STEPS CAREFULLY. RETAIN THIS MANUAL  
FOR FUTURE REFERENCE TO ENSURE THAT  
YOUR NEW ITEM IS CORRECTLY ASSEMBLED  
IN CASE IT SHOULD BE DISASSEMBLED OR  
MOVED. WE ARE NOT RESPONSIBLE FOR  
ANY FAULTS OR DAMAGES CAUSED BY  
NOT FOLLOWING THESE INSTRUCTIONS  
CORRECTLY.**

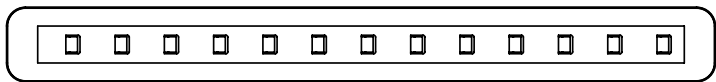

**A x 3 or 5**



**B x 2**

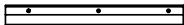

**B x 2**



**c x 6**

# TOOLS NEEDED

## IMPORTANT!

THESE ITEMS ARE NOT INCL. AND CAN BE PURCHASED IN THE STORES.  
USE WALL PLUGS AND DRILLS SUITABLE FOR YOUR WALL. BE CAREFUL  
WITH THIN/PLASTER/DRY WALLS AND SOLID CONCRETE WALLS. IN CASE  
OF DOUBT, WE RECOMMEND THAT YOU ASK A PROFESSIONAL.

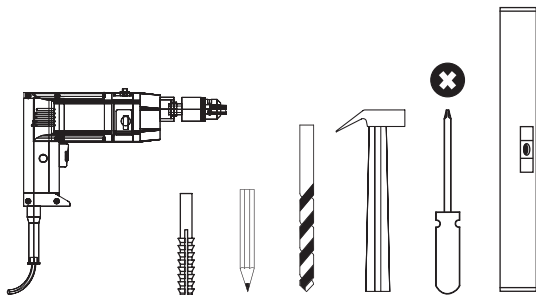

## STEP 0

CHOOSE TO HANG THE MIRRORS VERTICAL OR HORIZONTAL.

VERTICAL MIRRORS

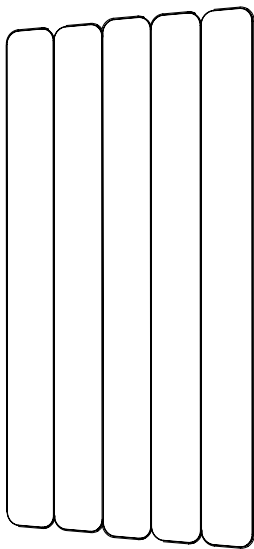

HORIZONTAL MIRRORS





# STEP 1

PLACE THE BRACKETS 40 CM APART. PLACE THE BRACKETS HORIZONTAL IF THE MIRROR SHOULD HANG VERTICAL OR PLACE THE BRACKETS VERTICAL IF THE MIRROR SHOULD HANG HORIZONTAL.

CHECK THE BRACKETS ARE TURNED CORRECTLY.

VERTICAL MIRROR

HORIZONTAL MIRROR

NB!

40 CM

40 CM

NB!

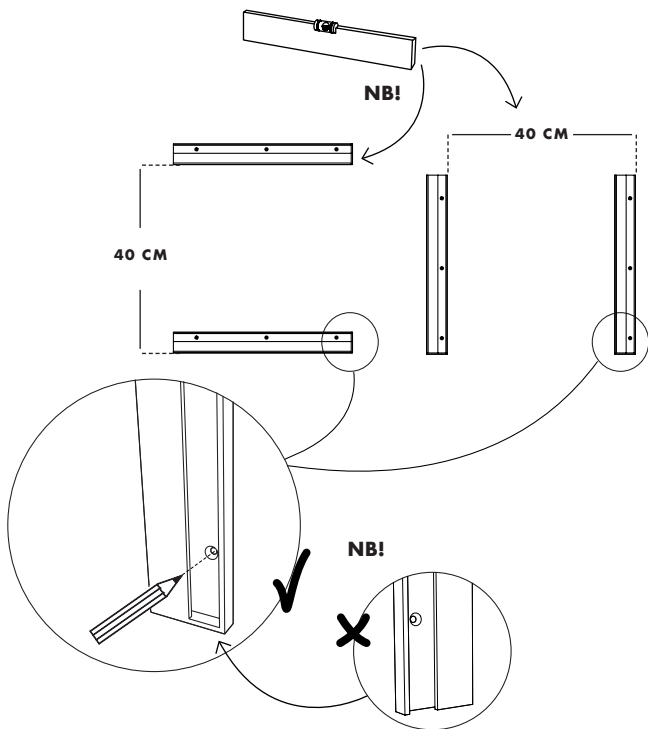

## STEP 1.2

IF YOU ARE PLANNING TO HANG MORE MIRRORS THEN 3 OR 5. PLEASE FOLLOW THE ASSEMBLY INSTRUCTIONS BELOW. THE EXAMPLE IS FOR HANGING 8 VERTICAL MIRRORS.

CHECK THE BRACKETS ARE TURNED CORRECTLY.

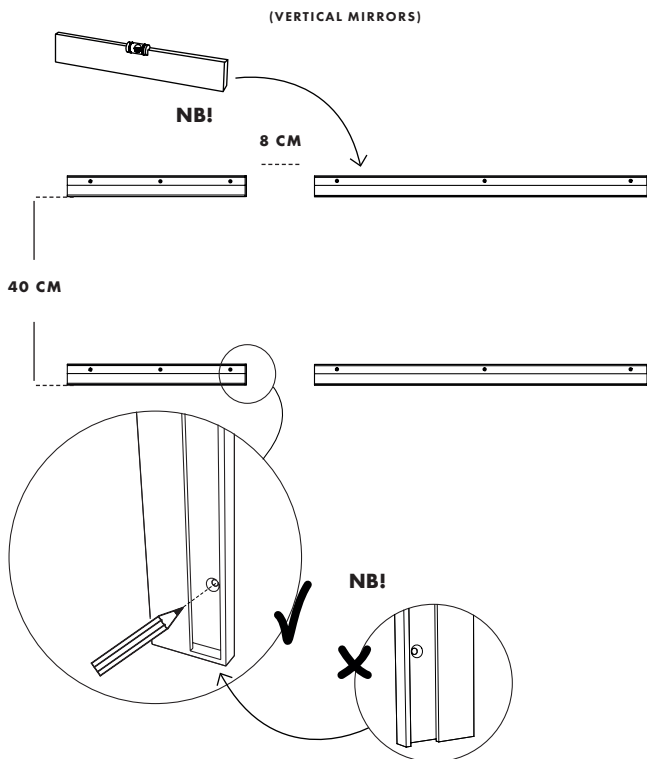

## STEP 2

DRILL HOLES IN THE WALL AT THE POINTS THAT WERE MARKED IN THE PREVIOUS STEP 1. THE DRILL END IS NOT INCLUDED, WE RECOMMEND THAT YOU CHECK WHICH DRILL END IS SUITABLE FOR YOUR WALL.

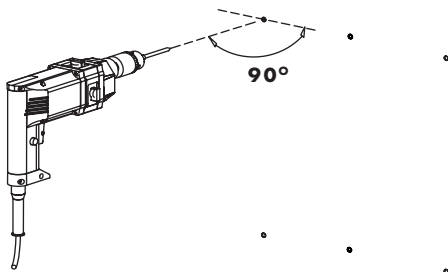

## STEP 3

APPLY THE WALL PLUGS.  
THE WALL PLUGS ARE NOT INCLUDED, WE RECOMMEND THAT YOU  
CHECK WHICH PLUGS FITS YOUR WALL.

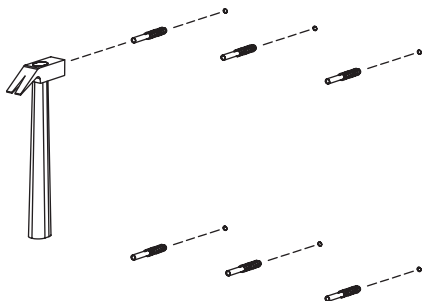

## STEP 4

**MOUNT THE FITTINGS TO THE WALL. MAKE SURE THE BRACKETS ARE TURNED THE RIGHT WAY, SO THE CLOSED END IS AT THE BOTTOM OR THE RIGHT HANDSIDE TO AVOID THE MIRRORS SLIDING THROUGH AND SMASHING.**

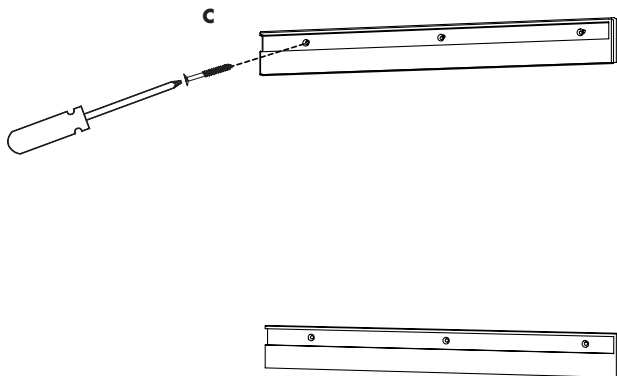

## STEP 5.1

MOUNT THE MIRRORS VERTICALLY ON THE FITTINGS.

CHECK AGAIN THAT THE BRACKETS ARE TURNED CORRECTLY.

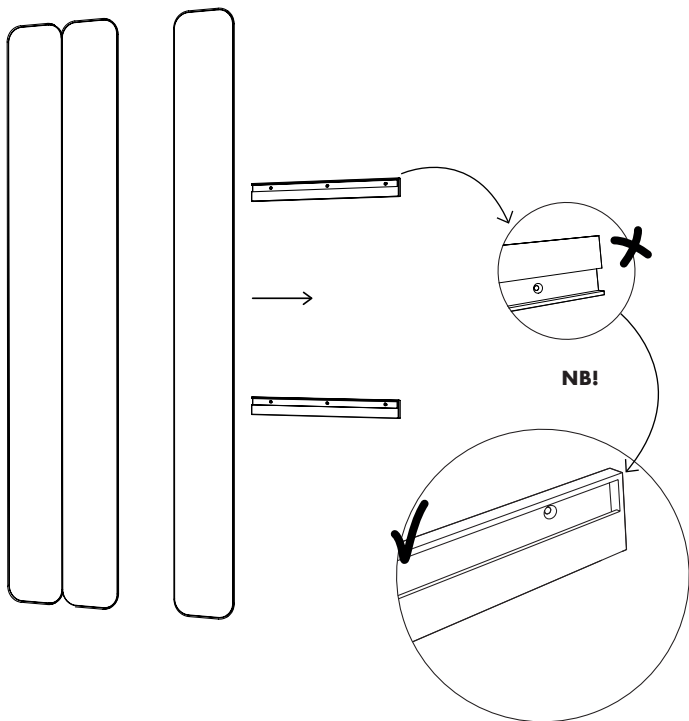

## STEP 5.2

MOUNT THE MIRRORS HORIZONTALLY ON THE FITTINGS.

CHECK AGAIN THAT THE BRACKETS ARE TURNED CORRECTLY.

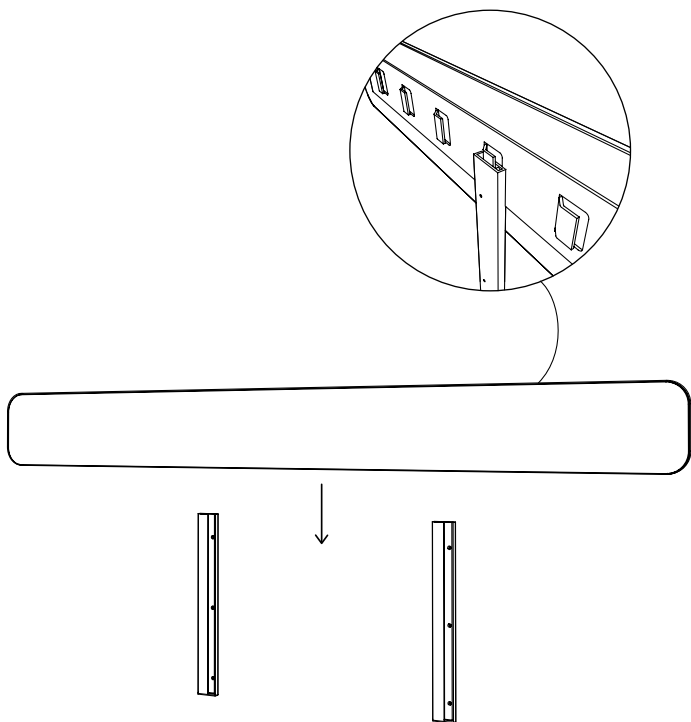

SEE [WWW.WOUD.DK](http://WWW.WOUD.DK) FOR CARE INSTRUCTIONS. BE GENTLE WHEN  
CLEANING THE MIRRORS TO PREVENT THE GLASS FROM CLASHING  
AGAINST EACH OTHER OR LIFTED OUT OF THE BRACKETS.

DESIGNED BY  
**VOSDING INDUSTRIAL DESIGN**