

ASSEMBLY INSTRUCTION

Array

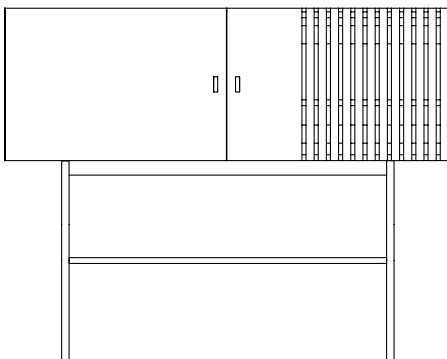

WOUD

ARRAY IS INSPIRED BY THE WOODEN SLATE
CLADDING FOUND IN MODERN ARCHITECTURE.
WITH ITS GEOMETRIC SHAPE AND HORIZONTAL
SLATES, ARRAY CREATES A STRONG VISUAL
DEPTH EFFECT FROM CATCHING BOTH LIGHT AND
SHADOW. THE ILLUSION OF TRANSPARENCY IS
INTENDED TO CREATE A FEELING OF GROWING
CURIOSITY AS YOU GET A GLIMPSE OF WHAT IS
HIDDEN BEHIND THE CLOSED DOORS. THE SLEEK
LEGS LIFT THE SIDEBOARD FROM THE GROUND
CREATING AN ELEGANT CONTRAST BETWEEN
THE SOLID WOODEN CABINET ON TOP AND THE
THIN METAL CONSTRUCTION UNDERNEATH. THE
ARRAY SERIES IS GRAPHICAL AND MODERN IN
ITS EXPRESSION WITH A MYSTERIOUS SHELL TO
CONTAIN YOUR PERSONAL ITEMS.

Kasper & Nikolaj
SAYS WHO

TAKE CARE

**WE HAVE NOW HANDED OVER
ONE OF OUR DARLINGS TO YOU.
NOW IT IS YOURS. TAKE GOOD
CARE OF IT. YOU CAN READ THE
CARE INSTRUCTIONS FOR ALL
OUR MATERIALS AT OUR WEBSITE.**

WOUD.DK/TAKECARE

ASSEMBLY INSTRUCTION

**PLEASE GO THROUGH THE FOLLOWING
STEPS CAREFULLY. RETAIN THIS MANUAL
FOR FUTURE REFERENCE TO ENSURE THAT
YOUR NEW ITEM IS CORRECTLY ASSEMBLED
IN CASE IT SHOULD BE DISASSEMBLED OR
MOVED. WE ARE NOT RESPONSIBLE FOR
ANY FAULTS OR DAMAGES CAUSED BY
NOT FOLLOWING THESE INSTRUCTIONS
CORRECTLY.**

A X 1

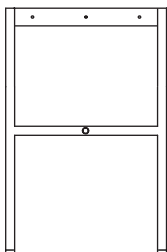
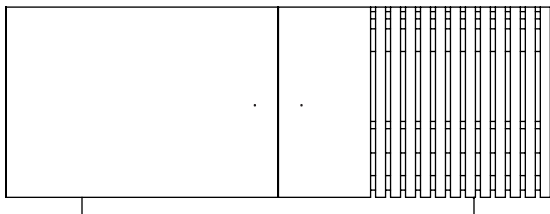

B X 2



C X 1



D X 6



E X 2



F X 1



G X 1



H X 2



I X 2

THIS INSTRUCTIONS MANUAL IS VALID FOR:

ARRAY SIDEBOARD (120 CM)

ARRAY SIDEBOARD (180 CM)

ARRAY HIGHBOARD (80 CM)

TOOLS NEEDED

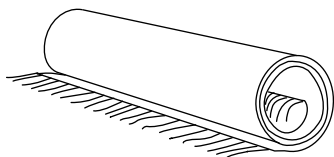

x 2



x 2

STEP 1

MOUNT THE LEGS ON THE METAL FRAME UNDER THE WOODEN CABINET

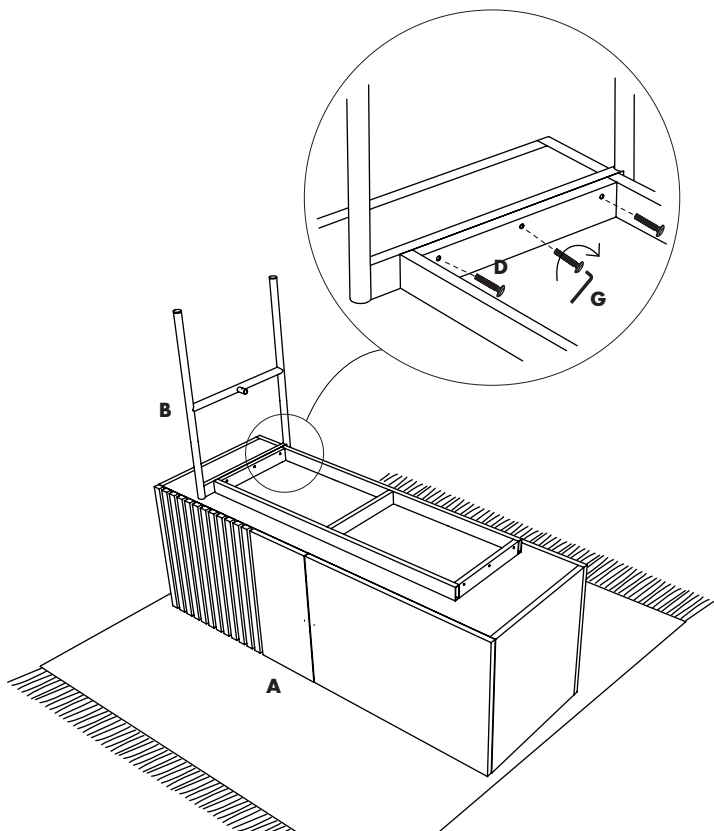

STEP 2

MOUNT THE METAL CROSSBAR ONTO THE LEG

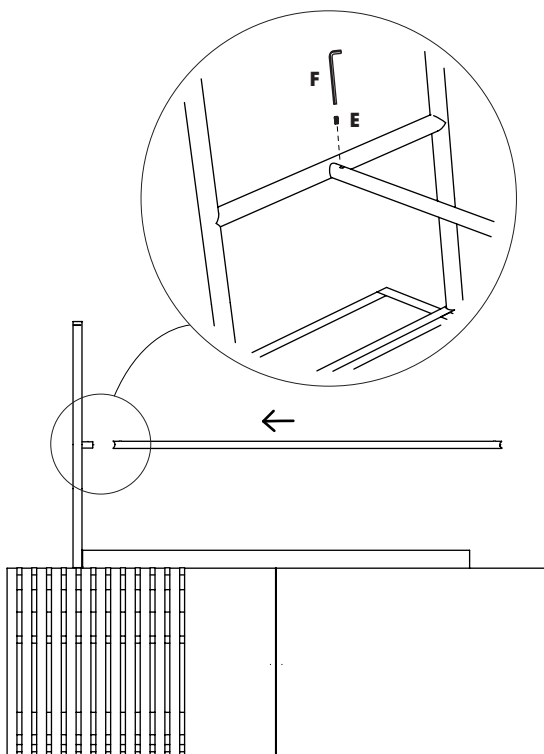

STEP 3

MOUNT THE SECOND LEG ON THE METAL FRAME AND CROSSBAR

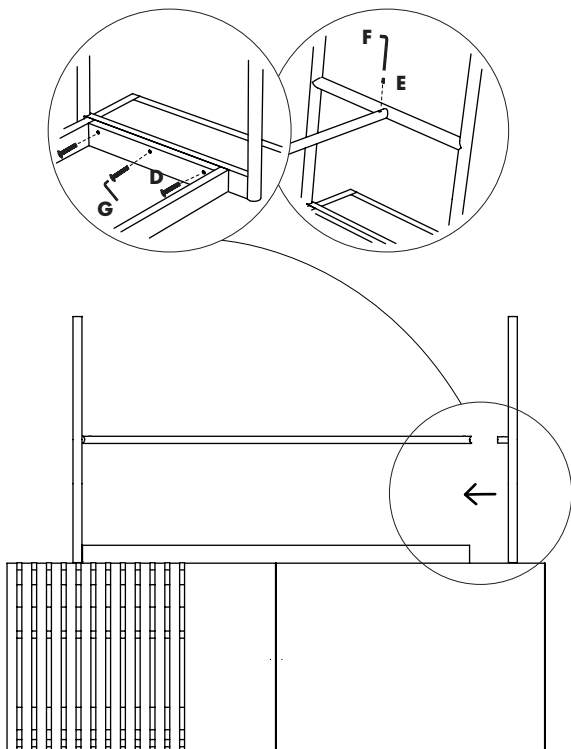

STEP 4

**DETACH THE HANDLES FROM THE INSIDE OF THE CABINET
AND ATTACH THEM ON THE OUTSIDE OF THE WOODEN DOORS**

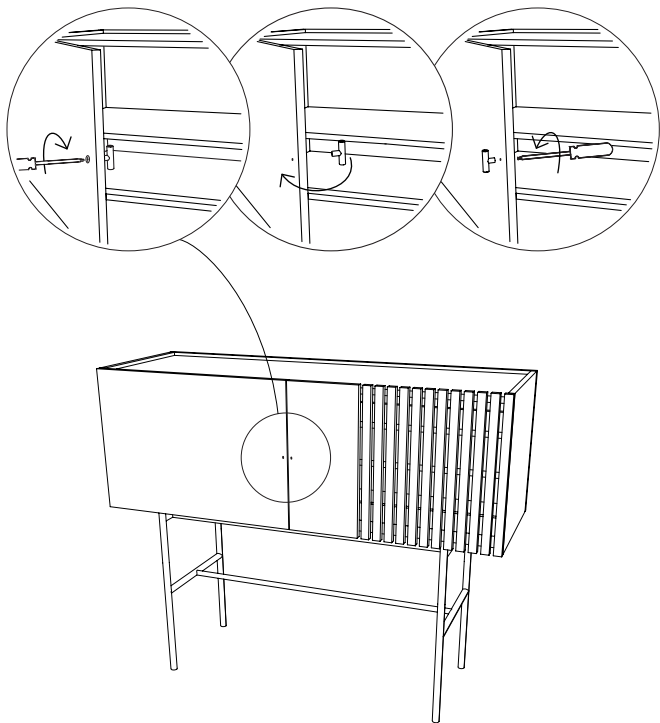

STEP 5

ADJUST THE FEET TO LEVEL THE CABINET

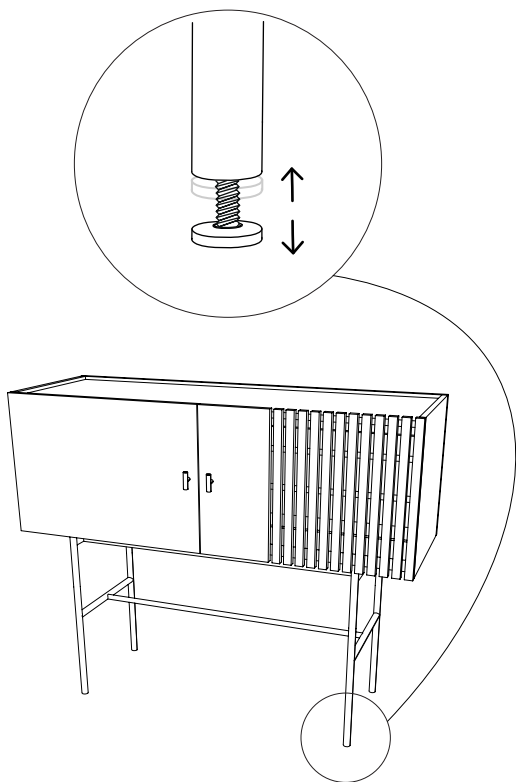

ADJUSTMENT INSTRUCTIONS

SHOULD YOU NEED TO LEVEL THE DOORS,
ALWAY START WITH THE NON SOLID DOOR AND MAKE SURE TO PLACE A
PIECE OF PAPER BETWEEN THE DOOR AND THE CABINET TO ENSURE THAT NO
DAMAGE OCCURS.

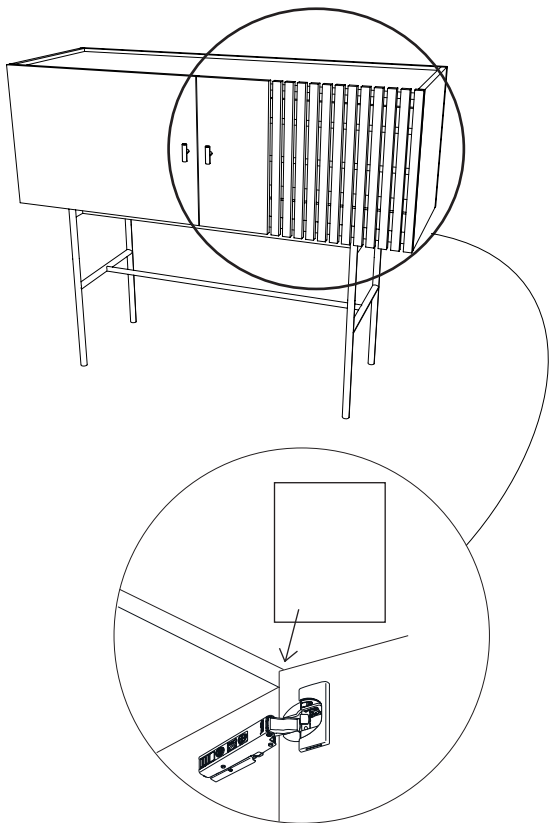

ADJUSTMENT INSTRUCTIONS

SHOULD YOU NEED TO LEVEL THE DOORS,
PLEASE FOLLOW THESE INSTRUCTIONS.

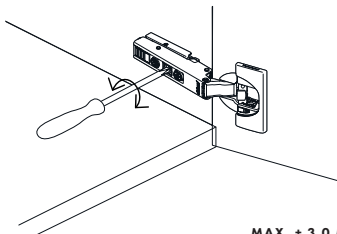

MAX. ± 3.0 MM

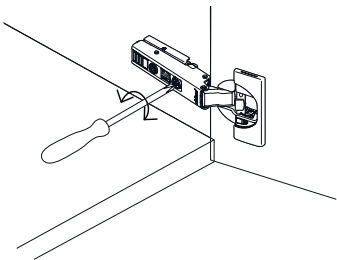

± 2.0 MM

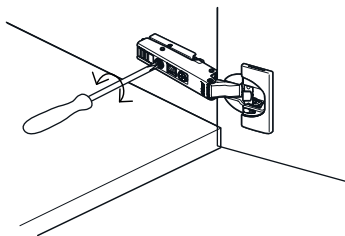

$+ 3.0 / - 2.0$ MM

SAFETY INSTRUCTIONS

TO PREVENT THIS FURNITURE FROM TIPPING OVER
RESULTING IN SERIOUS OR FATAL INJURIES, IT MUST
BE PERMANENTLY FIXED TO THE WALL

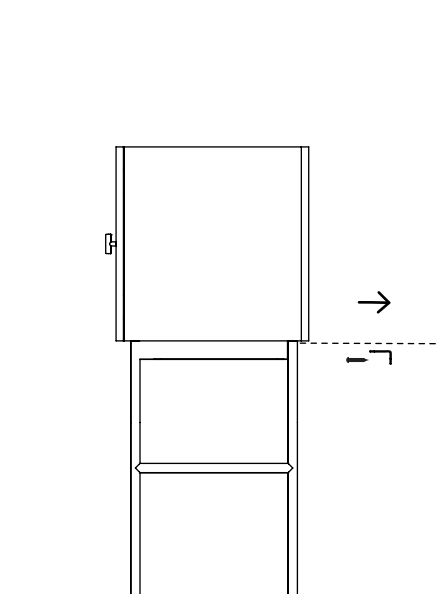

MEASURE THE HEIGHT AND DRILL HOLES IN THE WALL. APPLY SUITABLE WALL PLUGS. MOUNT THE METAL BRACKET TO THE WALL WITH SCREWS AND THEN MOUNT THE BRACKET TO THE CABINET.

