

## INSTALLATION INSTRUCTIONS

### Bennet LED Picture Light

PIC-1-8/PIC-1-18/PIC-1-24

ALDER & ORE

**CAUTION:** To prevent electrical shock, ensure electricity has been turned off at the circuit breaker before beginning.

- Read all instructions before installing.
- System is intended for installation by a licensed electrician in accordance with the National Electrical Code (NEC) and local regulations.
- When handling the fixture, do not apply pressure to the LEDs. Hold the fixture by the base only.
- Retain installation instructions for future maintenance reference.

**WARNING:** All parts must be used as indicated in these instructions. This product is designed for use only with the supplied parts and/or accessories designated for use by Lumens. Substitution of parts or accessories not designated for use with this product by Lumens could result in personal injury or property damage, and will void the warranty. Contact an authorized dealer or the manufacturer if any parts are damaged or missing.

**MAINTENANCE NOTE:** Coastal conditions may cause mineral and residue build-up on the fixture. We recommend that customers in coastal areas clean all external surfaces of the fixture once every two weeks with a wet cloth.

**MISE EN GARDE:** Pour éviter tout choc électrique, assurez-vous que le disjoncteur soit mis hors tension avant de commencer.

- Lisez toutes les instructions avant l'installation.
- Le système doit être installé par un électricien licencié conformément au code national de l'électricité (NEC), et également aux règlements locaux.
- Lors de la manipulation du luminaire, n'appuyez pas sur les LED. Tenez-le uniquement par la base.

**ATTENTION:** Toutes les pièces doivent être utilisées comme indiqué dans ces instructions. Ce produit est conçu pour être utilisé seulement avec les pièces et/ou accessoires fournis pour être utilisés avec les produits Lumens. Remplacer des pièces ou accessoires non conçus pour ce produit Lumens pourrait causer des dommages corporels ou matériels et pourrait également causer l'annulation de la garantie. Veuillez contacter un revendeur autorisé ou le fabricant si des pièces manquent ou sont endommagées.

**NOTE D'ENTRETIEN:** Les conditions côtières peut causer une accumulation de minéraux et de résidus sur le luminaire. Nous recommandons aux clients qui résident dans les zones côtières de nettoyer toutes les surfaces externes du luminaire une fois toutes les deux semaines avec un chiffon humide.

## HARDWARE

A



Wire Connector  
Qty: 3pcs+1 Extra

B



Mounting Screw  
Qty: 1pc Extra

C



Assembly Screw  
Qty: 2pcs+1 Extra

D

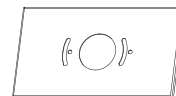

Conversion Plate  
Qty: 1pc

E

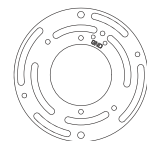

Mounting Ring  
Qty: 1pc

# INSTALLATION INSTRUCTIONS

## Bennet LED Picture Light

PIC-1-8/PIC-1-18/PIC-1-24

ALDER & ORE

### PREPARATION

1. Shut off the power at the circuit breaker and remove existing fixture, including the crossbar.
2. Carefully unpack your new fixture and lay out all the parts on a clear area. Be careful not to lose any small parts necessary for installation.

### MOUNTING THE FIXTURE ON SWITCH BOX (Fig. 1)

3. Remove the mounting screws (B) from the fixture.
  4. Secure the mounting plate to the junction box using the original junction box screws.
- Note: (i) It is recommended to use only original junction box screws or replacements provided by junction box manufacturer.  
(ii) The side of the wall plate marked "GND" must face out, towards the installer.

Fig. 1

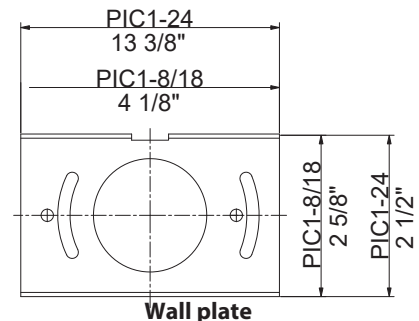
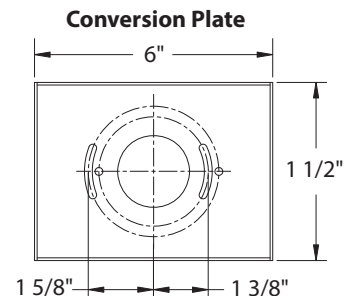
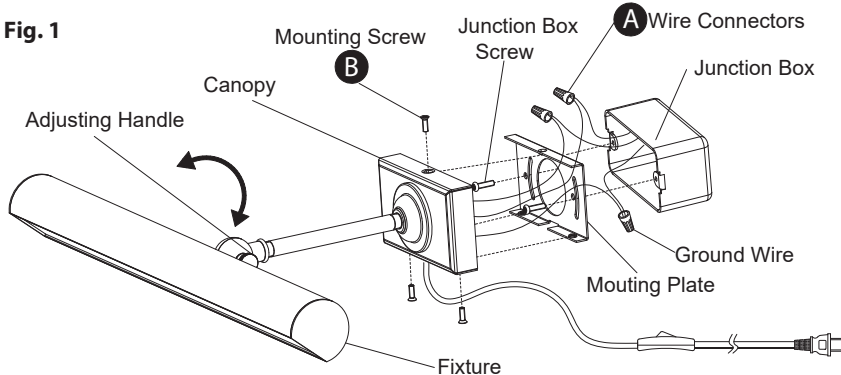

OR

### MOUNTING THE FIXTURE ON JUNCTION BOX (Fig. 2)

Fig. 2

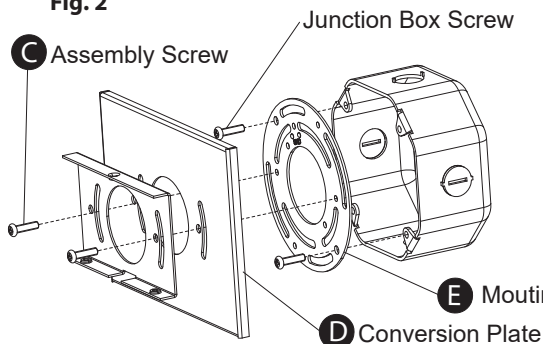
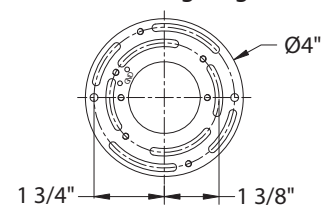

Fig. 3 Wiring



<b>Fixture Wires</b> Black or Smooth	<b>House Wires</b> Black (Hot)
<b>Fixture Wires</b> White or Ribbed	<b>House Wires</b> White (Neutral)
<b>Fixture Wires</b> Bare wire (Ground)	<b>House Wires</b> Green or Bare Copper (Ground)

Mounting Ring



3. Remove the mounting screw(B) from the fixture, and then remove the back plate.
4. Secure the mounting ring to the junction box using the junction box screw .
5. Secure the mounting plate and conversion plate (D) to the mounting ring(E) with the assembly screws (C).

### CONNECTING THE WIRES (Fig. 3)

6. This portable lamp has a polarized plug. If no plug is needed, remove the plug wire and reconnect it as shown in Figure 1.
7. Connect the fixture's wires to junction box wires as shown in Fig. 3, making sure that all wire connectors (A) are secured. If your outlet box has a green or bare copper ground wire, connect the fixture's ground wire to it. Otherwise, connect the fixture's ground wire directly to the back plate using the screw provided. After wires are connected, tuck them carefully inside the junction box.
8. Secure the fixture to the mounting back plate using the mounting screws (B).

**\*The fixture can be adjusted by adjusting handle to adjust the rotation angle of the lamp head\***

### IMPORTANT SAFETY INSTRUCTIONS

This portable lamp has a polarized plug (one blade is wider than the other) as a safety feature to reduce the risk of electric shock. This plug will fit a polarized outlet only one way. If the plug does not fit fully in the outlet, reverse the plug. If it still does not fit, contact a qualified electrician. Never use an extension cord unless the plug can be fully inserted. Do not change or alter the plug.