

## KTRIBE S2

Designed by Philippe Starck, 2005

F6257000

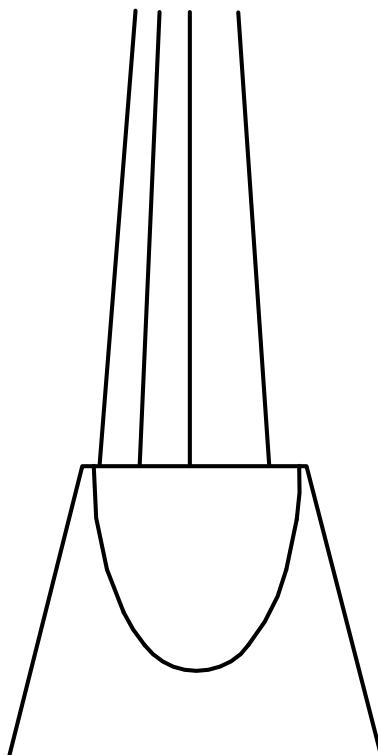

## KTRIBE S2

F6257000

EN

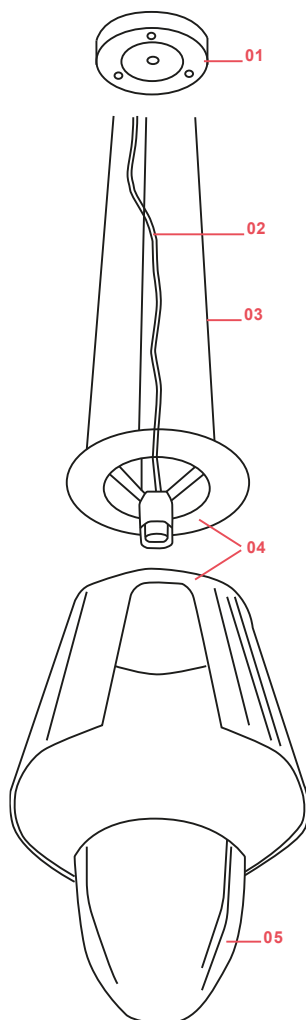

**01. RF6257001** – S2/S3 ceiling rose assembly

**02. RF4190200** – 5mt Sil/Fep transparent cable 2x0.75

**03. RF29875** – Steel cable pack (3 cables) 3mt.

**04. RF6257002** – Lamp holder wiring assembly with aluminized silver external diffuser

**05. RF19802** – K S2 PC Calibre Internal diffuser

KTRIBE S2 F6257000

EN

## RF6257001

S2/S3 CEILING ROSE ASSEMBLY

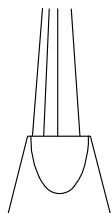

Ktribe  
S2  
p.03

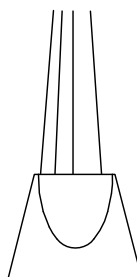

Ktribe  
S3  
p.03

**WARNING!** When installing and whenever acting on the appliance, ensure that the power supply has been switched off.  
For the installation of the spare-part, it is necessary to consult a qualified electrician.

KTRIBE S2 F6257000

EN

## RF6257001

S2/S3 CEILING ROSE ASSEMBLY

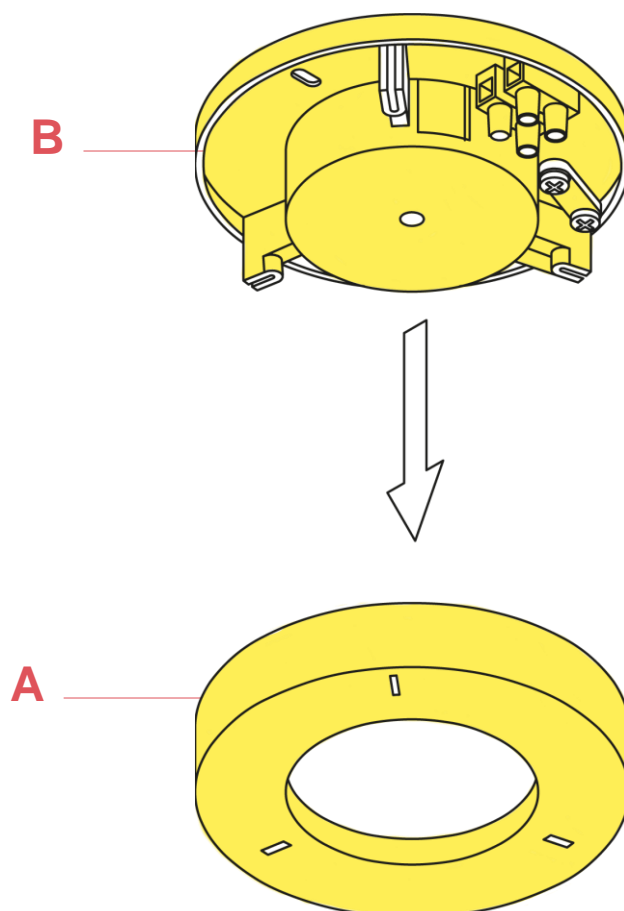

Fig.1

Unhook ceiling rose (A) from the ceiling attachment (B);

WARNING! When installing and whenever acting on the appliance, ensure that the power supply has been switched off.  
For the installation of the spare-part, it is necessary to consult a qualified electrician.

KTRIBE S2 F6257000

EN

## RF6257001

S2/S3 CEILING ROSE ASSEMBLY

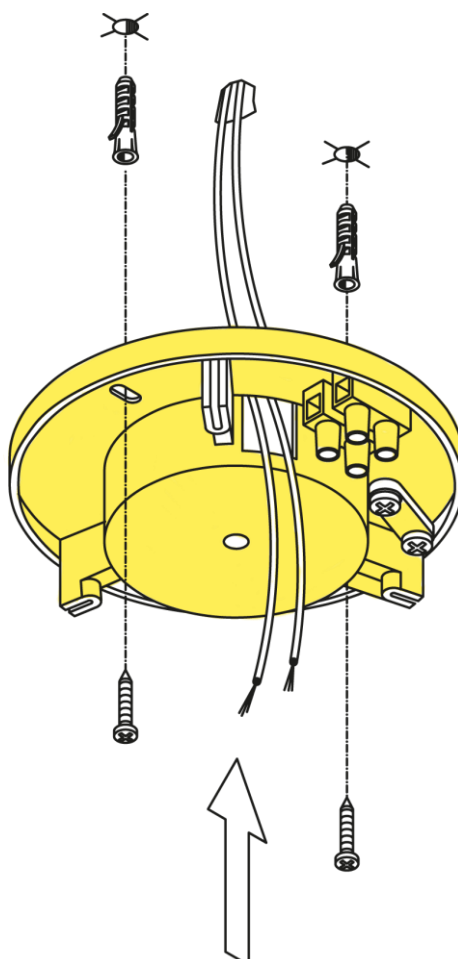

Fig.2

Connect the power cable to the terminal box.

Hook the ceiling rose (A) to the wall attachment (B).(Fig.1 page 4)

WARNING! When installing and whenever acting on the appliance, ensure that the power supply has been switched off.  
For the installation of the spare-part, it is necessary to consult a qualified electrician.

KTRIBE S2 F6257000

EN

## RF4190200

5 METERS SIL/FEP 2X0,75 TRANSPARENT ELECTRICAL CABLE

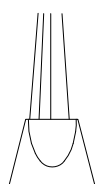

Ktribe S2  
p.06

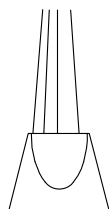

Ktribe S3  
p.06



Mini  
Glo-Ball S  
p.07



Ray S  
p.08



Romeo  
Babe  
p.08



Romeo  
Babe Soft S  
p.08

**WARNING!** When installing and whenever acting on the appliance, ensure that the power supply has been switched off.  
For the installation of the spare-part, it is necessary to consult a qualified electrician.

KTRIBE S2 F6257000

EN

## RF29875

STEEL CABLE PACKED 3 PIECES MT. 3

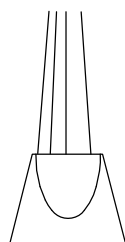

Ktribe S2  
p.07

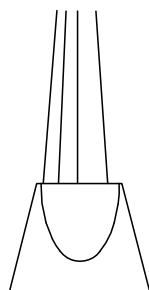

Ktribe S3  
p.07

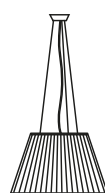

Romeo  
Moon S1  
p.08

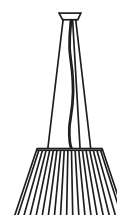

Romeo  
Moon S2  
p.08

WARNING! When installing and whenever acting on the appliance, ensure that the power supply has been switched off.  
For the installation of the spare-part, it is necessary to consult a qualified electrician.

KTRIBE S2 F6257000

EN

## RF29875

STEEL CABLE PACKED 3 PIECES MT. 3

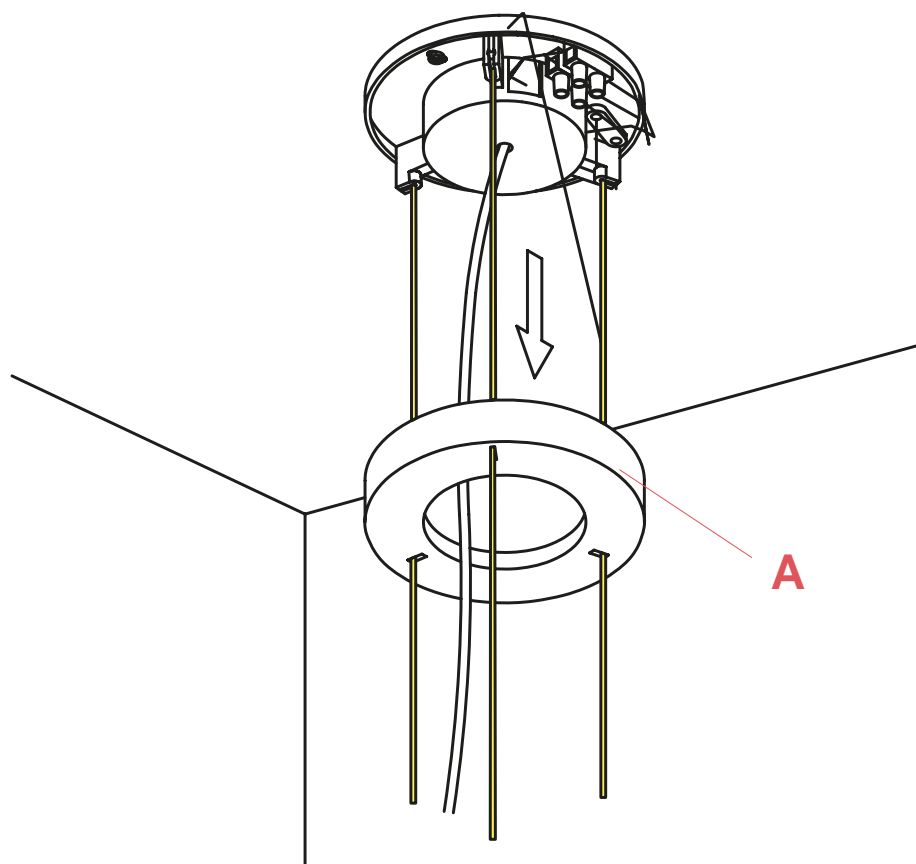

Fig.1

Unhook ceiling rose (A) from the ceiling attachment;

WARNING! When installing and whenever acting on the appliance, ensure that the power supply has been switched off.  
For the installation of the spare-part, it is necessary to consult a qualified electrician.



KTRIBE S2 F6257000

EN

## RF29875

STEEL CABLE PACKED 3 PIECES MT. 3

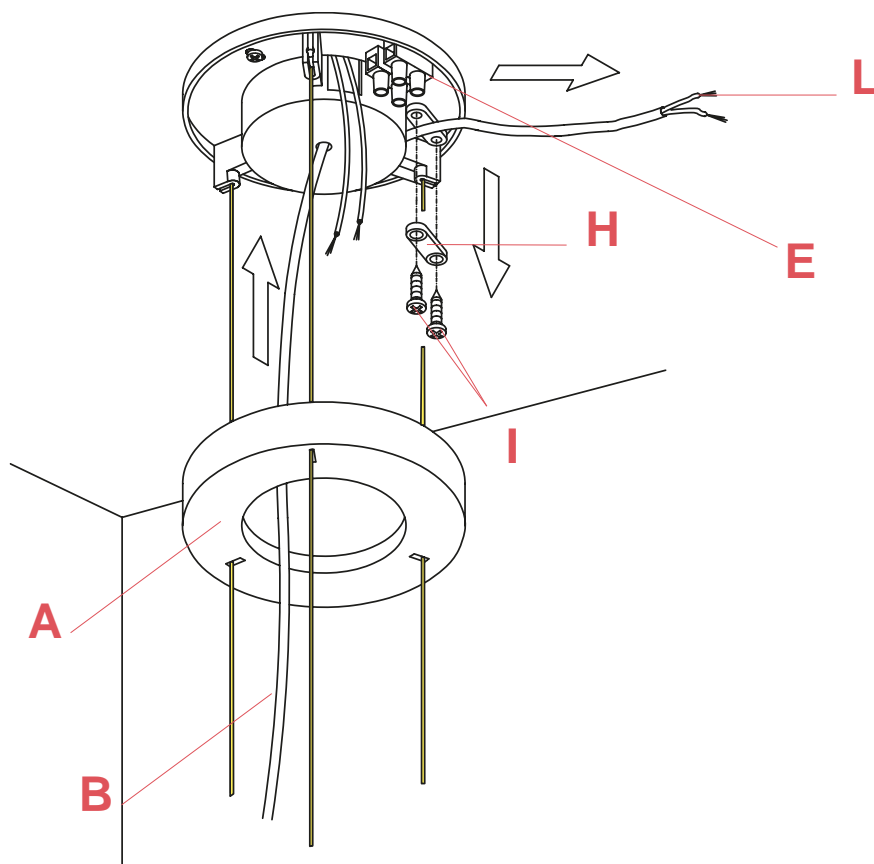

Fig.2

Free the electrical cable by disconnect the wires (L) from the terminal box (E) then unfastening the screws (I) of the cable clamp (H) and slide the cable out of the ceiling rose.

KTRIBE S2 F6257000

EN

**RF29875**

STEEL CABLE PACKED 3 PIECES MT. 3

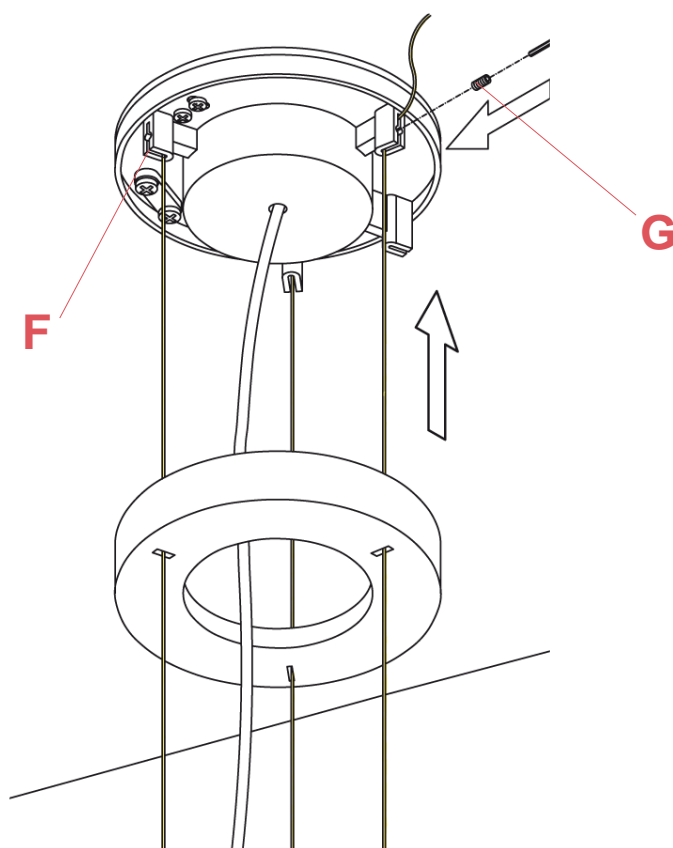

Fig.3

Unfasten the three grub screws (G) from the guides (F);  
Slide out the steel suspension wires from the guides (F).

**ATTENTION:** When doing this operation please hold the lamp to avoid that it can fall down.

WARNING! When installing and whenever acting on the appliance, ensure that the power supply has been switched off.  
For the installation of the spare-part, it is necessary to consult a qualified electrician.

©2021 Flos - All rights reserved - [www.flos.com](http://www.flos.com)  
Flos reserves the right to introduce any changes to its own models, without prior notice.

KTRIBE S2 F6257000

EN

**RF29875**

STEEL CABLE PACKED 3 PIECES MT. 3

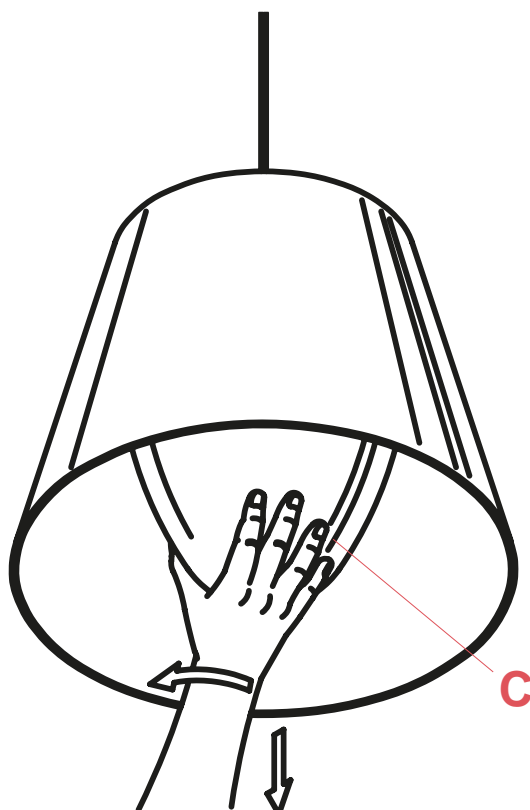

Fig.4

Remove the internal diffuser (C) unhooking it from the outer diffuser (M) by slightly rotating it counter clockwise.

WARNING! When installing and whenever acting on the appliance, ensure that the power supply has been switched off.  
For the installation of the spare-part, it is necessary to consult a qualified electrician.

KTRIBE S2 F6257000

EN

**RF29875**

STEEL CABLE PACKED 3 PIECES MT. 3

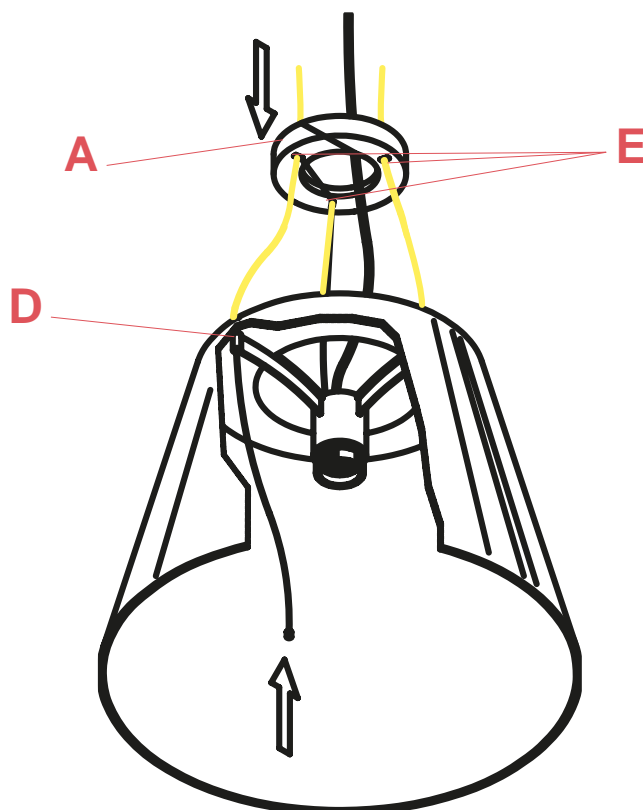

Fig.5

Slide the suspension wires out from the openings (E) on the ceiling rose (A) and slide them out from the outer diffuser holes (D).

Assemble now the new spare-part:

Insert the three steel suspension cables through the apposite holes (D) of the external diffusers and through the holes (E) of the ceiling rose (A).

WARNING! When installing and whenever acting on the appliance, ensure that the power supply has been switched off.  
For the installation of the spare-part, it is necessary to consult a qualified electrician.

KTRIBE S2 F6257000

EN

## RF29875

STEEL CABLE PACKED 3 PIECES MT. 3

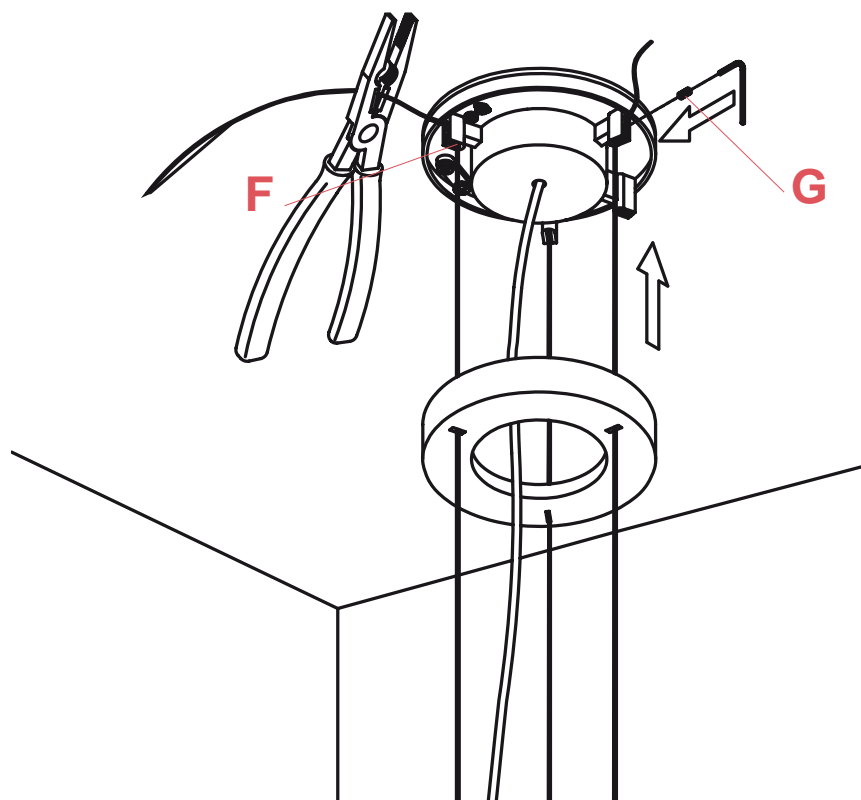

Fig.6

Bend the ends of the three steel suspension cables about 90° and then insert them into the corresponding guides (F) of the ceiling attachment; regulate the lamp to the desired height. After block the cables by tightening the screws (G) with an Allen key.  
Cut any excess length of the steel cables.

Insert the electrical cable (B) through the ceiling rose (A).  
Connect the electrical wires (L) to the terminal box (E). Lock the electrical cable isolation with the cable clamp (H) by fastening the screws (I).  
Hook the ceiling rose (A) to the wall attachment.(Fig.2 page 9)

**WARNING!** When installing and whenever acting on the appliance, ensure that the power supply has been switched off.  
For the installation of the spare-part, it is necessary to consult a qualified electrician.

KTRIBE S2 F6257000

EN

## RF6257002

WIRING ASSEMBLY AND EXTERNAL DIFFUSER WITH SUPPORT



WARNING! When installing and whenever acting on the appliance, ensure that the power supply has been switched off.  
For the installation of the spare-part, it is necessary to consult a qualified electrician.

©2021 Flos - All rights reserved - [www.flos.com](http://www.flos.com)  
Flos reserves the right to introduce any changes to its own models, without prior notice.

KTRIBE S2 F6257000

EN

## RF6257002

WIRING ASSEMBLY AND EXTERNAL DIFFUSER WITH SUPPORT

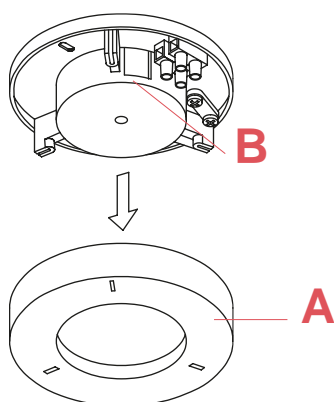

Fig.1

Unhook the rosette (A) from the socket on the roof (B).

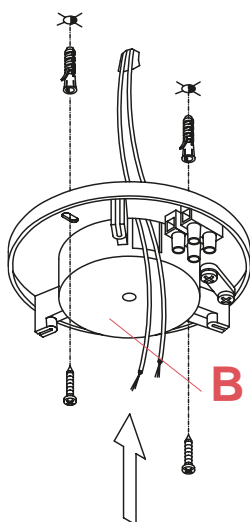

Fig.2

Attach the wall socket to the roof with screws and expansion plugs taking care to pass the feeding wires to the opposite lateral crack.

**NOTE:** choose the correct expansion plugs for the surface that it has to be mounted on.

## RF6257002

### WIRING ASSEMBLY AND EXTERNAL DIFFUSER WITH SUPPORT

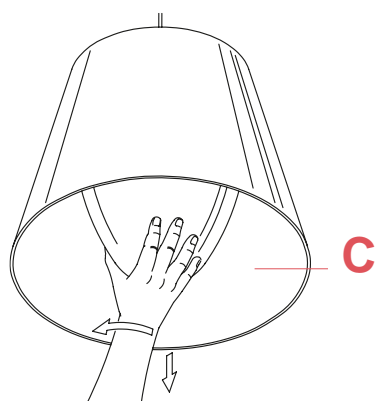

Fig.3

Remove the internal lampshade (C) unhooking it from the outer lampshade by turning it slightly anticlockwise.

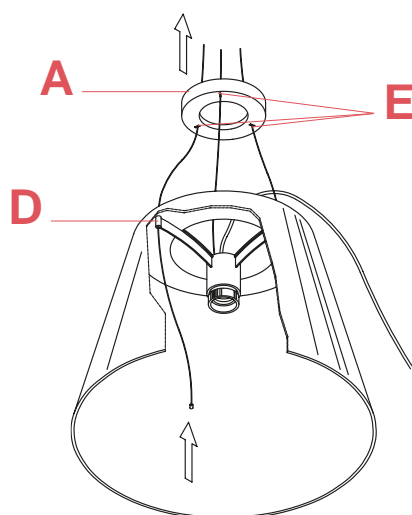

Fig.4

Attach the three small steel cables through the appropriate holes (D) of the same diffusers and through the holes (E) of the rosette (A).

**WARNING!** When installing and whenever acting on the appliance, ensure that the power supply has been switched off.  
For the installation of the spare-part, it is necessary to consult a qualified electrician.



## RF6257002

### WIRING ASSEMBLY AND EXTERNAL DIFFUSER WITH SUPPORT

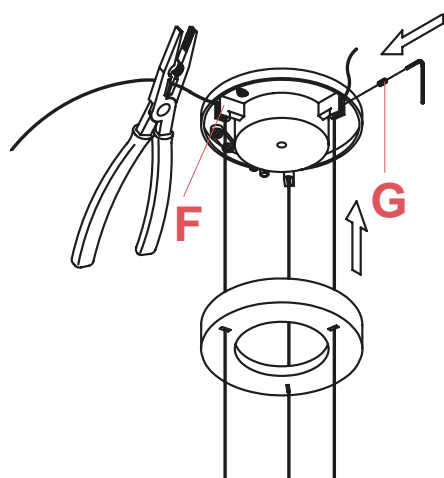

Fig.5

Bend the ends of the three steel cables by about 90° and then insert them into the corresponding guides (F) of the plugs on the roof; regulate the apparatus to the desired height thereafter block the cables by tightening the screws (G) with the keys supplied with the equipment; cut any excess length of the Cables.

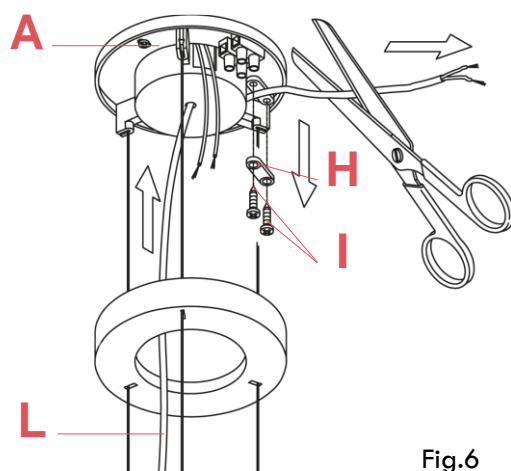

Fig.6

Dismantle the cable block (H) tightening the two screws (I); Pass the feeding cable (L) coming from the apparatus through the central hole of the rosette and attach it to the roof, thereafter cut the excess length of the cable.

KTRIBE S2 F6257000

EN

**RF6257002**

WIRING ASSEMBLY AND EXTERNAL DIFFUSER WITH SUPPORT

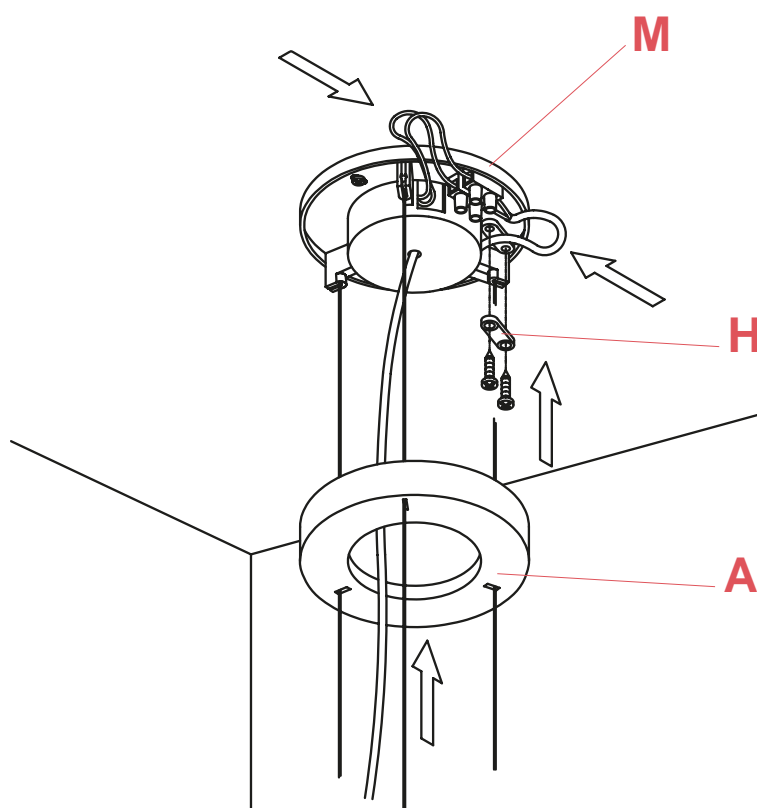

Fig.7

Connect the electric wires to the terminal board (M), block the feeding cable with the blocking cable (H); re-hooking the rosette (A).

WARNING! When installing and whenever acting on the appliance, ensure that the power supply has been switched off.  
For the installation of the spare-part, it is necessary to consult a qualified electrician.

**RF6257002**

WIRING ASSEMBLY AND EXTERNAL DIFFUSER WITH SUPPORT

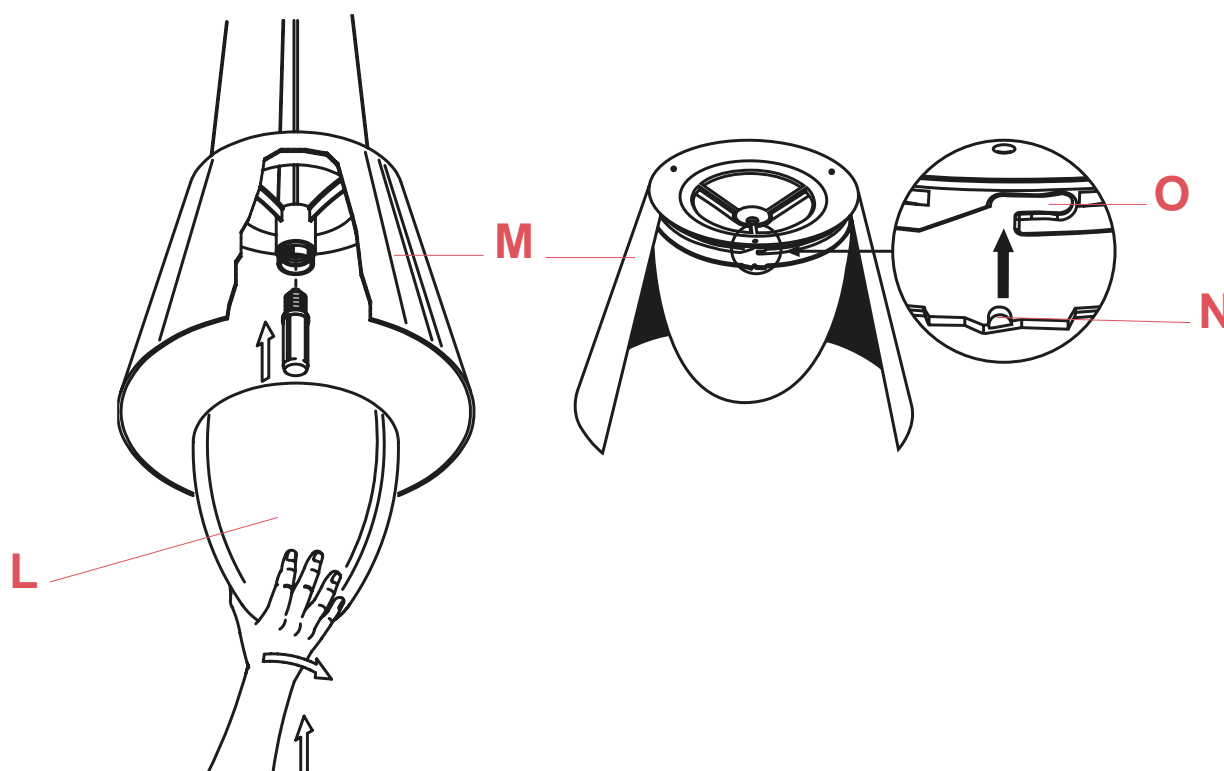

Fig.8

Insert the light bulb then replace the inner lampshade (L) blocking it with a “bayonet” movement: to carry out this operation the pins (N) hooking the inner lampshade must be inserted into the specific openings (O) of the outer lampshade (M).

KTRIBE S2 F6257000

EN

## RF19802

KTRIBE S2 CALIBRE INTERNAL DIFFUSER



WARNING! When installing and whenever acting on the appliance, ensure that the power supply has been switched off.  
For the installation of the spare-part, it is necessary to consult a qualified electrician.

©2021 Flos - All rights reserved - [www.flos.com](http://www.flos.com)  
Flos reserves the right to introduce any changes to its own models, without prior notice.

KTRIBE S2 F6257000

EN

**RF19802**

KTRIBE S2 CALIBRE INTERNAL DIFFUSER

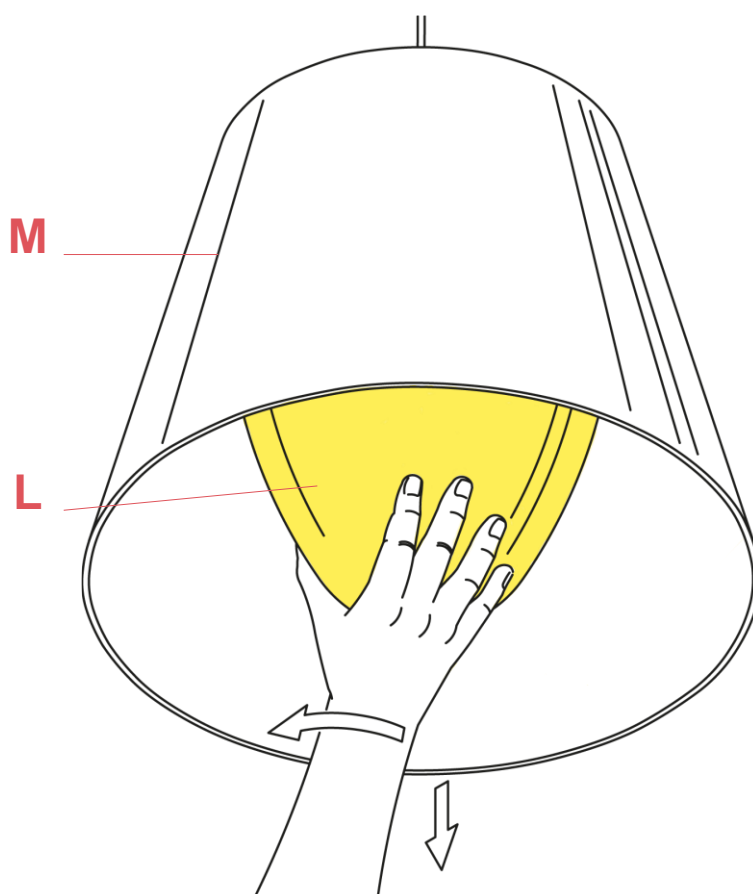

Fig.1

Remove the damaged internal diffuser (L) unhooking it from the outer diffuser (M) by slightly rotating it counter clockwise.

WARNING! When installing and whenever acting on the appliance, ensure that the power supply has been switched off.  
For the installation of the spare-part, it is necessary to consult a qualified electrician.

KTRIBE S2 F6257000

EN

**RF19802**

KTRIBE S2 CALIBRE INTERNAL DIFFUSER

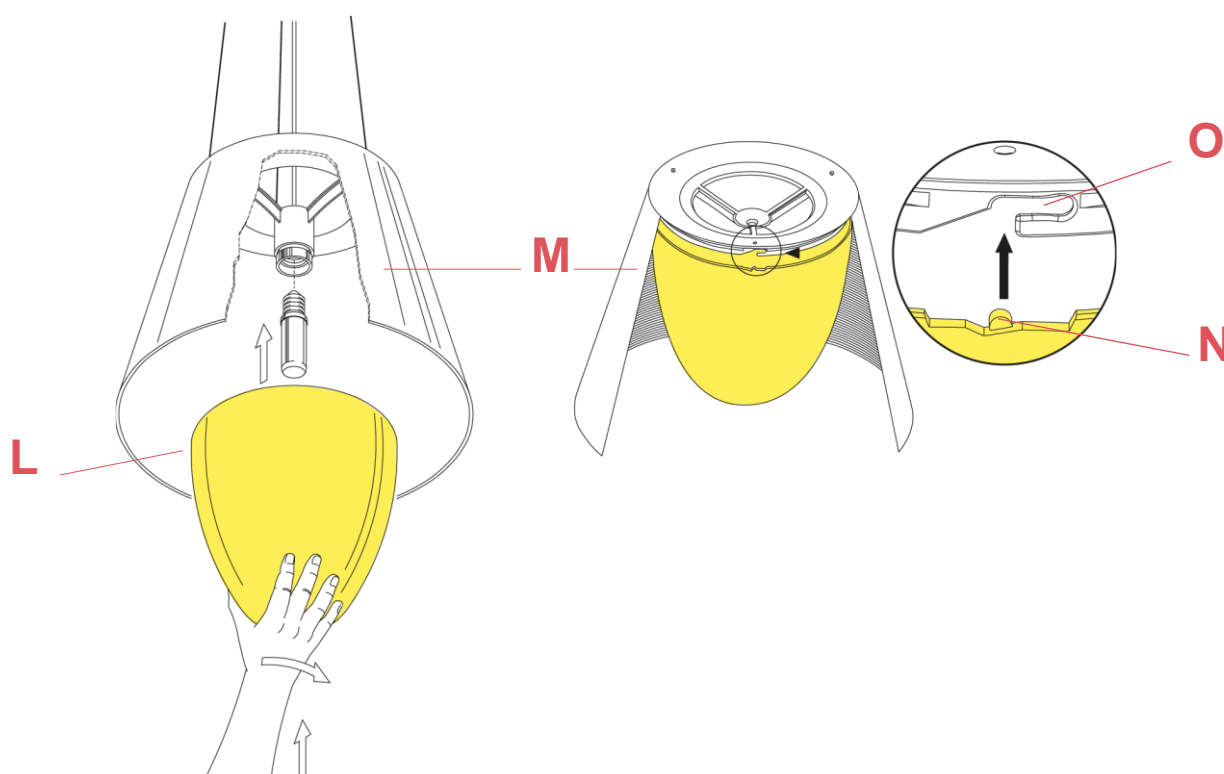

Fig.2

Insert the light bulb if not present then replace the inner diffuser (L) blocking it to the outer diffuser. To carry out this operation it is necessary that the pins (N) hook of the inner diffuser must go inserted into the specific openings (O) of the outer diffuser (M).